

## Models with touchscreen

## Touchscreen Operation

Use simple gestures—including touching, swiping, and scrolling—to operate certain audio functions.

Some items may be grayed out during driving to reduce the potential for distraction. You can select them when the vehicle is stopped or use voice commands\*.

Wearing gloves may limit or prevent touchscreen response.

You can use the microfiber cleaning cloth included in the glovebox kit to remove dust or fingerprints from the touchscreen.

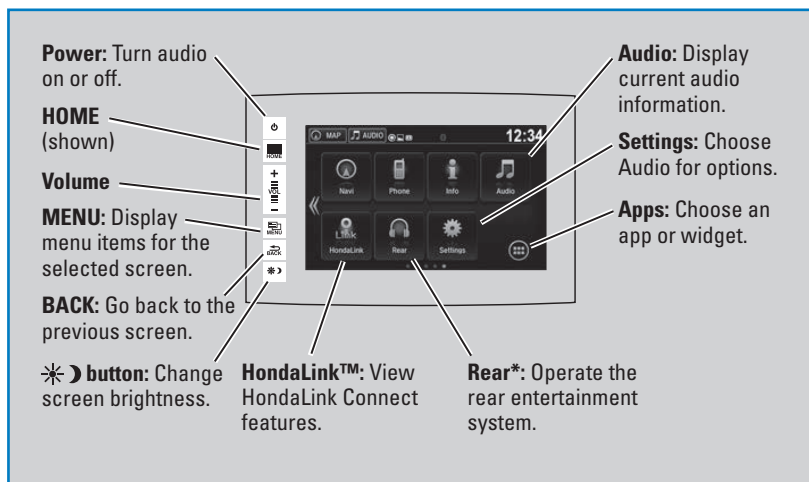

### ■ Changing Icon Order

You can change the order of the icons on the Home screen.

1. From the Home screen, select and hold an icon to enter the customization screen.
2. Select and hold the icon you want to move and slide it to a different position.
3. Select OK when complete.



### ■ Adding Apps or Widgets to the Home Screen

You can add apps or widgets to the Home screen for easy selection.

1. From the Home screen, select and hold an empty space.
2. Select Add App or Add Widget. The Apps screen appears.
3. Select and hold the app or widget you want to add to the Home screen. The customization screen appears.
4. Select and hold the app or widget and move it to where you want.
5. Select OK when complete.

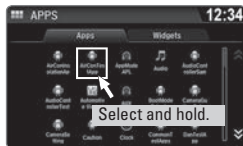

## Models with touchscreen

### HondaLink™

Provides you with useful information about your vehicle directly from Honda.

To check phone compatibility, visit [handsfreelink.com](http://handsfreelink.com) (U.S.) or [handsfreelink.ca](http://handsfreelink.ca) (Canada). Standard data rates may apply with your phone service provider.

To get more information on HondaLink features and to download the app, visit [www.hondalink.com](http://www.hondalink.com) (U.S.) or [honda.ca/hondalink](http://honda.ca/hondalink) (Canada).

#### ■ HondaLink Connection

Follow the steps below to connect to HondaLink and use its features.

1. Download the HondaLink Connect app to your compatible smartphone.
2. Pair your phone to *Bluetooth®* HandsFreeLink®.
3. From the HOME screen, select HondaLink.
4. Certain features require you to send vehicle information to Honda. Select Enable Once, Always Enable, or Cancel.

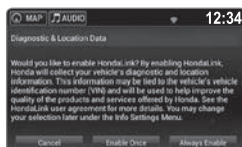

#### ■ HondaLink Menu

Select a menu option.

**Places\*:** Display restaurants, gas stations, and other locations. You can send a location to the navigation system and set a route.

**Vehicle:** Get instructional messages when your vehicle needs service.

**Messages from Honda:** Display helpful and important information from Honda.

**Help & Support:** Display tips for vehicle usage, get roadside assistance, or contact customer service.

**Weather:** Display a weekly five-day weather forecast for any location.



## Models with touchscreen

### Wi-Fi Connection

You can connect the audio system to the internet using Wi-Fi and use online services through the touchscreen. If your compatible phone has hotspot capabilities, the system can be tethered to the phone. Follow the steps below to set up Wi-Fi when the vehicle is stopped. Standard data rates apply with your phone service provider.

1. From the Home screen, select Settings.
2. Select Bluetooth/Wi-Fi. Select the Wi-Fi tab.
3. Select Wi-Fi On/Off Status, and select On.
4. Select Wi-Fi Network List. Make sure your phone's Wi-Fi setting is in access point (tethering) mode.
5. Select the phone you want to connect to the system. If the phone you want to connect does not appear, select Scan.
6. Select Connect.
7. Enter a password for your phone. Select Done.  
The Wi-Fi symbol is displayed on the list when connection is successful.



### Aha™ Radio

Access music and information programming, location-based services, and social media through your vehicle's audio system.

Visit [handsfreelink.honda.com](http://handsfreelink.honda.com) (U.S.) or [handsfreelink.ca](http://handsfreelink.ca) (Canada) to check phone compatibility. Standard data rates apply. Make sure you have an active Aha account.

#### Bluetooth connection

Connect your compatible smartphone via *Bluetooth*® HandsFreeLink®. Make sure the HondaLink Connect app is downloaded to your phone. Follow steps 1 and 2 below.

#### Wi-Fi connection

You can also connect via Wi-Fi or Wi-Fi tethering with your enabled smartphone. Follow steps 1 and 2 below.

1. From the HOME screen, swipe to the second screen (if necessary). Select Aha.
2. Enter your Aha account email and password to begin using Aha.

## Models with touchscreen

**FM/AM Radio**

Play FM or AM radio stations.



**Source:** Select the FM or AM icon.

**Scan:** Scan for each station with a strong signal.

**Tune:** Change the station.

**Presets:** Select and hold a preset number to store the current station. Select a preset number to select a previously stored station.

**Open/close:** Display or hide the station list or preset list.

**TAG\*:** Tag a song on an HD Radio™ station to store to an iPod/iPhone.

**Seek:** Search for the next or previous station with a strong signal.



## Models with touchscreen

## SiriusXM® Radio\*

Available on a subscription basis only. For more information or to subscribe, contact your dealer, or visit [www.siriusxm.com](http://www.siriusxm.com) (U.S.) or [www.sirius.ca](http://www.sirius.ca) (Canada).



**Source:** Select the XM icon.

**Scan:** Scan for each station with a strong signal.

**Category:** Change the category.

**Presets:** Select and hold a preset number to store the current station. Select a preset number to select a previously stored station.

**Channel:** Change the channel. Press and hold to skip 10 channels at a time.

**Skip:** Change the selection. Press and hold to skip rapidly.

**Open/close:** Display or hide the channel list or preset list.

**TAG\*:** Tag a song to store to an iPod/iPhone.



To learn about additional features—such as multi-channel preset, replay, or SportsFlash—see your Owner's Manual on the Owner Information CD or visit [owners.honda.com](http://owners.honda.com) (U.S.) or [myhonda.ca](http://myhonda.ca) (Canada).

Models with touchscreen

iPod®

Play and operate an iPod through the vehicle's audio system. Connect your device to the USB port.

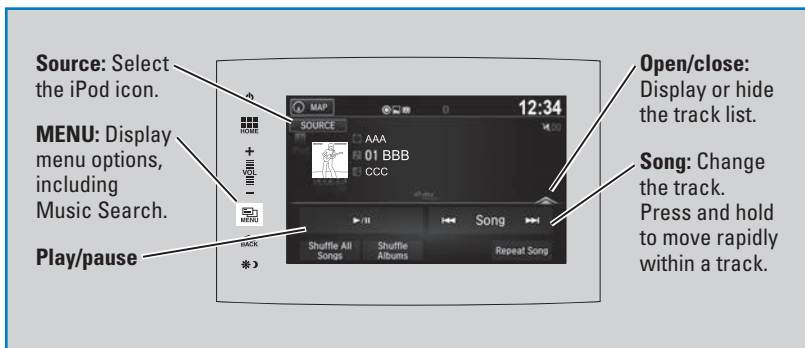

■ Searching for Music

Use the touchscreen to search for tracks stored on the iPod.

1. From the audio screen, press MENU.
2. Select Music Search.
3. Select a search option.
4. Select the track you want to play.



On vehicles with navigation, you can also search for and play iPod music using Song By Voice™.

## Models with touchscreen

## USB Flash Drive

Play and operate a USB flash drive through the vehicle's audio system. Connect your device to the USB port.

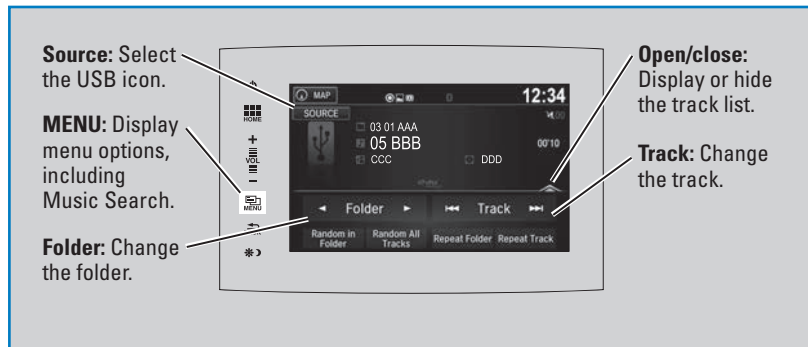

## ■ Searching for Music

Use the touchscreen to search for tracks stored on the USB flash drive.

1. From the audio screen, press MENU.
2. Select Music Search.
3. Select a folder.
4. Select the track you want to play.

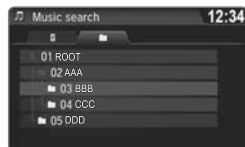



## Models with touchscreen

**Bluetooth® Audio**

Play streaming or stored audio from your compatible phone through the vehicle's audio system. Visit [handsfreelink.com](http://handsfreelink.com) (U.S.) or [handsfreelink.ca](http://handsfreelink.ca) (Canada) to check phone compatibility. Standard data rates apply with your phone service provider. Connect your phone to **Bluetooth® HandsFreeLink®**.

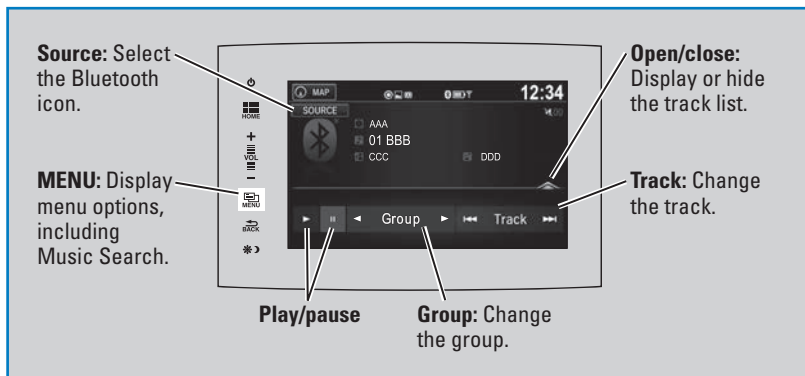
**■ Searching for Music**

Use the touchscreen to search for tracks stored on the device.

1. From the audio screen, press MENU.
2. Select Music Search.
3. Select a search category.
4. Select the track you want to play.

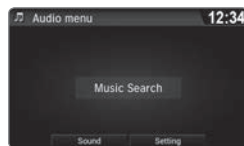
**Notes:**

- Make sure the volume on your phone is properly adjusted.
- You may need to enable additional settings on your phone for playback.
- The resume/pause function and remote audio controls are not supported on all phones.

*State, provincial, or local laws may prohibit the operation of handheld electronic devices while operating a vehicle. Only launch streaming audio on your phone when it is safe to do so.*

## Models with touchscreen

### Pandora®

Play and operate Pandora from your compatible phone through the vehicle's audio system. Visit [handsfreelink.com](http://handsfreelink.com) to check phone compatibility. Standard data rates apply with your phone service provider. **Available in the U.S. only.**

Connect your phone when the vehicle is stopped.

#### For iPhone:

- Connect via **Bluetooth®** HandsFreeLink® or USB port.
- A pop-up may appear on your phone requesting you to allow access for Pandora to be launched.
- If you cannot operate Pandora through the audio system, it may be streaming through **Bluetooth®** Audio. Make sure Pandora is selected on the audio system.
- If Pandora still does not operate, try rebooting the phone and reconnecting the cable if necessary.

#### For other compatible smartphones:

- Connect via **Bluetooth®** HandsFreeLink®.

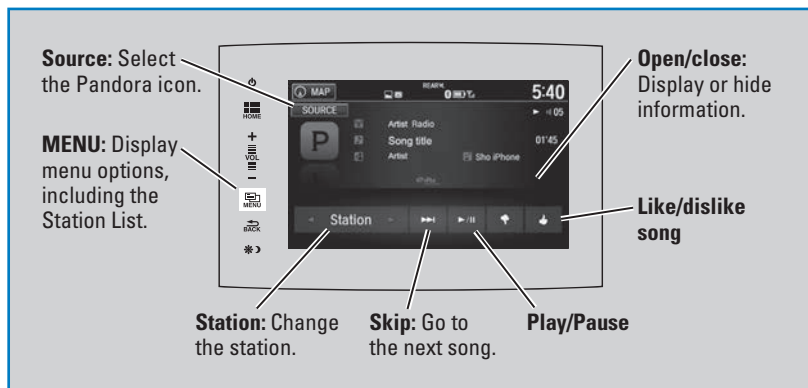

*State, provincial, or local laws may prohibit the operation of handheld electronic devices while operating a vehicle. Only launch streaming audio on your phone when it is safe to do so.*