

AUDIO AND CONNECTIVITY

Learn how to operate the vehicle's audio system.

Basic Audio Operation

Connect audio devices and operate buttons and displays for the audio system.

USB Adapter Cable*

1. Open the center console. Unclip the USB connector and loosen the adapter cable.
2. Connect a USB flash drive or other audio device, such as an iPod® or iPhone®.

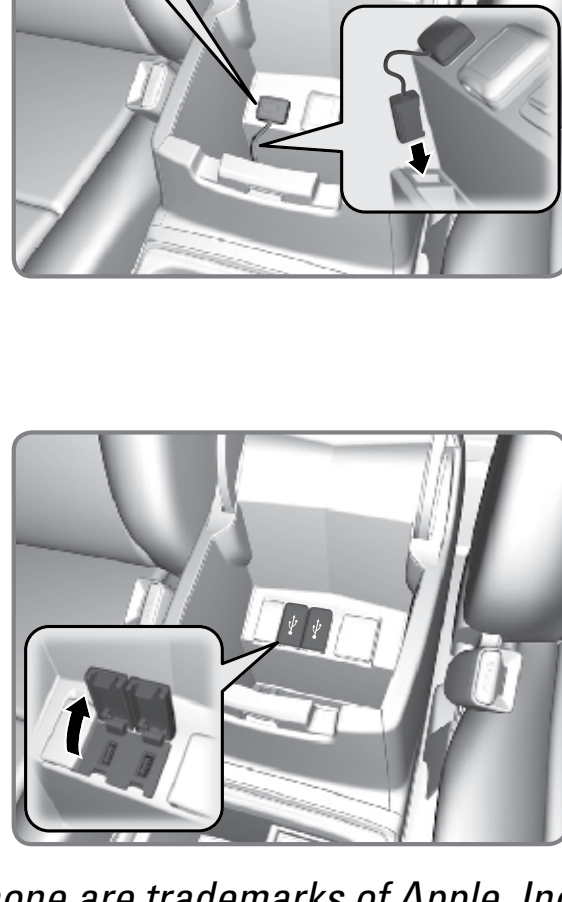

USB Port*

1. Open the center console. Open one of the USB covers.
2. Insert a USB flash drive or other audio device, such as an iPod® or iPhone®, into the USB port.

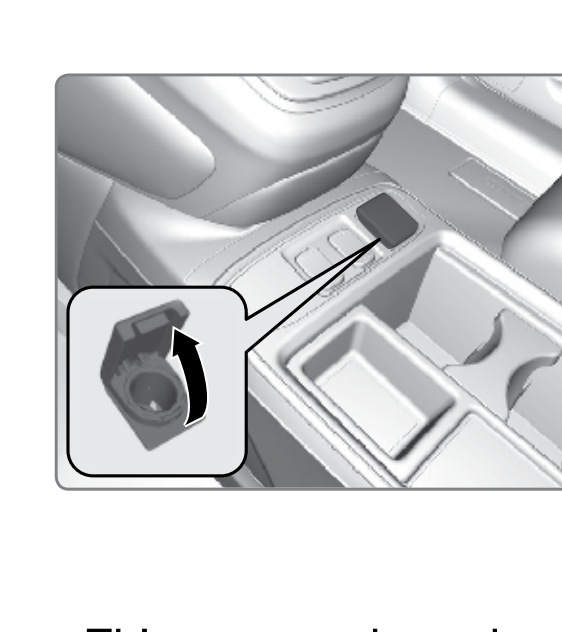

iPod and iPhone are trademarks of Apple, Inc. State or local laws may prohibit the operation of handheld electronic devices while operating a vehicle.

Accessory Power Socket

Open the socket cover in the front console to use power when the vehicle is on. An additional power socket is also located in the center console.

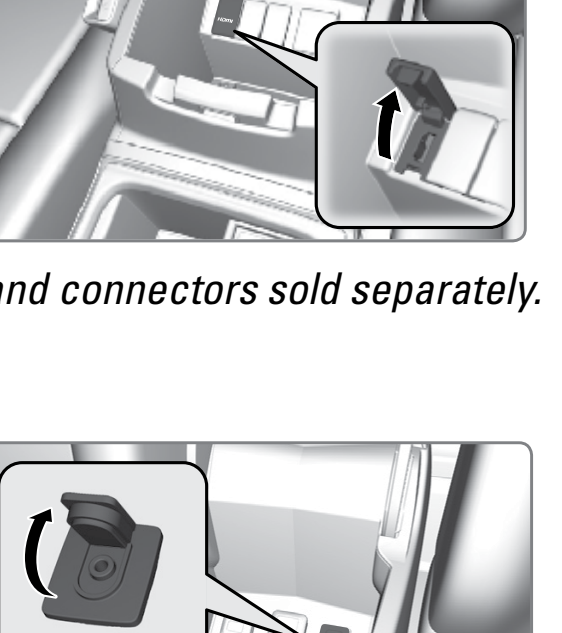

NOTICE

Do not insert an automotive type cigarette lighter element. This can overheat the power socket.

**if equipped*

HDMI Port*

1. Open the center console. Open the HDMI cover.
2. Insert an HDMI cable to the HDMI port.

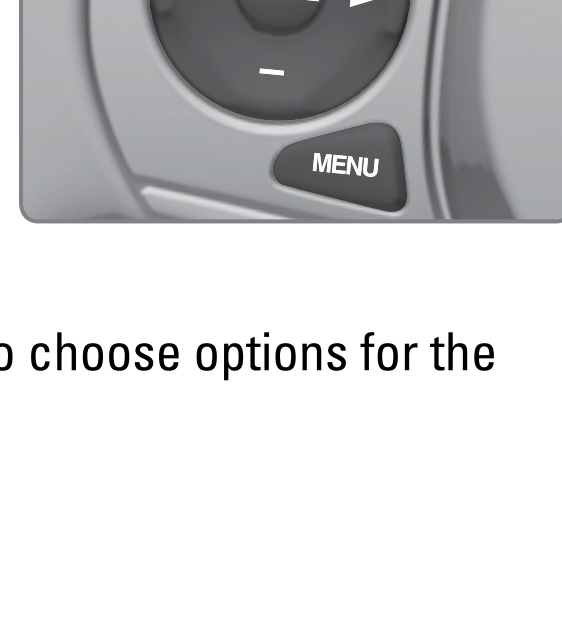

Additional cables and connectors sold separately.

Auxiliary Input Jack*

Connect standard audio devices with a 1/8-inch (3.5 mm) stereo miniplug.

1. Open the AUX cover.
2. Insert the miniplug attached to the audio device into the jack. The audio system switches to AUX mode. Use the device to control the audio.

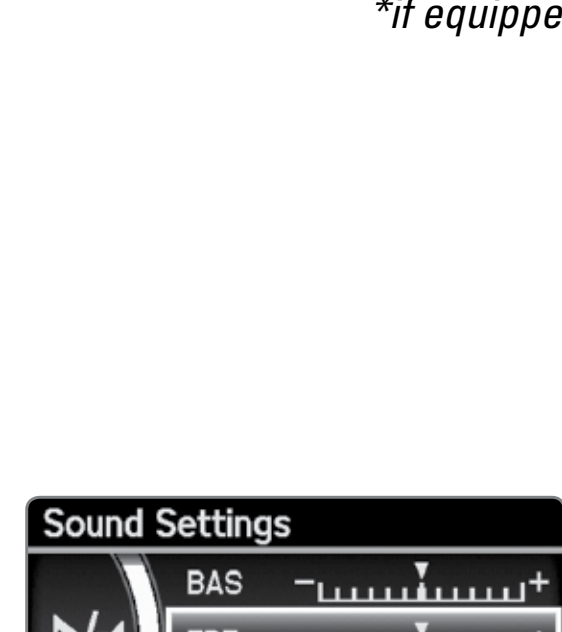

Steering Wheel Controls

You can operate certain functions of the audio system using the steering wheel controls.

SOURCE button: Cycle through available audio modes.

◀/▶ buttons: Change presets, tracks, albums, or folders.

+/- buttons: Adjust audio volume.

MENU button: From the audio screen, press and hold to choose options for the current audio mode (models with touchscreen).

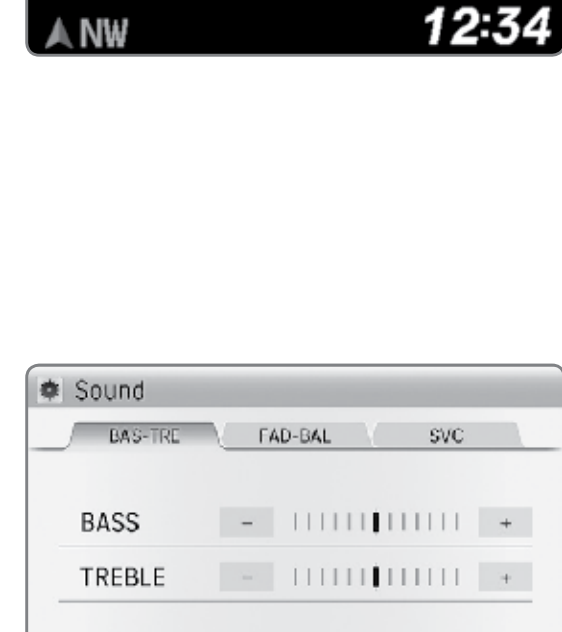

FM/AM/XM® Radio

Press **◀** or **▶** for the next or previous station.

Press and hold **◀** or **▶** for the next or previous strong station.

CD/iPod®/USB/Bluetooth® Audio

Press **◀** or **▶** for the next or previous track.

Press and hold **◀** or **▶** for the next or previous folder (CD/USB).

Pandora®

Press **▶** for the next song.

Press and hold **◀** or **▶** for the next or previous station.

**if equipped*

Adjusting the Sound

Adjust various sound settings.

Models with one display

Use the selector knob to make and enter selections.

1. Press the SETUP button.
2. Select Sound Settings.
3. Select a sound mode to change, and adjust it using the selector knob.
4. Press the Back button to exit the menu.

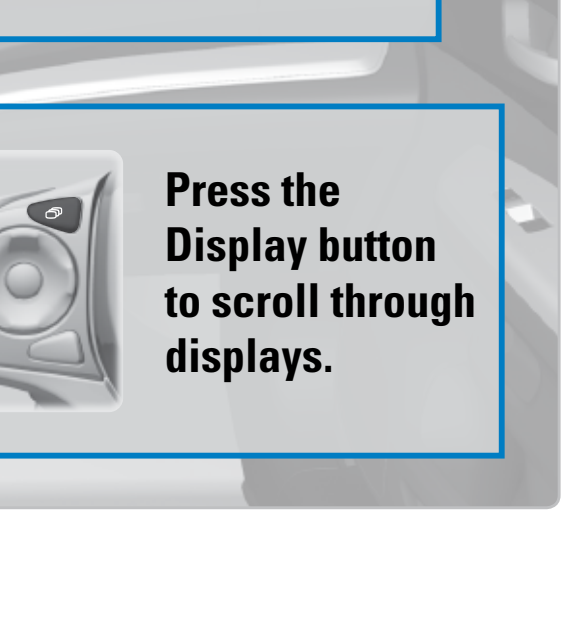

Models with touchscreen

Make selections using the touchscreen.

1. From the HOME screen, select Settings.
2. Select Audio.
3. Select Sound.
4. Select the tabs to change the sound mode and adjust the setting.
5. Select OK when complete.

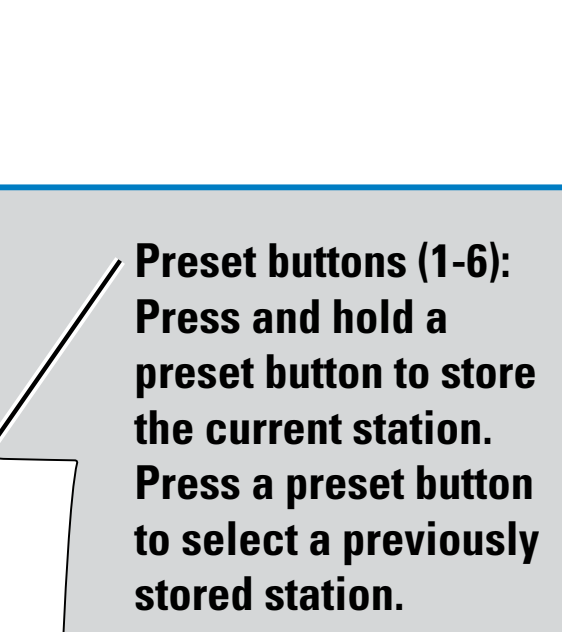

**if equipped*

Intelligent Multi-Information Display (i-MID)

Display audio information. Use the buttons to control the display and audio system.

Models with one display

Power button: Press to turn the audio system on and off.

BACK button: Go back to the previous display.

Selector knob/volume knob: Make and enter selections. Rotate to adjust volume.

SETUP button: Select various audio mode options, sound settings, and clock adjustment.

i-MID

Press the Display button to scroll through displays.

FM/AM Radio

Play FM or AM radio stations.

Models with one display

SCAN button: Press to sample strong stations on the selected band. Press again to turn off scan.

FM/AM button: Select a band.

(⇌ / ▲ / ▼) buttons: Press to display a radio data category. Press Seek/Skip to search the band for stations in that category.

Preset buttons (1-6): Press and hold a preset button to store the current station. Press a preset button to select a previously stored station.

Seek/Skip buttons: Search up and down the selected band for a station with a strong signal.

FM/AM radio display

Compact Disc (CD)

The audio system supports audio CDs, CD-Rs, and CD-RWs in MP3, WMA, or AAC formats.

Models with one display

SCAN button: Press to sample each track. Press again to sample the first file in each folder. Press and hold to turn off scan.

(⇌ / ▲ / ▼) buttons: Press to skip to the next or previous folder.

CD button: Play a CD.

CD eject button

Seek/Skip buttons: Press to change tracks. Press and hold to move rapidly within a track.

CD display

NOTICE

Do not use CDs with adhesive labels or insert a damaged CD. Inserting these types of CDs may cause them to get stuck or damage the audio unit.

iPod®

Play and operate an iPod through the vehicle's audio system.

Models with one display

(⇌ / ▲ / ▼) button: Press to go back to the previous display.

Seek/Skip buttons: Press to change tracks.

AUX button: Play iPod.

Selector knob: Press the display the iPod menu. Rotate to scroll through items, and select an item to play.

iPod display

Searching for Music

Use the selector knob to search for tracks stored on the iPod.

1. From the audio screen, press the selector knob.
2. Select a search option.
3. Select the track you want to play.

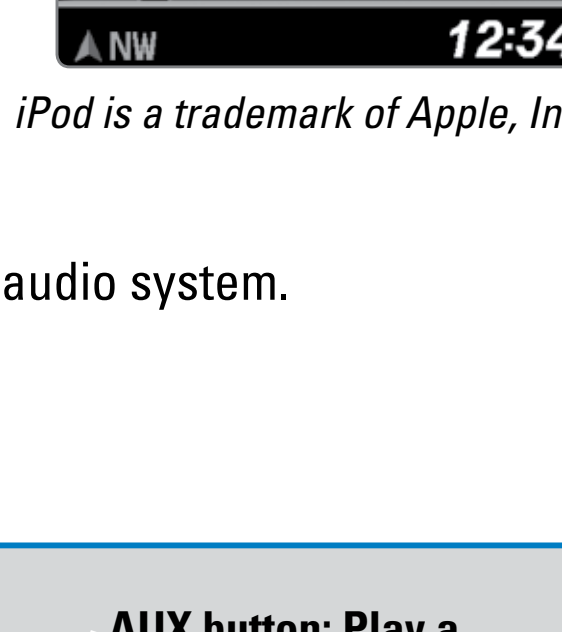

iPod is a trademark of Apple, Inc.

USB Flash Drive

Play and operate a USB flash drive through the vehicle's audio system.

Models with one display

SCAN button: Press to sample each track in the current folder. Press again to sample the first file in each folder. Press and hold to turn off scan.

(⇌ / ▲ / ▼) buttons: Press to skip to the next or previous folder.

AUX button: Play a connected USB flash drive.

Seek/Skip buttons: Press to change tracks. Press and hold to move rapidly within a track.

USB display

Searching for Music

Use the selector knob to search for tracks stored on the flash drive.

1. From the audio screen, press the selector knob.
2. Select a folder.
3. Select the track you want to play.



iPod is a trademark of Apple, Inc.

Bluetooth® Audio

Play streaming or stored audio from your compatible phone through the vehicle's audio system. Visit handsfreelink.com (U.S.) or handsfreelink.ca (Canada) to check phone compatibility. Standard data rates apply.

Models with one display

Connect your phone to **Bluetooth® HandsFreeLink®**.

Preset button 1: Pause or resume audio.

AUX button: Play Bluetooth® Audio.

Seek/Skip buttons: Change audio tracks.

Bluetooth® Audio display

Notes:

- Make sure the volume on your phone is properly adjusted.
- You may need to enable additional settings on your phone for playback.
- The resume/pause function and remote audio controls are not supported on all phones.

State or local laws may prohibit the operation of handheld electronic devices while operating a vehicle. Only launch streaming audio on your phone when it is safe to do so.