

NAVIGATION*

Learn how to enter a destination and operate the navigation system.

Basic Navigation Operation

A real-time navigation system uses GPS and a map database to show your current location and help guide you to a desired destination. You can operate the system using voice commands or the touchscreen.

To reduce the potential for driver distraction, certain manual functions may be inoperable or grayed out while the vehicle is moving. Voice commands are always available.

Steering Wheel Controls

Use the steering wheel controls to control the system.

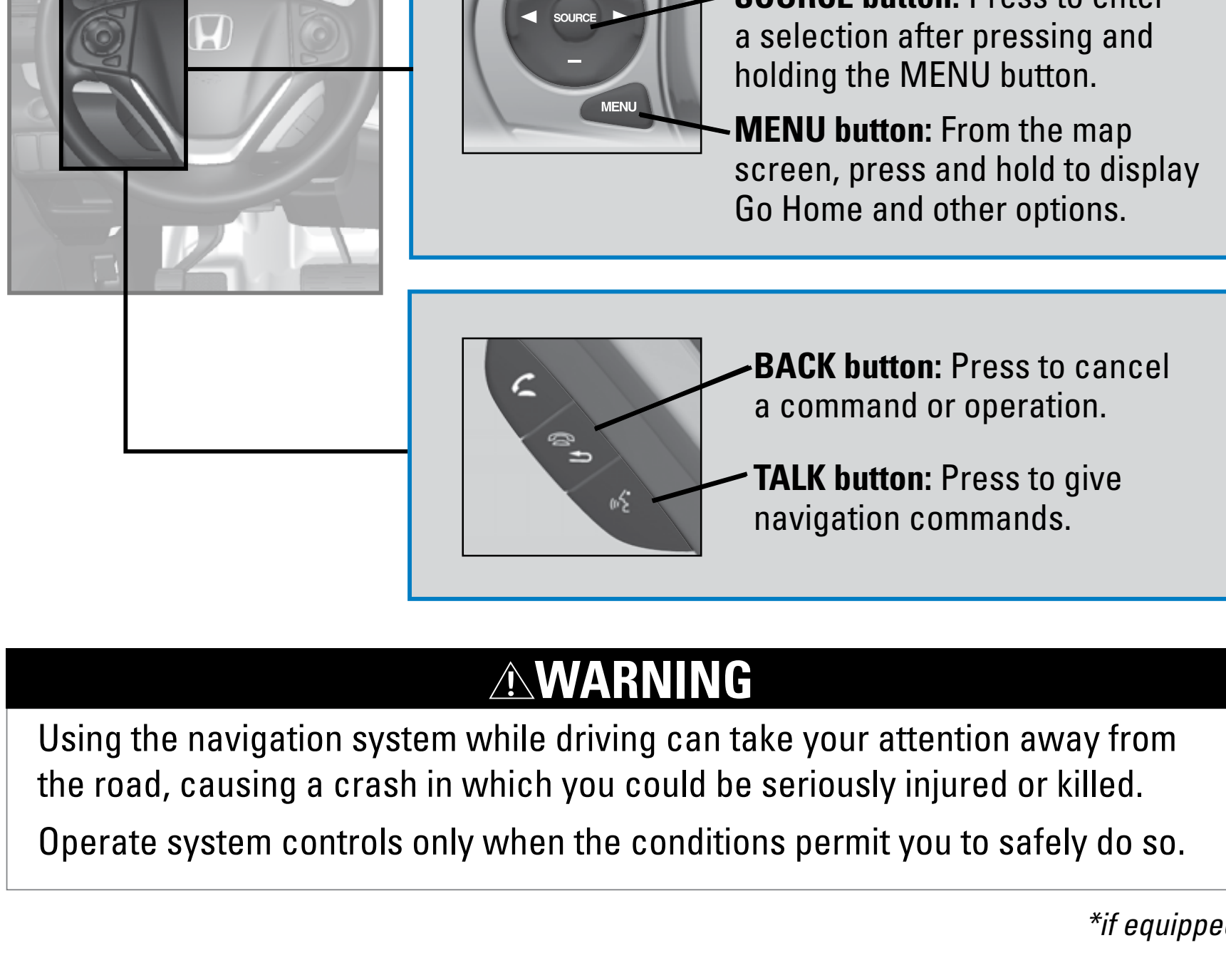

WARNING

Using the navigation system while driving can take your attention away from the road, causing a crash in which you could be seriously injured or killed.

Operate system controls only when the conditions permit you to safely do so.

*if equipped

Navigation Display and Controls

Use the touchscreen to enter information and make selections.

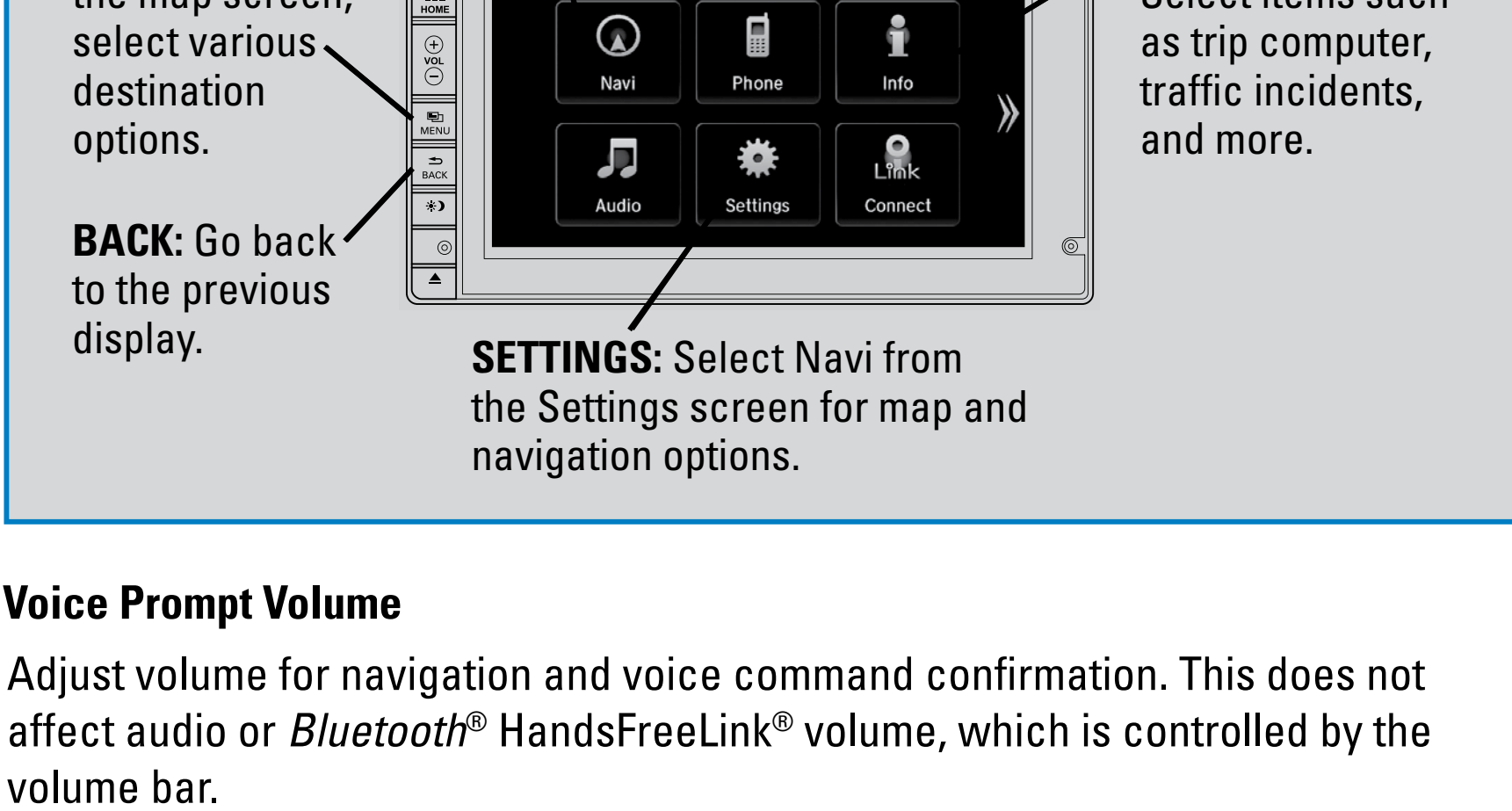
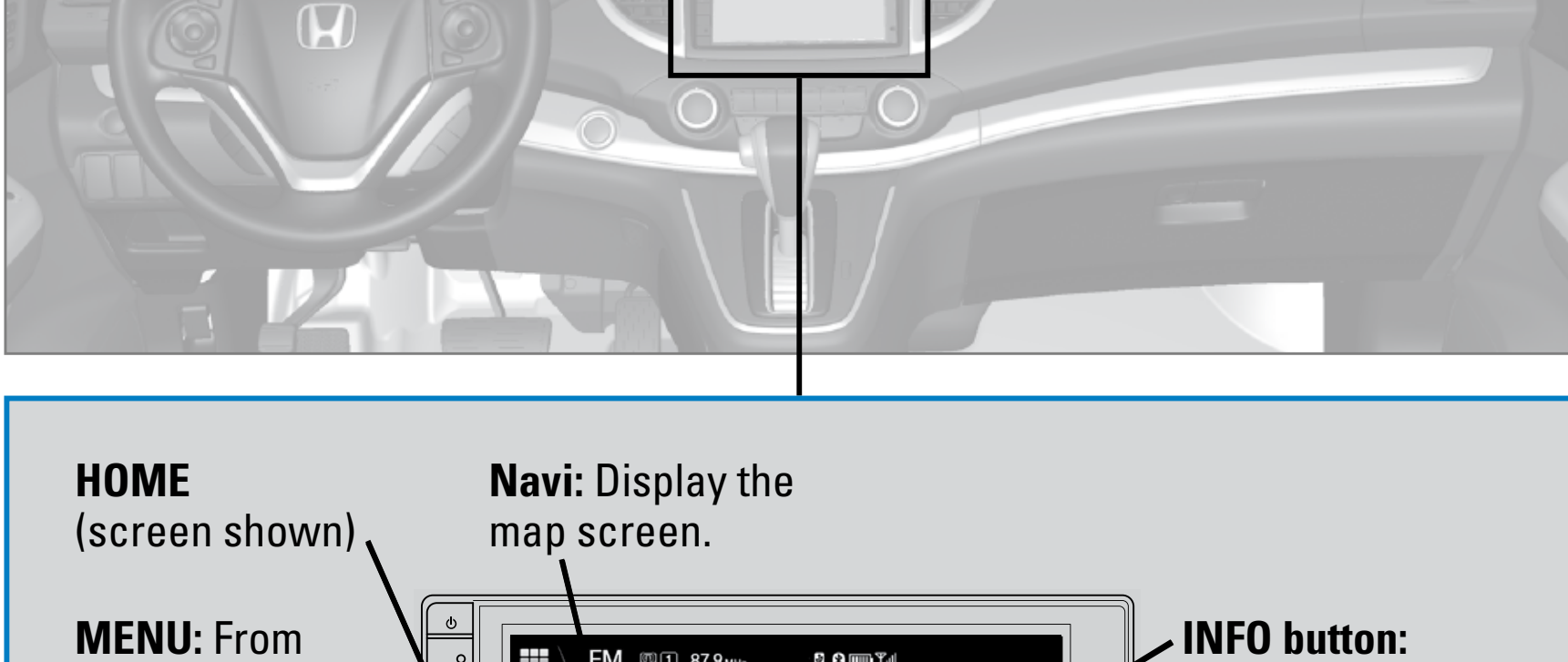

Voice Prompt Volume

Adjust volume for navigation and voice command confirmation. This does not affect audio or Bluetooth® HandsFreeLink® volume, which is controlled by the volume bar.

- From the Home Screen, select Settings.
- Select System.
- Select Volume.
- Adjust the level, or select off.

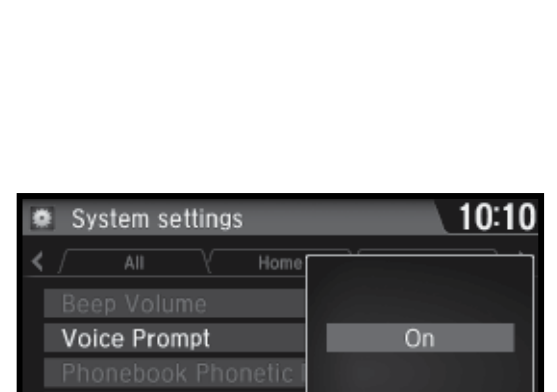

Voice Prompt

Turn the voice feedback feature on or off.

- From the Home screen, select Settings.
- Select System.
- Select Voice Prompt.
- Select On or Off.

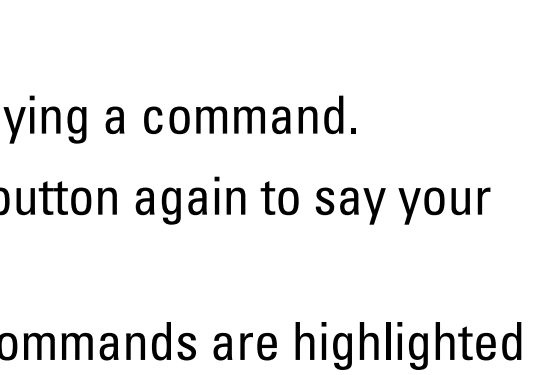

Voice Recognition Tips

- When using the Talk button, wait for a beep before saying a command.
- To bypass the system prompts, simply press the Talk button again to say your command.
- When the Talk button is pressed, all available voice commands are highlighted in yellow.
- Speak in a clear, natural voice.
- Reduce all background noise.
- Adjust the dashboard and side vents away from the microphone in the ceiling.
- Close the windows and moonroof.

Entering a Destination

Use multiple methods to enter a destination.

Home Address

Store your home address in the system so you can easily route to it.

- From the Home screen, select Settings.
- Select Navigation.
- Select Edit Go Home (1 or 2).
- Enter the address, and select OK when complete.

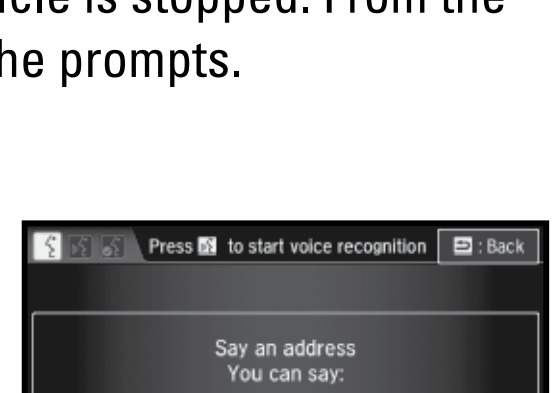

When your home address is stored, you can press the Talk button and say "Go home" at any time. You can also select Go home from the navigation menu.

Street Address

Enter a street address using voice commands. Press the Talk button before saying each command.

You can also enter the address manually when the vehicle is stopped. From the map screen, press MENU and select Address. Follow the prompts.

U.S. models

- From the Voice Portal screen, say "Address."
- The system prompts you to say the entire address. For example, say "1-2-3-4 Main Street, Los Angeles, California."
- The system interprets the address by state, city, street, and address number. If necessary, you may have to clarify similar matches.
- Say "Set as destination" to set the route.

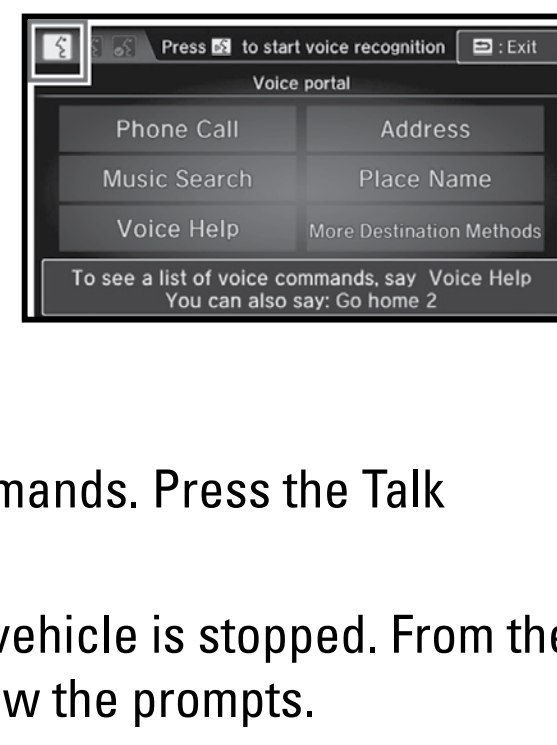

Canadian models

- From the Voice Portal screen, say "Address."
- Follow the prompts.

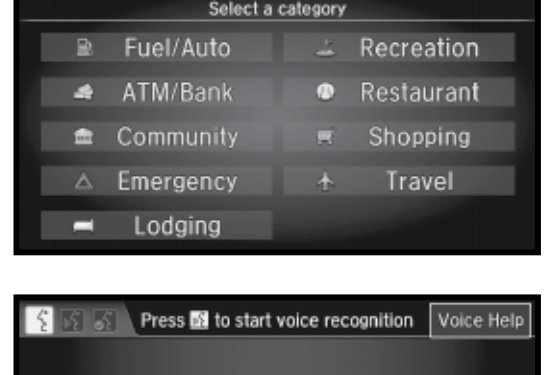

Place Category

Enter a destination or point of interest using voice commands. Press the Talk button before saying each command.

You can also enter the place name manually when the vehicle is stopped. From the map screen, press MENU and select Place Name. Follow the prompts.

- From the Voice Portal screen, say "Place name."
- Say a category, for example "ATM/Bank."
- Say the name of the place, for example "ABC Bank."
- The system interprets the name. If necessary, you may have to clarify similar matches.
- Say "Set as destination" to set the route.



Find Nearest Place

Enter a destination by category and distance using voice commands. Press the Talk button before saying each command.

- Say "Find nearest" and a place. For example, "Find nearest ATM."
- A list of the nearest places in your area is displayed by shortest distance to destination.
- Say the number next to the destination you want to select.
- Say "Set as destination" to set the route.

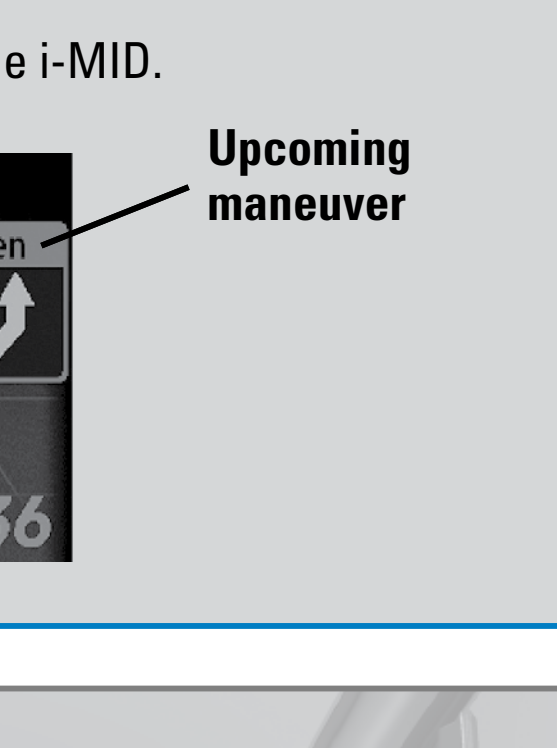

Routing

After a destination is set, you can alter or cancel your route.

Map Legend

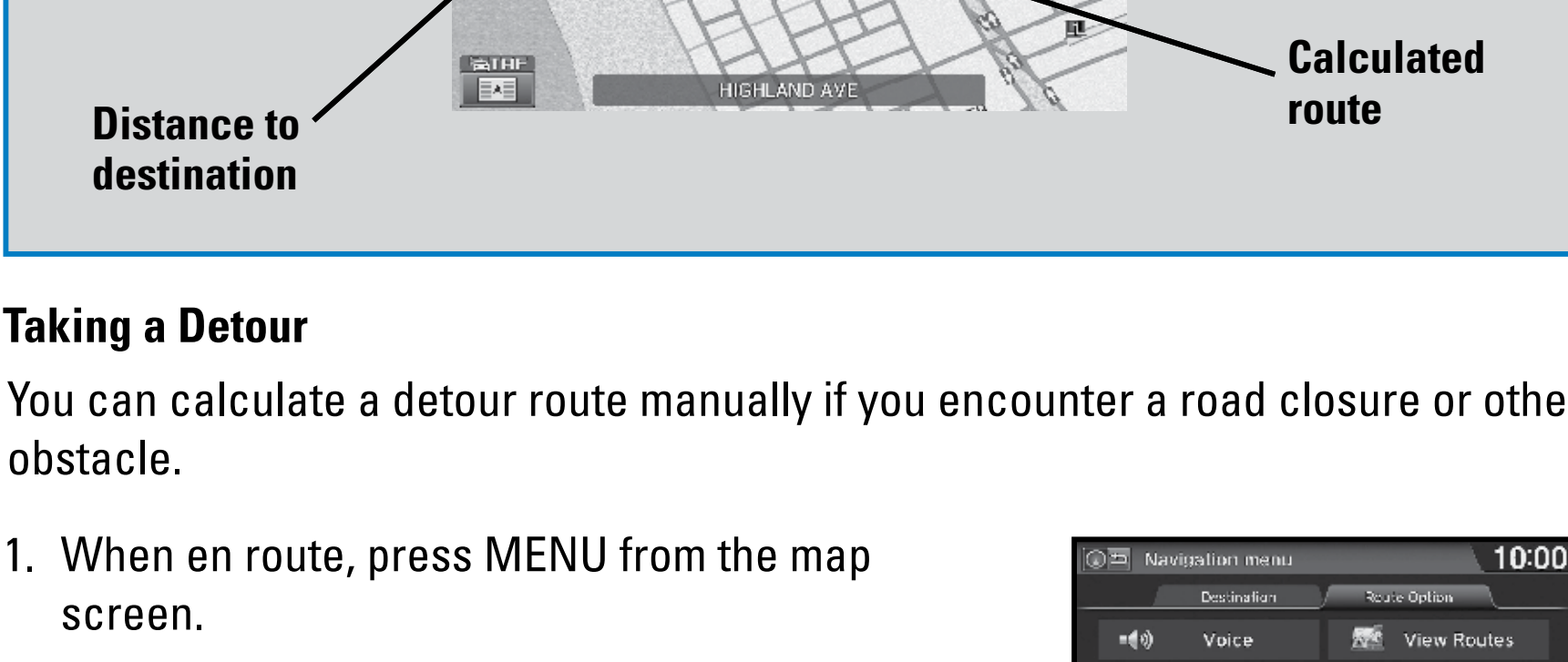
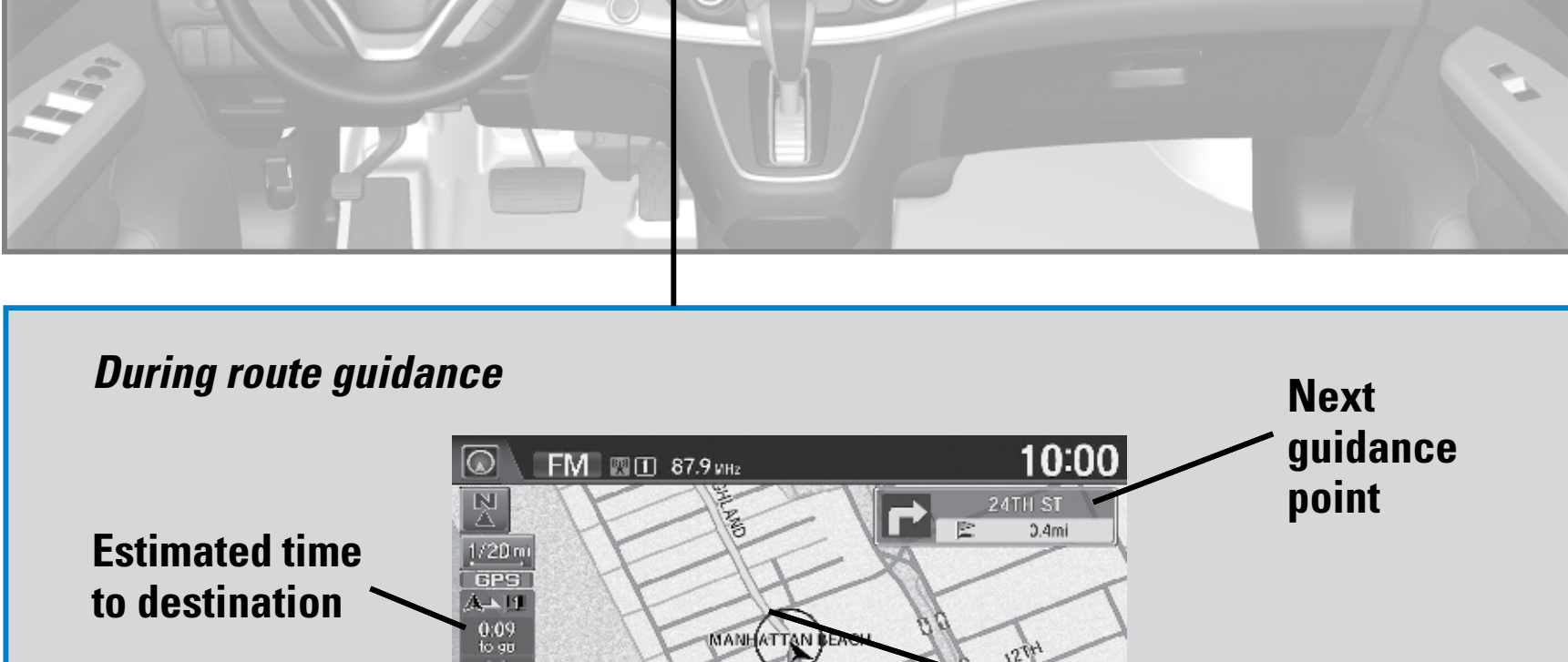

Taking a Detour

You can calculate a detour route manually if you encounter a road closure or other obstacle.

- When en route, press MENU from the map screen.
- Select Detour. The system attempts to calculate a new route by avoiding the next 5 miles (8 km) while on a freeway or 1 mile (1 km) while on a surface street.



Traffic

View traffic flow, incidents, and construction in major metro areas. You can also route around congestion or incidents using voice commands. Press the Talk button before saying each command. **Available on U.S. models only.**

- When en route, say "Display traffic incidents." A list of incidents on your route appears.
- Say the number of the incident you want to avoid.
- Say "Avoid" and the incident list returns.
- Say "Recalculate route" to set the new route.

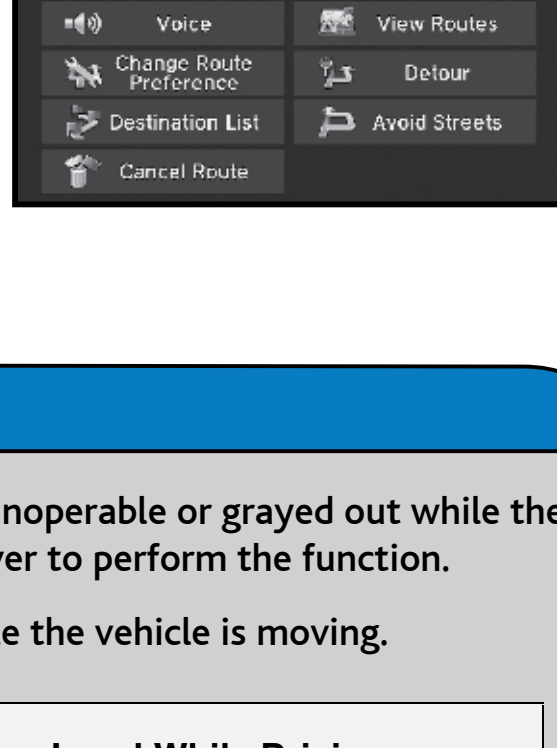

Canceling Your Route

You can cancel your route at any time.

- When en route, press MENU from the map screen.
- Select Cancel Route. The route is cleared and the map screen returns. You can also press the Talk button and say "Cancel route."

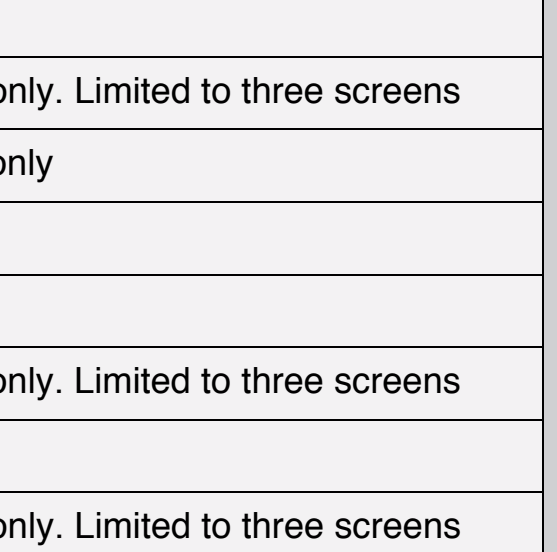

Driver Distraction

To reduce the potential for driver distraction, certain functions may be inoperable or grayed out while the vehicle is moving. You may have to use voice commands, stop or pull over to perform the function.

The chart below shows a list of some operations that are restricted while the vehicle is moving.

| Function | Restriction Level While Driving |
|------------------------------|----------------------------------------------|
| Navigation System | |
| Address | Voice command only |
| Place category | Not restricted |
| Place category scroll | Voice command only. Limited to three screens |
| Place name | Voice command only |
| Go home | Not restricted |
| Previous destination | Not restricted |
| Previous destination scroll | Voice command only. Limited to three screens |
| Address book | Not restricted |
| Address book scroll | Voice command only. Limited to three screens |
| Place phone number | Voice command only |
| Coordinate | Voice command only |
| Intersection | Voice command only |
| Map scroll | Limited use |
| Map point set as destination | Restricted |
| Destination list edit | Restricted |
| Route avoid street | Restricted |
| Route add waypoint | Restricted |