

AUDIO AND CONNECTIVITY

Learn how to operate the vehicle's audio system.

Basic Audio Operation

Connect audio devices and operate buttons and displays for the audio system.

■ USB Port

1. Open the cover in the front console.
2. Connect a USB flash drive or iPod/iPhone® cable connector to the USB port.

On models with a touchscreen, connect a compatible iPhone for Apple CarPlay.

An additional USB port* is located in the center console.

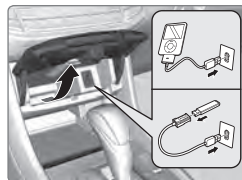

iPod and iPhone are trademarks of Apple, Inc.

■ Auxiliary Input Jack*

Connect standard audio devices with a 1/8-inch (3.5 mm) stereo miniplug.

1. Open the AUX cover on the audio panel.
2. Insert the miniplug attached to the audio device into the jack. The audio system switches to AUX mode. Use the device to control the audio.



State or local laws may prohibit the operation of handheld electronic devices while operating a vehicle.

■ Accessory Power Socket

Open the socket cover in the front console to use power when the vehicle is on.

There is an additional power socket inside the center console.

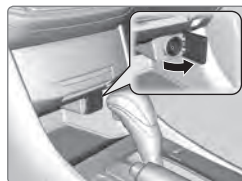

NOTICE

Do not insert an automotive type cigarette lighter element. This can overheat the power socket.

■ Wireless Charger*

Charge your compatible device when the vehicle is on.

1. Press and hold the POWER button. A green indicator appears when the charger is on.
2. Place the chargeable side of the device on the charge area. The system begins charging the device when the amber indicator appears.
3. The green indicator appears when charging is complete. On some devices, the amber indicator may stay on even when charging is complete.

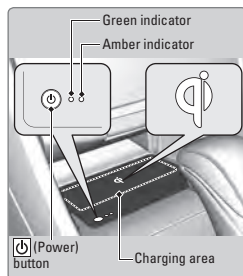

Notes:

- This system consumes a lot of power. It is best to charge your device when the engine is running.
- If the indicator light is blinking, there may be an obstacle between the device and charging area, the device may have moved, or the charger is malfunctioning.
- The device may not charge if you are near strong electromagnetic waves, such as at a gas station.
- The device and charging area may get warm during charging. This is normal.

⚠ CAUTION

Metal objects between the charge pad and the device to be charged will get hot and can burn you.

- Always remove foreign objects from the charge pad before charging the device.
- Be sure the surface is clear of dust and other debris before charging.
- Do not spill liquids (i.e. water, drinks, etc.) on the charger and the device.
- Do not use oil, grease, alcohol, benzine or thinner for cleaning the charge pad.
- Do not cover the system with towels, clothing, or other objects while charging.
- Avoid spraying aerosols which may contact the charge pad surface.

NOTICE

Do not place any magnetic devices, credit cards, or watches within the charge area while charging. The data on credit cards can be lost, and watches may stop working.

**if equipped*

■ Steering Wheel Controls

You can operate certain functions of the audio system using the steering wheel controls.

SOURCE button: Cycle through available audio modes.

◀/▶ buttons: Change presets, tracks, albums, or folders.

+ / - buttons: Adjust audio volume.

MENU button*: On vehicles with touchscreen, press to view options for the current audio source. Use the other buttons to navigate through the options.



FM/AM/SiriusXM® Radio*

Press ▶ or ◀ for the next or previous station.

Press and hold ▶ or ◀ for the next or previous strong station.

CD/iPod®/USB/Bluetooth® Audio

Press ▶ or ◀ for the next or previous track.

Press and hold ▶ or ◀ for the next or previous folder (CD/USB).

Pandora® (U.S. only)

Press ▶ for the next song.

Press and hold ▶ or ◀ for the next or previous station.

**if equipped*

■ Adjusting the Sound

Adjust various sound settings.

Using the **SETTINGS** button*

Use the selector knob to make and enter selections.

1. Press the **SETTINGS** button.
2. Select Audio Settings.
3. Select Sound.
4. Select a sound mode to change, and adjust it using the selector knob.
5. Press the **BACK** button to exit the menu.



Using the **touchscreen***

Touch items on the screen to make and enter selections.

1. From the **HOME** screen, select Audio.
2. Select Menu.
3. Select Sound.
4. Select the tabs to change the sound mode and adjust the setting.
5. Select **OK** when complete.

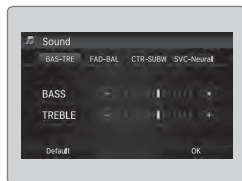

Models with one display

FM/AM Radio

Play FM or AM radio stations.

FM/AM button:
Select a band.

Preset buttons (1-6): Press and hold a preset button to store the current station. Press a preset button to select a previously stored station.

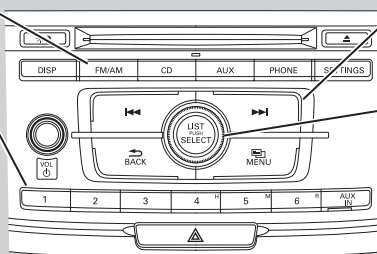

Seek/Skip buttons: Find the next or previous strong station.

Selector knob:
Rotate to tune radio frequency.

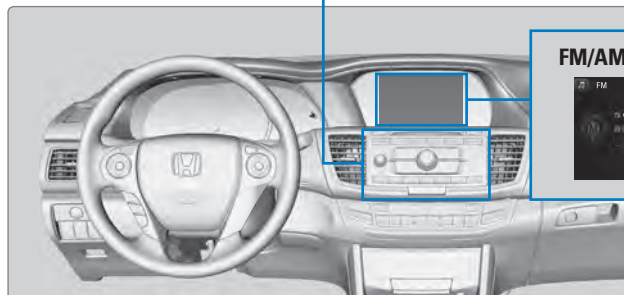

FM/AM radio display



Models with one display

Compact Disc (CD)

The audio system supports audio CDs, CD-Rs, and CD-RWs in MP3, WMA, or AAC formats.

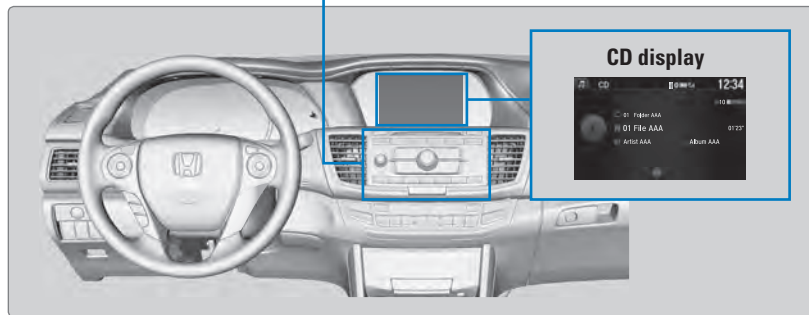
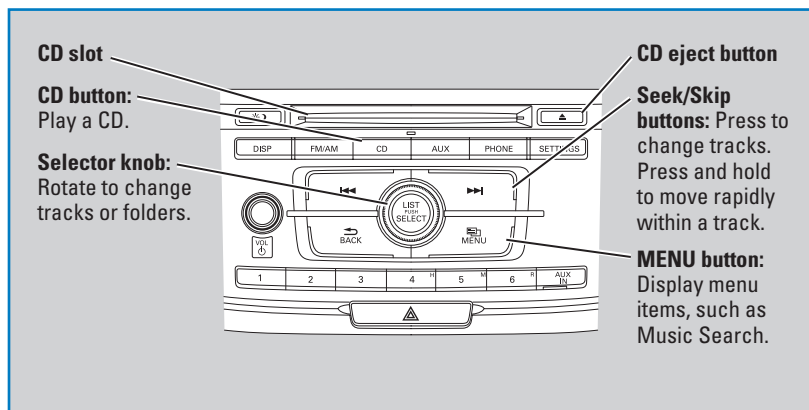

■ Searching for Music

Use the selector knob to search for tracks stored on the CD.

1. From the audio screen, press the MENU button.
2. Select Music Search.
3. Select the folder or track you want to play.



NOTICE

Do not use CDs with adhesive labels or insert a damaged CD. Inserting these types of CDs may cause them to get stuck or damage the audio unit.

Models with one display

iPod®

Play and operate an iPod through the vehicle's audio system. Connect your device to the USB port.

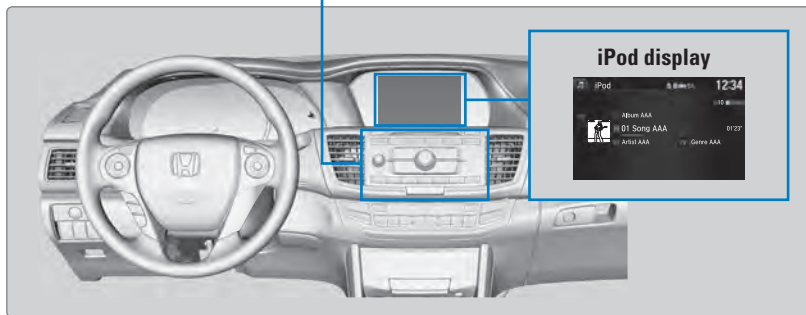
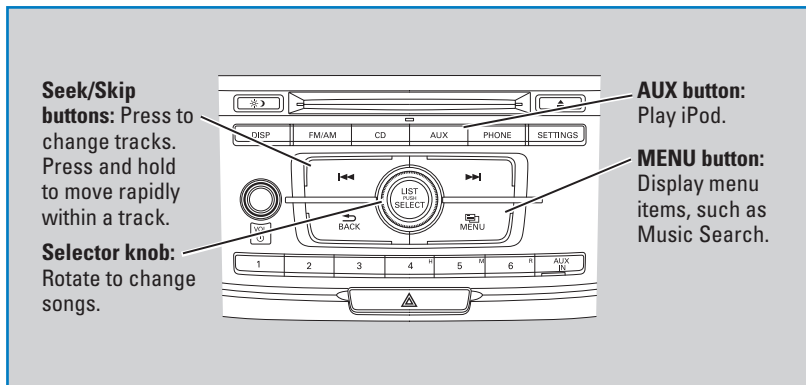

■ Searching for Music

Use the selector knob to search for tracks stored on the iPod.

1. From the audio screen, press the MENU button.
2. Select Music Search.
3. Select a search category.
4. Select the track you want to play.



iPod is a trademark of Apple, Inc.

Models with one display

USB Flash Drive

Play and operate a USB flash drive through the vehicle's audio system. Only MP3, WMA, or AAC formats are supported. Connect your device to the USB port.

Seek/Skip buttons: Press to change tracks. Press and hold to move rapidly within a track.

Selector knob: Rotate to change folders.

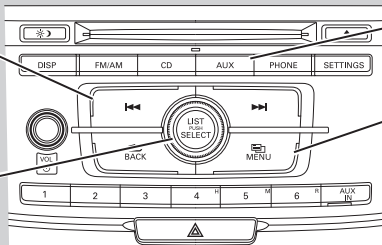

AUX button: Play a connected USB drive.

MENU button: Display menu items, such as Music Search.

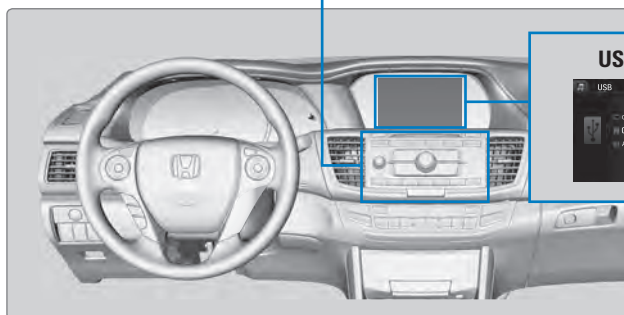

USB display



■ Searching for Music

Use the selector knob to search for tracks stored on the USB flash drive.

1. From the audio screen, press the MENU button.
2. Select Music Search.
3. Select a folder.
4. Select the track you want to play.



Models with one display

Bluetooth® Audio

Play streaming or stored audio from your compatible phone through the vehicle's audio system. Connect your phone to **Bluetooth HandsFreeLink**. Visit handsfreelink.com to check phone compatibility. Standard data rates apply.

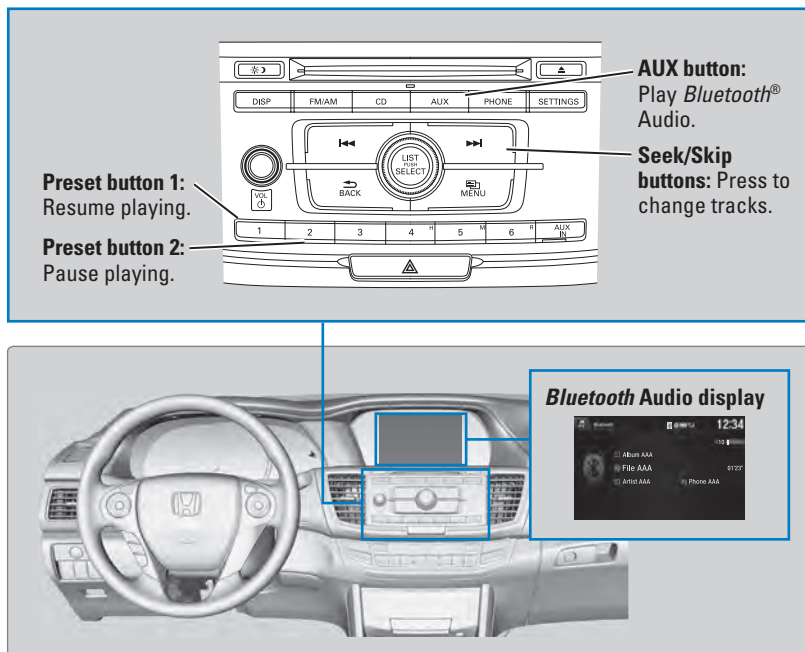

Notes:

- Make sure the volume on your phone is properly adjusted.
- You may need to enable additional settings on your phone for playback.
- The resume/pause function and remote audio controls are not supported on all phones.

State or local laws may prohibit the operation of handheld electronic devices while operating a vehicle. Only launch streaming audio on your phone when it is safe to do so.

Pandora®

Play and operate Pandora from your phone through the vehicle's audio system. Visit handsfreelink.com to check phone compatibility. Standard data rates apply.

Available in the U.S. only.

Connect your phone when the vehicle is stopped.

For iPhone:

- Connect via *Bluetooth* HandsFreeLink or USB port.
- A pop-up may appear on your phone requesting you to allow access for Pandora to be launched.
- If you cannot operate Pandora through the audio system, it may be streaming through *Bluetooth* Audio. Make sure Pandora is selected on the audio system.
- If Pandora still does not operate, try rebooting the phone and reconnecting the cable if necessary.

For Android or BlackBerry:

- Connect via *Bluetooth* HandsFreeLink.

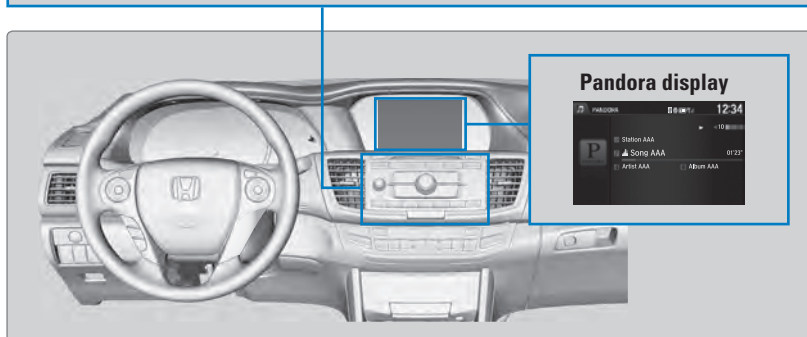
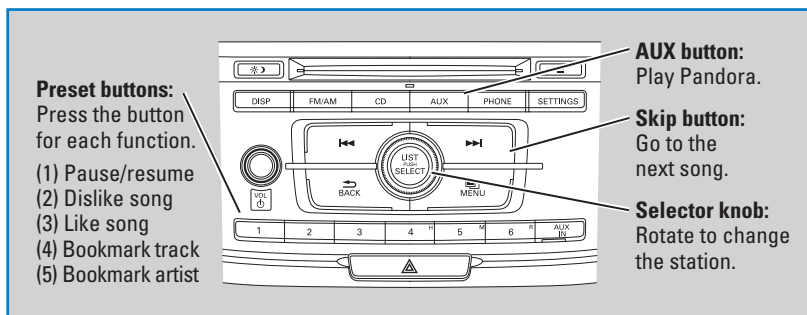

State or local laws may prohibit the operation of handheld electronic devices while operating a vehicle. Only launch streaming audio on your phone when it is safe to do so.