

Information Display*

Consists of several displays that provide you with useful information.

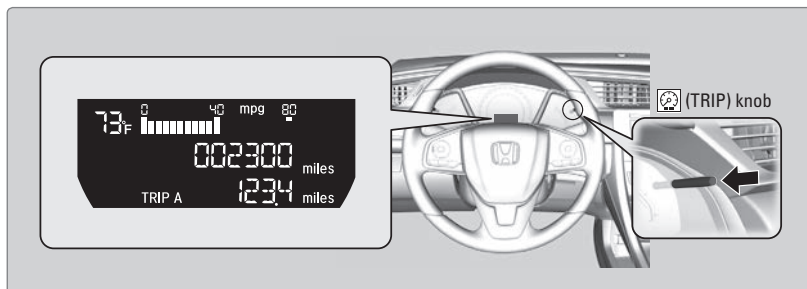

Press the TRIP knob to cycle through the displays shown below.

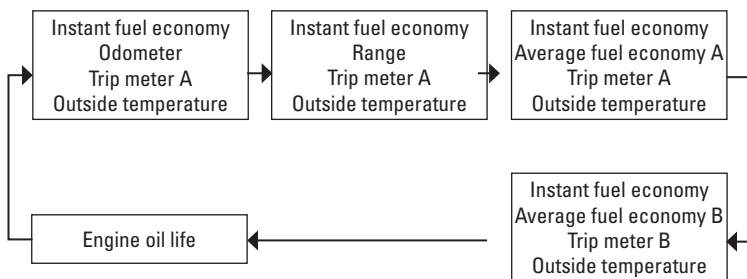

Driver Information Interface*

Consists of several displays that provide you with useful information.

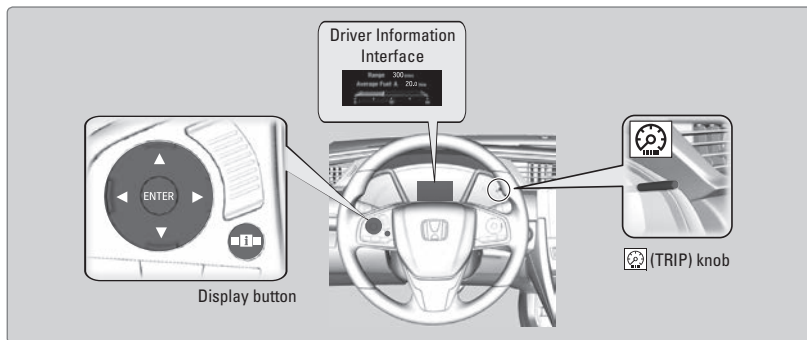

■ Main Displays

Press the Display button to scroll through the different icons shown below. Detailed information for the selected icon appears after a few seconds, or you can press the ENTER button to view it.

**if equipped*

You can customize the contents in the Driver Information Interface. For complete instructions, see the Owner's Manual at owners.honda.com.

Models without SPORT mode

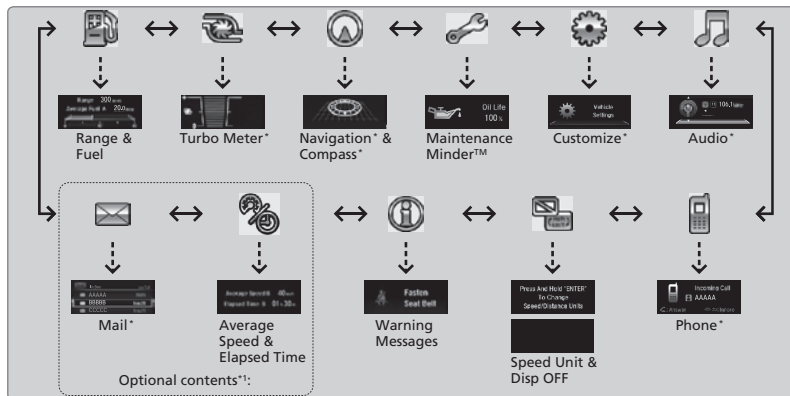

Models with SPORT mode

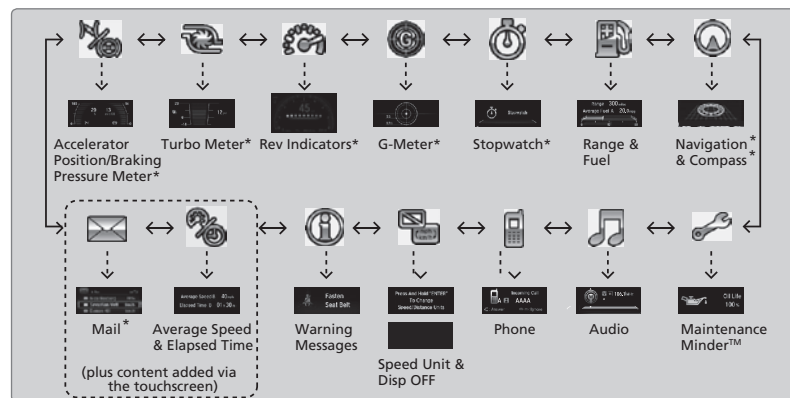

■ Trip Computer

Press the TRIP knob to cycle through the lower displays shown below.

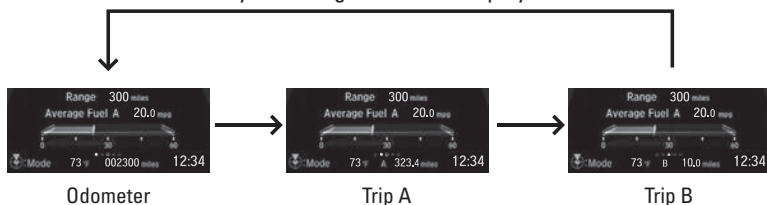

**if equipped*