

AUDIO AND CONNECTIVITY

Learn how to operate the vehicle's audio system.

Basic Audio Operation

Connect audio devices and operate buttons and displays for the audio system.

■ USB Port

1. Open either USB cover in the front console.
2. Connect a USB flash drive or iPod/iPhone cable connector to the USB port.

The USB port (1.5A) is for charging devices, playing audio files and connecting for Apple CarPlay or Android Auto to the 1.5A port.

The USB port (1.0A) is for playing audio files, connecting a phone and charging devices.

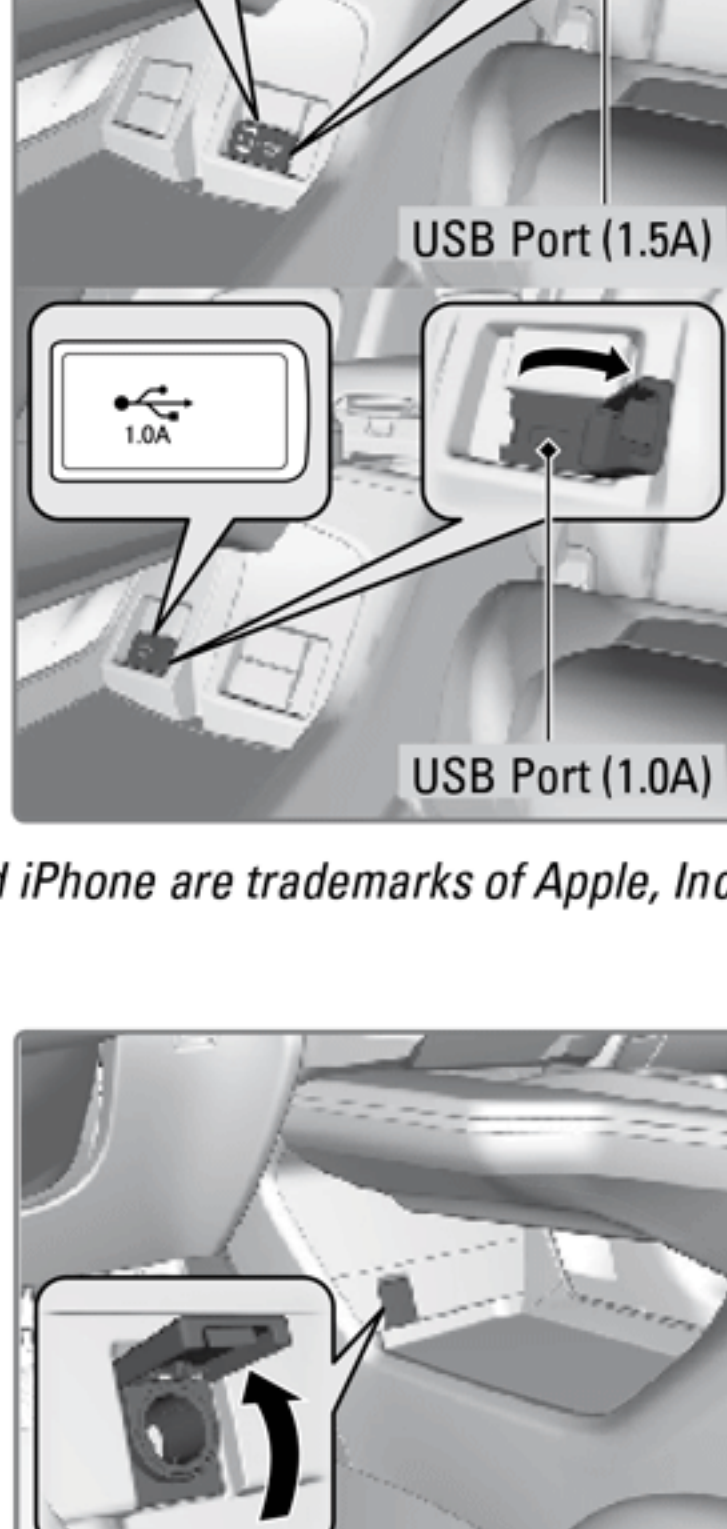

iPod and iPhone are trademarks of Apple, Inc.

■ Accessory Power Socket

Open the socket cover in the front console to use power when the power mode is on.

There is an additional power socket on the rear of the center console.

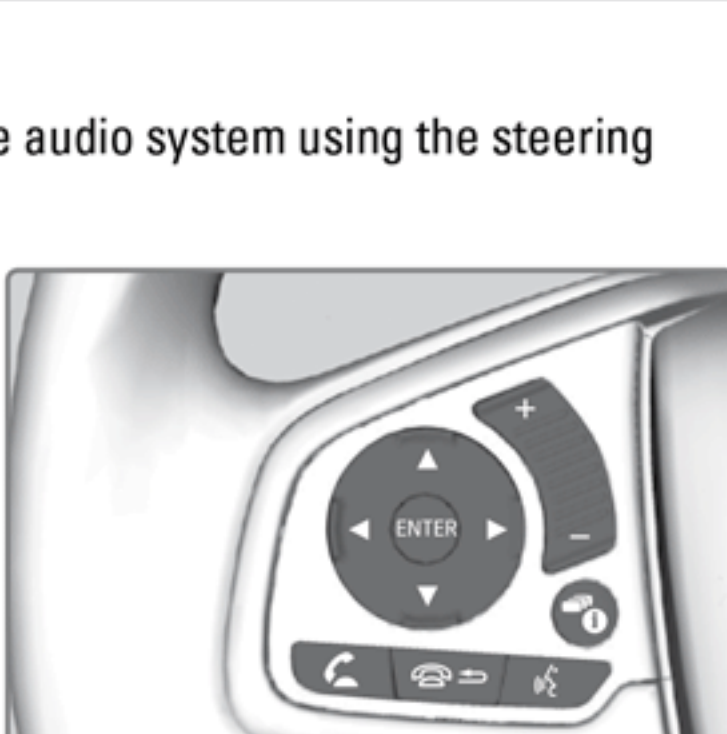

NOTICE

Do not insert an automotive type cigarette lighter element. This can overheat the power socket.

■ Audio Remote Controls

You can operate certain functions of the audio system using the steering wheel controls.

⏮ button: Press until the audio screen is displayed in the Driver Information Interface.

+ / - bar: Press the ends of the bar to adjust audio volume.

ENTER button: Make audio selections in the Driver Information Interface.

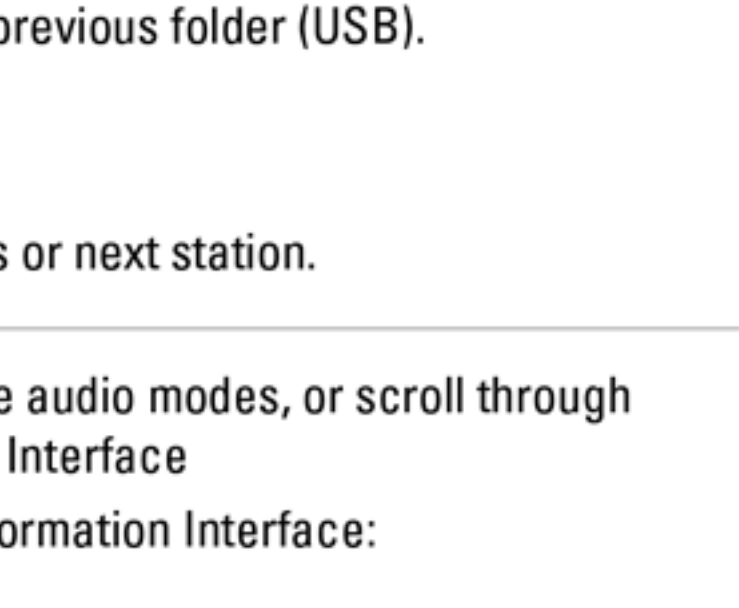

◀ / ▶ buttons: Change presets, tracks, albums, or folders.

From the audio screen in the Driver Information Interface:

FM/AM/SiriusXM Radio

Press **◀** or **▶** for the next or previous preset station.

Press and hold **◀** or **▶** to seek the next or previous strong station.

iPod/USB/Bluetooth Audio

Press **◀** or **▶** for the next or previous track.

Press and hold **◀** or **▶** for the next or previous folder (USB).

Pandora

Press **▶** for the next song.

Press and hold **◀** or **▶** for the previous or next station.

▲ / ▼ buttons: Cycle through available audio modes, or scroll through audio options in the Driver Information Interface

From the audio screen in the Driver Information Interface:

FM/AM/SiriusXM Radio

Press the **ENTER** button to display a preset list. Press **▲** or **▼** to scroll the list, and press the **ENTER** button to select a preset.

USB Flash Drive

Press the **ENTER** button to display the folder list. Press **▲** or **▼** to scroll the list, and press the **ENTER** button to select a folder. Repeat to select a track.

iPod

Press the **ENTER** button to display the iPod list. Press **▲** or **▼** to scroll the category, and press the **ENTER** button to select an item. Repeat to select a track.

Bluetooth Audio

Press the **ENTER** button to display the track list. Press **▲** or **▼** to scroll the list, and press the **ENTER** button to select a track.

Pandora

Press the **ENTER** button to display the station list. Press **▲** or **▼** to scroll the list, and press the **ENTER** button to select a station.

■ Adjusting the Sound

Adjust various sound settings.

Using the touchscreen

1. Touch items on the screen to make and enter selections.
2. From the HOME screen, select Audio.
3. Select Menu.
4. Select Sound.
5. Select the tabs to change the sound mode and adjust the setting.
6. Select OK when complete.



Touchscreen Operation

Use simple gestures—including touching, swiping, and scrolling—to operate certain audio functions.

Some items may be grayed out during driving to reduce the potential for distraction. You can select them when the vehicle is stopped or use voice commands.

Wearing gloves may limit or prevent touchscreen response.

You can use a microfiber cleaning cloth to remove dust or fingerprints from the touchscreen.

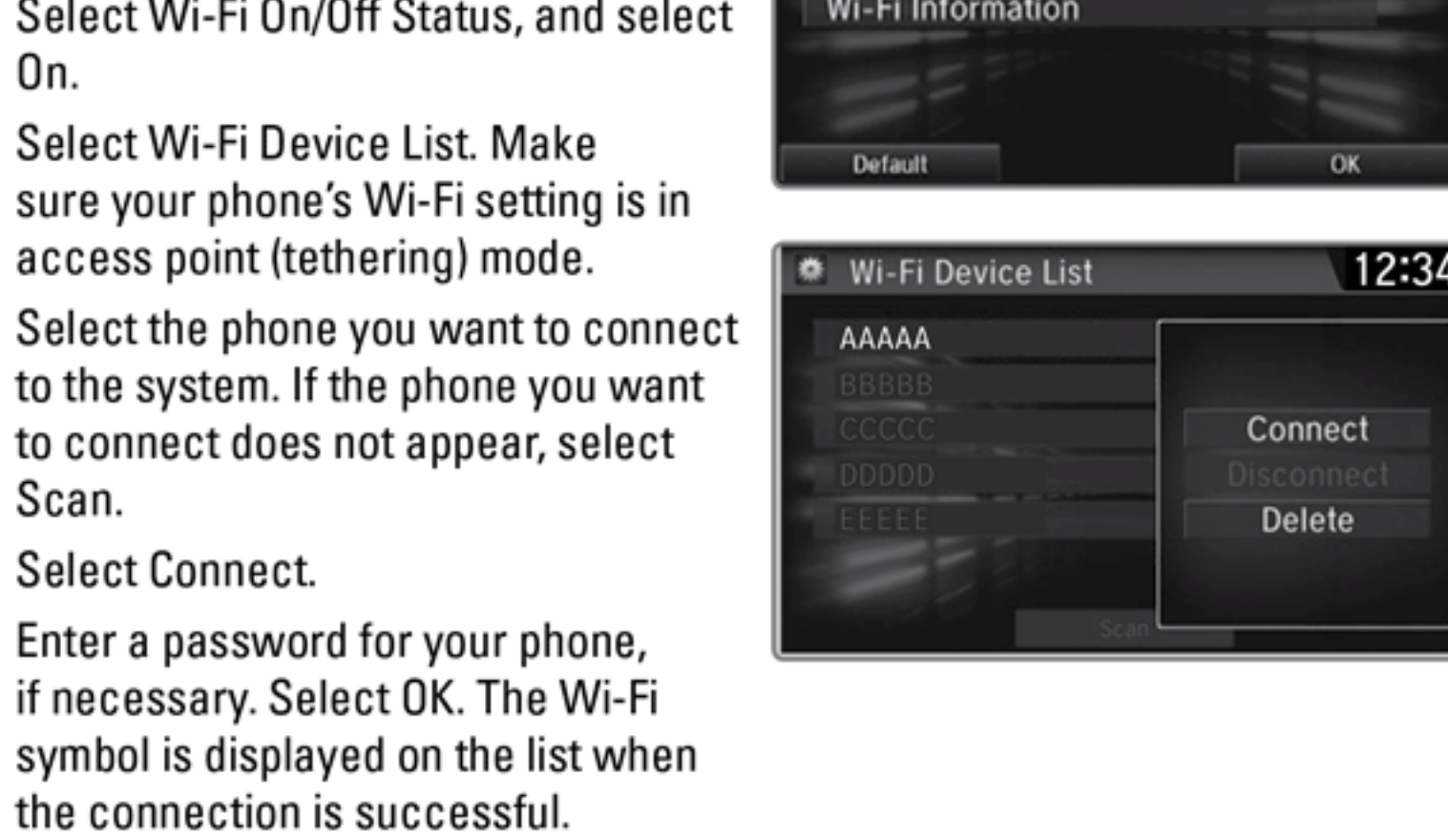

■ Setting Touchscreen Sensitivity

You can adjust the touchscreen's sensitivity to your fingertip.

1. From the HOME screen, select Settings, then System.
2. Select Display, then Touch Panel Sensitivity.
3. Make your selection.

Wi-Fi Connection

You can connect the audio system to the internet using Wi-Fi and use online services through the touchscreen. If your compatible phone has hotspot capabilities, the system can be tethered to the phone. Follow the steps below to set up Wi-Fi when the vehicle is stopped. Standard data rates apply with your phone service provider.

1. From the HOME screen, select Settings.
2. Select Bluetooth/Wi-Fi. Select the Wi-Fi tab.
3. Select Wi-Fi On/Off Status, and select On.
4. Select Wi-Fi Device List. Make sure your phone's Wi-Fi setting is in access point (tethering) mode.
5. Select the phone you want to connect to the system. If the phone you want to connect does not appear, select Scan.
6. Select Connect.
7. Enter a password for your phone, if necessary. Select OK. The Wi-Fi symbol is displayed on the list when the connection is successful.

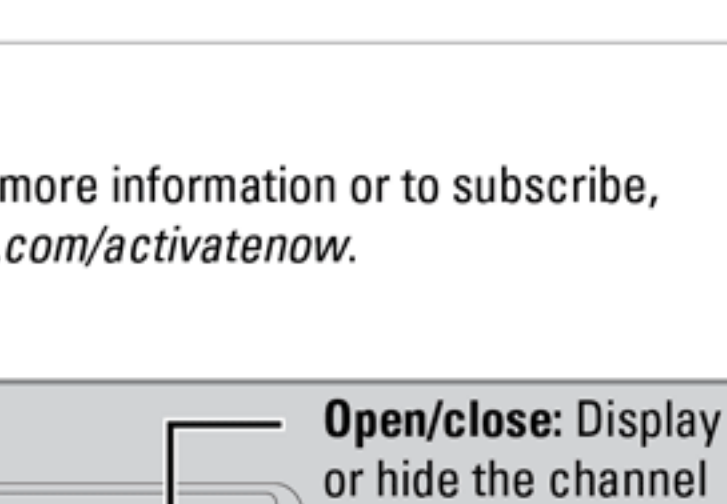

FM/AM Radio

Play FM or AM radio stations.

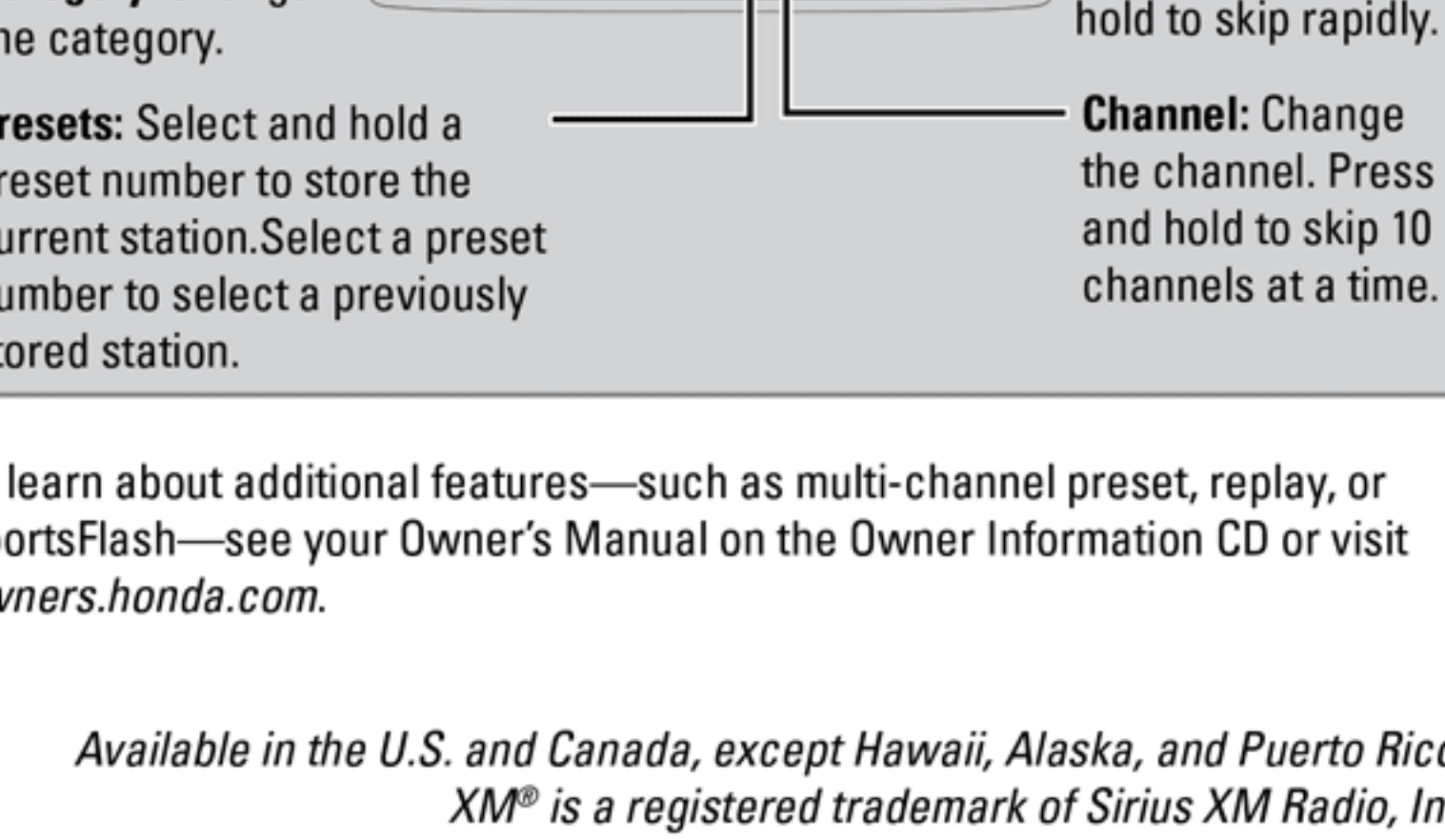

SiriusXM® Radio

Available on a subscription basis only. For more information or to subscribe, contact your dealer, or visit www.siriusxm.com/activatenow.

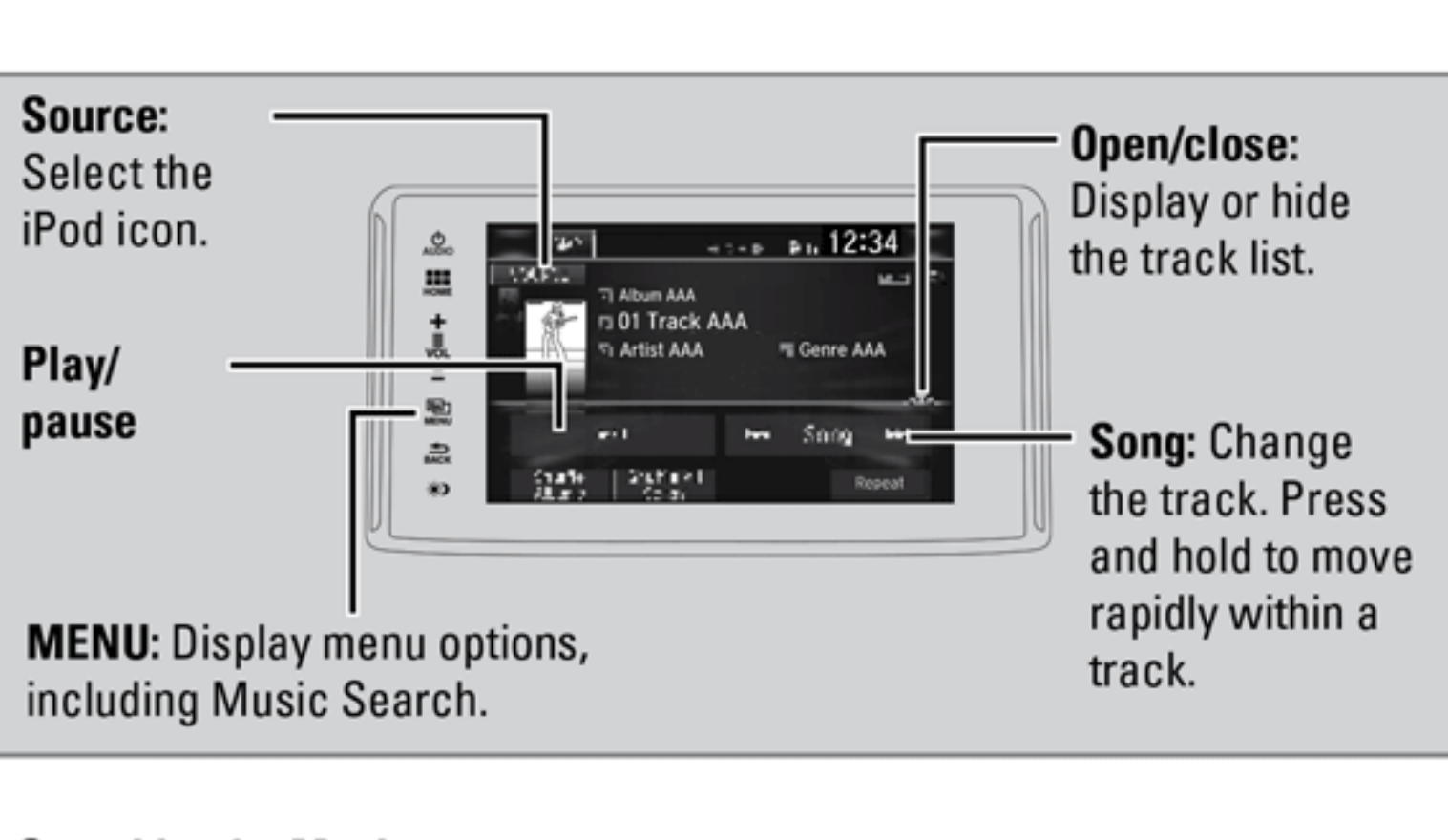

To learn about additional features—such as multi-channel preset, replay, or SportsFlash—see your Owner's Manual on the Owner Information CD or visit owners.honda.com.

Available in the U.S. and Canada, except Hawaii, Alaska, and Puerto Rico. XM® is a registered trademark of Sirius XM Radio, Inc.

iPod®

Play and operate an iPod through the vehicle's audio system. Connect your device to the USB port.

If an iPhone is connected via Apple CarPlay, the iPod source is unavailable and audio files on the phone can only be played within Apple CarPlay.

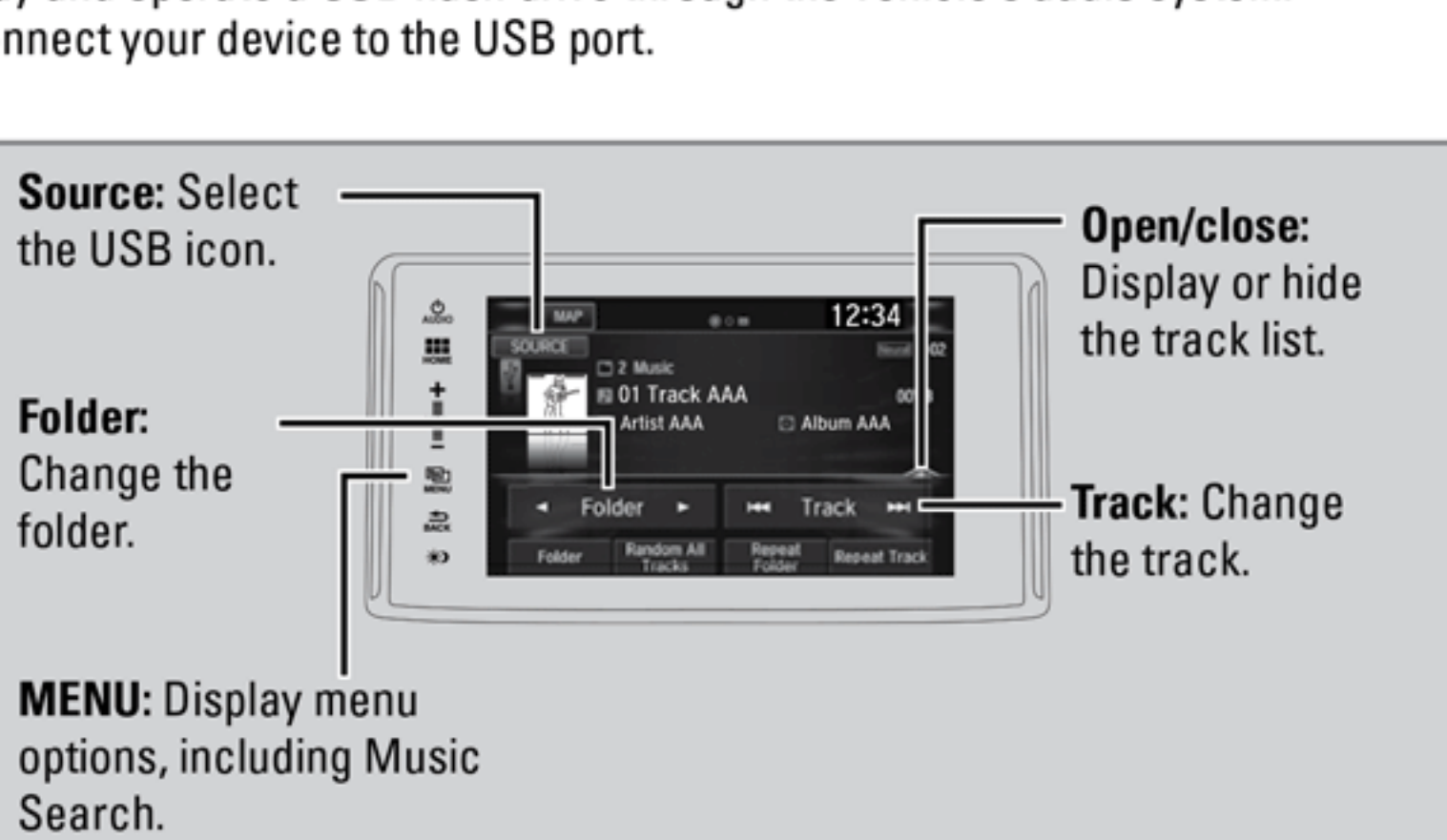

■ Searching for Music

Use the touchscreen to search for tracks stored on the iPod.

1. From the audio screen, press MENU.
2. Select Music Search.
3. Select a search option.
4. Select the track you want to play.

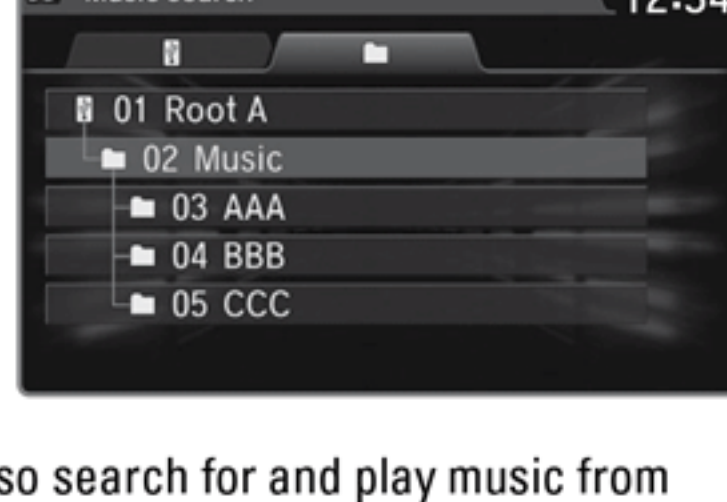

iPod is a trademark of Apple, Inc.

USB Flash Drive

Play and operate a USB flash drive through the vehicle's audio system. Connect your device to the USB port.

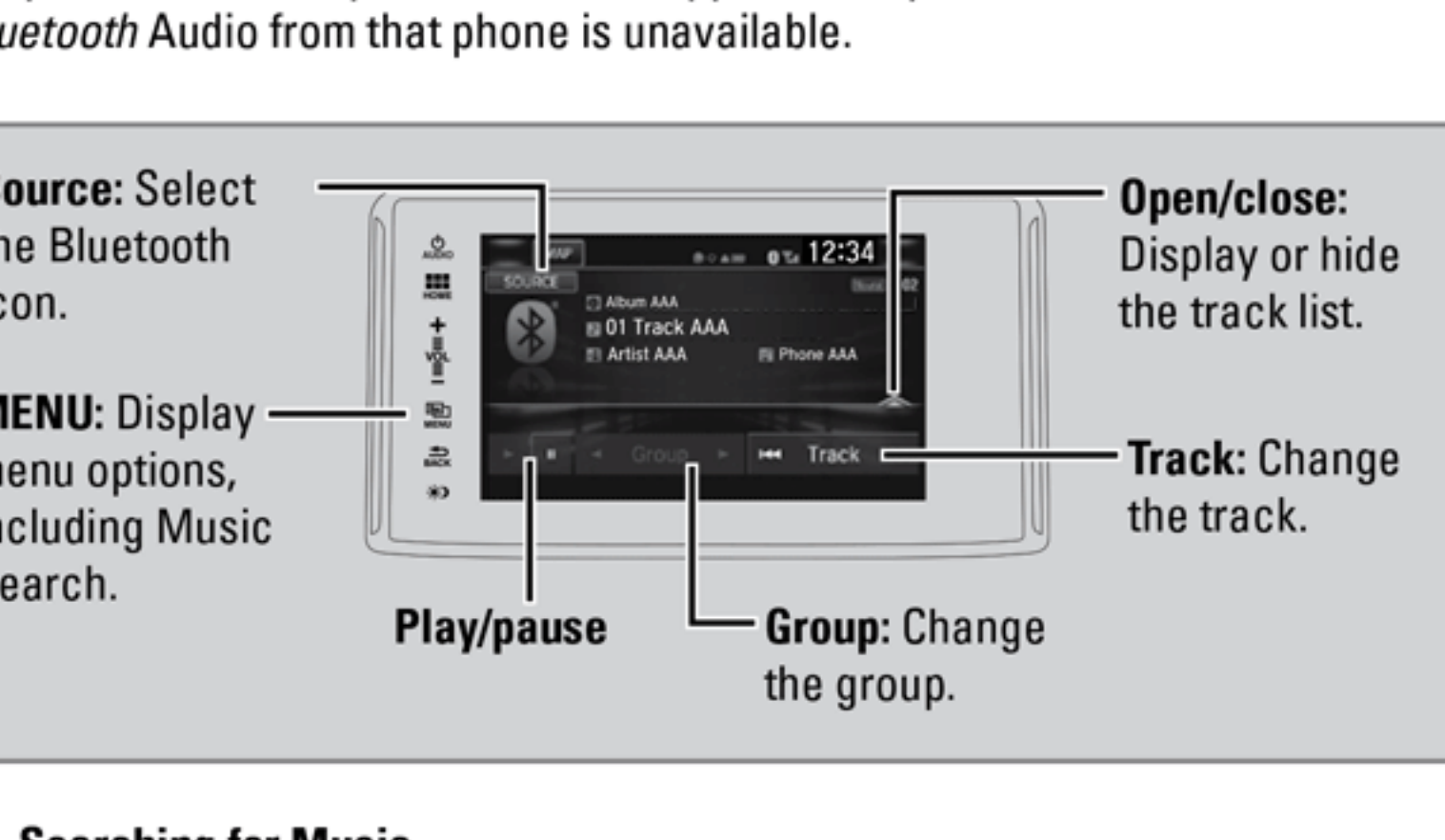

■ Searching for Music

Use the touchscreen to search for tracks stored on the USB flash drive.

1. From the audio screen, press MENU.
2. Select Music Search.
3. Select a search category.
4. Select the track you want to play.

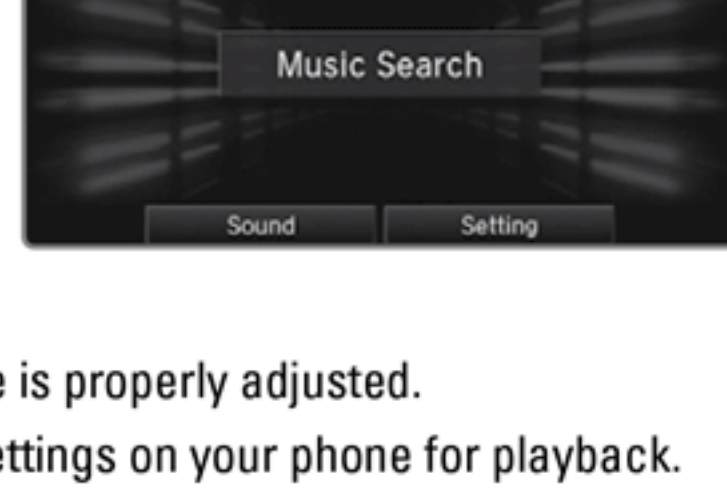

Notes:

- Make sure the volume on your phone is properly adjusted.
- You may need to enable additional settings on your phone for playback.
- Certain audio controls are not supported on all phones.

Applicable laws may prohibit the operation of handheld electronic devices while operating a vehicle. Launch streaming audio on your phone only when it is safe to do so.