

## HDMI Video

Play video from a compatible device while your vehicle is stopped.

### Models with touchscreen

Connect your device to the HDMI port.

From the connected device, launch the video you want to display on the touchscreen. The device or video resolution must be 720p or lower to view. This feature is limited while the vehicle is moving.



**Source:** Select the HDMI icon from the SOURCE screen.



## ■ HDMI Port\*

1. Open the HDMI cover under the front console.
2. Insert an HDMI cable to the HDMI port.

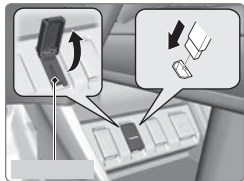

*Additional cables and connectors sold separately.*

*\*if equipped*