

## Collision Mitigation Braking System™ (CMBS™)

Can assist you when there is a possibility of your vehicle colliding with a vehicle or a pedestrian detected in front of yours.

The system can give you visual and audible alerts when a potential collision is determined and reduce your vehicle speed to help minimize collision severity when a collision is deemed unavoidable.

When a potential collision with a detected oncoming vehicle is determined, a BRAKE message appears in the driver information interface, the head-up warning lights flash, and a beep sounds.

The system activates when:

- The speed difference between your vehicle and a vehicle or pedestrian detected in front of you is about 3 mph (5 km/h) and over with a chance of a collision.
- Your vehicle speed is about 62 mph (100 km/h) or less and there is a chance of a collision with an oncoming detected vehicle or a pedestrian in front of you.

### Alert Stages

The system has three alert stages for a possible collision. Depending on the circumstances or CMBS settings, CMBS may not go through all of the stages before initiating the last stage.

**Stage 1:** Visual and audible warning

**Stage 2:** Visual and audible warning, light brake application

**Stage 3:** Visual and audible warning, strong brake application

### Turning CMBS On or Off

Press the safety support switch and roll the left selector wheel to the CMBS symbol and select it. A message appears in the driver information interface. The CMBS indicator appears when the system is off.

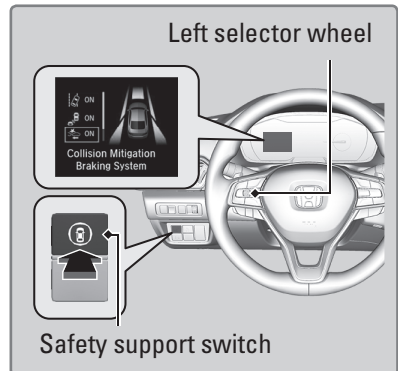
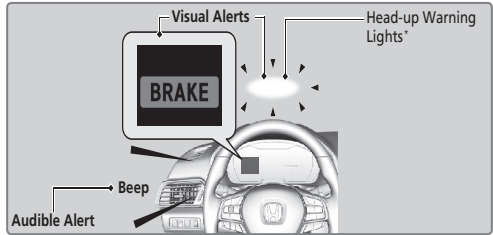

*\*if equipped*

## ■ Changing Settings

Determine the warning timing. The vehicle must be in Park (P).

### Models with Color Audio

1. Press the **MENU/CLOCK** button, select **Settings**.
2. Select **Vehicle Settings**.
3. Select **Driver Assist System Setup**.
4. Select **Forward Collision Warning Distance**.
5. Select **Normal, Short, or Long**.

### Models with Display Audio

1. Press the **HOME** button, select **Settings**.
2. Select **Vehicle**.
3. Select **Driver Assist System Setup**.
4. Select **Forward Collision Warning Distance**.
5. Select **Normal, Short, or Long**.

## Important Safety Reminder

The CMBS™ is designed to reduce the severity of an unavoidable collision. It does not prevent a collision nor stop the vehicle automatically. It is still your responsibility to operate the brake pedal and steering wheel appropriately according to the driving conditions.

## Honda Sensing™

Honda Sensing is a driver support system which employs the use of two distinctly different kinds of sensors, a radar sensor located at the lower part of the front bumper and a front sensor camera mounted to the interior side of the windshield, behind the rearview mirror.

- Do not change the position of the radar sensor or any of the surrounding parts.
- Do not apply paint, stickers, or attach nongenuine accessories to the front part of the radar sensor or the surrounding area.
- Be particularly careful that any custom license plate frame or other accessory does not block any part of the radar beam path (see illustration below).

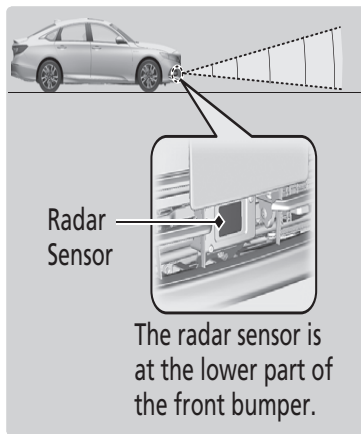
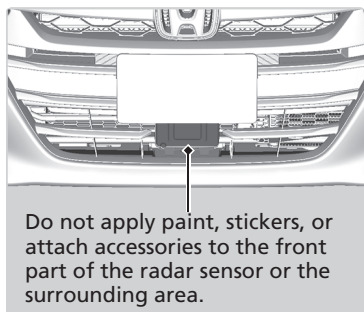

Honda Sensing™ has following functions:

**Adaptive Cruise Control (ACC) with Low Speed Follow (LSF):** Helps maintain a constant vehicle speed and a set following interval behind a vehicle detected ahead of yours and, if the detected vehicle comes to a stop, can decelerate and stop your vehicle.

**Lane Keeping Assist System (LKAS):** Provides steering input to help keep the vehicle in the middle of a detected lane and provides tactile and visual alerts if the vehicle is detected drifting out of its lane.

**Traffic Sign Recognition System:** Reminds you of road sign information, such as the current speed limit and that overtaking is prohibited.

**Road Departure Mitigation (RDM) System:** Alerts and helps to assist you when the system detects a possibility of your vehicle unintentionally crossing over detected lane markings and/or leaving the roadway altogether.

**Collision Mitigation Braking System™ (CMBS™):** Can assist you when there is a possibility of your vehicle colliding with a vehicle or a pedestrian detected in front of yours.