

■ Electric Parking Brake Switch

To apply: The electric parking brake can be applied any time the vehicle has battery, no matter which position the power mode is in. Pull the electric parking brake switch up gently and securely.

Pull the electric parking brake switch up gently and securely.

- The indicator in the switch comes on.
- The parking brake indicator (red) comes on.



To release: The power mode must be in ON in order to release the electric parking brake.

1. Depress the brake pedal.
2. Press the electric parking brake switch.
 - The indicator in the switch goes off.
 - The parking brake indicator (red) goes off.

Manually releasing the parking brake using the switch helps your vehicle start slowly and smoothly when facing down hill on steep hills.

The parking brake cannot be released automatically while the following indicators are on:

- Malfunction indicator lamp
- Transmission indicator

You cannot apply or release the parking brake if the 12-volt battery goes dead.

NOTICE

In cold climates, the parking brake may freeze in place if applied.

NOTICE

Release the parking brake fully before driving. The rear brakes and axle can be damaged if you drive with the parking brake applied.

■ Automatic Brake Hold

Keeps the brake applied after releasing the brake pedal until the accelerator pedal is pressed. You can use this system while the vehicle is temporarily stopped, like at traffic lights and in heavy traffic.

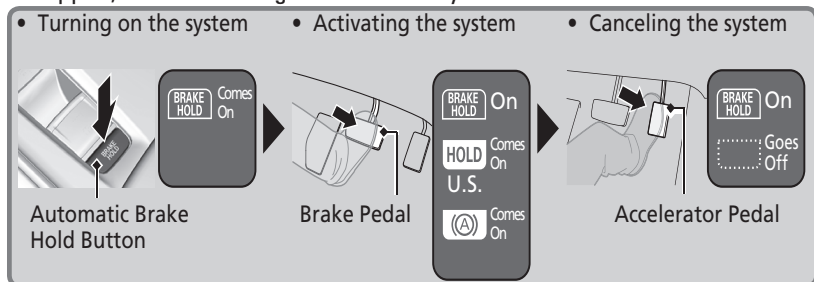

1. Fasten your seat belt properly, then start the power system. Press the automatic brake hold button. The automatic brake hold system indicator comes on. The system is turned on.
2. With the transmission in Drive (D) or Neutral (N), press the brake pedal and come to a complete stop. The HOLD indicator appears, and brake hold is applied. Release the brake pedal.
3. Press the BRAKE HOLD button behind the gear selector. The BRAKE HOLD indicator appears in the instrument panel.

Press the accelerator pedal to cancel brake hold and start moving.

To turn off brake hold: Press the brake pedal and press the BRAKE HOLD button again.

Automatic brake hold cancels when:

- Braking is applied for more than 10 minutes.
- The electric parking brake is engaged.
- The foot brake is pressed and the transmission is put in Park or Reverse.
- The driver's seat belt is unfastened.
- The engine stalls or is turned off.
- There is a problem with the automatic brake hold system.

⚠ WARNING

Activating the automatic brake hold system on steep hills or slippery roads may still allow the vehicle to move if you remove your foot from the brake pedal. Using the automatic brake hold system to park the vehicle may result in the vehicle unexpectedly moving. If a vehicle unexpectedly moves, it may cause a crash resulting in serious injury or death. Never leave the vehicle when braking is temporarily kept by automatic brake hold and always park the vehicle by putting the transmission in Park (P) and applying the parking brake.