

Wiper Operation

The windshield wipers and washers can be used when the power mode is in ON.

■ MIST

The wipers run at a high speed until you release the lever.

■ Wiper Switch (OFF, INT*¹/AUTO*², LO, HI)

Move the lever up or down to change the wiper settings.

■ Washer

Sprays while you pull the lever toward you. When you release the lever for more than one second, the spray stops, the wipers sweep two or three more times to clear the windshield, then stop.

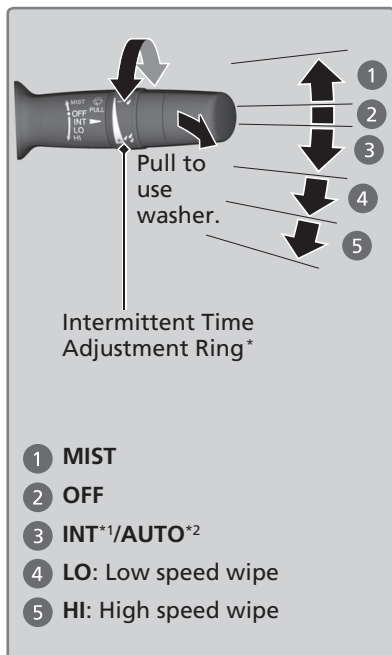

Models with intermittent time adjustment ring

If the vehicle speeds up while the wipers are operating intermittently, the length of the wipe interval shortens.

When the vehicle speeds up, the wiper operation's shortest delay setting (☂) and the **LO** setting become the same.

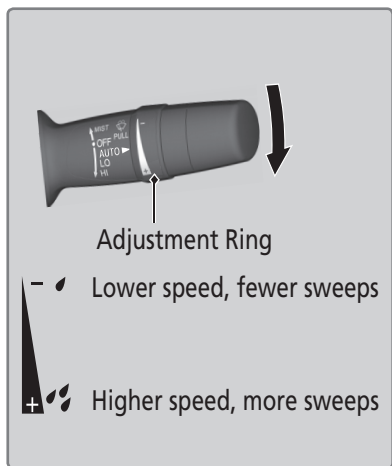

*1: without automatic intermittent wipers

*2: with automatic intermittent wipers

*if equipped

■ Headlight-Wiper Integration*

When the headlights are in the **AUTO** position, they automatically turn on when the front wipers operate several times within a certain interval. The headlights turn off shortly after the wipers are turned off or if there is enough ambient light.

■ Intermittent (INT) Wipers*

When you move the lever to the **INT** position, the wipers operate based on the delay adjustment.

Rotate the adjustment ring to adjust the wiper delay.

■ Automatic (AUTO) Intermittent Wipers*

When you push the lever down to **AUTO**, the windshield wipers sweep once, and go into the automatic mode.

The wipers operate intermittently, at low speed, or at high speed and stops in accordance with the amount of rainfall the rainfall sensor detects.

When the wiper function is set to **AUTO**, you can adjust the sensitivity of the rain fall sensor (using the adjustment ring) so that wipers will operate in accordance with your preference.



NOTICE

Turn the washers off if no washer fluid comes out. The pump may get damaged.

NOTICE

Do not use the wipers when the windshield is dry. The windshield will get scratched or the rubber blades will get damaged.

In cold weather, the blades may freeze to the windshield. Operating the wipers in this condition may damage the wipers. Use the defroster or heated windshield* to warm the windshield, then turn the wipers on.

**if equipped*

VEHICLE CONTROLS

NOTICE

AUTO should always be turned **OFF** before the following situations in order to prevent severe damage to the wiper system:

- Cleaning the windshield
- Driving through a car wash
- No rain present