

## Display Audio Operation

Use simple gestures—including touching, swiping, and scrolling—to operate certain audio functions.

Some items may be grayed out during driving to reduce the potential for distraction. You can select them when the vehicle is stopped or use voice commands\*.

Wearing gloves may limit or prevent touchscreen response.

You can use a microfiber cleaning cloth to remove dust or fingerprints from the touchscreen.

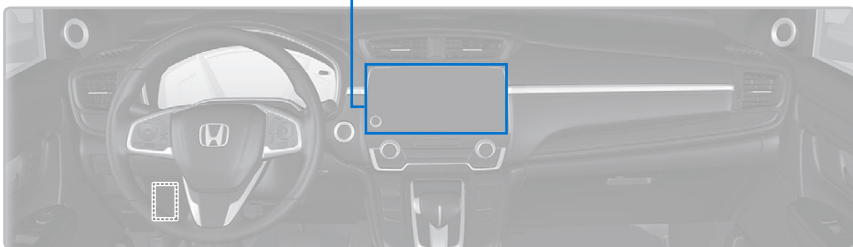
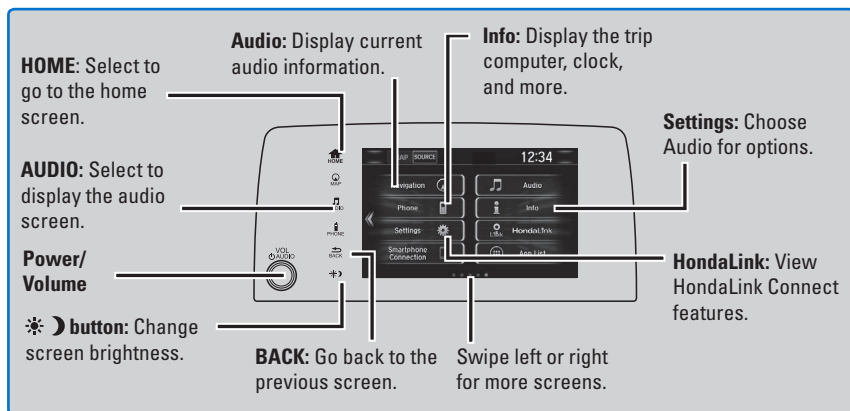

### ■ Setting Touchscreen Sensitivity

You can adjust the touchscreen's sensitivity to your fingertip.

1. From the HOME screen, select Settings, then System.
2. Select Display, then Touch Panel Sensitivity.
3. Make your selection.

## Models with Display Audio

### HondaLink®

Provides you with useful information about your vehicle directly from Honda.

Visit [automobiles.honda.com/handsfreelink/](http://automobiles.honda.com/handsfreelink/) (U.S.) or phone (888) 528-7876 (U.S. and Canada) to check phone compatibility. Standard data rates may apply with your phone service provider.

To get more information on HondaLink, visit [www.hondalink.com](http://www.hondalink.com) (U.S.) or [honda.ca/hondalink](http://honda.ca/hondalink) (Canada).

#### ■ HondaLink Connection

Follow the steps below to connect to HondaLink and use its features.

1. Download the HondaLink Connect app to your compatible smartphone.
2. Pair your phone to Bluetooth HandsFreeLink.
3. From the HOME screen, select HondaLink.
4. Certain features require you to send vehicle information to Honda. Select Enable Once, Always Enable, or Cancel.



#### ■ HondaLink Menu

Select a menu option.

**Places\*:** Displays restaurants, gas stations, Honda dealers, etc. and provides navigation instructions to those locations via the navigation system.

**Vehicle:** Displays instruction messages when the vehicle needs service.

**Help & Support:** Display tips for vehicle usage, get roadside assistance, or contact customer service.

**Messages from Honda:** Displays helpful and important information from Honda. If you have a new message, a yellow envelope icon appears at the top of the screen and a beep sounds. You can swipe down to view the message from any screen.

**Weather\*:** Displays a weekly five-day weather forecast for any location.



*\*if equipped*

### Models with Display Audio

### HondaLink® Assist

If your vehicle's airbags deploy or if the unit detects that the vehicle is severely impacted, your vehicle automatically attempts to connect to an operator. Your phone must be paired to the system and have good cellular connection. Visit [www.hondalink.com](http://www.hondalink.com) (U.S.) or [honda.ca/hondalinkassist](http://honda.ca/hondalinkassist) (Canada) for more information.

1. Make sure your phone is on and paired to *Bluetooth HandsFreeLink*.
2. Select *Call Now*, or the system automatically connects after 10 seconds. The vehicle information and its position may be sent to the operator.\*
3. Select *Talk Now* to immediately talk to the operator.
4. When the call is complete, select *Hang Up* or press the *Hang-Up/Back* button on the steering wheel.

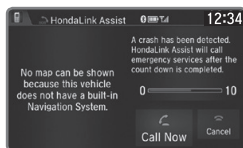

### Wi-Fi Connection

You can connect the audio system to the internet using Wi-Fi and use online services through the touchscreen. If your compatible phone has hotspot capabilities, the system can be tethered to the phone. Follow the steps below to set up Wi-Fi when the vehicle is stopped. Standard data rates apply with your phone service provider.

1. From the Home screen, select *Settings*.
2. Select *Bluetooth/Wi-Fi*. Select the *Wi-Fi* tab.
3. Select *Wi-Fi On/Off Status*, select *Next*, then select *On*.
4. Select *Yes*.
5. Select *Wi-Fi Device List*. Make sure your phone's Wi-Fi setting is in access point (tethering) mode.
6. Select the phone you want to connect to the system. If the phone you want to connect does not appear, select *Scan*.
7. Select *Add*.
8. Enter a password for your phone, if necessary. Select *Done*. The Wi-Fi symbol is displayed on the list when connection is successful.



*\*Depending on your phone and cellular signal capability, your vehicle's location may not be sent to the operator.*

## Models with Display Audio

### Apple CarPlay™

Connect an Apple CarPlay-compatible iPhone to the system. You can use the touchscreen to make a phone call, listen to music, and more. Visit the Apple CarPlay website for more information.

When your iPhone is connected to Apple CarPlay, it is not possible to use the *Bluetooth* Audio or *Bluetooth* HandsFreeLink. However, other previously paired phones can stream audio via *Bluetooth* while Apple CarPlay is connected.

Park in a safe place before connecting your iPhone and launching any compatible apps.

1. Connect the iPhone to the center-console USB port (1.5A).
2. Apple CarPlay requires you to send vehicle information to Honda. Select Enable Once, Always Enable, or Cancel. Your phone may prompt you to allow access for CarPlay to be launched.
3. From the HOME screen, select Apple CarPlay.
4. Select a menu option.

**Phone:** Access your contacts, make phone calls, or listen to voicemail. While connected to Apple CarPlay, calls can only be made through Apple CarPlay, not through Bluetooth HandsFreeLink.

**Music:** Play music stored on your iPhone.

**Maps:** View a map and operate navigation. You can only use Apple CarPlay or the pre-installed navigation system to set a destination with routing guidance.

**Messages:** View and reply to text messages, or have messages read to you aloud by the system.

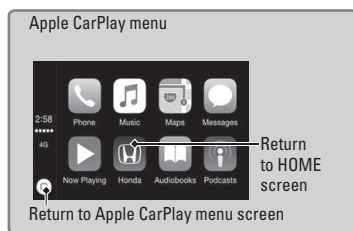
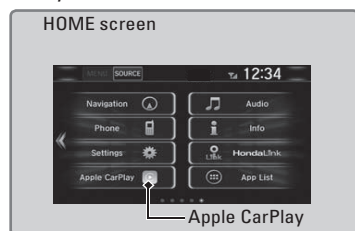

Once connected, press and hold the Talk button on the steering wheel to operate the system using voice commands with Siri Eyes Free

*Depending on use, Apple CarPlay can share certain vehicle information (e.g., vehicle location, speed, and other operating conditions) with the connected iPhone. See Apple's privacy policy for details regarding Apple's use and handling of data uploaded by CarPlay. Use of CarPlay is at user's own risk, and is subject to agreement to the CarPlay terms of use, which are included as part of the Apple iOS terms of use. CarPlay vehicle integration is provided "as is," and Honda cannot guarantee CarPlay operability or functionality now or in the future due to, among other conditions, changes in CarPlay software/Apple iOS, service interruptions, or incompatibility or obsolescence of vehicle-integrated hardware or software. See dealer for details. Only use CarPlay when conditions allow you to do so safely. See your Owner's Manual at [owners.honda.com](http://owners.honda.com) (U.S.) for further license and warranty terms.*

## Models with Display Audio

## Android Auto™

Connect a compatible Android phone to the system. You can use the touchscreen to make a phone call, listen to music, and more. Visit the Android Auto website for more information.

When your Android phone is connected to Android Auto, it is not possible to use the *Bluetooth* Audio. However, other previously paired phones can stream audio via *Bluetooth* while Android Auto is connected.

Park in a safe place before connecting your Android smartphone and launching any compatible apps.

1. Download the Android Auto app to your phone.
2. Connect the phone to the center-console USB port (1.5A). The phone is automatically paired. A tutorial also appears.
3. From the HOME screen, select Android Auto.
4. Android Auto requires you to send vehicle information to Honda. Select Enable Once, Always Enable, or Cancel.
5. Select a menu option.



- a. Maps (Navigation):** View Google Maps and operate navigation. You can only use this system or the pre-installed navigation system to set a destination with routing guidance. You cannot enter destinations using the keyboard while the vehicle is moving.
- b. Phone (Communication):** Make and receive phone calls, as well as listen to voicemail. While connected to Android Auto, calls can only be made through Android Auto, not through *Bluetooth* HandsFreeLink.
- c. Google Now (Home Screen):** Display useful information organized by Android Auto into simple cards that appear only when needed.
- d. Music and audio:** Play music from compatible apps. Select this icon to switch between music apps.
- e. Go back to the HOME screen:** Go back to the vehicle system HOME screen.
- f. Voice:** Use voice commands via Google Voice Search to operate Android Auto. You can also press and hold the Talk button on the steering wheel to say voice commands.

*Depending on use, Android Auto can share certain vehicle information (e.g., vehicle location, speed, and other operating conditions) with Google and its service providers. See Google privacy policy for details regarding Google's use and handling of data uploaded by Android Auto. Use of Android Auto is at user's own risk, and is subject to agreement to the Android Auto terms of use, which are presented to the user when the Android Auto application is downloaded to the user's Android phone. Android Auto vehicle integration is provided "as is," and Honda cannot guarantee Android Auto operability or functionality now or in the future due to, among other conditions, changes in Android Auto software/Android operating system, service interruptions, or incompatibility or obsolescence of vehicle-integrated hardware or software. See dealer for details. Only use Android Auto when conditions allow you to do so safely. See your Owner's Manual at [owners.honda.com](http://owners.honda.com) (U.S.) for further license and warranty terms.*

## Models with Display Audio

### FM/AM Radio

Play FM or AM radio stations.

**Source:** Select the FM or AM icon.

**Scan:** Scan for each station with a strong signal.

**Audio:** Display menu options, including Music Search.

**Open/close:** Display or hide the station list or preset list.

**Seek:** Search for the next or previous station with a strong signal.

**Tune:** Change the station.

**Presets:** Select and hold a preset number to store the current station. Select a preset number to select a previously stored station.

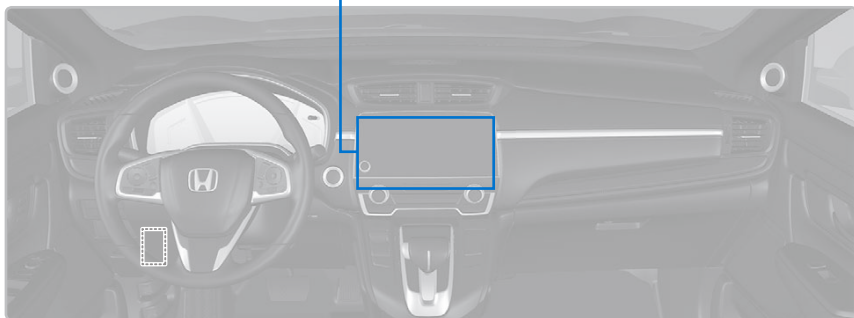
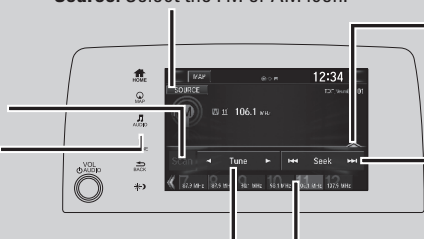

### Models with Display Audio

## SiriusXM® Radio\*

Available on a subscription basis only. For more information or to subscribe, contact your dealer, or visit [www.siriusxm.com/subscribe-now](http://www.siriusxm.com/subscribe-now) (U.S.) or [www.sirius.ca/subscribe-now](http://www.sirius.ca/subscribe-now) (Canada).

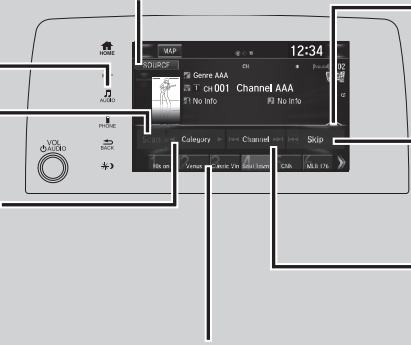

**Audio:** Display menu options, including Music Search.

**Scan:** Scan for each station with a strong signal.

**Category:** Change the category.

**Source:** Select the SiriusXM icon.

**Open/close:** Display or hide the channel list or preset list.

**Skip:** Change the selection. Press and hold to skip rapidly.

**Channel:** Change the channel. Press and hold to skip 10 channels at a time.

**Presets:** Select and hold a preset number to store the current station. Select a preset number to select a previously stored station.

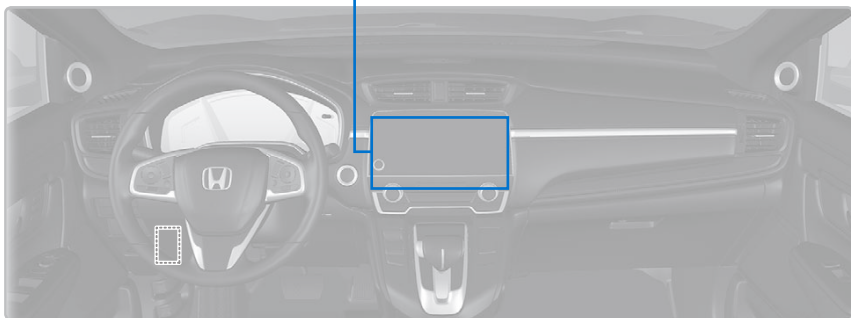

To learn about additional features—such as multi-channel preset, replay, or SportsFlash—see your Owner's Manual at [owners.honda.com](http://owners.honda.com).

Available in the U.S. and Canada, except Hawaii, Alaska, and Puerto Rico.  
XM® is a registered trademark of Sirius XM Radio, Inc.

\*if equipped

## Models with Display Audio

### iPod®

Play and operate an iPod through the vehicle's audio system. Connect your device to the USB port.

If an iPhone is connected via Apple CarPlay, the iPod source is unavailable and audio files on the phone can only be played within Apple CarPlay.

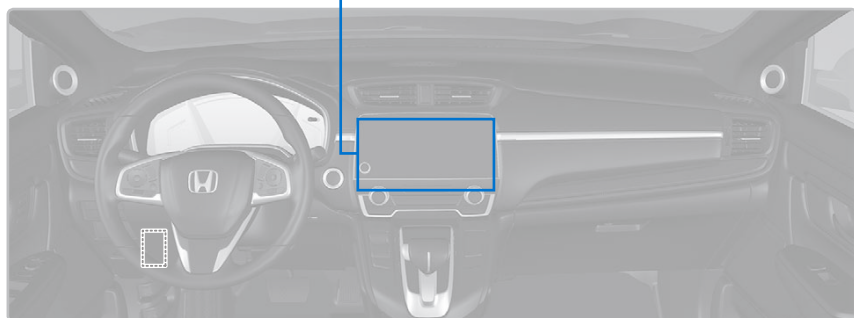
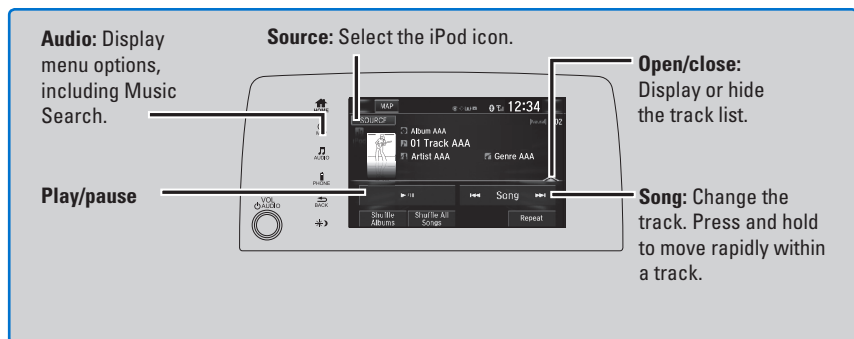

### ■ Searching for Music

Use the touchscreen to search for tracks stored on the iPod.

1. From the audio screen, press MENU.
2. Select Music Search.
3. Select a search option.
4. Select the track you want to play.
5. On vehicles with navigation, you can also search for and play iPod music using Song By Voice.

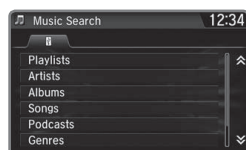



### Models with Display Audio

## USB Flash Drive

Play and operate a USB flash drive through the vehicle's audio system. Connect your device to the USB port.

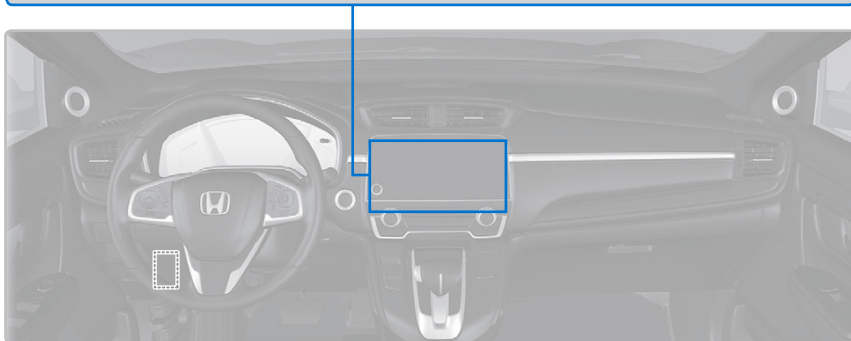
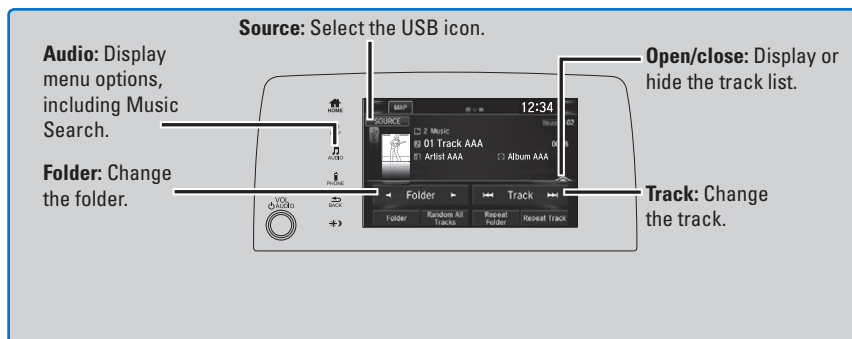

### ■ Searching for Music

Use the touchscreen to search for tracks stored on the USB flash drive.

1. From the audio screen, press MENU.
2. Select Music Search.
3. Select a folder.
4. Select the track you want to play.

On vehicles with navigation, you can also search for and play music from the flash drive using Song By Voice.



## Models with Display Audio

**Bluetooth® Audio**

Play streaming or stored audio from your compatible phone through the vehicle's audio system. Visit [automobiles.honda.com/handsfreelink/](http://automobiles.honda.com/handsfreelink/) (U.S.) or phone (888) 528-7876 (U.S. and Canada) to check phone compatibility. Standard data rates apply with your phone service provider. Connect your phone to *Bluetooth HandsFreeLink*.

If a phone is currently connected via Apple CarPlay or Android Auto, *Bluetooth Audio* from that phone is unavailable.

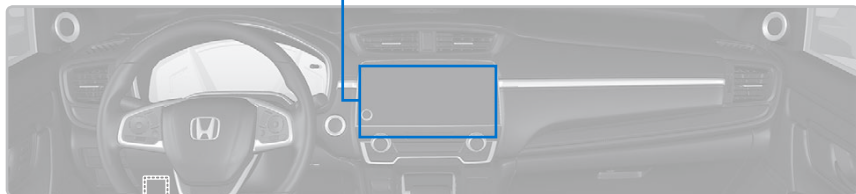
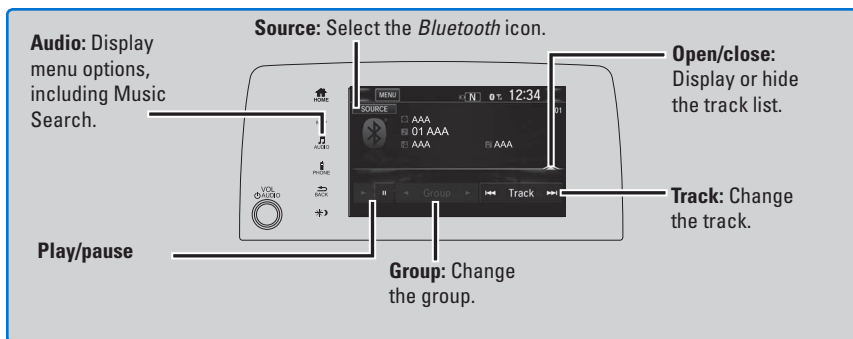
■ **Searching for Music**

Use the touchscreen to search for tracks stored on the device.

1. From the audio screen, press MENU.
2. Select Music Search.
3. Select a search category.
4. Select the track you want to play.

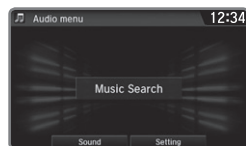
**Notes:**

- Make sure the volume on your phone is properly adjusted.
- You may need to enable additional settings on your phone for playback.
- Certain audio controls are not supported on all phones.

*Applicable laws may prohibit the operation of handheld electronic devices while operating a vehicle. Launch streaming audio on your phone only when safe to do so.*

## Models with Display Audio

### Pandora®\*

Play and operate Pandora from your compatible phone through the vehicle's audio system. Visit [automobiles.honda.com/handsfreelink/](http://automobiles.honda.com/handsfreelink/) or phone (888) 528-7876 to check phone compatibility. Standard data rates apply with your phone service provider. Connect your phone when the vehicle is stopped. Disruptions in your phone's cell signal can affect audio playback.

#### For iPhone:

- Connect via *Bluetooth* HandsFreeLink or USB port.
- A pop-up may appear on your phone requesting you to allow access for Pandora to be launched.
- If you cannot operate Pandora through the audio system, it may be streaming through *Bluetooth* Audio. Make sure Pandora is selected on the audio system.
- If Pandora still does not operate, try rebooting the phone and reconnecting the cable if necessary.

#### For other compatible smartphones:

- Connect via *Bluetooth* HandsFreeLink.
- If your phone is connected to Android Auto, Pandora is only available through the Android Auto interface. Visit the Android Auto website to check compatibility.

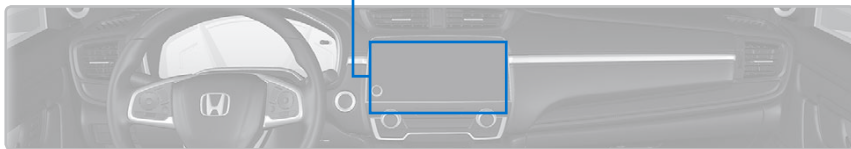
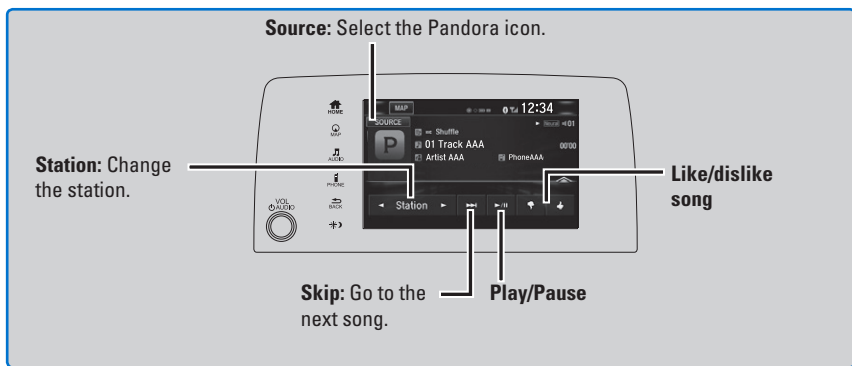

*\*If equipped*  
*Applicable laws may prohibit the operation of handheld electronic devices while operating a vehicle. Launch streaming audio on your phone only when safe to do so.*

## Models with Display Audio

### Basic HFL Operation

Make and receive phone calls using the vehicle's audio system, without handling your phone. Visit [automobiles.honda.com/handsfreelink/](http://automobiles.honda.com/handsfreelink/) (U.S.) or phone (888) 528-7876 (U.S. and Canada) to check phone compatibility.

**To reduce the potential for driver distraction, certain manual functions may be inoperable or grayed out while the vehicle is moving. Stop or pull over to perform the function. Voice commands are also available.**

#### ■ HFL Controls

Use the controls to enter information and make selections.

**Hang-Up/Back button:** End or decline a call, or cancel an operation.

**Pick-Up button:** Answer an incoming call.

**Talk button:** Make a call using a stored voice tag, or say voice commands\*.

**Phone icon button:** Press until the phone screen is displayed in the Driver Information Interface.

**▲ / ▼ buttons:** Scroll the phone list in the Driver Information Interface.

**ENTER button:** From the phone screen in the Driver Information Interface, select from Speed Dial, Call History, or Phonebook.

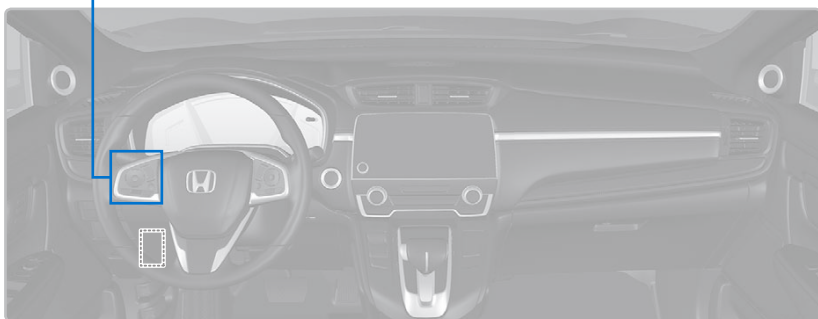
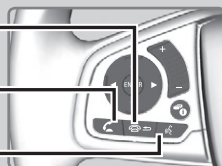

**Phone:** From the HOME screen, display the phone screen.

**BACK:** Go back to the previous display.



Models with Navigation shown

**Settings:** Select Phone from the Settings screen for phone pairing and more.

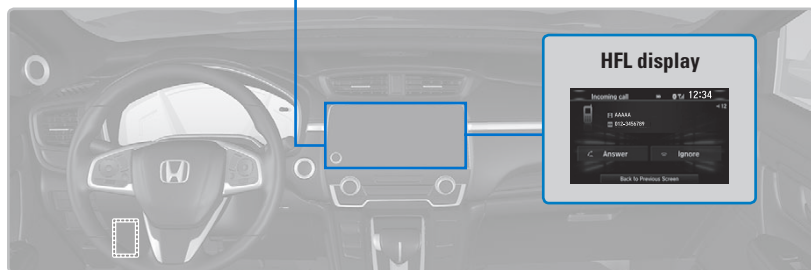

## Talk Button Tips

- When using the Talk button, wait until you hear a beep before speaking.
- To bypass the system prompts, simply press the Talk button again to say your command.\*
- When the Talk button is pressed, all available voice commands are highlighted in yellow.\*
- Speak in a clear, natural voice.
- Reduce all background noise.
- Adjust the dashboard vents away from the microphone on the ceiling.
- Close the windows and moonroof.

*\*vehicles with navigation*

## Models with Display Audio

### Pairing a Phone

To use hands-free phone and streaming audio functions, you must first pair your phone to the system. This can only be done when the vehicle is stopped. Use the touchscreen to make and enter selections.

If there is an active connection to Apple CarPlay or Android Auto, pairing of additional *Bluetooth*-compatible devices is unavailable and Add Bluetooth Device is grayed out from the Bluetooth Device List screen.

1. From the Home screen, select Settings.
2. Select Phone, then select Yes.
3. Make sure your phone is in discovery mode. Select Continue.
4. The system searches for your phone. Select your phone when it appears on the list.
5. If your phone does not appear: Select Refresh or Select Phone Not Found and search for Bluetooth® devices using your phone. From your phone, search for HandsFreeLink.
6. The system gives you a pairing code. Confirm the code that appears on the screen and your phone match. Connect to HFL from your phone.



*Applicable laws may prohibit the operation of handheld electronic devices while operating a vehicle.*

## Models with Display Audio

### Making a Call

You can make a call using several methods.

#### ■ Dialing a Number

Enter a 10-digit phone number to call.

##### Using voice commands

Press the Talk button before you say each command.

1. Say "Dial by number."
2. Say the phone number: For example, "3-1-0-5-5-1-2-3-4."
3. The system begins to dial.



##### Using the touchscreen

Manual operation is limited while the vehicle is moving. Voice commands are always available.

1. From the Home screen, select Phone.
2. Select MENU.
3. Select Dial.
4. Enter the phone number. Select the green phone icon to call.



#### ■ Using the Phonebook

When your phone is paired, its entire phonebook can be automatically imported to the system. Phone synchronization must be turned on.

##### Using voice commands

Press the Talk button before you say each command.

1. Say "Dial by name."
2. Say the phonebook name and phone type. For example, "John Smith mobile."

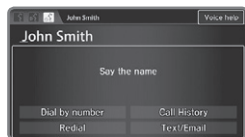

##### Using the touchscreen

Manual operation is limited while the vehicle is moving. Voice commands are always available.

1. From the Home screen, select Phone.
2. Select MENU.
3. Select Phonebook.
4. Scroll through the list to find the name and number you want to call, and select it to call.



## ■ Storing Speed Dial Entries

Store up to 20 numbers for quick dialing.

1. From the Home screen, select Phone.
2. Select MENU.
3. Select Edit Speed Dial, then select New Entry.
4. Select an entry method.
5. If desired, you can create a voice tag for the number. Follow the prompts.



## ■ Using Speed Dial

Make calls quickly using stored speed dial entries.

### Using voice commands

Press the Talk button before you say each command.

1. Say *"Dial by name."*
2. Say the stored voice tag name.  
For example, *"John Smith."*



### Using the touchscreen

1. Go to the Phone Menu screen, then select Speed Dial.
2. Scroll through the list to find the entry you want to call, select it to call.





## Models with Display Audio

### SMS Text Messaging and E-Mail\*

Certain phones can receive and send messages when paired and connected. Visit [automobiles.honda.com/handsfreelink/](http://automobiles.honda.com/handsfreelink/) (U.S.) or phone (888) 528-7876 (U.S. and Canada) to check phone compatibility. Standard message rates apply with your phone service provider. This feature is limited while the vehicle is moving.

#### Selecting an Account

If your phone has both text message and e-mail accounts, you can select only one of them at a time to be active and receive notifications.

1. Go to the Phone Settings screen.
2. Select Text/Email tab.
3. Select Select Account.
4. Select a Text Message or an e-mail account.

To enable new message notification:

5. Return to the Text/Email tab.
6. Select Enable Text/E-Mail, then select Next.
7. A pop menu appears, Select On.

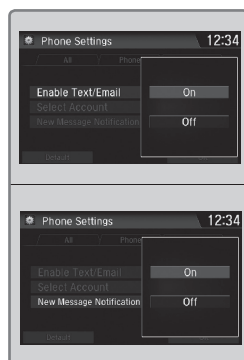

#### Receiving and Responding to Messages

When you receive a new message, a pop-up appears on the touchscreen. You can view the message when the vehicle is stopped. You can also reply to it using fixed phrases or call the sender.

1. When the prompt appears, select Read.
2. The message is displayed, and the system reads it aloud.

*To reply:* With the message open, select Reply, and choose one of the six available responses. Select Send to send the message. You cannot create a new text message.

*To call the sender:* With the message open, select Dial.

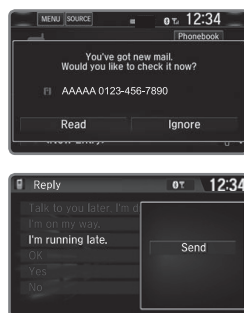

**Models with Display Audio****Siri® Eyes Free**

Activate Siri through your vehicle when an iPhone is paired to the system. Visit [\*automobiles.honda.com/handsfreelink/\*](http://automobiles.honda.com/handsfreelink/) (U.S.) or [\*honda.ca/siri\*](http://honda.ca/siri) (Canada) to check phone compatibility.

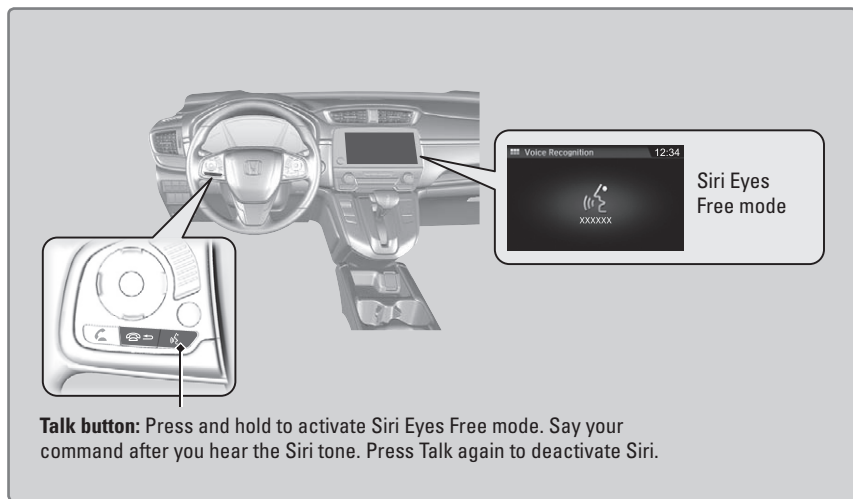

Here are some examples of Siri commands:

*"Call John Smith"*

*"Read my new text message"*

*"Find a nearby sushi restaurant"*

*"Remind me to pick up dinner"*

*"Set up a meeting today at 3 p.m."*

*"Play song XYZ"*

**Notes:**

- Any requests that include visual feedback from Siri on your phone are not displayed in the vehicle.
- Certain commands rely on the iPhone's features and existing apps.
- To hear turn-by-turn directions or songs through the vehicle, set the audio source to *Bluetooth Audio*.
- If using Siri Eyes Free through Apple CarPlay, use the Talk button to activate and deactivate Siri Eyes Free mode.

# VOICE COMMAND INDEX

Learn about all available voice commands to help you operate the vehicle. The system recognizes only the commands listed here. Available on vehicles with Display Audio.

Press the Talk button before you say a command.

## ■ Voice Portal Commands

When you press the Talk button, the Voice Portal screen appears. Say one of the options, and follow the system prompts.

- Phone call
- Music search
- Audio
- Climate control
- Navigation\*
- Voice setting
- Voice help
- What is today's date?
- What time is it?

## ■ Navigation Commands\*

The system accepts these commands on most screens. You only need to press the Talk button once for navigation commands.

- View map
- Find place
- Find category
- Find intersection
- Recently found
- Go home
- Find address
- Find city
- Saved places
- Detour
- Stop Route

## ■ Climate Control Commands\*

The system accepts these commands on most screens.

- Climate control on\*\*
- Climate control off\*\*
- Air conditioner on\*\*
- Air conditioner off\*\*
- Defrost on\*\*
- Defrost off\*\*
- Fan speed # (#: 1 to 7)
- Temperature # degrees (#: 57 to 87°F, 18 to 32°C)
- Temperature max heat
- Temperature max cool

## ■ Phone Commands

The system accepts these commands on most screens.

- Call by number
- Call by name
- Call (number)
- Call (name)

*\*models with navigation*

*\*\*These commands toggle the function on and off, so the command may not match your intended action.*

## ■ Audio Commands\*

The system accepts these commands on most screens. Audio volume levels cannot be controlled using voice commands.

### FM/AM Radio Commands

- Audio on\*\*
- Audio off\*\*
- Radio FM
- Radio AM
- Radio tune to # FM (#: frequency, e.g., 95.5)
- Radio tune to # AM (#: frequency, e.g., 1020)
- Radio FM preset # (#: 1 to 12)
- Radio AM preset # (#: 1 to 6)

### SiriusXM Radio Commands

- Radio SXM
- SXM channel # (#: 0 to 255)
- SXM channel (channel name)
- Radio SXM preset # (#: 1 to 12)

### Song By Voice™ Commands

Available for tracks stored on an iPod or USB device.

- Music search
- List album (specify album)
- List artist (specify artist)
- List composer (specify composer)
- List genre (specify genre)
- List playlist (specify playlist)
- Play album (specify album)
- Play artist (specify artist)
- Play composer (specify composer)
- Play genre (specify genre)
- Play playlist (specify playlist)
- Play song (specify song)
- What/Who am I listening to?
- Who is this?
- What's playing?
- Who's playing?
- What album is this?

### Pandora Commands (U.S. only)

- Pandora play

### USB Commands

- USB
- USB play
- USB play track # (#: 1 to 30)

### iPod Commands

- iPod
- iPod play
- iPod play track # (#: 1-30)

### Bluetooth Audio Commands

- Bluetooth audio play (may not work on all phones)

*\*models with navigation*

*\*\*These commands toggle the function on and off, so the command may not match your intended action.*