

Climate Control System

Maintains your preferred interior temperature by selecting the proper mix of heated or cooled air and fan speed. Use the buttons on the dashboard to control the system.

Selected temperature display

A/C: Turn air conditioning on or off.

MODE: Select airflow location.



Driver's temperature control dial

Fan control buttons

CLIMATE button: Select climate options on the touchscreen.

Passenger's temperature control dial

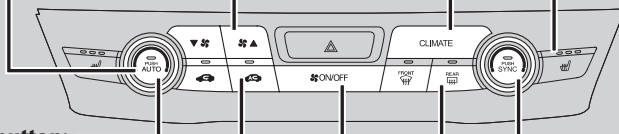

AUTO button: Press, then use the temperature control dial to set your preferred temperature.

ON/OFF button

Defroster buttons

SYNC button: Set the passenger's side temperature to the same as the driver's side.

Recirculation buttons:

Recirculation mode (indicator on): Recirculates air from the vehicle's interior.

Auto mode (indicator on): Automatically switch between the recirculation and fresh air modes most suitable to environmental conditions.

Fresh air mode (both indicators off): Maintains outside ventilation. Keep the system in fresh air mode in normal situations.

Remote Climate Control

Start the climate control system using the remote transmitter before you enter the vehicle.

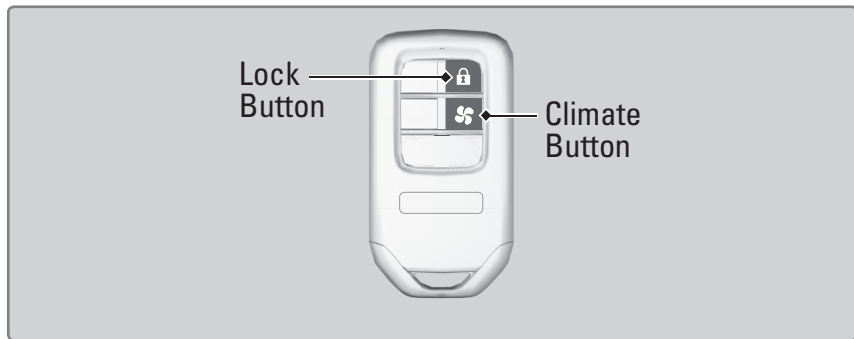

■ Turn On the Climate Control System

Press the Lock button, then press and hold the climate button within 5 seconds.

■ Turn Off the Climate Control System

Press and hold the climate button.