

# BLUETOOTH® HANDSFREELINK®

Learn how to operate the vehicle's hands-free calling system.

## Basic HFL Operation

Make and receive phone calls using the vehicle's audio system, without handling your phone. Visit *handsfreelink.com (US)* or phone (888) 528-7876 (Canada) to check phone compatibility.

To reduce the potential for driver distraction, certain manual functions may be inoperable or grayed out while the vehicle is moving. Voice commands are always available.

### ■ HFL Displays and Controls

Use the controls to enter information and make selections.

Models with Display Audio

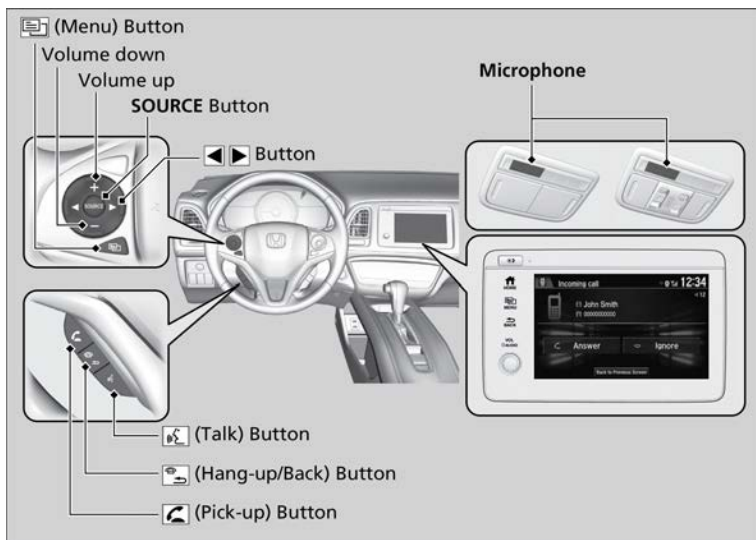

- Pick-up button:** Press to go directly to the phone screen, or to answer an incoming call.
- Hang-up/back button:** Press to end a call, go back to the previous command, or cancel a command.
- Talk button:** Press to call a number with a stored voice tag.
- Menu button:** Press and hold to display Speed Dial, Call History, or Redial on the phone screen.
- <> button:** Press to select an item displayed on the phone screen.
- SOURCE button:** Press to call a number listed in the selected item on the phone screen.

#### ■ Talk Button Tips

When using the Talk button, wait for the beep before saying a command. The system recognizes commands listed in the Voice Command Index.

- When using the Talk button, wait until you hear a beep before speaking.
- To bypass the system prompts, simply press the Talk button again to say your command.
- Speak in a clear, natural voice.
- Reduce all background noise.
- Adjust the dashboard vents away from the microphone on the ceiling.
- Close the windows and moonroof\*1.

## Pairing a Phone

To use hands-free phone and streaming audio functions, you must first pair your phone to the system. This can only be done when the vehicle is stopped. If there is an active connection to Apple CarPlay (see Models with Display Audio - Apple CarPlay™) or Android Auto (see Android Auto™), pairing of additional Bluetooth-compatible devices is unavailable and Add Bluetooth Device is grayed out from the Bluetooth Device List screen.

### ■ Pairing the First Phone

#### Models with Display Audio

Use the touchscreen to make and enter selections.

*\*1 - If equipped*

1. Select Phone.
2. Select Yes.
3. Make sure your phone is search or discoverable mode, then select Continue.  
HFL automatically searches for a Bluetooth® device.
4. Select your phone when it appears on the list.  
If your phone does not appear, you can select Refresh to search again.
5. The system gives you a pairing code on the audio/information screen.  
Confirm if the pairing code on the screen and your phone match.  
This may vary by phone.

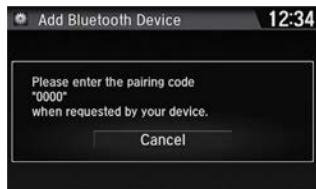

## Making a Call

You can make calls by inputting any phone number, or by using the imported phonebook, call history, speed dial entries, or redial.

### ■ Dialing a Number

*Applicable laws may prohibit the operation of handheld electronic devices while operating a vehicle.*

## Models with Display Audio

1. Go to the phone menu screen.
2. Select Dial.
3. Select a number.

Use the keyboard on the touch screen for entering numbers.

4. Select Hang up.



## ■ Using the Phonebook

When your phone is paired, its phonebook is automatically imported to the system.

This method is inoperable while the vehicle is moving.

## Models with Display Audio

1. Go to the phone menu screen.
2. Select Phonebook.
3. Select a name.

You can also search by letter. Select Search.

4. Select a number.

Dialing starts automatically.



## ■ Storing Speed Dial Entries

Store up to 20 numbers for quick dialing. To store a speed dial number:

## Models with Display Audio

1. Go to the phone menu screen.
2. Select Speed Dial.
3. Select New Entry.
4. Select a place to choose a number.

From Manual Input:

Input the number manually.

From Import from Phonebook:

Select a number from the connected mobile phone's imported phonebook.

5. When the speed dial is successfully stored, you are asked to create a voice tag for the number. Select Yes or No.
6. Select Record to store a voice tag for the speed dial entry.



### ■ Using Speed Dial

## Models with Display Audio

1. Go to the phone menu screen.
2. Select Speed Dial.
3. Select a number.

Dialing starts automatically.





# VOICE COMMAND INDEX

Learn about the available voice commands to help you operate the vehicle. The system recognizes only those commands shown here. Press the TALK button before you say a command.

## Voice Portal Commands

When you press the TALK button, the Voice Portal screen appears. Say one of the options, and follow the system prompts.

- Phone
- Audio
- Navigation<sup>\*2</sup>

## Phone Commands

The system accepts these commands on most screens.

## Audio Commands<sup>\*1</sup>

The system accepts these commands on the dedicated screen for the voice recognition of the audio.

## Navigation Commands<sup>\*2</sup>

When you press the Talk button and say “*Navigation*,” you can say one of the options below. Follow the system prompts.

- Show/View map
- Go home
- Find address
- Stop route
- Detour
- Find city
- Recent Places
- Find intersection

*\*2 - Models with navigation only*

*\*1 - If equipped*