

## AUDIO AND CONNECTIVITY

---

### **Display Audio System**

Use simple gestures-including touching, swiping and scrolling-to operate certain audio functions.

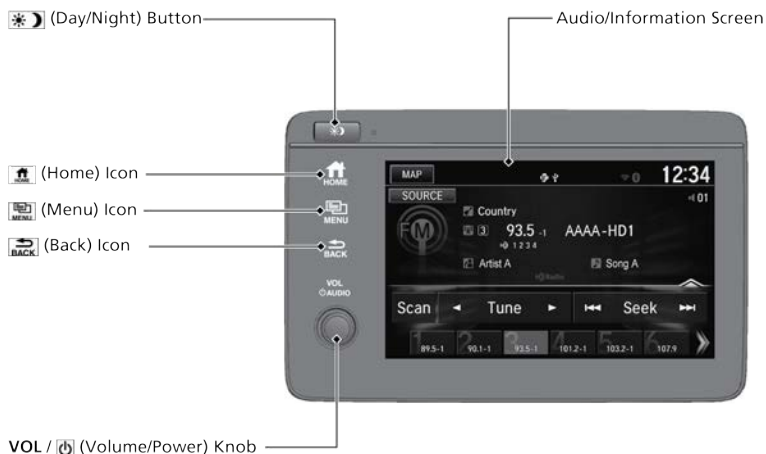

**Note:** Some items may be grayed out during driving to reduce the potential for distraction. You can select them when the vehicle is stopped or use voice commands.

Wearing gloves may limit or prevent touchscreen response.

## HondaLink<sup>®</sup>

### Models with Display Audio

A subscription-based service that provides convenient features such as voice communication in case of emergency, online security, and one-on-one operator assistance\*1.

To check phone compatibility and get more information, visit [handsfreelink.com](http://handsfreelink.com) (US) [handsfreelink.ca](http://handsfreelink.ca) (Canada). Standard data rates may apply with your phone service provider.

#### ■ HondaLink<sup>®</sup> Connection

Follow the steps below to connect to HondaLink<sup>®</sup> Connection and use its features.

## Apple Carplay<sup>™</sup>

### Models with Display Audio

If you connect an Apple Carplay<sup>™</sup>-compatible iPhone<sup>®</sup> to the system via the 1.5A USB port, you can use the audio/information touchscreen, instead of the iPhone<sup>®</sup> display, to make a phone call, listen to music, view maps (navigation), and access messages.

### Home Screen



Apple CarPlay™ Icon

### Apple CarPlay™ Menu

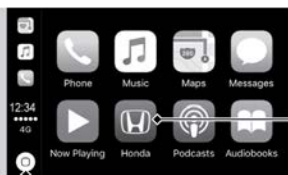

Go back to the Apple CarPlay™ menu screen.

Select the Honda Icon to return to the Home screen.

**Phone:** Access the contact list, make phone calls, or listen to voice mail.

**Messages:** Check and reply to text messages, or have messages read to you.

**Music:** Play music stored on your iPhone®.

**Maps:** Display Apple Maps and use the navigation function just as you would on your iPhone®.

### Models with navigation system

Only one navigation system (pre-installed navigation or Apple CarPlay™) can give directions at a time. When you are using one system, directions to any prior destination set on the other system will be canceled, and the system you are currently using will direct you to your destination.

## Android Auto™

When you connect an Android phone to the display audio system via the 1.5A USB port, Android Auto™ is automatically initiated. When connected via Android Auto™, you can use the audio/information screen to access the Phone, Google Maps (Navigation), Google Play Music, and Google Now functions. When you first use Android Auto™, a tutorial will appear on the screen. We recommend that you complete this tutorial while safely parked before using Android Auto™.

*Depending on use, Apple CarPlay can share certain vehicle information (e.g., vehicle location, speed, and other operating conditions) with the connected iPhone. See Apple's privacy policy for details regarding Apple's use and handling of data uploaded by CarPlay. Use of CarPlay is at user's own risk, and is subject to agreement to the CarPlay terms of use, which are included as part of the*

*Apple iOS terms of use. CarPlay vehicle integration is provided "as is," and Honda cannot guarantee CarPlay operability or functionality now or in the future due to, among other conditions, changes in CarPlay software/Apple iOS, service interruptions, or incompatibility or obsolescence of vehicle-integrated hardware or software. See dealer for details. Only use CarPlay when conditions allow you to do so safely. See your Owner's Manual at [owners.honda.com](http://owners.honda.com) (U.S.) or [myhonda.ca](http://myhonda.ca) (Canada) for further license and warranty terms.*

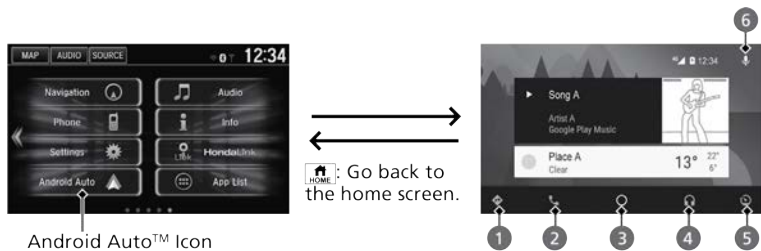

1. **Maps (Navigation):** Display Google Maps and use the navigation function just as you would with your Android phone. When the vehicle is in motion, it is not possible to make keyboard entries. Stop the vehicle in a safe location to undertake a search or provide other inputs.

### Models with navigation system

Only one navigation system (pre-installed navigation or Android Auto™) can give directions at a time. When you are using one system, directions to any prior destination set on the other system will be canceled, and the system you are currently using will direct you to your destination. The audio/Information screen shows you turn-by-turn driving directions to your destination.

2. **Phone (Communication):** Make and receive phone calls as well as listen to voicemail.
3. **Google Now (Home screen):** Display useful information organized by Android Auto™ into simple cards that appear just when they're needed.
4. **Music and audio:** Play Google Play Music and music apps that are compatible with Android Auto™. To switch between music apps, press this icon.
5. **Go back to the Home Screen**
6. **Voice:** Operate Android Auto™ with your voice.

*Depending on use, Android Auto can share certain vehicle information (e.g., vehicle location, speed, and other operating conditions) with Google and its service providers. See Google privacy policy for details regarding Google's use and handling of data uploaded by Android Auto. Use of Android Auto is at user's own risk, and is subject to agreement to the Android Auto terms of use, which are presented to the user when the Android Auto application is downloaded to the user's Android phone. Android Auto vehicle integration is provided "as is," and Honda cannot guarantee Android Auto operability or functionality now or in the future due to, among other conditions, changes in Android Auto software/Android operating system, service interruptions, or incompatibility or obsolescence of vehicle-integrated hardware or software. See dealer for details. Only use Android Auto when conditions allow you to do so safely. See your Owner's Manual at [owners.honda.com](http://owners.honda.com) (U.S.) or [myhonda.ca](http://myhonda.ca) (Canada) for further license and warranty terms.*

## AUDIO AND CONNECTIVITY

### FM/AM Radio

Play FM or AM radio stations.

#### Models with Display Audio

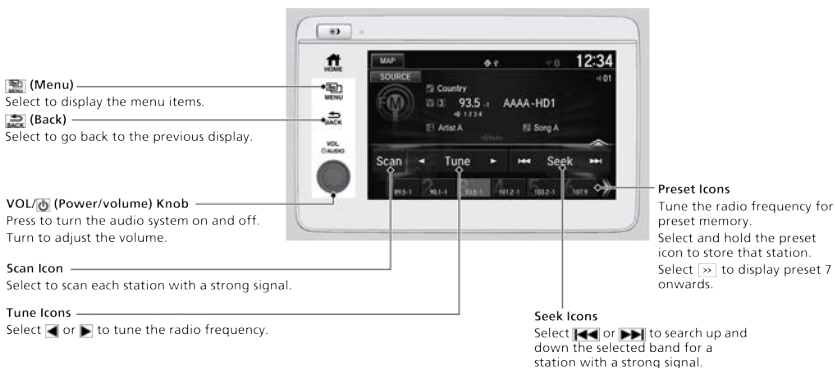

### SiriusXM®\*1

#### Models with Display Audio

Available on a subscription basis only. For more information or to subscribe, contact your dealer, or visit [www.sirius.com/subscribenow](http://www.sirius.com/subscribenow) (U.S.) or [www.sirius.ca/subscribe-now](http://www.sirius.ca/subscribe-now) (Canada).

*\*1 - If equipped*

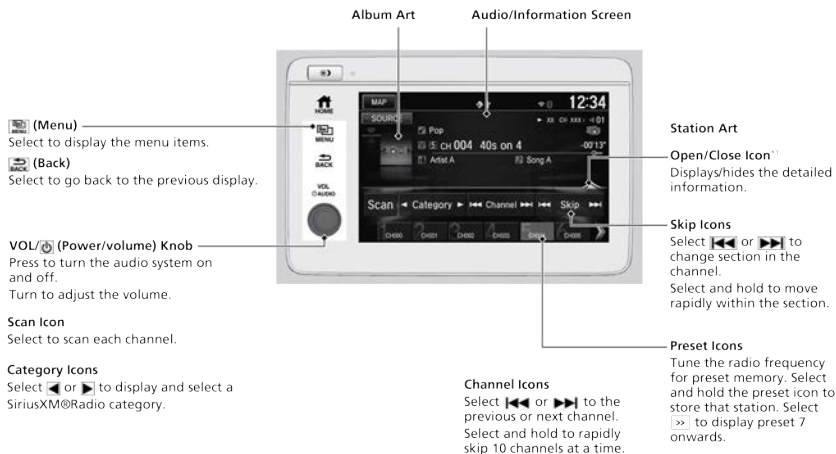

To learn about additional features—such as multi-channel preset, replay, or SportsFlash—see your Owner's Manual at [owners.honda.com](http://owners.honda.com) (U.S.) or [myhonda.ca](http://myhonda.ca) (Canada).

**iPod®**

Play and operate an iPod®\*14 through the vehicle's audio system. Connect your device to the USB port (see USB Port).

\*14 - iPod and iPhone are trademarks of Apple, Inc.

# AUDIO AND CONNECTIVITY

## Models with Display Audio

Audio/Information Screen

USB Indicator

Appears when an iPod is connected.

 (Menu)

Select to display the menu items.

 (Back)

Select to go back to the previous display.

VOL  (Power/volume) Knob

Press to turn the audio system on and off.  
Turn to adjust the volume.

Cover Art



Open/Close Icon<sup>1</sup>

Displays/hides the detailed information.

Song Icons

Select  or  to change songs.

Select and hold to move rapidly within a song.

## ■ Searching for Music

### Models with Display Audio

Use the touchscreen to search for tracks stored on the iPod.

1. Select Menu, then select Music Search.
2. Select the items on that menu.

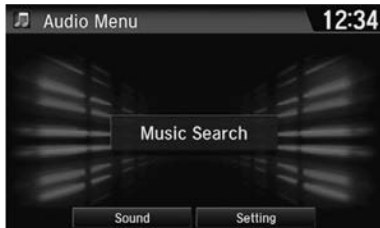

## Pandora®\*13

Your audio system allows you to listen to music from the Pandora®\*13 app on a compatible smartphone. This function is available when the phone is paired and connected to the vehicle's *Bluetooth*® HandsFreeLink® system, or with an iPhone®, you can connect using your USB cable to the USB port.

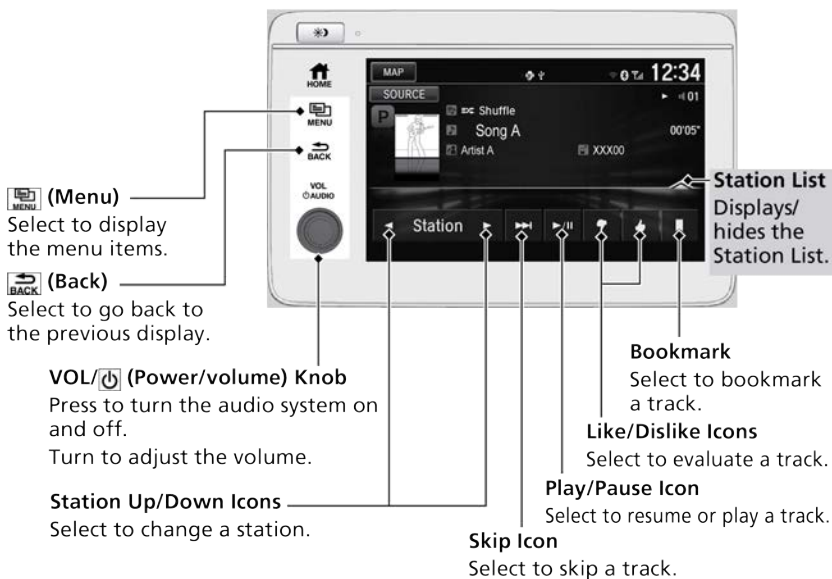

## USB Flash Drive

Your audio system reads and plays sound files on a USB flash drive in either MP3, WMA, or AAC\*1 format. Connect your USB flash drive to the USB port .

*\*13 - US models only, if equipped*

*Applicable laws may prohibit the operation of handheld electronic devices while operating a vehicle. Launch streaming audio on your phone only when it is safe to do so.*

*\*1 - If equipped*



# AUDIO AND CONNECTIVITY

## Models with Display Audio

Audio/Information Screen

 (Menu)

Select to display the menu items.

 (Back)

Select to go back to the previous display.

VOL  (Power/volume) Knob

Press to turn the audio system on and off.  
Turn to adjust the volume.

Folder Icons

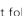
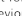
Select  to skip to the next folder, and  to skip to the beginning of the previous folder.





USB Indicator

Appears when a USB flash drive is connected.

Open/Close Icon<sup>17</sup>

Displays/hides the detailed information.

Track Icons

Select  or  to change files.  
Select and hold to move rapidly within a track.

## ■ Searching for Music

### Models with Display Audio

Use the touchscreen to search for tracks.

1. From the audio screen, press MENU.
2. Select Music Search.
3. Select a folder.
4. Select the track you want to play.



## **Bluetooth® Audio**

Play streaming or stored audio from your compatible phone when it is paired to *Bluetooth® HandsFreeLink®* (see Pairing a Phone). Visit *handsfreelink.com* (US) or *handsfreelink.ca* (Canada) to check phone compatibility. Standard data rates apply with your phone service provider.

### Models with Display Audio

## AUDIO AND CONNECTIVITY

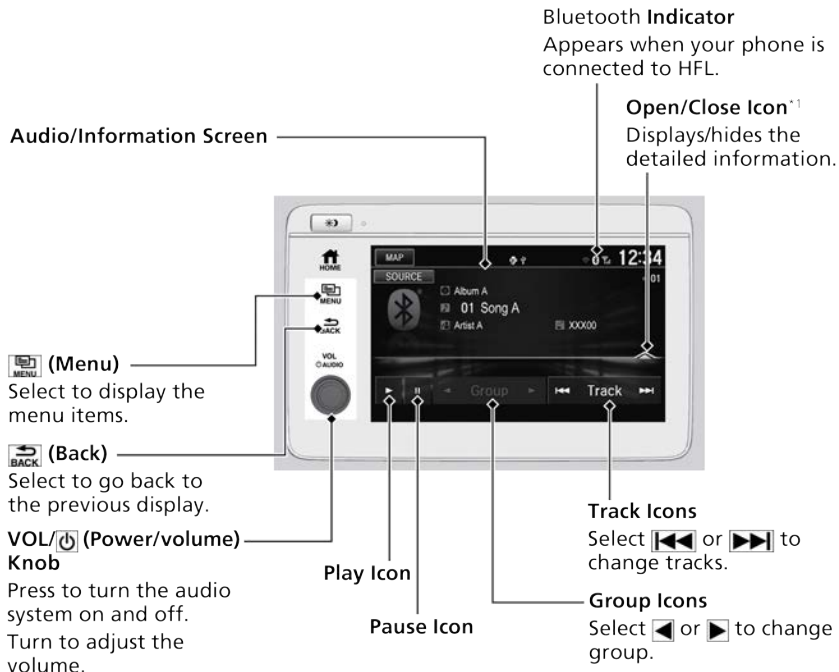

### ■ Searching for Music

#### Models with Display Audio

*Applicable laws may prohibit the operation of handheld electronic devices while operating a vehicle. Launch streaming audio on your phone only when safe to do so.*

1. From the audio screen, press MENU.
2. Select Music Search.
3. Select a search category.
4. Select the track you want to play.

**Note:**

- Make sure the volume on your phone is properly adjusted.
- You may need to enable additional settings on your phone for playback.
- The resume/pause function and remote audio controls are not supported on all phones.

