

BLUETOOTH® HANDSFREELINK®

Learn how to operate the vehicle's hands-free calling system.

Basic HFL Operation

Make and receive phone calls using the vehicle's audio system, without handling your phone. Visit handsfreelink.com (US) (U.S.) or phone (888) 528-7876 (Canada) to check phone compatibility.

To reduce the potential for driver distraction, certain manual functions may be inoperable or grayed out while the vehicle is moving. Voice commands are always available.

■ HFL Displays and Controls

Use the controls to enter information and make selections.

Models with Color Audio

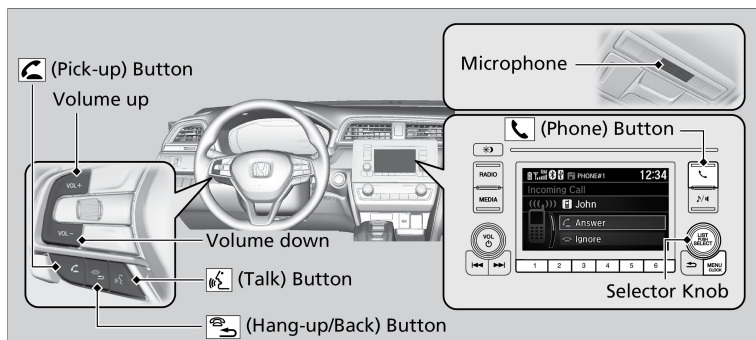

(Pick-up) button: Press to go directly to the phone screen, or to answer an incoming call.

(Hang-up/back) button: Press to end a call, go back to the previous command, or cancel a command.

(Talk) button: Press to call a number with a stored voice tag.

■ **Talk Button Tips**

When using the Talk button, wait for the beep before saying a command. The system recognizes only the commands listed in the Voice Command Index.

- Aim the vents away from the ceiling and close the windows, as noise coming from them may interfere with the microphone.
- Press and release the talk button when you want to call a number using a stored voice tag. Speak clearly and naturally after a beep.
- If the microphone picks up voices other than yours, the command may be misinterpreted.

- To change the volume level, use the audio system's volume knob or the remote audio controls*1 on the steering wheel.

Pairing a Phone

To use hands-free phone and streaming audio functions, you must first pair your phone to the system. This can only be done when the vehicle is stopped. If there is an active connection to Apple CarPlay (see Models with Display Audio - Apple CarPlay™) or Android Auto (see Android Auto™), pairing of additional Bluetooth-compatible devices is unavailable and Add Bluetooth Device is grayed out from the Bluetooth Device List screen.

■ Pairing the First Phone

Models with Color Audio

Use the selector knob to make and enter selections.

1. Press the pick up button or the hang up button.
2. Rotate the selector knob to select Yes, then press the selector knob.
3. Rotate the selector knob and select Add New Device, then press the selector knob.
4. Press the selector knob to select OK.
5. Make sure your phone is in search or discovery mode.
HFL automatically searches for a Bluetooth® device.
6. When your phone appears on the list, select it by pressing the selector knob.

If your phone doesn't appear, select Phone Not Found? and search for Bluetooth® devices using your phone. From your phone, select HandsFreeLink®.

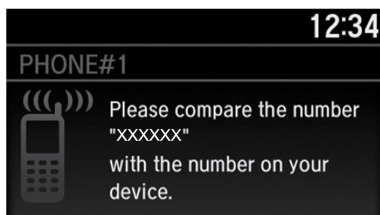
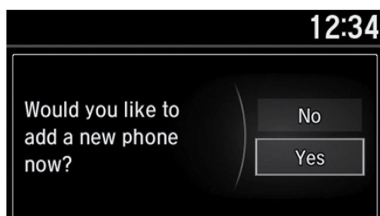

*1 - If equipped

7. The system gives you a pairing code on the audio/information screen. Confirm if the pairing code on the screen and your phone match. This may vary by phone.
8. A notification appears on the screen if pairing is successful.

Making a Call

You can make calls by inputting any phone number, or by using the imported phonebook, call history, speed dial entries, or redial.

■ Dialing a Number

Applicable laws may prohibit the operation of handheld electronic devices while operating a vehicle.

Models with Color Audio

Enter a 10-digit phone number to call. Use the selector knob to make and enter selections. This method is inoperable while the vehicle is moving.

1. Press the pick up button or the hang up button.
2. Rotate the selector knob to select Dial, then press the selector knob.
3. Rotate the selector knob to select a number, then press the selector knob.
4. Rotate the selector knob to select the hang up button, then press the selector knob.

Dialing starts automatically.



■ Using the Phonebook

When your phone is paired, its phonebook is automatically imported to the system.

This method is inoperable while the vehicle is moving.

Models with Color Audio

1. Press the pick up button or the hang up button.
2. Rotate the selector knob to select Phonebook, then press the selector knob.



3. The phonebook is stored alphabetically.

Rotate the selector knob to select the initial, then press the selector knob.

4. Rotate the selector knob to select a name, then press the selector knob.
5. Rotate the selector knob to select a number, then press the selector knob.

Dialing starts automatically.



■ Storing Speed Dial Entries

Store up to 20 numbers for quick dialing. Use the selector knob to make and enter selections. To store a speed dial number:

1. Press the pick up button or the hang up button.
2. Rotate the selector knob to select Speed Dial, then press the selector knob.



3. Rotate the selector knob to select Add New, then press the selector knob.
4. Rotate the selector knob to select a place to choose a number from, then press the selector knob.

From Call History:

Select a number from the call history. From Phonebook:

Select a number from the connected cell phone's imported phonebook.

From Phone Number:

Input the number manually.

5. When the speed dial is successfully stored, you are asked to create a voice tag for the number. Rotate the selector knob to select Yes or No, then press the selector knob.
6. Using the talk button, follow the prompts to say the name for the speed dial entry.

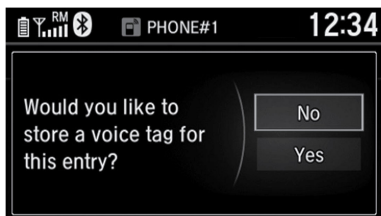

■ Using Speed Dial

Models with Color Audio

Make calls quickly using stored speed dial entries or call history numbers.

1. Press the Phone button.
2. Rotate the selector knob to select Speed Dial, then press the selector knob.
3. Rotate the selector knob to select a number, then press the selector knob.

Dialing starts automatically.



SMS Text Messaging and E-Mail*1

HFL can display newly received text messages as well as the last 20 messages received on a linked cell phone. Each received message can be read aloud and replied to using a fixed common phrase.

1. Select the system status icon.

The status area appears.

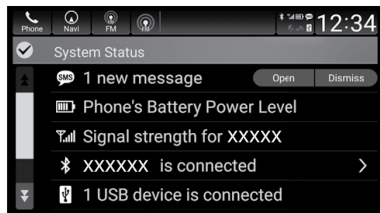

**1 - If equipped*

2. A pop-up appears and notifies you of a new text message.

The text message is displayed.

3. Select Open to display the message.
4. Select Play to listen to the message. To discontinue the message read-out, select Stop.

