

### Road Departure Mitigation (RDM)

Alerts and helps to assist you if the system determines a possibility of your vehicle unintentionally crossing over detected lane markings and/or leaving the roadway altogether while driving between 45-90 mph (72-145km/h).

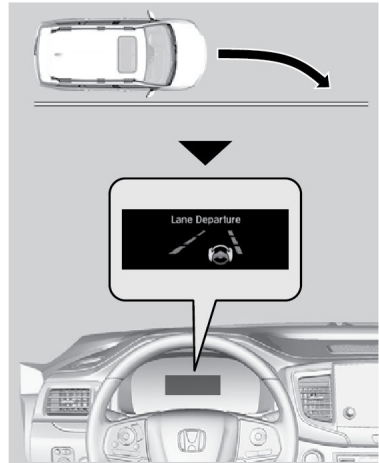

## ■ Turning the System On or Off

Press the RDM button to turn the system on or off. A green indicator appears on the button when the system is on.

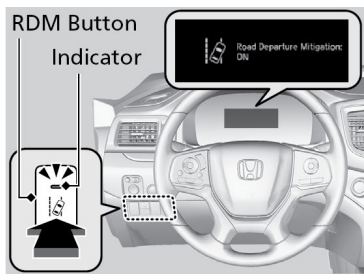

## ■ Changing Settings

### Models with Color Audio

1. Press the Home button.
2. Select Settings.
3. Select Driver Assist System Setup.
4. Select Road Departure Mitigation Setting.

### Models with Display Audio

1. From the Home screen, select Settings.
2. Select Settings.
3. Select Driver Assist System Setup.
4. Select Road Departure Mitigation Setting.

## ■ Important Safety Reminder

The RDM system has limitations. Over-reliance on it may result in a collision. It is always your responsibility to keep your vehicle within the driving lane.