

### Remote Engine Start\*1

You can remotely start the engine on using the smart entry remote.

When started remotely, the engine automatically shuts off after 10 minutes of idling and/or the brake pedal and ENGINE START/STOP button have not been pressed simultaneously.

**Note:** Make sure the vehicle is in a safe location when using remote engine start (i.e., a well-ventilated area, away from any flammable materials).

#### ■ Starting the Engine

*\*1 - If equipped*

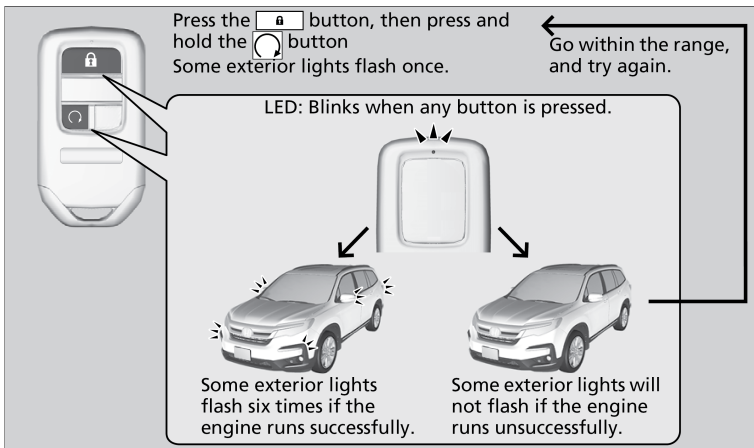

- The engine runs for up to 10 minutes. To extend the run time for another 10 minutes, repeat the procedure during the initial 10 minutes.
- The amber LED blinks, then the green LED comes back on if a 10-minute extension request was transmitted successfully.
- After pressing the (lock) button, wait for the green LED to blink. This indicates that the all the doors and the trunk are locked.

## ■ Stopping the Engine

Go within the range,  
and try again.

The exterior lights will not flash when the remote  
is out of the smart entry system range.  
The engine will not stop.



Press and hold the



button for  
one second.



The exterior lights flash once if the engine stops  
successfully.

### **WARNING**

Carbon monoxide gas is toxic and can rapidly accumulate in closed or even partly enclosed areas.

Breathing it can cause unconsciousness and even kill you.

Never use the remote engine starter with the vehicle parked in a garage or other areas with limited ventilation.