

AUDIO AND CONNECTIVITY

Learn how to operate the vehicle's audio system.

Basic Audio Operation

Connect audio devices and operate buttons and displays for the audio system.

■ USB Port

Connect a USB flash drive or other audio device, such as an iPod or iPhone^{*14}. Install the flash drive or cable connector to the USB port.

On the front console compartment

Models with Display Audio

The USB port (1.5A) is for charging devices, playing audio files and connecting compatible phones with Apple CarPlay or Android Auto.

Models with color audio system

The USB port (1.0A) is for playing audio files on a USB flash drive, connecting a mobile phone, and charging devices.

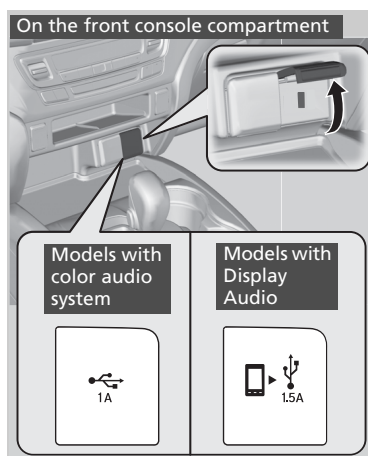

In the console compartment

Models with Display Audio

The USB port (1.0A) is for playing audio files on a USB flash drive, connecting a mobile phone, and charging devices.

Models with color audio system

The USB port (2.5A) is only for charging devices.

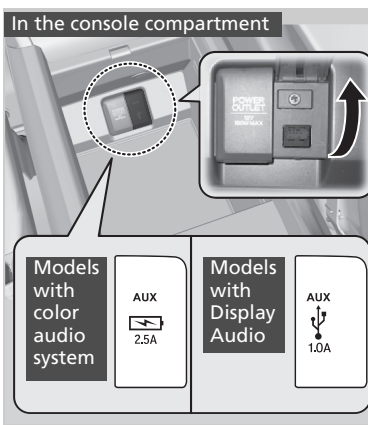

^{*14} - iPod and iPhone are trademarks of Apple, Inc.

On the back of the console compartment*1

The USB ports (2.5A) are only for charging devices.

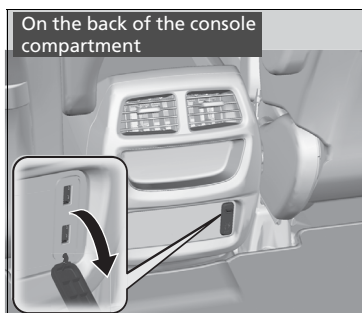

■ Auxiliary Input Jack

Connect the standard audio devices with a 1/8 inch (3.5 mm) stereo miniplug.

1. Open the AUX cover.
2. Insert the miniplug attached to the audio device into the jack. The audio system switches to AUX mode. Use the device to control the audio.

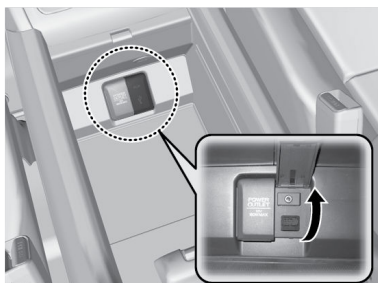

■ Accessory Power Socket

Open the socket cover to use power when the vehicle is on.

Power sockets are located in the front console and inside the center console.

NOTICE

Do not insert an automotive type cigarette lighter element. This can overheat the power socket.

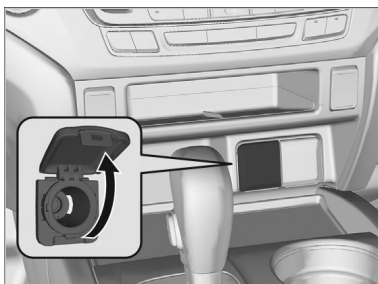

■ Steering Wheel Controls

You can operate certain functions of the audio system using the steering wheel controls.

*1 - If equipped

SOURCE button: Cycle through available audio modes.

</> buttons: Change presets, tracks, albums, or folders.

: Change presets, tracks, albums, or folders.

+/- buttons: Adjust audio volume.

: Adjust audio volume.

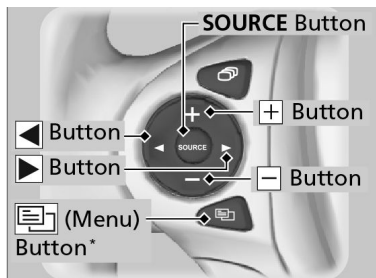

Menu button*: From the audio screen, press to choose options for the current audio mode. Use the +/- buttons and the SOURCE button to scroll and enter selections.

FM/AM/SiriusXM Radio

Press < or > for the next or previous station.

Press and hold < or > for the next or previous strong station.

CD/iPod/USB/Bluetooth Audio

Press < or > for the next or previous track.

Press and hold < or > for the next or previous folder (CD/USB).

Pandora (U.S. only)

Press > for the next song.

Press and hold < or > for the next or previous station.

■ Adjusting the Sound

Adjust various sound settings.

Models with color audio system

Use the selector knob to make and enter selections.

1. Press the Sound button.
2. Select a sound mode to change, and adjust it using the selector knob.
3. Press the Back button to exit the menu.

Models with display audio

Make selections using the touchscreen

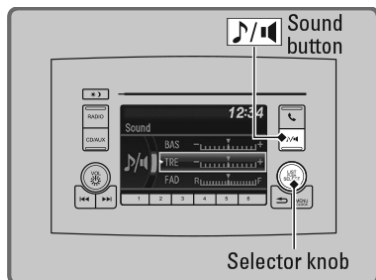

1. From the HOME screen, select Settings.
2. Select Audio.
3. Select Sound.
4. Select the tabs to change the sound mode and adjust the setting.
5. Select OK when complete.

