

■ Customizing Door Lock and Unlock Settings

Customize the auto door lock and unlock settings to your preference.

Models with Color Audio

Using the Audio/Information Screen

1. Press the **MENU/CLOCK** button, then select **Settings**.
2. Select **Vehicle Settings**.
3. Select **Door/Window Setup**.
4. Select **Auto Door Lock** or **Auto Door Unlock** to customize.

Models with Display Audio

Using the Audio/Information Screen

1. Press the **Home** button.
2. Select **Settings**.
3. Select **Vehicle**.
4. Select **Door/Window Setup**.
5. Select **Auto Door Lock** or **Auto Door Unlock** to customize.

■ Walk Away Auto Lock®

When you walk away from the vehicle while carrying the remote transmitter, the doors and trunk automatically lock if the following conditions are met:

- The remote transmitter is within a range of 5 feet (1.5 m).
- All doors and the trunk are closed.
- There are no remote transmitters inside the vehicle.

Follow these steps:

1. Exit the vehicle, close the door and stay near it. Listen for a beep. The system is activated.
2. Walk at least 5 feet (1.5 m) away.
3. Listen for a beep and look for the lights to flash. The doors lock.

The auto lock function is set to OFF as the factory default setting. It can be set to ON using the audio/information

screen. If you set the auto lock function to ON, only the remote transmitter

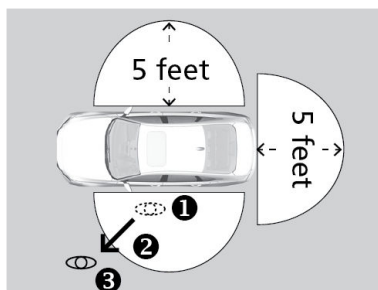

that was used to unlock the driver's door prior to the setting change can activate auto lock. To turn on this feature, follow the steps below:

Models with Display Audio

Using the Audio/Information Screen

1. Press the HOME button then select **Settings**.
2. Select **Vehicle**.
3. Select **Door/Window Setup**.
4. Select **Walk Away Auto Lock®**, then select **ON**.

Door Operation

There are a few different ways of unlocking the doors from inside the vehicle.

■ Using the Lock Tab

To unlock: Pull the lock tab rearward. When you unlock either front door using the lock tab, the specific door (driver's or passenger's) unlocks.

To lock: Push the lock tab forward. When you lock the door using the lock tab on the driver's door, all the other doors and the fuel fill door lock at the same time. When you lock the door using the lock tab on the front passenger's door, only that door locks.

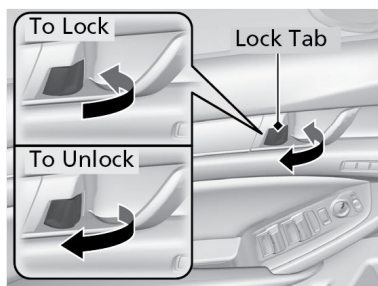

■ Using the Front Door Inner Handle

Pull the front door inner handle. The door unlocks and opens in one motion. Unlocking and opening the driver's door from the inner handle unlocks all other doors.

Do not pull a front door inner handle while the vehicle is moving.

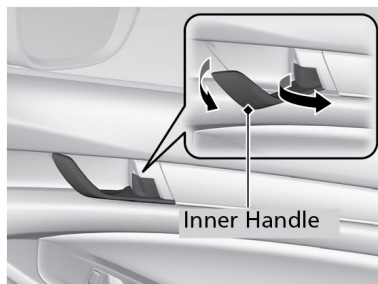

■ Using the Master Door Lock Switch

To unlock: Press the unlock side of the switch to unlock all doors, the fuel fill door, and the trunk.

To lock: Press the lock side of the switch to lock all doors, the fuel fill door, and the trunk.

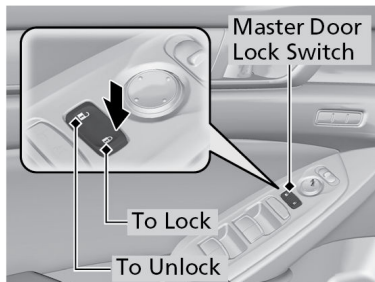

■ Childproof Door Locks

The childproof door locks prevent the rear doors from being opened from the inside regardless of the position of the lock tab.

Slide the lever in the rear door to the lock position, and close the door.

Open the door using the outer door handle.

Note: To open the door from the inside when the childproof door lock is on, put the lock tab in the unlock position, lower the rear window, put your hand out of the window, and pull the outside door handle.

