

AUDIO AND CONNECTIVITY

How to operate the vehicle's audio system.

Basic Audio Operation

Connect audio devices and operate buttons and displays for the audio system.

Note: When the screen is viewed through polarized sunglasses, a rainbow pattern may appear on the screen due to optical characteristics of the screen.

■ USB Port

Install the iPod® USB connector or the USB flash drive to the USB port.

Models with Color Audio

In the Center Pocket

The USB port (1.0A) is for playing audio files on a USB flash drive, connecting a cellular phone and charging devices.

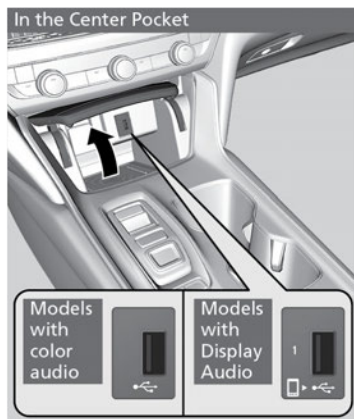

Models with Display Audio

The USB port (2.5A) is for charging devices, playing audio files and connecting compatible phones with Apple CarPlay® or Android Auto™.

In the console compartment

The USB port (2.5A) is for charging devices, playing audio files and connecting compatible phones with Apple CarPlay® or Android Auto™.

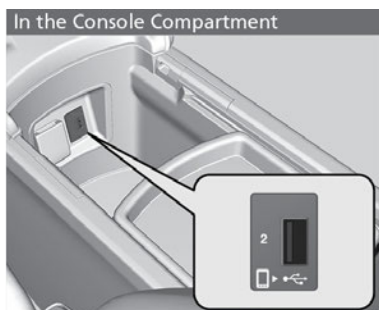

Rear of the center console*¹

The USB ports (2.5A) are only for charging devices.



* Not available on all models

Tip: To prevent any potential issues, be sure to use an Apple MFi Certified Lightning Connector for Apple CarPlay® or a USB cable certified by USB-IF to be compliant with USB 2.0 Standard for Android Auto™.

■ Accessory Power Sockets

The accessory power sockets can be used when the power mode is in ACCESSORY or ON.

Center pocket

Open the cover to use it.

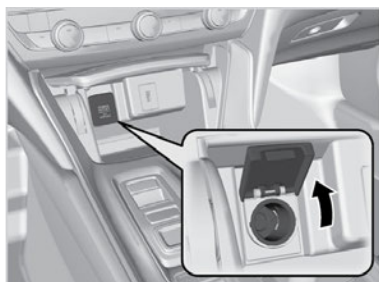

**1 - If equipped*

Console compartment

Open the console lid and the cover to use it.

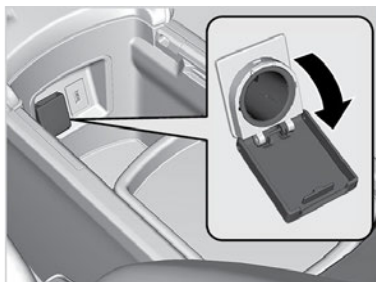

NOTICE

Do not insert an automotive type cigarette lighter element. This can overheat the power socket.

■ Wireless Charger*1

To use the wireless charger, the power mode must be in ACCESSORY or ON. Charge a compatible device on the area indicated by the wireless battery icon mark as follows:

1. To turn the system on and off, press and hold the power button.

When the system is activated, the green indicator light comes on.

2. Place the device you want to charge on the charging area.

The system will automatically start charging the device, and the amber indicator light will come on.

Make sure that the device is compatible with the system, and placed with the chargeable side in the center of the charging area.

3. When charging is completed, the green indicator light will come on. Depending on the device, the amber indicator light will stay on.

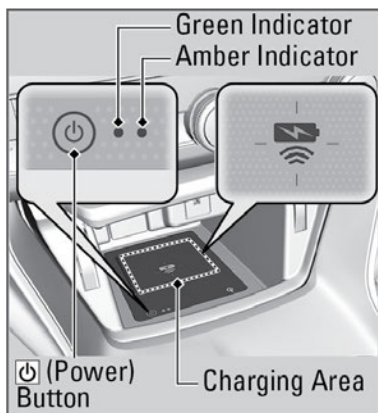

*1 - If equipped

FCC statement

This product complies with the appropriate requirements or the required standards of FCC (Federal Communication Commission), described below:

This device complies with Part 18 of the FCC rules.

This equipment generates, uses, and can radiate radio frequency energy and, if not installed and used per the instructions, may cause harmful interference to radio communications.

In order to use safely:

- Remove any metal objects from the charge pad before charging a device.
- Do not open the charger case.
- Do not use the charger if it malfunctions. Contact your dealer.

If the charger interferes with radio communications, attempt to correct the interference:

- Press and hold the switch on the charger for a few seconds to turn off the charger.

The wireless battery icon appears on the audio/information screen when the device is being charged by the wireless charger.

⚠ CAUTION

Metal objects between the charge pad and the device to be charged will get hot and can burn you.

- Always remove foreign objects from the charge pad before charging the device.
- Be sure the surface is clear of dust and other debris before charging.
- Do not spill liquids (i. e. water, drinks, etc.) on the charger and the device.
- Do not use oil, grease, alcohol, benzine or thinner for cleaning the charge pad.
- Do not cover the system with towels, clothing, or other objects while charging etc.
- Avoid spraying aerosols which may come in contact with the charge pad surface.

NOTICE

Do not place any magnetic recording media or precision machines within the charging area while charging.

The data on your cards such as credit cards can be lost because of the magnetic effect. Also precision machines such as watches can go wrong.

■ Audio Remote Controls

You can operate certain functions of the audio system using the steering wheel controls.

Models with Color Audio

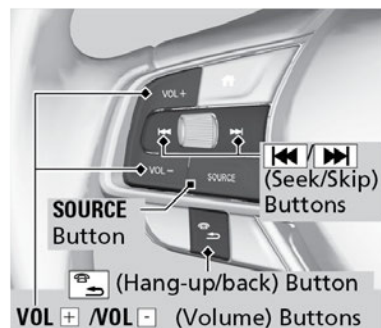

Volume Buttons (+/-): Press to adjust the volume.

SOURCE Button: Press to cycle through the available audio modes.

Models with Display Audio

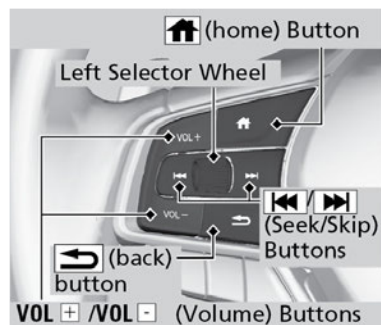

Volume Buttons (+/-): Press to adjust the volume.

Left Selector Wheel: Roll up/down to cycle through the available audio modes.

■ Adjusting the Sound

Models with Color Audio

Press the sound button, and rotate the selector knob to scroll through the following choices:

- Bass
- Middle
- Treble
- Fader
- Balance
- Speed-sensitive Volume Compensation

Rotate the selector knob to adjust the sound setting, then press it.



Models with Display Audio

1. Press the Home button.
2. Select an audio source icon.
3. Select Sound.
4. Select the setting you want.
5. Select Save.

Select an item from the following choices:

- Bass / Treble: Treble, Midrange, Bass, subwoofer*¹
- Balance / Fader: Balance, Fader
- DTS Neural Surround*¹: DTS Neural Surround™
- Speed Volume Compensation: Speed Volume Compensation (SVC)

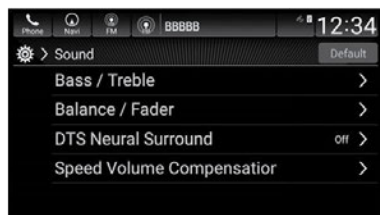

*¹ - If equipped

Audio/Information Screen

Displays each mode status and wallpaper. From this screen, you can go to various setup options.

■ Switching the Display

Models with Color Audio

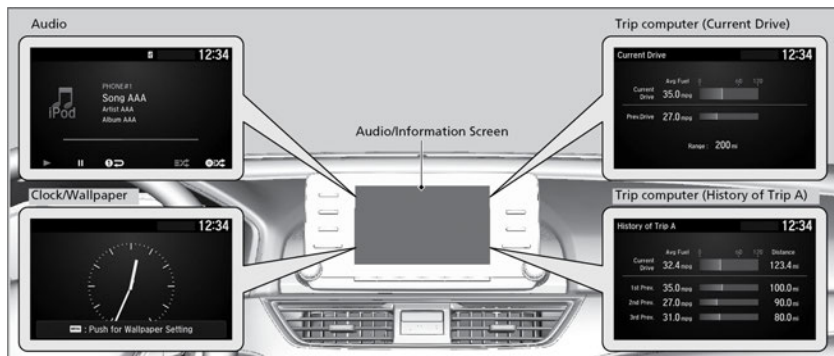

1. Press the **MENU/CLOCK** Button.
 2. Select **Settings**.
 3. Select **Display Change**.
 4. Select **Clock/Wallpaper**.
- If you want to return to the audio display, select **Audio**.

AUDIO AND CONNECTIVITY

Models with Display Audio

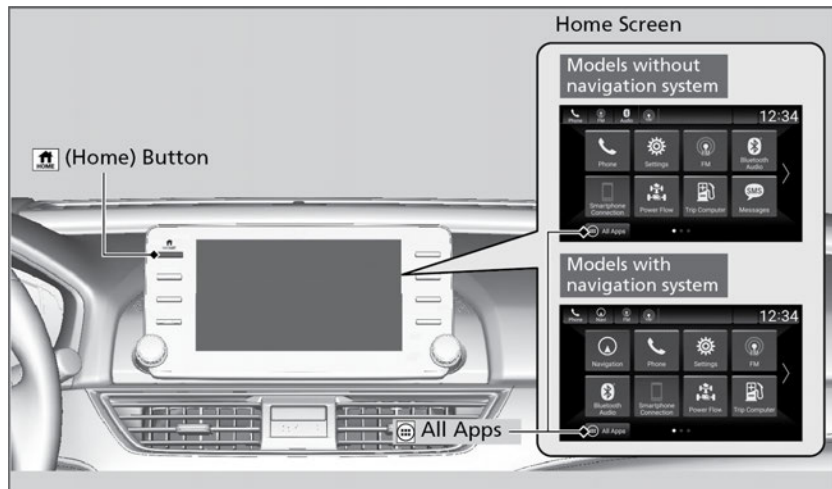

1. Press the **Home** button to go to the home screen.

Color Audio System

Use the buttons to control the color audio system.



Display Audio System

Use simple gestures - including touching, swiping and scrolling - to operate certain audio functions.



Note: Some items may be grayed out during driving to reduce the potential for distraction. You can select them when the vehicle is stopped or use voice commands.

Wearing gloves may limit or prevent touchscreen response.

AM/FM Radio

Models with Color Audio

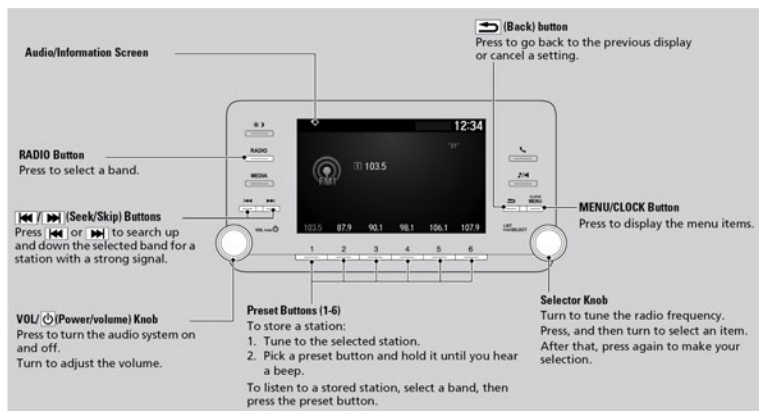

Models with Display Audio

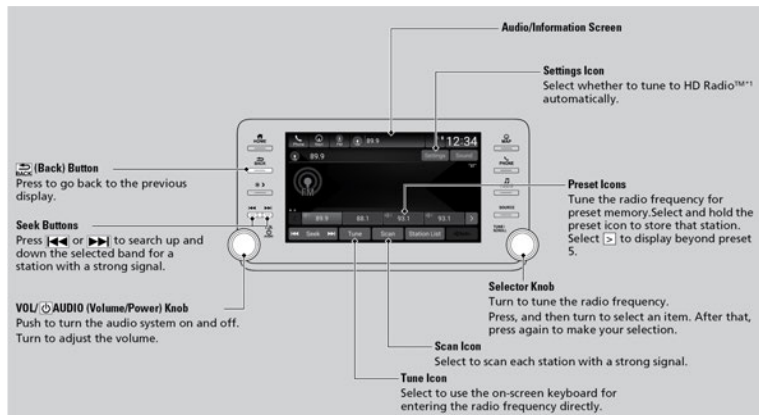

SiriusXM®*1

Available on a subscription basis only. For more information or to subscribe, contact your dealer, or visit www.sirius.com/subscribenow (U.S.) (1-855-236-9236) or www.sirius.ca/subscribe-now (Canada) (877-209-0079).

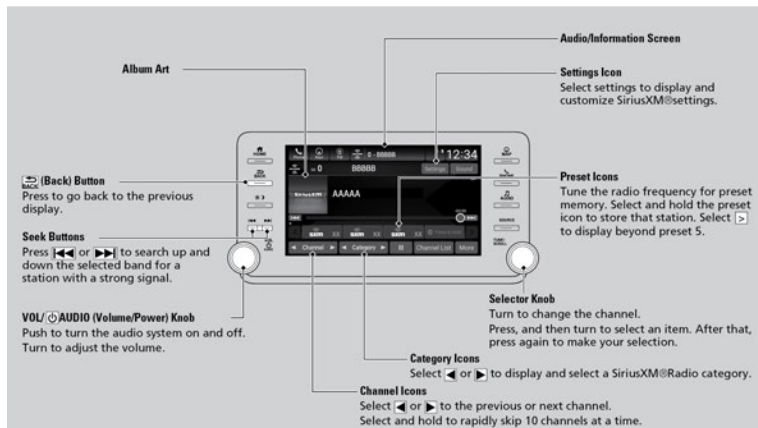

**1 - If equipped*

Bluetooth® Audio

Play audio from your compatible phone when it is paired to *Bluetooth®* HandsFreeLink® (see Pairing a Phone). Visit handsfreelink.com to check phone compatibility. Canada customers can phone (855) 490-7351 for any HandsFreeLink® related inquiry.

Models with Color Audio

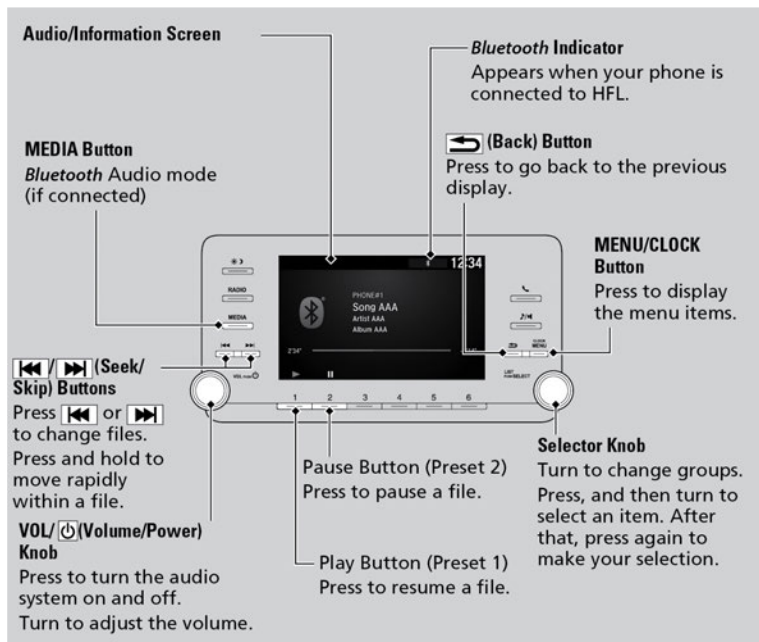

Models with Display Audio

