

VEHICLE CONTROLS

Various controls necessary for operating and driving the vehicle.

Using the Key or Remote Transmitter

Lock or unlock the doors and hatch.

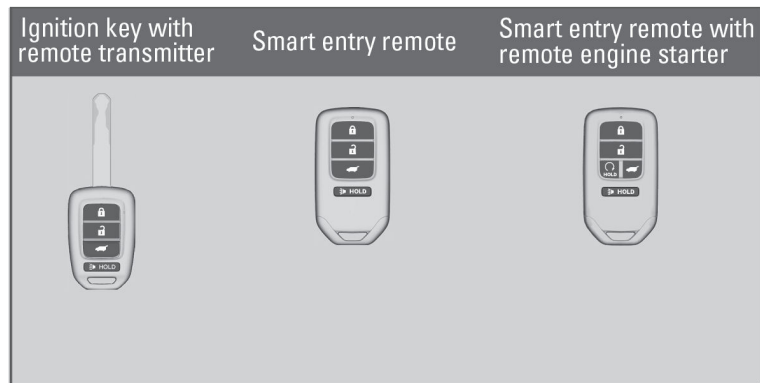

NOTICE

Leaving the remote transmitter in the vehicle can result in theft or accidental movement of the vehicle. Always take it with you whenever you leave the vehicle unattended.

Smart Entry System^{*1}

When you carry the remote transmitter, in a pocket or purse and it is outside the vehicle and within range (about 32 inches or 80 cm), you can lock or unlock the doors, and open the hatch without handling the transmitter.

^{*1} - If equipped

■ Unlocking/Locking the Doors and Hatch

To unlock: Grab the driver's door handle to unlock the driver's door. Grab the front passenger's door handle to unlock all the doors and the hatch. You can customize this feature's behavior.

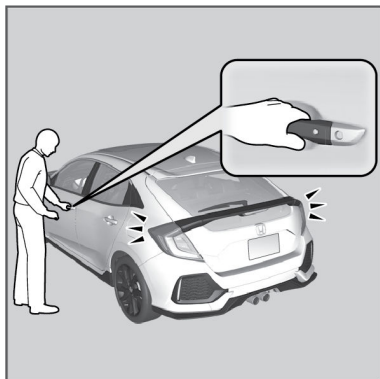

Press the hatch release button.

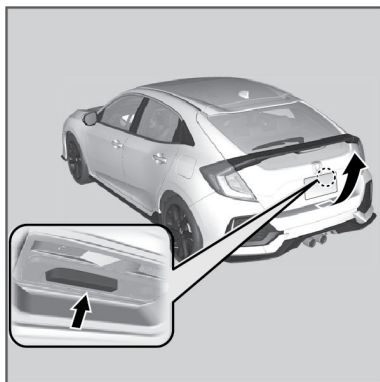

To lock: Press the door lock button on the front door or on the hatch.

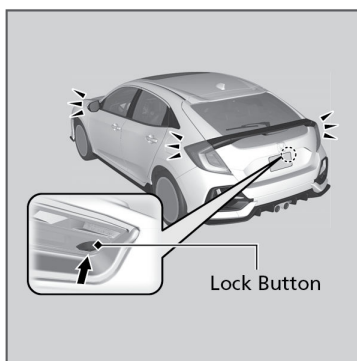

Note: System range is affected by radio signals from other devices (for example, cell phones or tablets) so for best results, carry the remote transmitter separately from these devices.

■ Customizing Door Lock and Unlock Settings

Customize the auto door lock and door unlock settings to your preference.

Models with Color Audio

Using the Driver Information Interface

1. Press the **Display/Information** button, then select **Vehicle Settings**. Press the **ENTER** button.
2. Select **Door Setup**.
3. Select **Auto Door Lock** or **Auto Door Unlock** then select an option.

Models with Display Audio

Using the Audio/Information Screen

1. Press the **Home** button.
2. Select **Settings**.
3. Select **Vehicle**.
4. Select **Door/Window Setup**.
5. Select **Auto Door Lock** or **Auto Door Unlock** then select an option.

■ Walk Away Auto Lock®

When you walk away from the vehicle while carrying the remote transmitter, the doors and hatch can automatically lock if the following conditions are met:

- The remote transmitter is within a range of 5 feet (1.5 m).
- All doors and the hatch are closed.
- There is not an additional remote transmitter inside the vehicle.

Follow these steps:

1. Exit the vehicle, close the door(s) and stay near it. Listen for a beep. The system is activated.
2. Walk at least 5 feet (1.5 m) away.
3. Listen for a beep and look for the lights to flash. The doors lock.

The auto lock function is set to OFF as the factory default setting. It can be set to ON using the audio/information screen. If you set the auto lock function

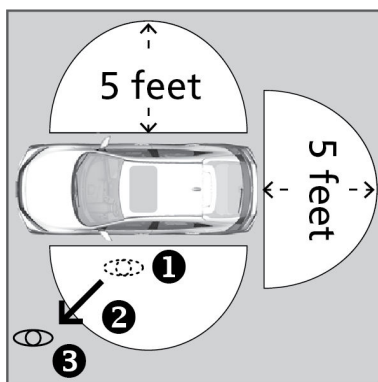

VEHICLE CONTROLS

to ON, only the remote transmitter that was used to unlock the driver's door prior to the setting change can activate auto lock. To turn on this feature, follow the steps below:

Models with Display Audio

1. Press the HOME button then select **Settings**.
2. Select **Vehicle**.
3. Select **Door/Window Setup**.
4. Select **Walk Away Auto Lock[®]**, then select **ON**.

Smart Entry System Battery Strength

Models with Smart Entry System

If the battery life in your remote transmitter is weak, a message appears in the driver information interface with information on how to start the engine.

1. Touch the back of the remote transmitter to the ENGINE START/STOP button while the indicator is flashing.
2. With the brake pedal or clutch pedal pressed, press the ENGINE START/STOP button within 10 seconds after the beeper sounds and the ENGINE START/STOP button changes from flashing to on.

