

Adaptive Cruise Control (ACC)*1

Helps maintain a constant vehicle speed and a set following-interval behind a vehicle detected ahead of yours, without you having to keep your foot on the brake or the accelerator.

**1 - If equipped*

When to use

The camera is located behind the rearview mirror.

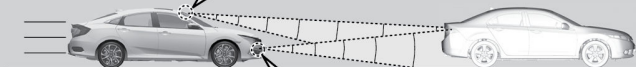
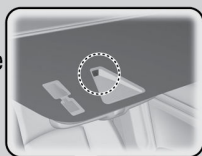

The radar sensor is in the lower bumper. Be careful not to have the radar sensor cover strongly impacted.

Vehicle speed for adaptive cruise control: Desired speed in a range above roughly 25 mph (40 km/h) ~.

Gear position for ACC: In 2 or higher position.

WARNING

Improper use of ACC can lead to a crash.

Use ACC only when traveling on open highways in good weather.

WARNING

ACC has limited braking capability.

When your vehicle speed drops below 22 mph (35 km/h), ACC will automatically cancel and no longer will apply your vehicle's brakes.

Always be prepared to apply the brake pedal when conditions require.

■ Activating and Setting the Vehicle Speed

1. Press the MAIN button. The ACC indicator appears.

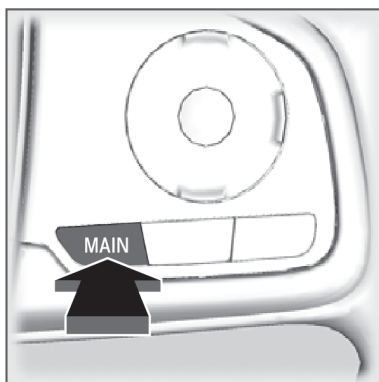

2. Accelerate to the desired speed.

Above 25 *mph* (40 *km/h*): Take your foot off the pedal and press the **SET** button to set the speed. Below 25 *mph* (40 *km/h*) Press the **SET** button to set the speed at 25 *mph* (40 *km/h*).

Note: When you completely disable VSA®, you cannot use ACC.

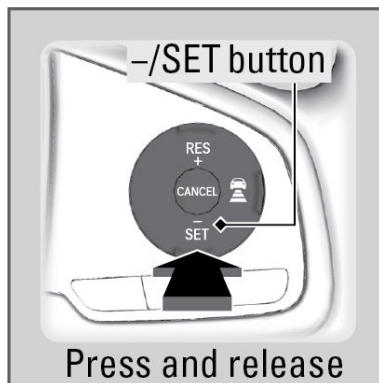

■ Adjusting the Vehicle Speed

Increase or decrease the vehicle speed using the **RES/+** or **SET/-** button on the steering wheel.

1. Each time you press the **RES/+** or **-/SET** button, the vehicle speed is increased or decreased by about 1 *mph* or 1 *km/h* accordingly.
2. If you keep pressing the **RES/+** or **-/SET** button, the vehicle speed increases or decreases by about 5 *mph* or 5 *km/h* accordingly.

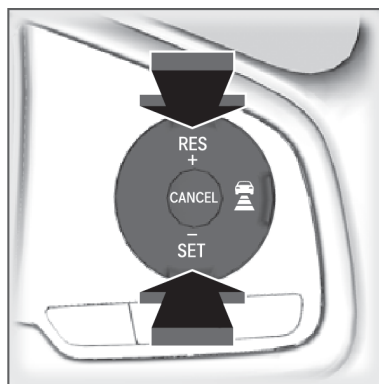

■ Adjusting the Vehicle Distance

Press the Interval button to change the ACC following-interval. Each time you press the button, the following-interval setting cycles through extra long, long, middle, and short following-intervals.

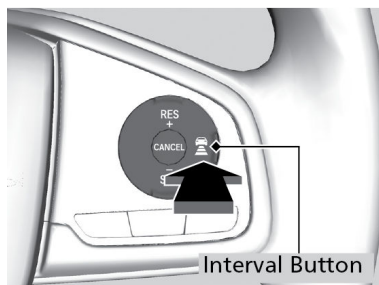

■ During Operation

ACC monitors if a vehicle ahead of you enters the ACC range. If a vehicle is detected doing so, the ACC system maintains or decelerates your vehicle's set speed in order to keep the vehicle's set following-interval from the vehicle ahead.

If a vehicle detected ahead of you slows down abruptly or if another vehicle cuts in front of you, the beeper sounds and a message appears on the driver information interface to alert you.

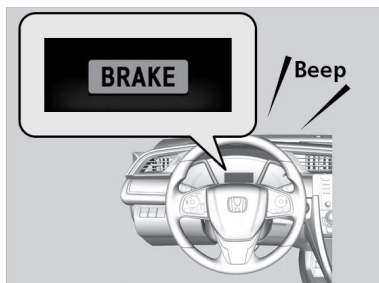

■ Canceling ACC

To cancel ACC, do any of the following:

- Press the **CANCEL** button.
- Press the **MAIN** button.

ACC indicator goes off.

- Depress the brake pedal.
- Depress the clutch pedal*¹ for five seconds or more.

Note: When you completely disable VSA[®] while ACC is activated, ACC will automatically be canceled.

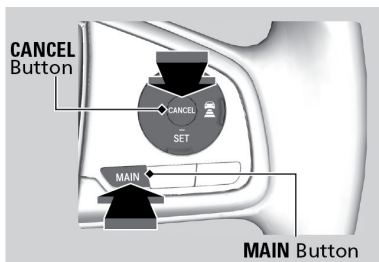

■ Switching to Standard Cruise Control

Press and hold the Interval button for one second.

Cruise Mode Selected appears in the driver information interface for two seconds, and then the mode switches to Cruise.

Press and hold the interval button for one second to switch back to ACC. **ACC Mode Selected** appears on the driver information interface for two seconds.

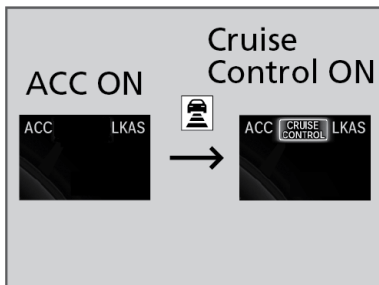

Adaptive Cruise Control (ACC) with Low Speed Follow^{*1}

Helps maintain a constant vehicle speed and a set following interval behind a vehicle detected ahead of yours and, if the detected vehicle comes to a stop, can decelerate and stop your vehicle, without you having to keep your foot on the brake or the accelerator. When ACC with Low Speed Follow slows your vehicle by applying the brakes, your vehicle's brake lights will illuminate.

When to use

The camera is located behind the rearview mirror.

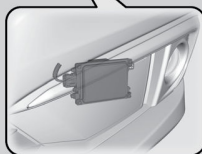
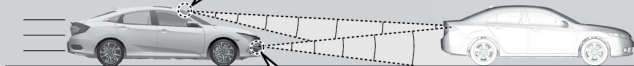
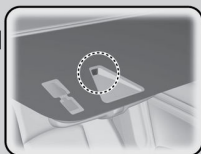

The radar sensor is in the lower bumper. Be careful not to have the radar sensor cover strongly impacted.

- Vehicle speed for ACC with Low Speed Follow: A vehicle is detected ahead within ACC with Low Speed Follow range – ACC with Low Speed Follow operates at speeds up to 90 mph (145 km/h).
 - No vehicle is detected within ACC with Low Speed Follow range – ACC with Low Speed Follow operates at the speed of 25 mph (40 km/h) or above.
- Shift position for ACC with Low Speed Follow: In **D** or **S**.

* Not available on all models

^{*1} - If equipped

■ Activating and Setting the Vehicle Speed

1. Press the **MAIN** button. The ACC indicator appears.

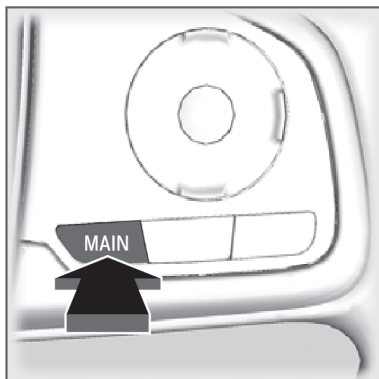

2. Accelerate to the desired speed.

Above 25 *mph* (40 km/h): Take your foot off the pedal and press the **SET** button to set the speed.

Below 25 *mph* (40 km/h) (*Low Speed Follow*): Press the **SET** button to set the speed at 25 *mph* (40 km/h).

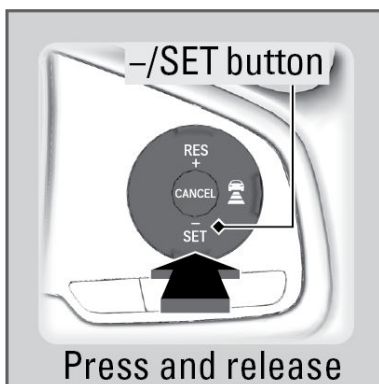

■ Adjusting the Vehicle Speed

Increase or decrease the vehicle speed using the **RES/+** or **SET/-** button on the steering wheel.

- Each time you press the **RES/+** or **-/SET** button, the vehicle speed is increased or decreased by about 1 *mph* or 1 km/h accordingly.
- If you press and hold the **RES/+** or **-/SET** button, the vehicle speed increases or decreases by about 5 *mph* or 5 km/h accordingly.

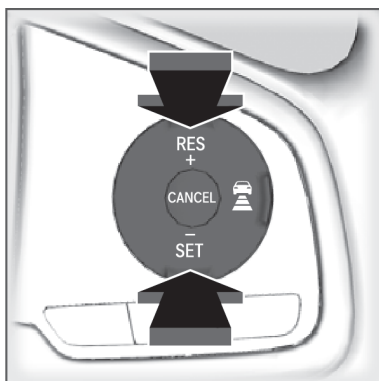

■ Adjusting the Vehicle Distance

Press the Interval button to change the ACC with Low Speed Follow following-interval. Each time you press the button, the following-interval setting cycles through extra long, long, middle, and short following-intervals.

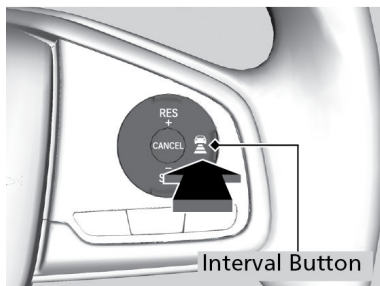

⚠ WARNING

Improper use of ACC with Low Speed Follow can lead to a crash.

Use ACC with Low Speed Follow only when driving on expressways or freeways and in good weather conditions.

■ During Operation

ACC with Low Speed Follow monitors if a vehicle ahead of you enters the ACC with Low Speed Follow range. If a vehicle is detected doing so, the ACC with Low Speed Follow system maintains or decelerates your vehicle's set speed in order to keep the vehicle's set following-interval from the vehicle ahead.

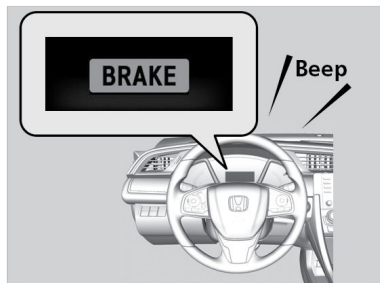

If a vehicle detected ahead of you slows down abruptly or if another vehicle cuts in front of you, the beeper sounds and a message appears on the driver information interface.

⚠ WARNING

ACC with Low Speed Follow has limited braking capability and may not stop your vehicle in time to avoid a collision with a vehicle that quickly stops in front of you.

Always be prepared to apply the brake pedal when conditions require.

■ Canceling ACC with Low Speed Follow

You can press the CANCEL button, MAIN button, or the brake pedal. The ACC with Low Speed Follow indicator goes off.

Certain conditions may cause ACC with Low Speed Follow to cancel automatically. When this happens, the ACC indicator appears on the driver information interface.

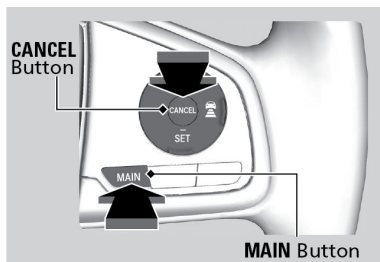

⚠ WARNING

Exiting a vehicle that has been stopped while the ACC with Low Speed Follow system is operating can result in the vehicle moving without operator control.

A vehicle that moves without operator control can cause a crash, resulting in serious injury or death.

Never exit a vehicle when the vehicle is stopped by ACC with Low Speed Follow.

⚠ WARNING

Improper use of ACC with Low Speed Follow can lead to a crash.

Use ACC only when driving on expressways or freeways and in good weather conditions.

⚠ WARNING

ACC with Low Speed Follow has limited braking capability and may not stop your vehicle in time to avoid a collision with a vehicle that quickly stops in front of you.

Always be prepared to apply the brake pedal when conditions require.

■ Switching to Standard Cruise Control

Press and hold the Interval button for one second.

Cruise Mode Selected appears in the driver information interface for two seconds, and then the mode switches to Cruise.

To switch back to ACC with Low Speed Follow, press and hold the interval button again for one second. **ACC Mode Selected** appears on the driver information interface for two seconds.

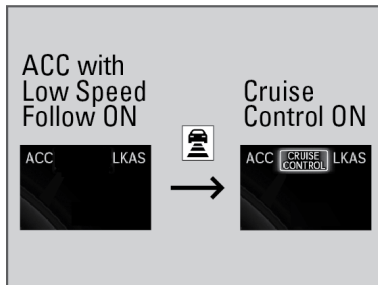

■ Important Safety Reminder

As with any system, there are limits to ACC with Low Speed Follow. Use the brake pedal whenever necessary, and always keep a safe interval between your vehicle and other vehicles.