

# AUDIO AND CONNECTIVITY

How to operate the vehicle's audio system.

## Basic Audio Operation

Connect audio devices and operate buttons and displays for the audio system.

**Note:** When the screen is viewed through polarized sunglasses, a rainbow pattern may appear on the screen due to optical characteristics of the screen.

### ■ USB Port

Your vehicle comes supplied with a USB extension cable that runs from the USB port up through to the front console.

#### Models with Color Audio

The USB port (1.0A) is for playing audio files on a USB flash drive and connecting a cellular phone and charging device.

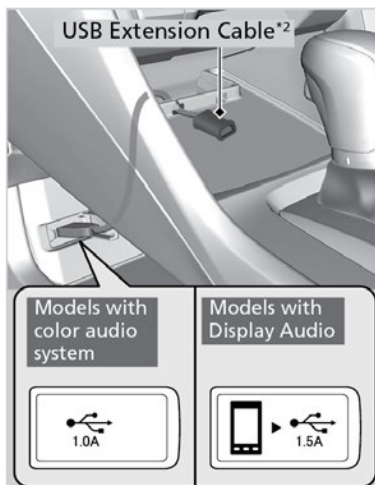

\*2: U.S. models only.

#### Models with Display Audio

The USB port (1.5A) is for charging devices, playing audio files and connecting compatible phones with Apple CarPlay® or Android Auto™.

**In the console compartment\***<sup>1</sup>

*\*1 - If equipped*

The USB port (1.0A) is for playing audio files on the USB flash drive and connecting a cellular phone and charging device.

Move the removable beverage holder tray rearward.

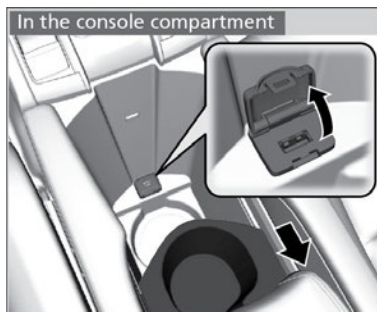

**Tip:** To prevent any potential issues, be sure to use an Apple MFi Certified Lightning Connector for Apple CarPlay® or a USB cable certified by USB-IF to be compliant with USB 2.0 Standard for Android Auto™.

### ■ Accessory Power Socket

There is an accessory power socket in the front console panel. It can be used when the vehicle is ON or in ACCESSORY Mode.

Open the cover to use it.

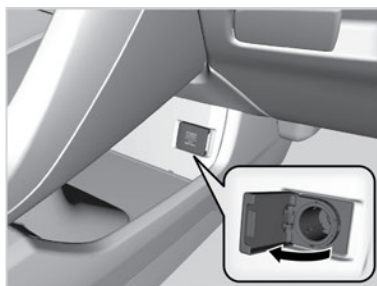

## NOTICE

Do not insert an automotive type cigarette lighter element. This can overheat the power socket.

### ■ Adjusting the Sound

#### Models with Color Audio

Press the sound button, and rotate to scroll through the following choices:

- Bass
- Middle
- Treble
- Fader
- Balance
- Speed-sensitive Volume Compensation



### Models with Display Audio

1. Press the Sound button.
2. Select Menu
3. Select Sound.

Select a tab from the following choices:



- BAS-MID-TRE: Bass, Middle, Treble
- FAD-BAL-SUBW\*<sup>1</sup>: Fader, Balance, Subwoofer\*<sup>1</sup>
- SVC-Neural\*<sup>1</sup>: Speed Volume Compensation, DTS Neural Surround™\*<sup>1</sup>

### ■ Audio Remote Controls

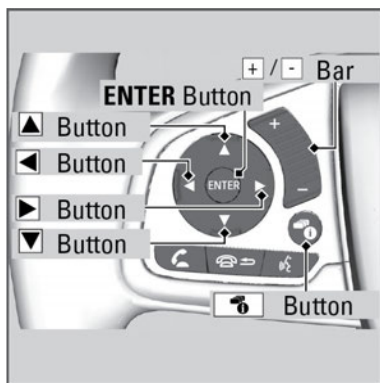

**Volume Bar (+/-):** Press the +/- at the ends of the bar to adjust the volume.

**Up/Down Arrows:** Press to cycle through the available audio modes.

*\*<sup>1</sup> - If equipped*

## Audio/Information Screen

Displays each mode status and wallpaper. From this screen, you can go to various setup options.

### ■ Switching the Display

#### Models with Color Audio

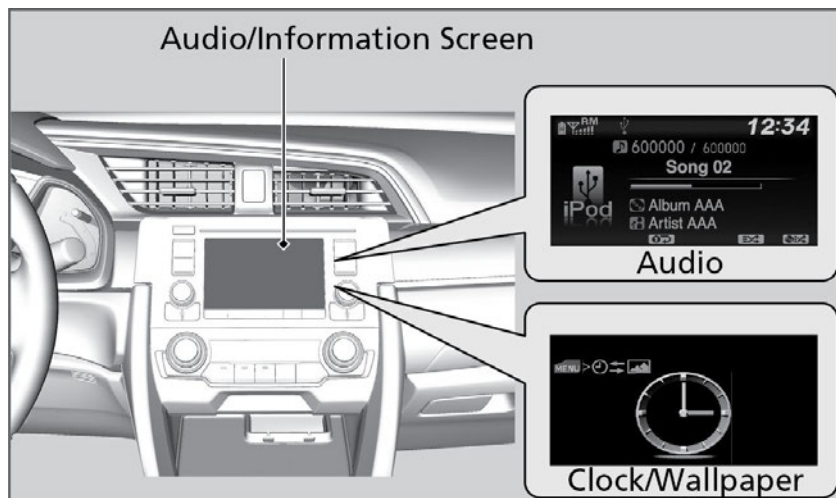

#### Models with Display Audio

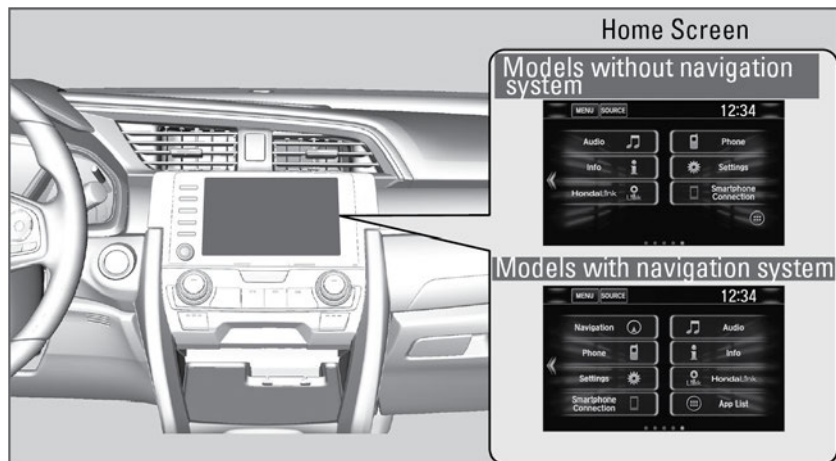

### Color Audio System

Use the buttons to control the color audio system.

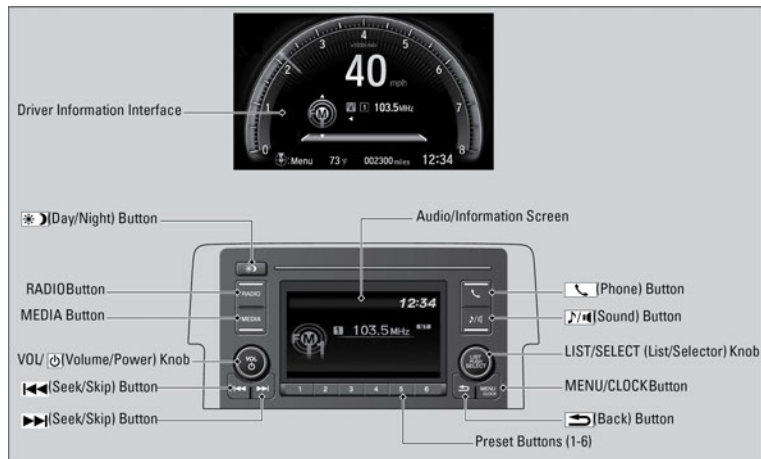

## Display Audio System

Use simple gestures - including touching, swiping and scrolling - to operate certain audio functions.

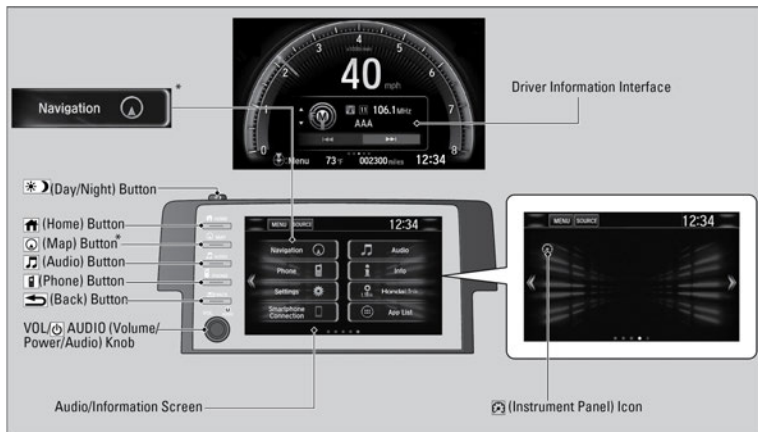

**Note:** Some items may be grayed out during driving to reduce the potential for distraction. You can select them when the vehicle is stopped or use voice commands.

Wearing gloves may limit or prevent touchscreen response.

## AM/FM Radio

### Models with Color Audio

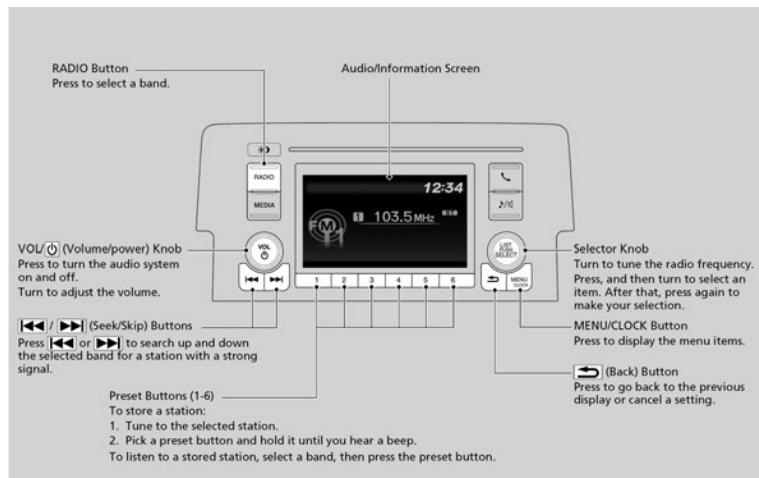

### Models with Display Audio

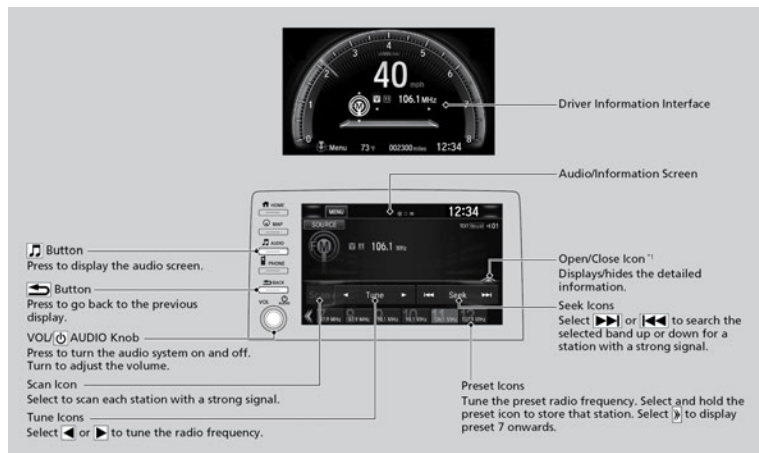

\* 1: Some or all of the lists may not be displayed.

## Bluetooth® Audio

Play audio from your compatible phone when it is paired to **Bluetooth®** HandsFreeLink® (see Pairing a Phone). Visit [handsfreelink.com](http://handsfreelink.com) to check phone compatibility. Canada customers can phone (855) 490-7351 for any HandsFreeLink® related inquiry.

### Models with Color Audio

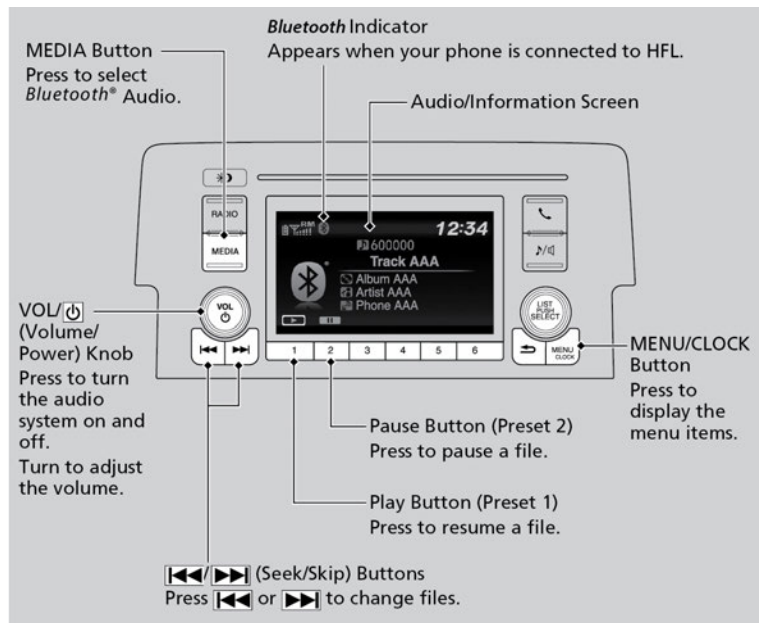



# AUDIO AND CONNECTIVITY

## Models with Display Audio

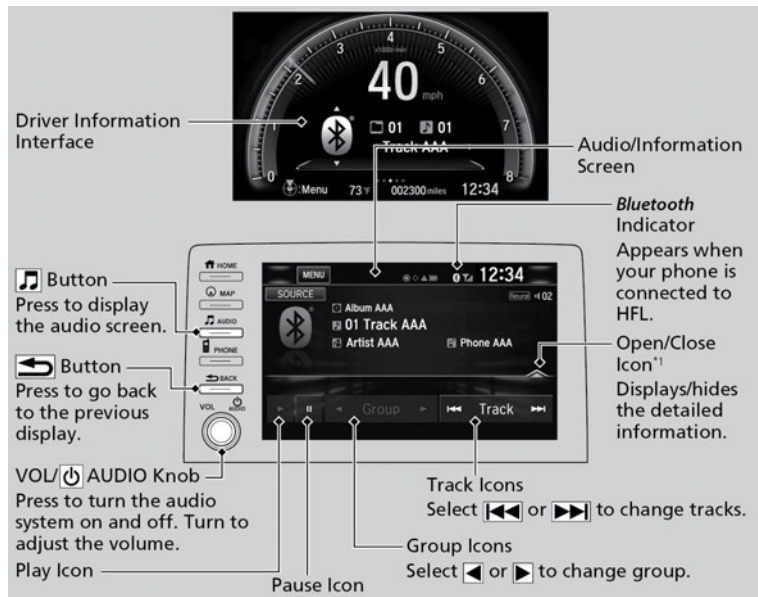

\*1: Depending on the *Bluetooth*® device you connect, some or all of the lists may not be displayed.