

HondaVAC™*1

Clean up dry spills and debris inside your vehicle with the in-car vacuum system.

■ Operating the Vacuum

1. Make sure the vehicle is in Park (P) with the parking brake set. The vacuum can be used with the vehicle ON (engine running) or in Accessory mode (engine NOT running).
2. Start the engine (ON) in a well ventilated, open area outside to minimize the likelihood of carbon monoxide exposure OR set the power mode to ACCESSORY.
3. Open the vacuum storage lid in the driver's side rear cargo area.
4. Pull out the vacuum hose and install one of the attachments if desired.
5. Press the power button and begin to vacuum (dry use only).

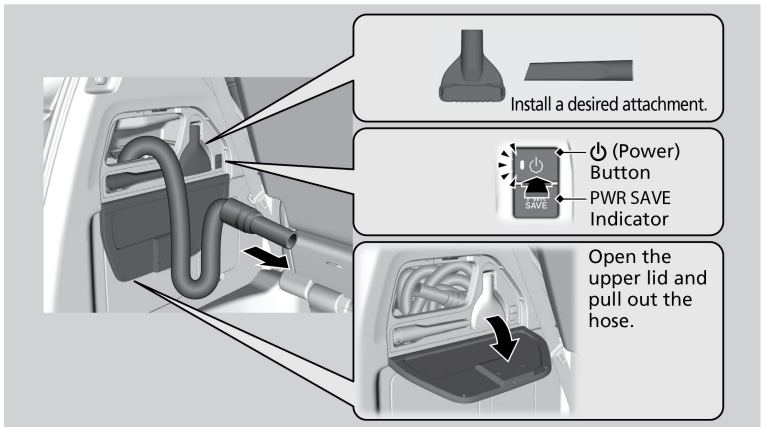

Accessory mode operation (without the engine running)

- After 7 minutes, an intermittent beep begins to sound as a time limit alert.
- After 8 minutes, a beep sounds PWR SAVE indicator comes on, and the vacuum turns off. You must start the engine if you want to continue using the vacuum. The vacuum will restart after the engine has been running for about one minute.

*1 - If equipped

See the Owner's Manual at owners.honda.com (U.S.) or honda.ca (Canada) for instructions on emptying the canister.

WARNING

Engine exhaust contains toxic carbon monoxide that builds up rapidly in enclosed areas. Breathing it can cause unconsciousness and even kill you.

If running the engine to power the vacuum, park the vehicle outdoors and lower all windows to ensure adequate ventilation.

Do not vacuum flammable liquids or in an area with flammable vapors. A fire or explosion could result, causing death or serious injury.

Note: The vacuum is intended for dry use only. Water and other liquids can damage the vacuum.