

BLUETOOTH® HANDSFREELINK®

How to operate the vehicle's hands-free calling system.

Basic HFL Operation

Make and receive phone calls using the vehicle's audio system, without handling your phone. Visit handsfreelink.com to check phone compatibility. Canada customers can phone (855) 490-7351 for any HandsFreeLink® related inquiry.

To reduce the potential for driver distraction, certain manual functions may be inoperable or grayed out while the vehicle is moving. Voice commands are always available.

■ HFL Displays and Controls

Use the controls to enter information and make selections.

Models with Color Audio

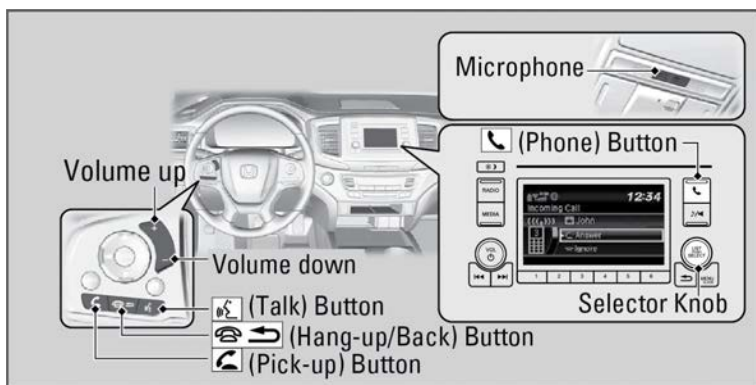

(Pick-Up) button: Press to go directly to the Phone screen or to answer an incoming call.

(Hang-up/Back) button: Press to end a call or to cancel a command.

(Talk) button: Press to call a number with a stored voice tag.

(Phone) button: Press to go directly to the Phone screen.

Selector knob: Rotate the selector knob to select an item on the screen, then press to select.

Models with Display Audio

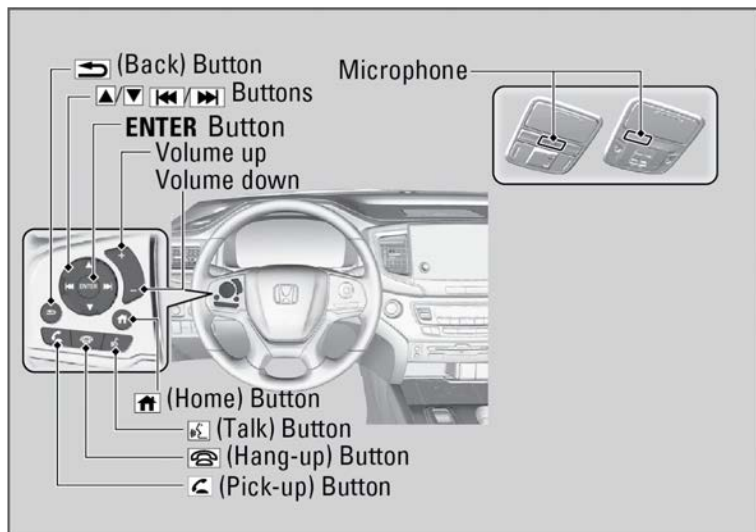

Pick-up button: Press to go directly to the phone screen of the driver information interface, or to answer an incoming call.

Hang-up button: Press to end a call.

Back button: Press to go back to the previous screen, or cancel a command.

Talk button: Press to access Voice Portal.

<</> buttons: Press to select an item displayed on the phone screen of the driver information interface.

ENTER button: Press to call a number listed in the selected item on the phone screen of the driver information interface.

Home button: Press to go back to the home screen of the driver information interface.

■ Talk Button Tips

When using the Talk button, wait for the beep before saying a command. The system recognizes commands listed in the Voice Command Index.

- When using the Talk button, wait until you hear a beep before speaking.
- To bypass the system prompts, simply press the Talk button again to say your command.
- Speak in a clear, natural voice.
- Reduce all background noise.

- Adjust the dashboard vents away from the microphone on the ceiling.
- Close the windows and moonroof*1.

Pairing a Phone

To use hands-free phone and streaming audio functions, you must first pair your phone to the system. This can only be done when the vehicle is stopped. If there is an active connection to Apple CarPlay® (see Apple CarPlay) or Android Auto™ (see Android Auto), pairing of additional Bluetooth-compatible devices is unavailable and Add Bluetooth Device is grayed out from the Bluetooth Device List screen.

■ Pairing the First Phone

Models with Color Audio

Use the selector knob to make and enter selections.

1. Press the Phone button.
2. Select Yes.
3. Make sure your phone is in search or discoverable mode, then press the selector knob.
4. When your phone appears on the list, select it by pressing the selector knob.

If your phone does not appear, select Phone Not Found? and search for *Bluetooth*® devices using your phone. From your phone, select HandsFreeLink®.

Search for *Bluetooth*® devices using your phone. From your phone, select HandsFreeLink®.

5. The system gives you a pairing code on the audio/information screen.

Confirm if the pairing code on the screen and your phone match. This may vary by phone.

6. A notification appears on the screen if pairing is successful.

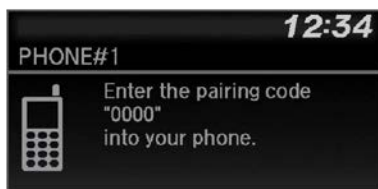

Models with Display Audio

Use the touchscreen to make and enter selections.

1. Press the Home button.
2. Select Phone.
3. Select Connect Phone.
4. Make sure your phone is in search or discoverable mode, then select +Connect New Device.

HFL automatically searches for a *Bluetooth*® device.

5. Select your phone when it appears on the list.

If your phone still does not appear, search for *Bluetooth*® devices using your phone.

From your phone, search for HandsFreeLink®.

6. The system gives you a pairing code on the audio/information screen.

Confirm if the pairing code on the screen and your phone match.

This may vary by phone.

7. Select desired functions and then select Connect.

A confirmation message appears on the screen. Select Continue or Connect without Internet.



Applicable laws may prohibit the operation of handheld electronic devices while operating a vehicle.

■ Pairing an Additional Phone

Models with Color Audio

1. Press the Phone button.
If a prompt appears asking to connect to a phone, select No and proceed with step 2.

2. Select Phone Setup.
3. Select *Bluetooth*® Setup.

4. Select Add New Device.
The screen changes to device list.

5. Select Add New.
6. Make sure your phone is in search or discoverable mode.

HFL automatically searches for a *Bluetooth*® device.

7. When your phone appears on the list, select it.

If your phone does not appear, select Phone Not Found? and search for *Bluetooth*® devices using your phone. From your phone, select HandsFreeLink®.

8. The system gives you a pairing code on the audio/information screen.

Confirm if the pairing code on the screen and your phone match.
This may vary by a phone.

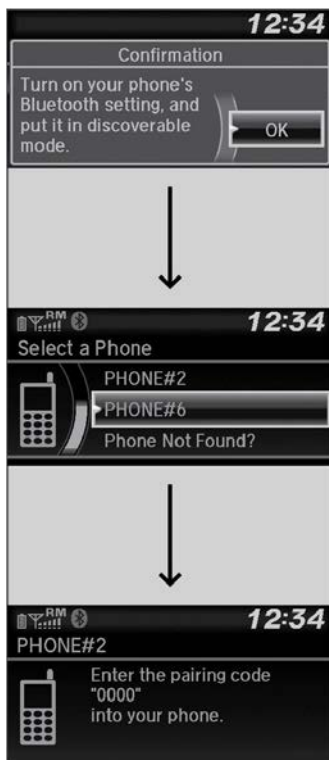

Models with Display Audio

1. Select from the *Bluetooth*® device list screen.
2. To change the *Bluetooth*® connection priority device setting, select Priority Device Settings from the *Bluetooth*® Device List screen.

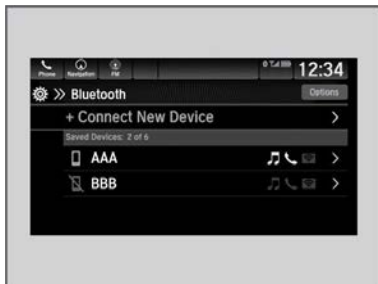

Making a Call

You can make calls by inputting any phone number, or by using the imported phonebook, call history, speed dial entries, or redial.

■ Dialing a Number

Models with Color Audio

1. Press the Phone button.
2. Rotate the selector knob to select Dial, then press the selector knob.
3. Rotate the selector knob to select a number, then press the selector knob.
4. Rotate the selector knob to select the Phone button, then press the selector knob.

Dialing starts automatically.



Models with Display Audio

Enter a 10-digit phone number to call.

1. Go to the phone menu screen.
2. Select Keypad.
3. Select a number.
Use the keyboard on the touch screen for entering numbers.

4. Select Call.

Dialing starts automatically.

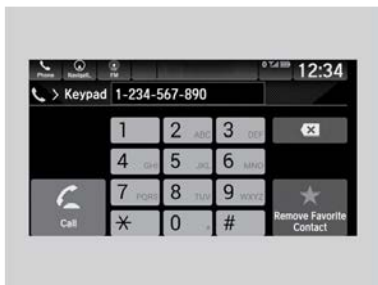

■ Using the Phonebook

When your phone is paired, its phonebook is automatically imported to the system.

This method is inoperable while the vehicle is moving.

Models with Color Audio

1. Press the Phone button.
2. Rotate the selector knob to select Phonebook, then press the selector knob.
3. The phonebook is stored alphabetically.

Rotate the selector knob to select the initial, then press the selector knob.

4. Rotate the selector knob to select a name, then press the selector knob.
5. Rotate the selector knob to select a number, then press the selector knob.

Dialing starts automatically.

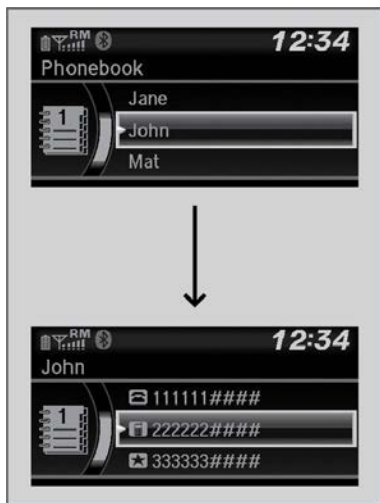

Models with Display Audio

1. Go to the phone menu screen.
2. Select Contacts.
3. Select a name.

You can sort by First Name or Last Name. Select the icon on the upper right of the screen.

4. Select a number.

Dialing starts automatically.

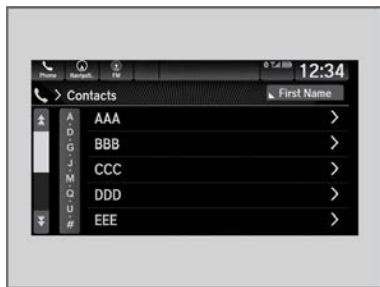

■ Storing Speed Dial Entries

Store up to 20 numbers for quick dialing. To store a speed dial number:

Models with Color Audio

1. Press the Phone button.
2. Rotate the selector knob to select Speed Dial, then press it.
3. Rotate the selector knob to select Add New, then press it.
4. Rotate the selector knob to select a place to choose a number from, then press it.

From Call History:

Select a number from the call history.

From Phonebook:

Select a number from the connected cell phone's imported phonebook.

From Phone Number:

Input the number manually.

5. When the speed dial is successfully stored, you are asked to create a voice tag for the number. Rotate the selector knob to select Yes or No, then press it.
6. Using the Talk button, follow the prompts to say the name for the speed dial entry.



Models with Display Audio

1. Go to the phone menu screen.
2. Select the Recent Calls, Contacts, or Keypad screen.
3. Select the star icon.

A notification appears on the screen if the speed dial is successfully stored.

To remove the speed dial, select the star icon again.

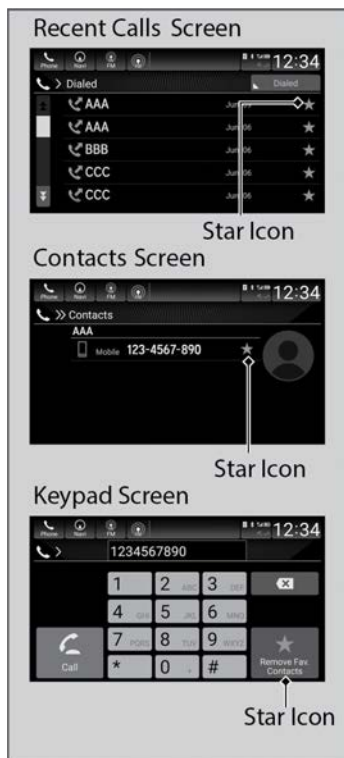

■ Using Speed Dial

Make calls quickly using stored speed dial entries or call history numbers.

Models with Color Audio

1. Press the Phone button.
2. Rotate the selector knob to select Speed Dial, then press the selector knob.
3. Rotate the selector knob to select a number, then press the selector knob.

Dialing starts automatically.



Models with Display Audio

1. Go to the phone menu screen.
2. Select Favorite Contacts.
You can change the order of speed dial entries by selecting Reorder.
3. Select a number.
Dialing starts automatically.

