

VEHICLE CONTROLS

Various controls necessary for operating and driving the vehicle.

Using the Remote Transmitter

Lock or unlock the doors and tailgate.

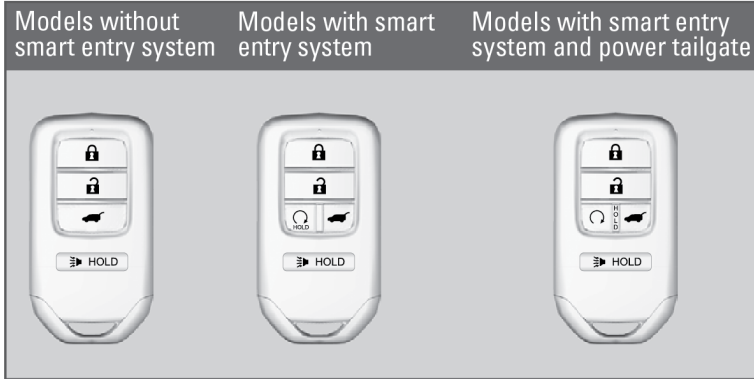

NOTICE

Leaving the remote transmitter in the vehicle can result in theft or accidental movement of the vehicle. Always take it with you whenever you leave the vehicle unattended.

Smart Entry System

When you carry the remote transmitter, in a pocket or purse and it is outside the vehicle and within range (about 32 inches or 80 cm), you can lock or unlock the doors, and open the tailgate without handling the transmitter.

■ Unlocking/Locking the Doors

To unlock: Grab the driver's door handle to unlock the driver's door. Grab the front passenger's door handle to unlock all the doors and the tailgate. You can customize this feature's behavior.

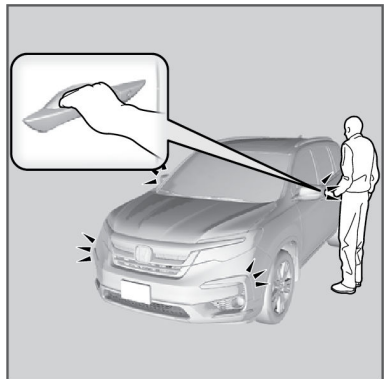

To lock: Press the door lock button on the front door or the tailgate.

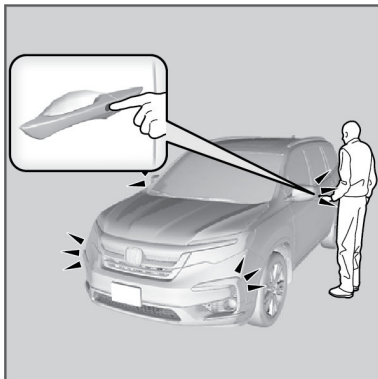

Note: System range is affected by radio signals from other devices (for example, cell phones or tablets) so for best results, carry the remote transmitter separately from these devices.

■ Customizing Door Lock and Unlock Settings

Customize the auto door lock and door unlock settings to your preference.

Using the Driver Information Interface

1. Press the **Home** button.
2. Look at the driver information interface and use the up and down arrows on the left selector wheel to select **Settings**. Press the **ENTER** button.
3. Use the left selector wheel to select **Door Setup**. Press the **ENTER** button.
4. Use the left selector wheel to select **Auto Door Lock** or **Auto Door Unlock**. Press the **ENTER** button.

Using the Audio/Information Screen

1. Select **Home**.
2. Select **Settings**.
3. Select **Vehicle**.
4. Select **Door Setup**.
5. Select **Auto Door Lock** or **Auto Door Unlock** then select an option.

■ Walk Away Auto Lock®

When you walk away from the vehicle while carrying the remote transmitter, the doors and tailgate can automatically lock if the following conditions are met:

- The remote transmitter is within a range of 5 feet (1.5 m).
- All doors and the tailgate are closed.
- There is not an additional remote transmitter inside the vehicle.

Follow these steps:

1. Exit the vehicle, close the door and stay near it. Listen for a beep. The system is activated.
2. Walk at least 5 feet (1.5 m) away.
3. Listen for a beep and look for the lights to flash. The doors lock.

The auto lock function is set to OFF as the factory default setting. It can be set to ON using the audio/information screen. If you set the auto lock function to ON, only the remote transmitter that was used to unlock the driver's door

prior to the setting change can activate auto lock. To turn on this feature, follow the steps below:

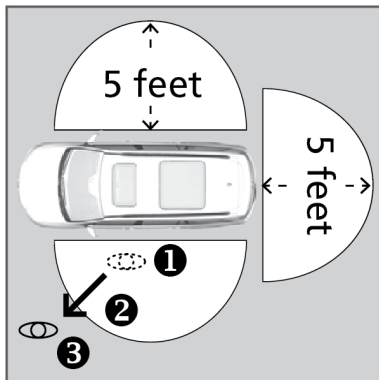

Models with Display Audio

Using the Audio/Information Screen

1. Press the HOME button then select **Settings**.
2. Select **Vehicle**.
3. Select **Keyless Access Setup**.
4. Select **Walk Away Auto Lock®**, then select **Enable**.

Door Operation

There are a few different ways of unlocking the doors from inside the vehicle.

■ Using the Lock Tab

To unlock: Pull the lock tab rearward. When you unlock either front door using the lock tab, the specific door (driver's or passenger's) unlocks.

To lock: Push the lock tab forward. When you lock the door using the lock tab on the driver's door, all the other doors and the tailgate lock at the same time. When you lock the door using the lock tab on the front passenger's door, only that door locks.

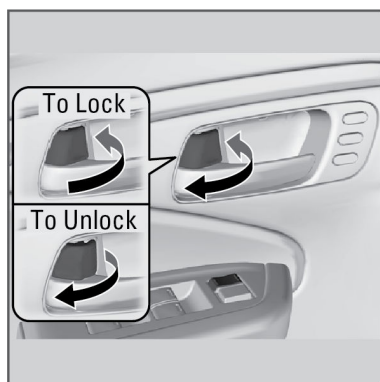

■ Using the Front Door Inner Handle

Pull the front door inner handle. The door unlocks and opens in one motion. Unlocking and opening the driver's door from the inner handle unlocks all other doors.

Do not pull a front door inner handle while the vehicle is moving.

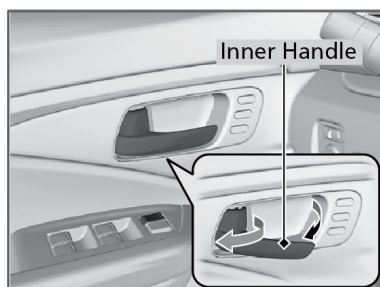

■ Using the Master Door Lock Switch

To unlock: Press the unlock side of the switch to unlock all doors and the tailgate.

To lock: Press the lock side of the switch to lock all doors and the tailgate.



■ Childproof Door Locks

The childproof door locks prevent the rear doors from being opened from the inside regardless of the position of the lock tab.

Slide the lever in the rear door to the lock position, and close the door.

Open the door using the outer door handle.

Note: To open the door from the inside when the childproof door lock is on, put the lock tab in the unlock position, lower the rear window, put your hand out of the window, and pull the outside door handle.

