

## Low Speed Braking Control\*

Using sonar sensors located on the front and rear bumpers, the vehicle detects if there is danger of a potential collision with a wall or other obstacle. The system is designed to alert you when a potential collision is determined, as well as assist in reducing speed, avoiding collisions, and reducing collision severity.

### ▶▶ Low Speed Braking Control\*

#### **⚠ WARNING**

It is not possible for the Low Speed Braking Control system to avoid collisions or reduce damage from collisions in all situations where the accelerator has been depressed accidentally or with too much force. Overreliance on this system may result in a collision and serious injury or death. It is your responsibility to always check your shift position, pedal location and surroundings, and safely operate the vehicle.

When trapped in a railway crossing, the system may detect the crossing gate as an obstacle and activate. If this happens, Low Speed Braking Control will automatically cancel after a certain amount of time after stopping, so continue to move forward.

If the system is activated by curbs/parking curbs or level differences on the road and you are unable to park or clear them, turn the system off.

\* Not available on all models

## How the System Works

The Low Speed Braking Control provides a visual and audible alert when the vehicle is moving between approximately 1 and 6 mph (2 and 10 km/h) and there is the possibility of a collision with a detected wall or other obstacle, as well as providing assistance with braking.

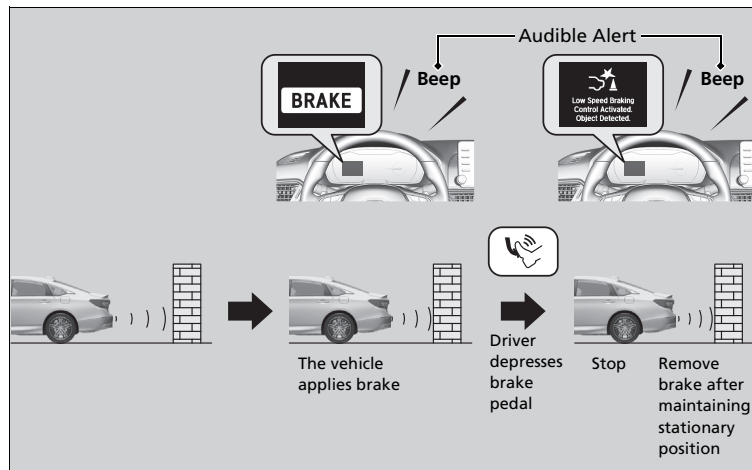

## Low Speed Braking Control\*

For directions on the proper handling of the sonar sensors, please refer to the following page.

### Sonar Sensors\*

The vehicle will release the brake and start moving a few seconds after the system is activated. To keep the vehicle stopped, keep the brake pedal depressed or put the transmission into **[P]**.

In order to prevent the system from activating when not needed, always turn it off during vehicle maintenance, when loading on ships, trucks, and so on, when using a chassis dynamometer or free rollers for inspection or when putting your vehicle through a conveyor type car wash.

Do not make any modifications to the suspension or the system may not operate correctly.

Always use the size and type of tires recommended, make, and amount of wear. If these differ, the system may not operate correctly.

\* Not available on all models

## System On and Off

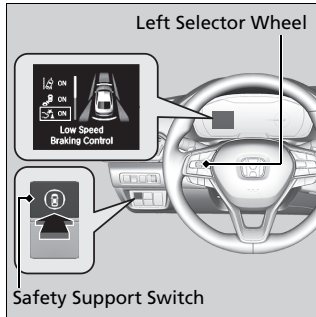

When you turn the system on and off, do the following.

1. Press the safety support switch.
2. Roll the left selector wheel to the  symbol and push it.

▶ The message appears on the driver information interface when the system turns on or off.

The system is turned on every time you start the power system, even if you turned it off the last time you drove the vehicle.

## System On and Off

If the 12-volt battery is disconnected and reconnected, the Low Speed Braking Control may not turn on right away when you turn on the power system.

The system will automatically turn ON after the vehicle has been moving at over 12 mph (20 km/h) for some time.

If the system does not turn on, have your vehicle checked by a dealer.

\* Not available on all models

## ■ Conditions for Cancellation

A certain amount of time has passed since activation.

## ■ Low Speed Braking Control System Conditions and Limitations

The system may not operate correctly under the following conditions:

### ■ Examples of obstacles the sonar sensors cannot detect

- Obstacles that do not reflect sound waves well, such as people, snow, cloth, sponges, etc.
- Thin obstacles such as fences, bicycles, sign posts, etc.
- Short or small obstacles.
- Obstacles immediately in front of the bumper.
- Moving objects or obstacles that suddenly enter the road.
- Obstacles that are not perpendicular to the ground, such as a wall.

### ☒ Conditions for Cancellation

After Low Speed Braking Control has activated once, it will not activate again for the same obstacle.

The system can be activated again after driving for some time after the last activation.

Low Speed Braking Control activates separately when moving forward and reversing. (For example, if it activates when moving forward, it can be activated again immediately if reversing.)

However, if Low Speed Braking Control has been activated, in order to activate again, it is necessary to drive for a certain amount of time.

\* Not available on all models

### ■ Examples of situations where the sonar sensors cannot detect obstacles

- The sonar sensors are dirty (covered by snow, water, mud, etc.).
- The vehicle is too hot or cold.
- The steering wheel is turned sharply when approaching the obstacle at an angle.

### ■ Examples of other cases where the system may not work correctly

- The vehicle is tilted due to heavy load in the trunk or rear seats.
- Bad weather conditions such as heavy rain, fog, snow, sandstorms, etc.
- The ambient temperature/humidity is too high or low.
- When going down a very steep slope.
- When close to other vehicles with sonar sensors or other objects that emit ultrasonic waves.

### ■ Situations where the system may activate even without risk of a collision

- When passing through short or narrow gates.
- When driving on uneven surfaces, grassy areas, or places with steps.
- When a sloped pillar or wall is protruding from a high position.
- When there are obstacles next to the road.
- When driving toward flags, curtains, tree branches, railroad crossing bars, etc.
- When driving on flooded roads.

\* Not available on all models