

## USB Port(s)

Install the iPod USB connector or the USB flash drive to the USB port.

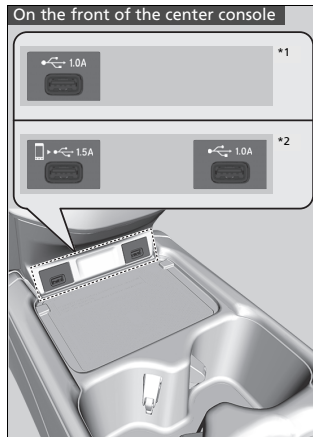

### ■ On the front of the center console

#### USB Port (1.0A)

The USB port (1.0A) is for playing audio files on a USB flash drive, connecting a cellular phone, and charging devices.

#### USB Port (1.5A)\*

The USB port (1.5A) is for charging devices, playing audio files and connecting compatible phones with Apple CarPlay™ or Android Auto™.

- ▶ To prevent any potential issues, be sure to use an Apple MFi Certified Lightning Connector for Apple CarPlay™, and for Android Auto™, the USB cables should be certified by USB-IF to be compliant with USB 2.0 Standard.

\*1: Models with color audio system

\*2: Models with Display Audio

\* Not available on all models

### ▶▶ USB Port(s)

- Do not leave the iPod or USB flash drive in the vehicle. Direct sunlight and high temperatures may damage it.
- We recommend using an extension cable with the USB port.
- Do not connect the iPod or USB flash drive using a hub.
- Do not use a device such as a card reader or hard disk drive, as the device or your files may be damaged.
- We recommend backing up your data before using the device in your vehicle.
- Displayed messages may vary depending on the device model and software version.

If the audio system does not recognize the iPod, try reconnecting it a few times or reboot the device. To reboot, follow the manufacturer's instructions provided with the iPod or visit [www.apple.com/ipod](http://www.apple.com/ipod).

The USB port can supply up to 1.5A/2.5A of power. It does not output 1.5A/2.5A unless the device requests.

For amperage details, read the operating manual of the device that needs to be charged.

Under certain conditions, a device connected to the port may generate noise to the radio station you are listening to.

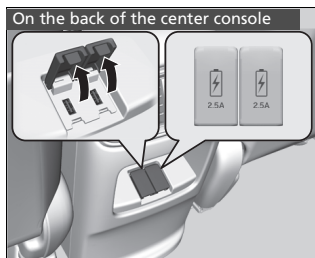

■ **On the back of the center console\***

The USB ports (2.5A) are only for charging devices.

» USB Port(s)

**USB Port (2.5A)\***

This port is for battery charge only. You cannot play music even if you have connected a music player to it.

\* Not available on all models