

Models with Display Audio

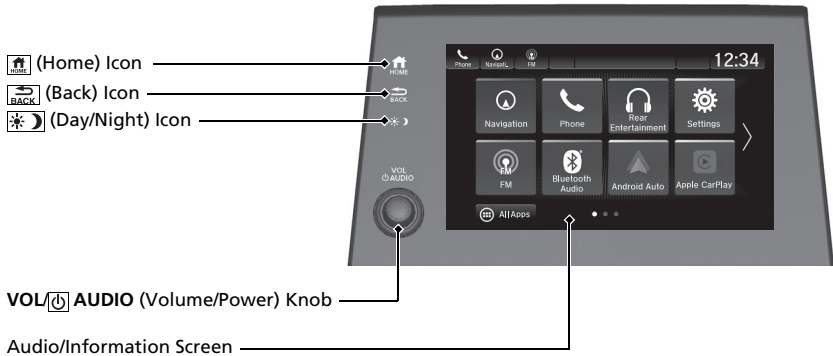

Models with Blu-ray™ or CD player

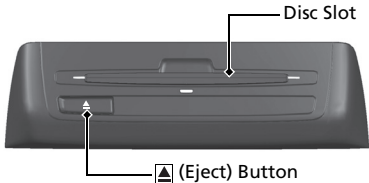

About Your Audio System

The audio system features AM/FM radio and SiriusXM® Radio* service. It can also play audio CDs*, USB flash drives, and iPod, iPhone, iPad* and **Bluetooth**® devices.

You can operate the audio system from the buttons* and knobs on the panel, the remote controls on the steering wheel, or the icons on the touchscreen interface*.

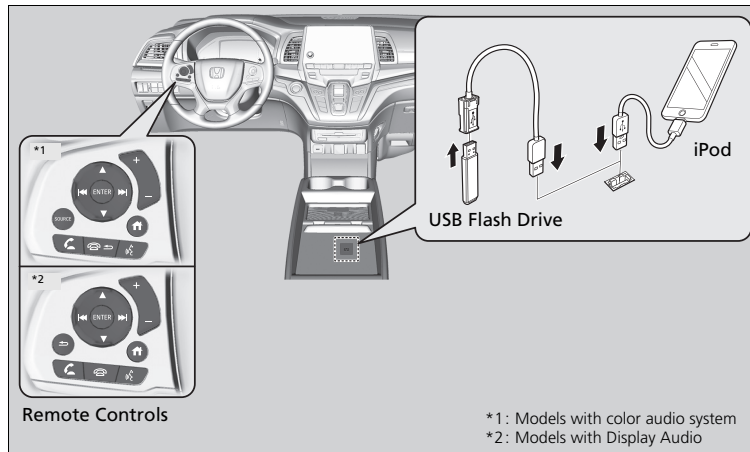

About Your Audio System

iPod, iPad, iPhone and iTunes are trademarks of Apple Inc.

State or local laws may prohibit the operation of handheld electronic devices while operating a vehicle.

Models with Blu-ray™ or CD player

Video CDs, DVDs*1, Blu-ray Discs*1, and 3-inch (8-cm) mini CDs are not supported.

*1: Models with CD player

SiriusXM® Radio* is available on a subscription basis only. For more information on SiriusXM® Radio*, contact a dealer.

SiriusXM® Radio* is available in the United States and Canada, except Hawaii, Alaska, and Puerto Rico.

SiriusXM® is a registered trademark of SiriusXM Radio*, Inc.

Models with Display Audio

After you set the power mode to VEHICLE OFF, you can use the audio system for up to 30 minutes per driving cycle, or until opening the driver's door. However, whether you can continue using the audio system depends on the battery condition. Repeatedly using this feature may drain the battery.

* Not available on all models

Models with Display Audio

Allow you to operate the audio system while driving. The information is shown on the driver information interface.

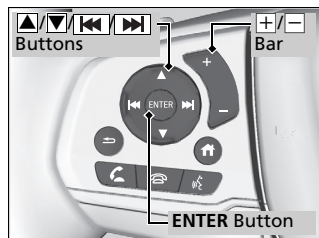

+/- (Volume) Bar

Press **+**: To increase the volume.

Press **-**: To decrease the volume.

Audio Remote Controls

Some modes appear only when an appropriate device or medium is used.

Depending on the **Bluetooth®** device you connect, some functions may not be operated.

Press the  (back) button to go back to the previous screen or cancel a command.

Press the  (home) button to go back to the home screen of the driver information interface.

You can show or hide the audio mode icons, or change the order of the icons.

▲/▼/◀◀/▶▶/ENTER Buttons

- When selecting the audio mode
Press ▲ or ▼ to select **Now Playing** on the home screen of the driver information interface, and then press the **ENTER** button.

Press ▲ or ▼: To cycles through the audio modes as follows:
Android Auto/Apple CarPlay→SiriusXM®*→Rear Entertainment*→AUX
Input→AM→*Bluetooth*® Audio→Social Playlist→FM→My Honda Music→USB/
iPod→CD*
- When listening to the radio
Press ▶▶: To select the next preset radio station.
Press ◀◀: To select the previous preset radio station.
Press and hold ▶▶: To select the next strong station.
Press and hold ◀◀: To select the previous strong station.
- When listening to a CD*, iPod, USB flash drive, My Honda Music, or *Bluetooth*® Audio
Press ▶▶: To skip to the next song.
Press ◀◀: To go back to the beginning of the current or previous song.
- When listening to an iPod, USB flash drive, My Honda Music, *Bluetooth*® Audio, or Apple CarPlay
Press and hold ◀◀/▶▶: To move rapidly within a song.

* Not available on all models

Audio/Information Screen

Displays the audio status and wallpaper. From this display, you can go to various setup options.

■ Switching the Display

■ Using the audio/information screen

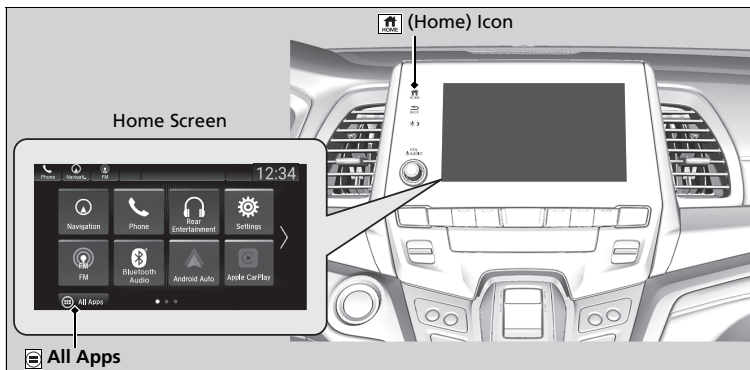

Select  to go to the home screen.

Select the following icons on the home screen or after selecting  **All Apps**.

▶▶ Audio/Information Screen

Touchscreen Operation

- Use simple gestures - including touching, swiping, and scrolling - to operate certain audio functions.
- Some items may be grayed out during driving to reduce the potential for distraction.
- You can select them when the vehicle is stopped or use voice commands.
- Wearing gloves may limit or prevent touchscreen response.

You can change the touchscreen sensitivity setting.

■ Phone

Displays the HFL information.

■ Trip Computer

Displays the trip computer information.

- **Current Drive** tab: Displays the current trip information.
- **Trip A/Trip B** tab: Displays information for the current and three previous drives.
The information is stored every time you reset Trip A/B.
To reset Trip A/B, select **Reset**.
To change the setting of how to reset Trip A/B, select **Settings**, then select **Trip A Reset Method** or **Trip B Reset Method**.

■ Clock

Displays the clock.

■ System Updates

Updates the software version of the audio system.

■ FM/AM/Sirius XM*/CD*/USB/Bluetooth Audio/AUX Input/My Honda Music/Social Playlist

Displays the each audio information.

■ Settings

Enters the customizing menu screen.

* Not available on all models

■ **Navigation***

Displays the navigation screen.

■ **HondaLink**

Displays the HondaLink® screen.

■ **Apple CarPlay/Android Auto**

Displays the **Apple CarPlay** or **Android Auto**.

■ **Messages**

Displays the text message screen.

■ **CabinTalk***

Displays the **CabinTalk** screen.

■ **CabinWatch***

Displays the **CabinWatch** screen.

■ **Rear Entertainment***

Displays the rear audio screen.

■ **AT&T Hotspot***

Displays the AT&T Hotspot screen.

■ **File Manager**

Displays the file manager screen.

■ Updating Apps

Some of the audio system's apps can be updated wirelessly when connected via Wi-Fi, or **Bluetooth®** in conjunction with the HondaLink® app installed on a compatible iOS or Android device. If an update is available, a notification is displayed at the top of the screen with the respective app's update icon.

■ To update an app:

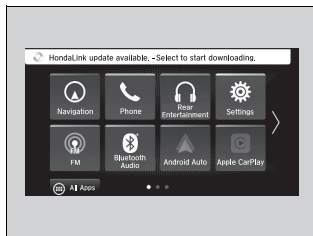

1. A notification appears and notifies you of a update message on the header area.

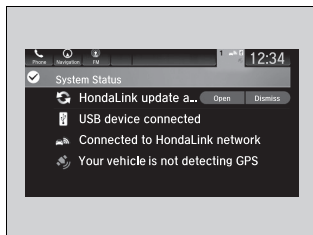

2. Select the system status icon, and then select the software update notification from the list.

☒ Updating Apps

The wireless updates are for the apps on the audio system only.

To update compatible apps on your iPhone or Android phone, please visit the App Store or Google Play Store, respectively.

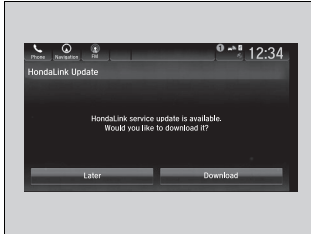

3. Select **Download**.

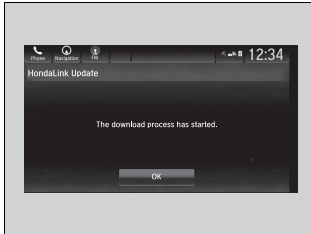

4. Select **OK**.

- ▶ A notification appears on the screen if the update is successful. Select **OK**.
- ▶ Restart the engine for the update to be applied.