

## Temporarily Repairing a Flat Tire

If the tire has a large cut or is otherwise severely damaged, you will need to have the vehicle towed. If the tire only has a small puncture, from a nail for instance, you can use the temporary tire repair kit so that you can drive to the nearest service station for a more permanent repair.

If a tire goes flat while driving, grasp the steering wheel firmly, and brake gradually to reduce speed. Then, stop in a safe place.

- 1. Park the vehicle on a firm, level, non-slippery surface and apply the parking brake.
- 2. Put the transmission into **P**.
- 3. Turn on the hazard warning lights and set the power mode to VEHICLE OFF (LOCK).

### Temporarily Repairing a Flat Tire

The kit should not be used in the following situations. Instead, contact a dealer or roadside assistance to have the vehicle towed.

- The tire sealant has expired.
- More than one tire is punctured.
- The puncture or cut is larger than 3/16 inch (4.8 mm).
- The tire side wall is damaged or the puncture is outside the contact area.



When the puncture is:	Kit Use
Smaller than 3/16 inch (4.8 mm)	Yes
Larger than 3/16 inch (4.8 mm)	No

- Damage has been caused by driving with the tire extremely under inflated.
- The tire bead is no longer seated.
- The rim is damaged.

Do not remove a nail or screw that punctured the tire. If you remove it from the tire, you may not be able to repair the puncture using the kit.

## ■ Getting Ready to Temporarily Repair the Flat Tire

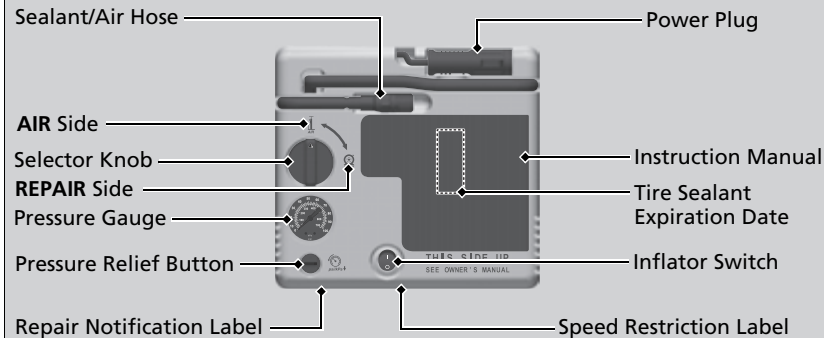

## ► Getting Ready to Temporarily Repair the Flat Tire

Repair notification label and speed restriction label are applied to the side of the temporary tire repair kit.

When making a temporary repair, carefully read the instruction manual provided with the kit.

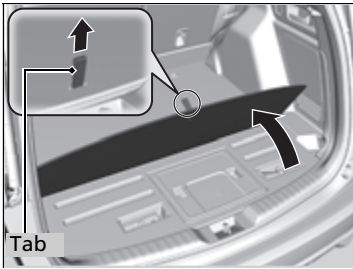

1. Using the tab, fold back the cargo area floor lid.

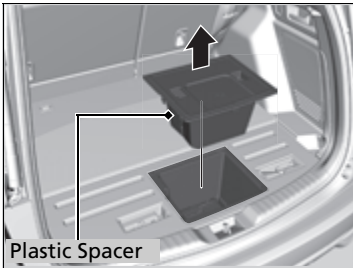

2. Remove the plastic spacer from the cargo area.

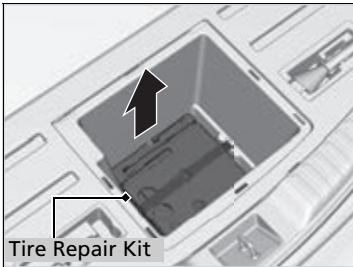

3. Unfasten the strap and remove the tire repair kit.
4. Place the kit face up, on flat ground near the flat tire, and away from traffic. Do not place the kit on its side.

## ■ Injecting Sealant and Air

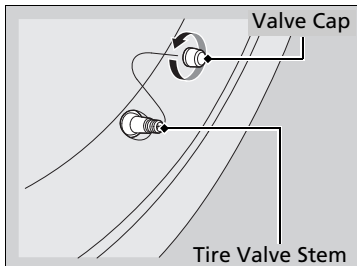

1. Remove the valve cap from the tire valve stem.

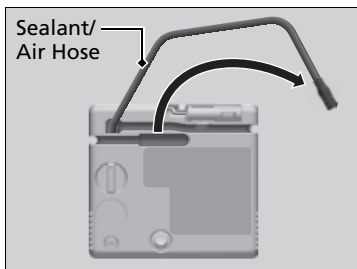

2. Unwind the sealant/air hose from the kit.

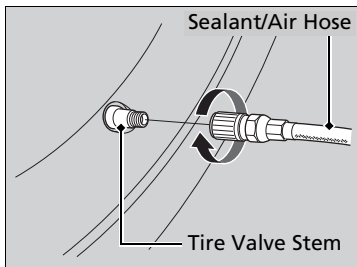

3. Attach the sealant/air hose onto the tire valve stem. Screw it clockwise until it is tight.

## ►► Injecting Sealant and Air

### ⚠ CAUTION

Tire sealant contains substances that are harmful if inhaled, ingested or if contact is made with the eyes or skin.

Always use in a well-ventilated area and use gloves and safety glasses for protection; do not ingest.

For skin or eye contact, flush with cool water; if ingested, rinse mouth with water. In all cases, seek medical attention if necessary.

In cold temperatures, the sealant may not flow easily. In this situation, warm it up for five minutes before using.

The sealant can permanently stain clothing and other materials. Be careful during handling and wipe away any spills immediately.

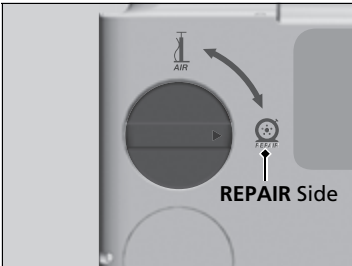
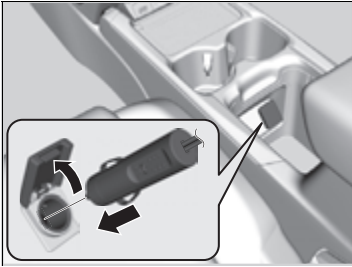

4. Plug in the compressor to the accessory power socket.
  - Be careful not to pinch the cord in a door or window.
  - ✎ **Accessory Power Socket** P. 229
5. Turn on the vehicle's power system.
  - ✎ **Turning on the Power** P. 469
  - Keep the power system on while injecting sealant and air.
  - ✎ **Carbon Monoxide Gas** P. 86
6. Turn the selector knob to **REPAIR**.

#### ✎ Injecting Sealant and Air

### ⚠ WARNING

Running the engine with the vehicle in an enclosed or even partly enclosed area can cause a rapid buildup of toxic carbon monoxide.

Breathing this colorless, odorless gas can cause unconsciousness and even death. Only run the engine to power the air compressor with the vehicle outdoors.

#### NOTICE

Do not operate the temporary tire repair kit compressor for more than 15 minutes. The compressor can overheat and become permanently damaged.

Until the sealant injection is complete, the pressure shown on the pressure gauge will appear higher than actual. After the sealant injection is complete the pressure will drop and then begin to rise again as the tire is inflated with air. This is normal. To accurately measure the air pressure using the gauge, turn the air compressor off only after the sealant injection is complete.

## ►► If a Tire Goes Flat ►► Temporarily Repairing a Flat Tire

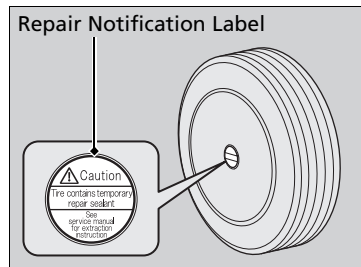
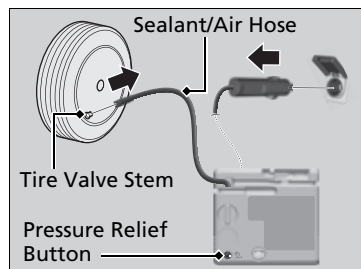
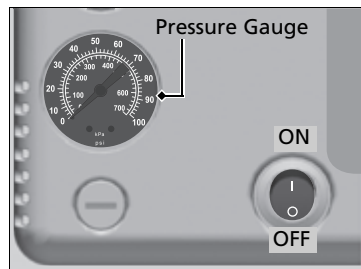

### 7. Press the inflator switch to turn on the kit.

- The compressor starts injecting sealant and air into the tire.
- When the sealant injection is complete, continue to add air.

### 8. After the tire reaches the specified air pressure, turn off the kit.

- To check the pressure, periodically turn off the compressor and read the gauge.
- Refer to the driver's doorjamb label for the specified pressure.

### 9. Unplug the power plug from the accessory power socket.

### 10. Unscrew the sealant/air hose from the tire valve stem. Reinstall the valve cap.

### 11. Press the pressure relief button until the gauge returns to 0 psi (0 kPa).

### 12. Apply the repair notification label to the flat surface of the wheel.

- The wheel surface must be clean to ensure the label adheres properly.

## ►► Injecting Sealant and Air

If the required air pressure is not reached within 10 minutes, the tire may be too severely damaged for the kit to provide the necessary seal, and your vehicle will need to be towed.

See a dealer for a replacement sealant bottle and proper disposal of an empty bottle.

## ■ Distributing the Sealant in the Tire

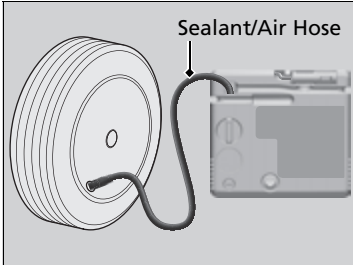
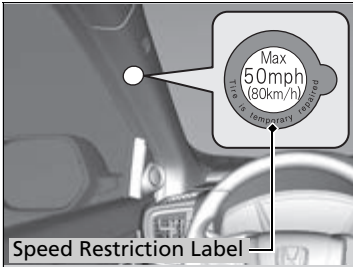

1. Apply the speed restriction label to the location as shown.
2. Drive the vehicle for about 10 minutes.
  - Do not exceed 50 mph (80 km/h).
3. Stop the vehicle in a safe place.
4. Recheck the air pressure using the sealant/air hose on the compressor.

*Continued*

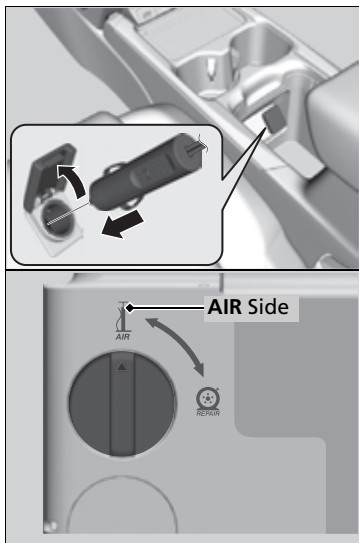

5. Turn the selector knob to **AIR**.

- Do not turn the air compressor on while checking the pressure.

❑ **Inflating an Under-inflated Tire** P. 640

►► Distributing the Sealant in the Tire

**⚠ WARNING**

Running the engine with the vehicle in an enclosed or even partly enclosed area can cause a rapid buildup of toxic carbon monoxide.

Breathing this colorless, odorless gas can cause unconsciousness and even death. Only run the engine to power the air compressor with the vehicle outdoors.



6. If the air pressure is

- Less than 25 psi (175 kPa):

Do not add air or continue driving. The leak is too severe. Call for help and have your vehicle towed.

🚚 **Emergency Towing** P. 663

**Models with 235/65R17 104H tires**

- Front: 32 psi (220 kPa)/rear: 30 psi (210 kPa) or more:

**Models with 235/60R18 103H tires**

- Front: 35 psi (240 kPa)/rear: 32 psi (220 kPa) or more:

**Models with 235/55R19 101H tires**

- 33 psi (230 kPa) or more:

Continue driving for another 10 minutes or until you reach the nearest service station, whichever is sooner. Do not exceed 50 mph (80 km/h). If you have not reached a service station, stop and check the tire pressure.

► If the air pressure does not go down after the 10 minute driving, you do not need to check the pressure any more.

**Models with 235/65R17 104H tires**

- Greater than 25 psi (175 kPa), but less than front: 32 psi (220 kPa)/rear: 30 psi (210 kPa):

Turn the air compressor on to inflate the tire until the tire pressure reaches front: 32 psi (220 kPa)/rear: 30 psi (210 kPa).

➤ **Inflating an Under-inflated Tire** P. 640

**Models with 235/60R18 103H tires**

- Greater than 25 psi (175 kPa), but less than front: 35 psi (240 kPa)/rear: 32 psi (220 kPa):

Turn the air compressor on to inflate the tire until the tire pressure reaches front: 35 psi (240 kPa)/rear: 32 psi (220 kPa).

➤ **Inflating an Under-inflated Tire** P. 640

**Models with 235/55R19 101H tires**

- Greater than 25 psi (175 kPa), but less than 33 psi (230 kPa):

Turn the air compressor on to inflate the tire until the tire pressure reaches 33 psi (230 kPa).

➤ **Inflating an Under-inflated Tire** P. 640

**All models**

Then, drive carefully for 10 more minutes or until you reach the nearest service station, whichever is sooner. Do not exceed 50 mph (80 km/h). If you have not reached a service station, stop and check the tire pressure.

► You should repeat this procedure as long as the air pressure is not within the range indicated for the tire size.

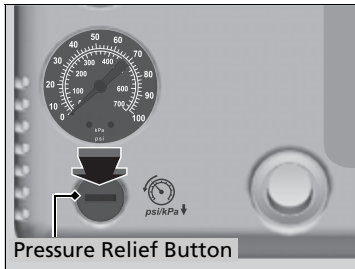

7. Unplug the kit from the accessory power socket.
8. Unscrew the sealant/air hose from the tire valve stem. Reinstall the valve cap.
9. Press the pressure relief button until the gauge returns to 0 psi (0 kPa).
10. Repackage and properly stow the kit.

## ■ Inflating an Under-inflated Tire

You can use the kit to inflate a non-punctured under-inflated tire.

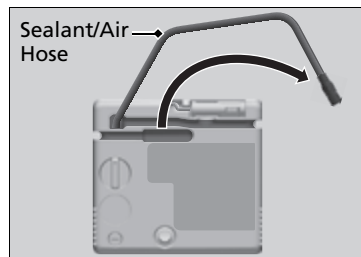

1. Open the trunk floor lid.  
    **▶ Getting Ready to Temporarily Repair the Flat Tire P. 630**

2. Remove the kit from the case.
3. Place the kit, face up, on flat ground near the tire to be inflated, away from traffic.  
    Do not place the kit on its side.
4. Remove the sealant/air hose from the kit.

5. Remove the valve cap.

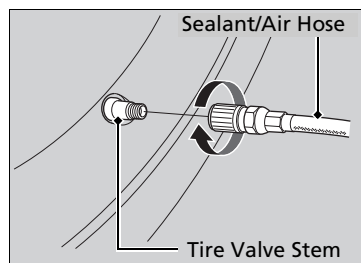
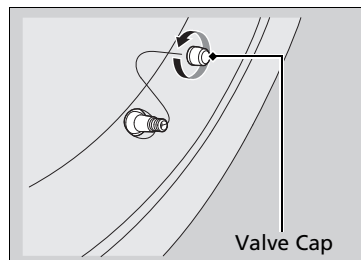

6. Attach the sealant/air hose onto the tire valve stem. Screw it clockwise until it is tight.

## ▶▶ Inflating an Under-inflated Tire

### NOTICE

Do not operate the temporary tire repair kit compressor for more than 15 minutes. The compressor can overheat and become permanently damaged.

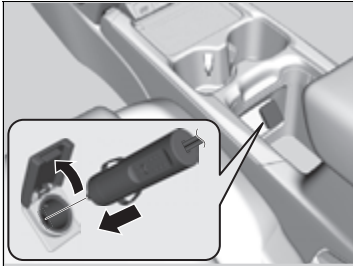

7. Plug in the kit to the accessory power socket.
  - Be careful not to pinch the cord in a door or window.
  - ✦ **Accessory Power Socket** P. 229
8. Turn on the vehicle's power system.
  - ✦ **Turning on the Power** P. 469
  - Keep the power system on while injecting sealant and air.
  - ✦ **Carbon Monoxide Gas** P. 86
9. Turn the selector knob to **AIR**.
10. Press the inflator switch to turn on the kit.
  - The compressor starts to inject air into the tire.
11. Inflate the tire to the specified air pressure.

#### ✦ Inflating an Under-inflated Tire

### ⚠ WARNING

Running the engine with the vehicle in an enclosed or even partly enclosed area can cause a rapid buildup of toxic carbon monoxide.

Breathing this colorless, odorless gas can cause unconsciousness and even death. Only run the engine to power the air compressor with the vehicle outdoors.

*Continued*

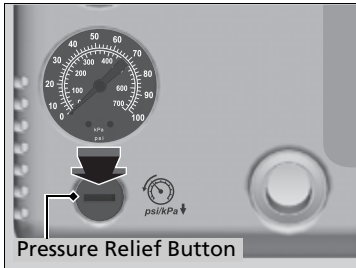

- 12.** Turn off the kit.
  - Check the pressure gauge on the air compressor.
  - If overinflated, press the pressure relief button.
- 13.** Unplug the kit from the accessory power socket.
- 14.** Unscrew the sealant/air hose from the tire valve stem. Reinstall the valve cap.
- 15.** Press the pressure relief button until the gauge returns to 0 psi (0 kPa).
- 16.** Repackage and properly stow the kit.