

Models with color audio system

Use the audio/information screen to customize certain features.

■ How to Customize the Settings

While the vehicle is at a complete stop with the power mode in ON, press the **MENU** button. To customize the phone settings, press the **PHONE** button, then select **Settings**.

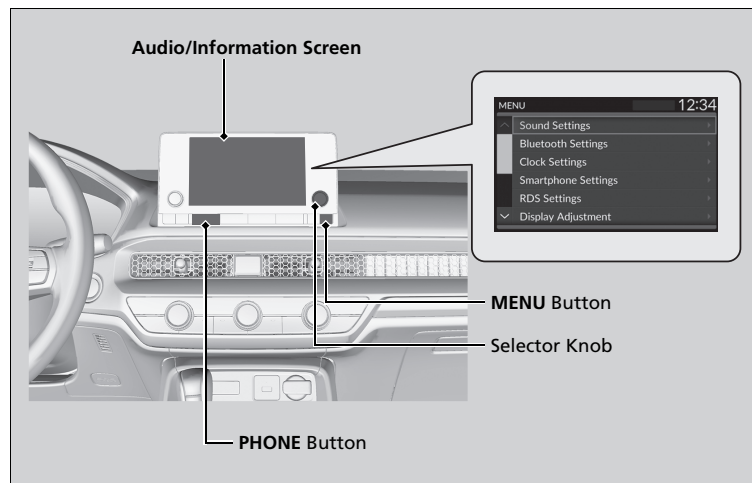

Customized Features

When you customize settings:

- Make sure that the vehicle is at a complete stop.
- Shift to **P**.

To customize features detail, refer to the following.

➤ **Customization Flow** P. 356

➤ **List of customizable options** P. 359

Continued

■ Customization Flow

Press the **MENU** button.

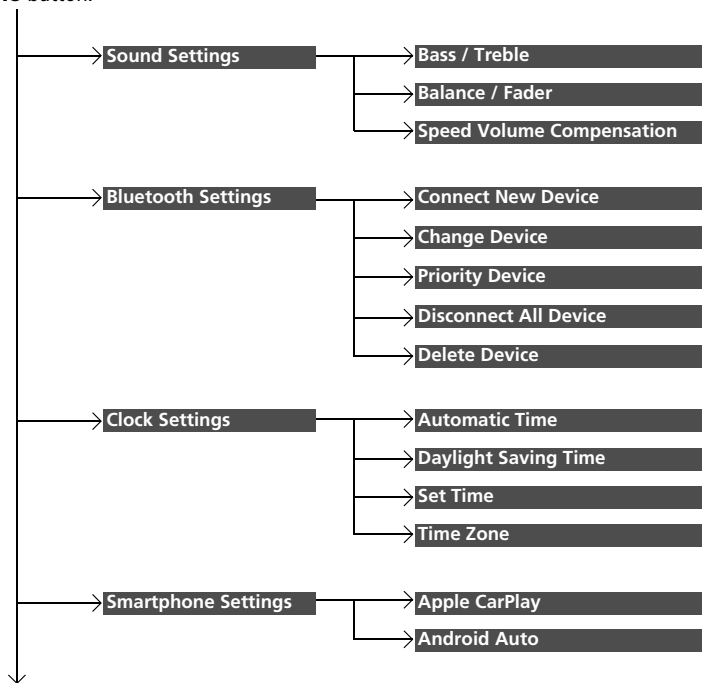

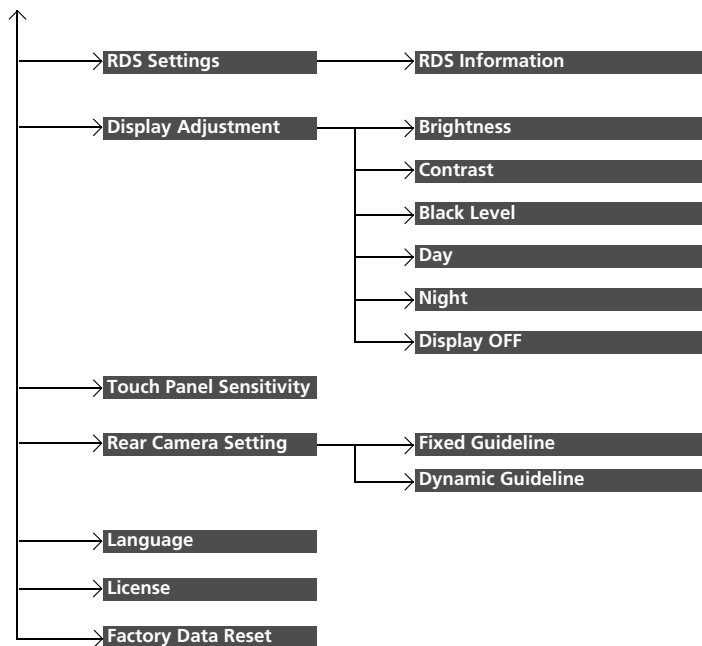

Press the **PHONE** button and select **Settings**.

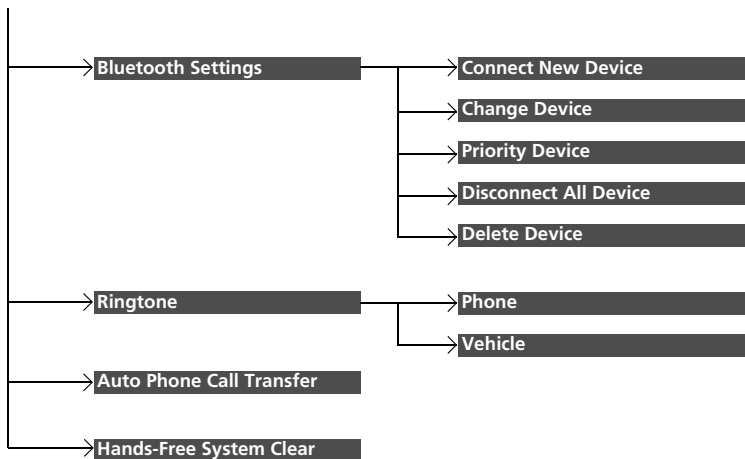

■ List of customizable options

Press the **MENU** button.

Customizable Features	Description	Selectable Settings
Sound Settings	Bass / Treble	—
	Balance / Fader	
	Speed Volume Compensation	
	Adjusts the settings of the audio speakers' sound. ▶ Adjusting the Sound P. 238	
Bluetooth Settings	Connect New Device	—
	Pairs a new phone to HFL. ▶ Phone Setup P. 394	
	Change Device	—
	Connects a paired phone. ▶ Phone Setup P. 394	
	Priority Device	ON *1/OFF
Clock Settings	Disconnect All Device	—
	Disconnects a paired phone from HFL.	
	Delete Device	—
	Deletes a paired phone.	
	Automatic Time	ON *1/OFF
Smartphone Settings	Selects ON to have the GPS automatically adjust the clock. Select OFF to cancel this function.	
	Daylight Saving Time	ON /OFF*1
	Sets the clock to update based on daylight savings time.	
	Set Time	—
RDS Settings	Adjusts time. ▶ Adjusting the Clock P. 154	
	Time Zone	—
	Changes the time zone manually.	
Smartphone Settings	Apple CarPlay	—
	Sets up the Apple CarPlay connection.	
Smartphone Settings	Android Auto	—
	Sets up the Android Auto connection.	
RDS Settings	RDS Information	ON *1/OFF
	Selects whether the RDS information comes on.	

*1:Default Setting

Customizable Features		Description	Selectable Settings
Display Adjustment	Brightness	Changes the brightness of the audio/information screen.	—
	Contrast	Changes the contrast of the audio/information screen.	
	Black Level	Changes the black level of the audio/information screen.	
	Day	Changes between the daytime mode, nighttime mode and display off mode.	
	Night		
	Display OFF		
Touch Panel Sensitivity		Sets the sensitivity of the touch panel screen.	Normal ^{*1} /High
Rear Camera Setting	Fixed Guideline	Shows the guideline that does not move with the steering wheel. 📷 Multi-View Rear Camera P. 573	ON ^{*1} /OFF
	Dynamic Guideline	Shows the guideline that moves with the steering wheel. 📷 Multi-View Rear Camera P. 573	ON ^{*1} /OFF
Language		Changes the display language.	English ^{*1} /Español/Français
License		Shows the legal information.	—
Factory Data Reset		Resets all the settings to their factory default. 📷 Defaulting All the Settings P. 362	—

*1:Default Setting

Press the **PHONE** button and select **Settings**.

Customizable Features		Description	Selectable Settings
Bluetooth Settings	Connect New Device	Pairs a new phone to HFL. 📶 Phone Setup P. 394	—
	Change Device	Connects a paired phone. 📶 Phone Setup P. 394	—
	Priority Device	Sets a device as the priority device.	ON *1/OFF
	Disconnect All Device	Disconnects a paired phone from HFL.	—
	Delete Device	Deletes a paired phone.	—
Ringtone		Selects the ring tone.	Phone *1/Vehicle
Auto Phone Call Transfer		Sets calls to automatically transfer from your phone to HFL when you enter the vehicle.	ON *1/OFF
Hands-Free System Clear		Resets all customized items in the Phone Settings group as default.	—

*1:Default Setting

Defaulting All the Settings

Reset all the menu and customized settings as the factory defaults.

1. Press the **MENU** button.
2. Select **Factory Data Reset**.
 - A confirmation message appears on the screen.
3. Select **Yes** to reset the settings.
4. Select **Yes** again to reset the settings.
 - The system will reboot.

» Defaulting All the Settings

When you transfer the vehicle to a third party, reset all settings to default and delete all personal data.

If you perform **Factory Data Reset**, it will reset the preinstalled apps to their factory default.