

AUDIO AND CONNECTIVITY

Learn how to operate the vehicle's audio system.

Basic Audio Operation

Connect audio devices and operate buttons and displays for the audio system.

USB/HDMI Port*

1. Open the port cover in the front console.
2. Connect a USB flash drive or iPod/iPhone® cable connector to the USB port, or an HDMI cable to the HDMI port.

An additional USB cable is located in the center console.

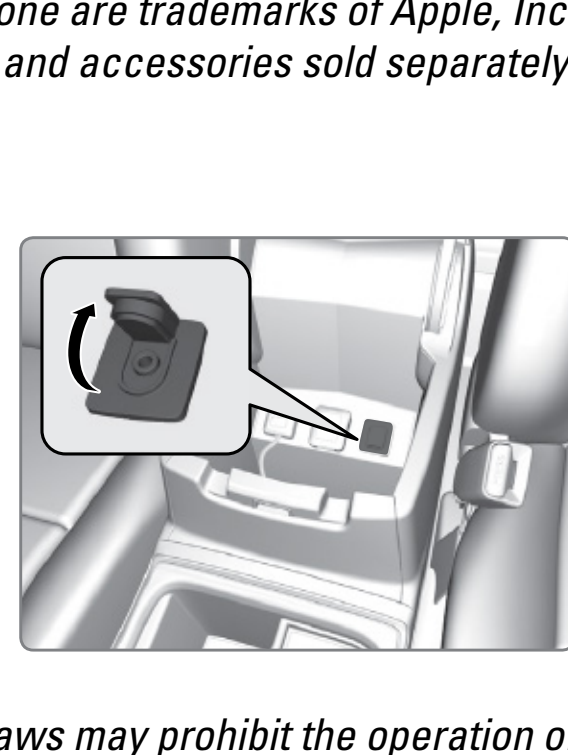

iPod and iPhone are trademarks of Apple, Inc. Additional cables and accessories sold separately.

Auxiliary Input Jack*

Connect standard audio devices with a 1/8-inch (3.5 mm) stereo miniplug.

1. Open the AUX cover in the front console.
2. Insert the miniplug attached to the audio device into the jack. The audio system switches to AUX mode. Use the device to control the audio.

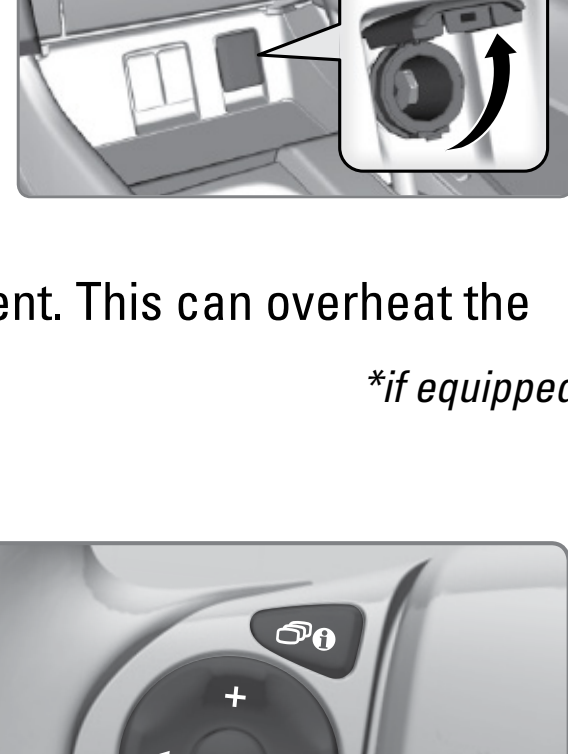

State or local laws may prohibit the operation of handheld electronic devices while operating a vehicle.

Accessory Power Socket

Open the socket cover in the front console to use power when the vehicle is on.

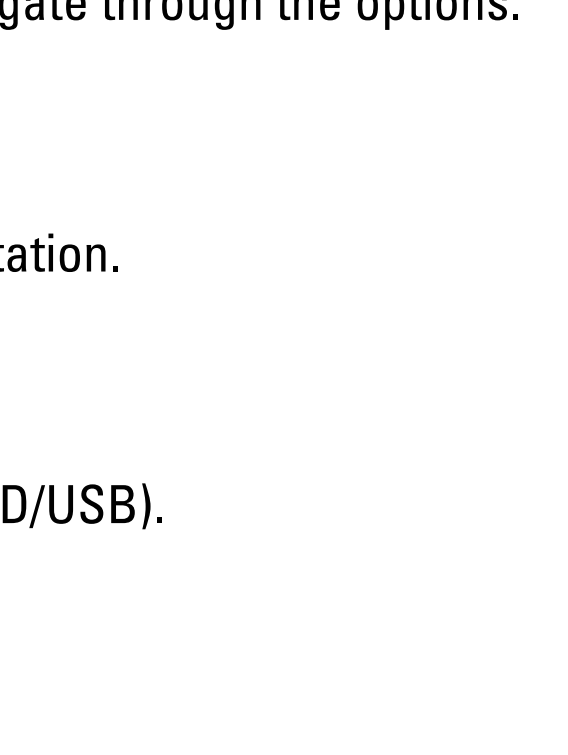

NOTICE

Do not insert an automotive type cigarette lighter element. This can overheat the power socket.

*if equipped

Steering Wheel Controls*

You can operate certain functions of the audio system using the steering wheel controls.

SOURCE button: Cycle through available audio modes.

◀/▶ buttons: Change presets, tracks, albums, or folders.

+/- buttons: Adjust audio volume.

MENU button: On vehicles with display audio, press and hold to view options for the current audio source. Use the other buttons to navigate through the options.

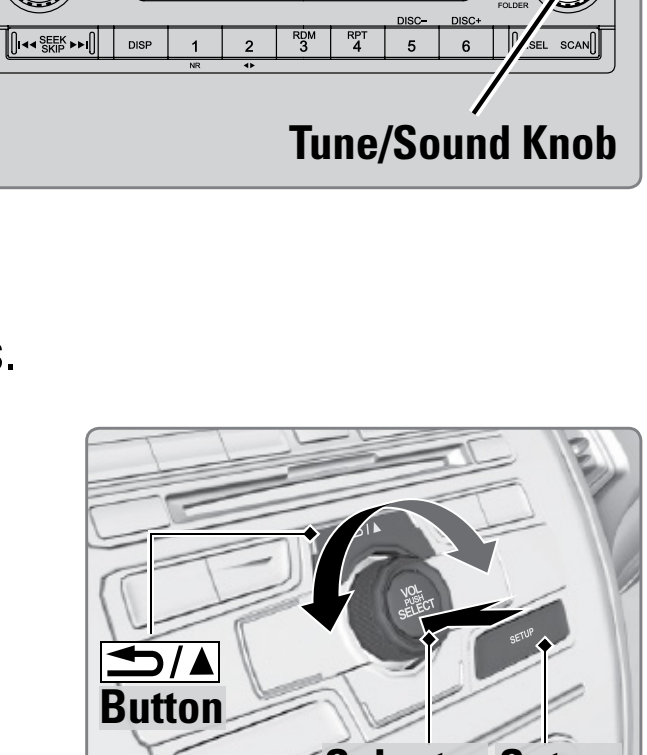

FM/AM/SiriusXM® Radio

Press **▶** or **◀** for the next or previous station.

Press and hold **▶** or **◀** for the next or previous strong station.

CD/iPod®/USB/Bluetooth® Audio

Press **▶** or **◀** for the next or previous track.

Press and hold **▶** or **◀** for the next or previous folder (CD/USB).

Pandora®

Press **▶** for the next song.

Press and hold **▶** or **◀** for the next or previous station.

Adjusting the Sound

Adjust various sound settings.

Vehicles with information display

Press the TUNE/SOUND knob to scroll through sound modes. Rotate the knob to adjust the setting for each mode.

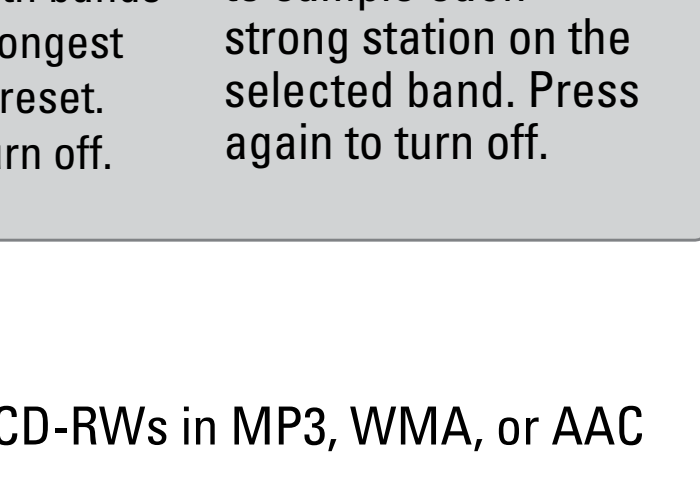

Vehicles with one display

Use the selector knob to make and enter selections.

1. Press the SETUP button.
2. Select Sound Settings.
3. Select a sound mode to change, and adjust it using the selector knob.
4. Press the Back button to exit the menu.

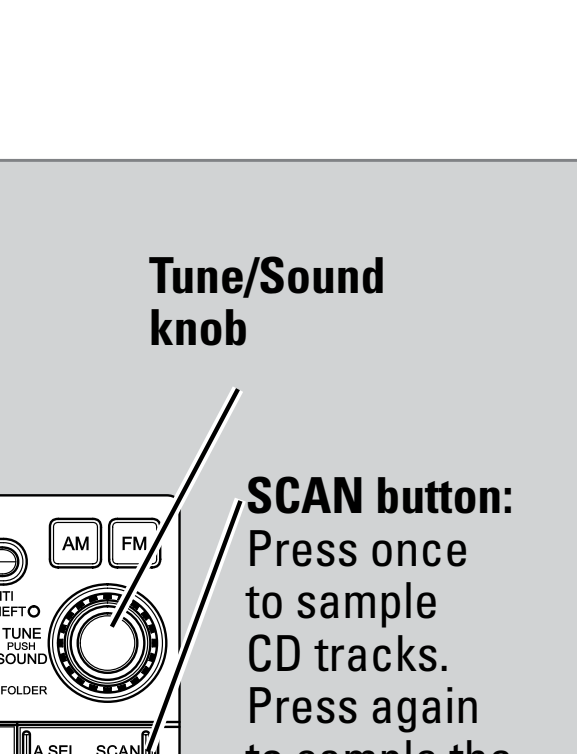

Vehicles with display audio

Make and enter selections using the touchscreen.

1. Select Settings.
2. Select Audio.
3. Select Sound.
4. Select the tabs to change the sound mode and adjust the setting.
5. Select OK when complete.

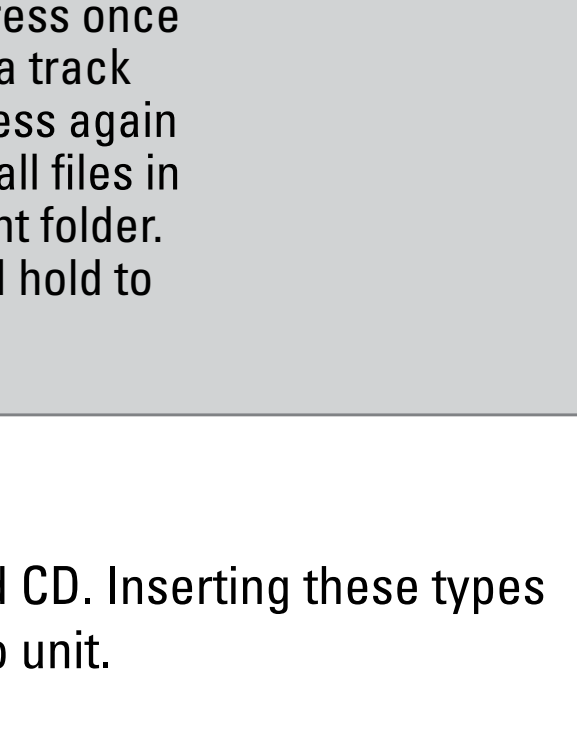

FM/AM Radio

Play FM or AM radio stations.

Models with information display

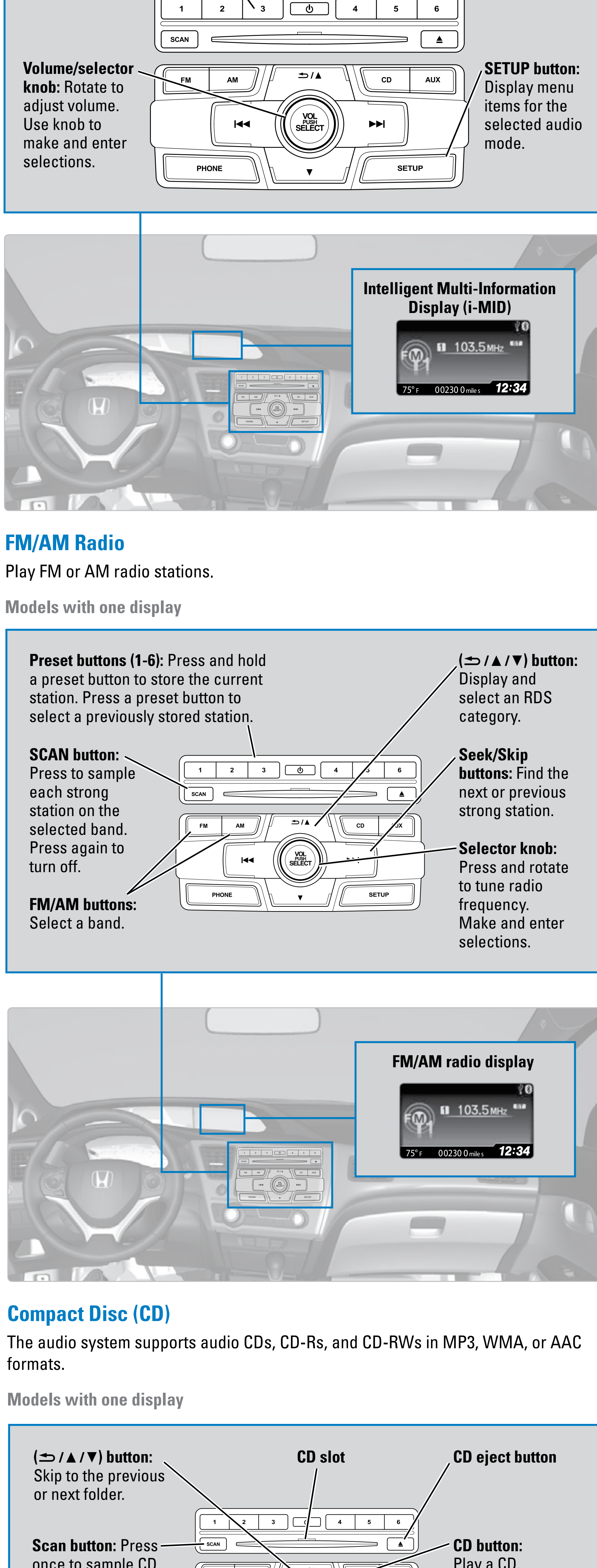

Compact Disc (CD)

The audio system supports audio CDs, CD-Rs, and CD-RWs in MP3, WMA, or AAC formats.

Models with information display

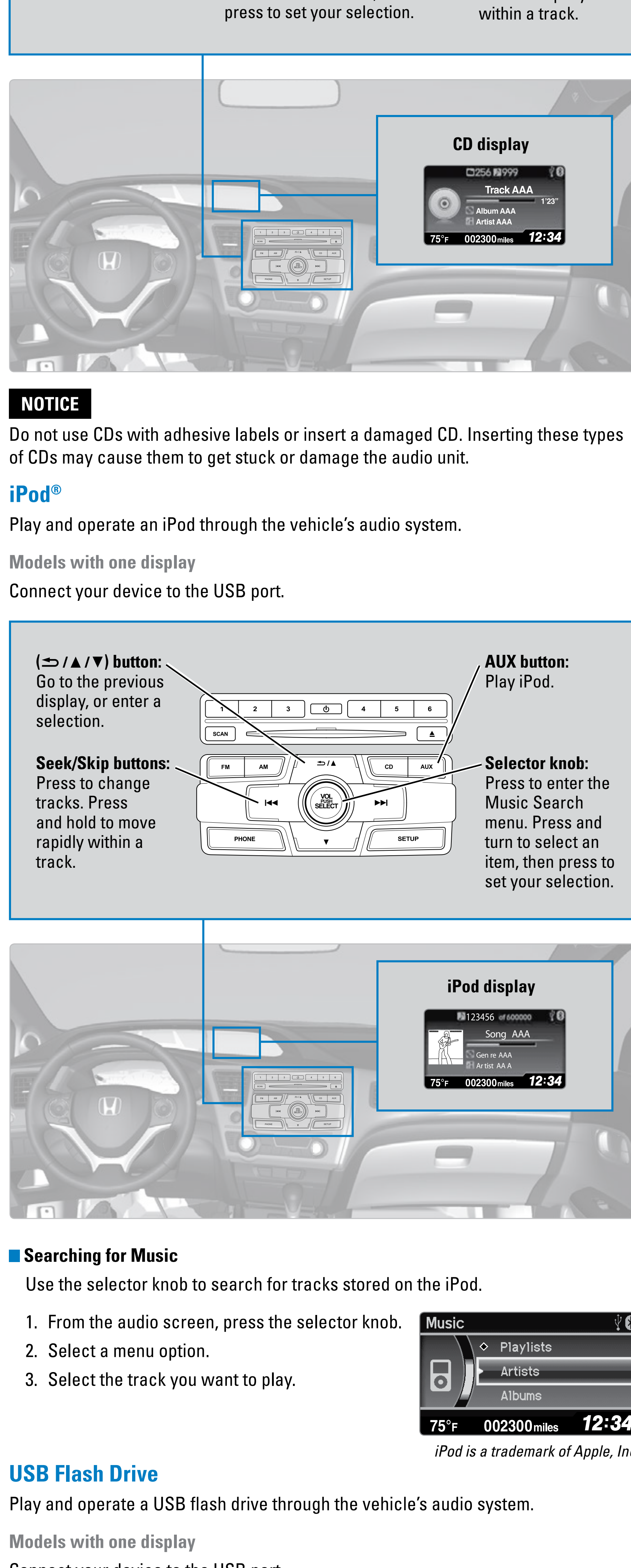

NOTICE

Do not use CDs with adhesive labels or insert a damaged CD. Inserting these types of CDs may cause them to get stuck or damage the audio unit.

One Display Audio Operation

Control audio operation in the intelligent Multi-Information Display (i-MID) using the dashboard buttons.

Models with one display

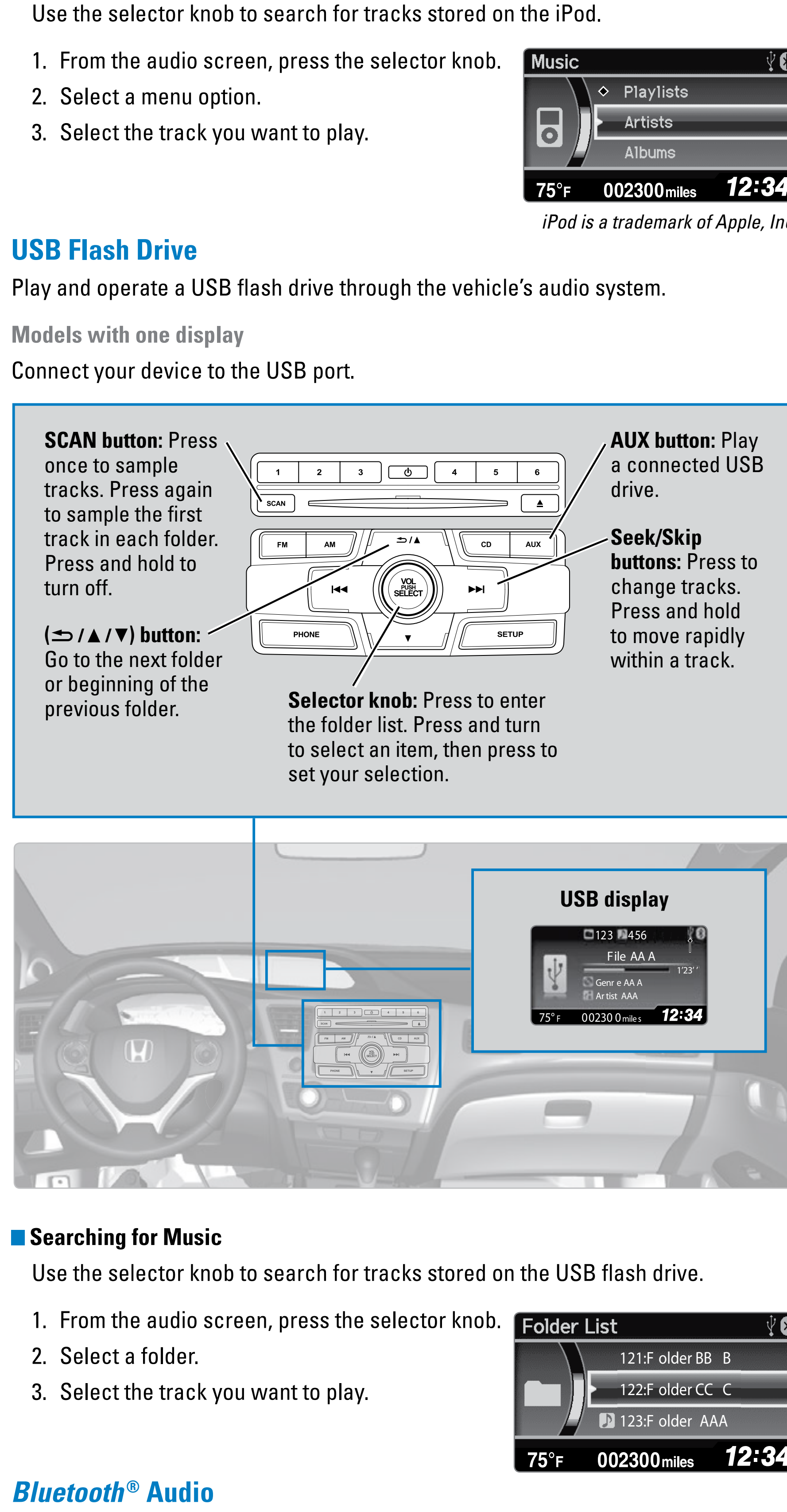

FM/AM Radio

Play FM or AM radio stations.

Models with one display

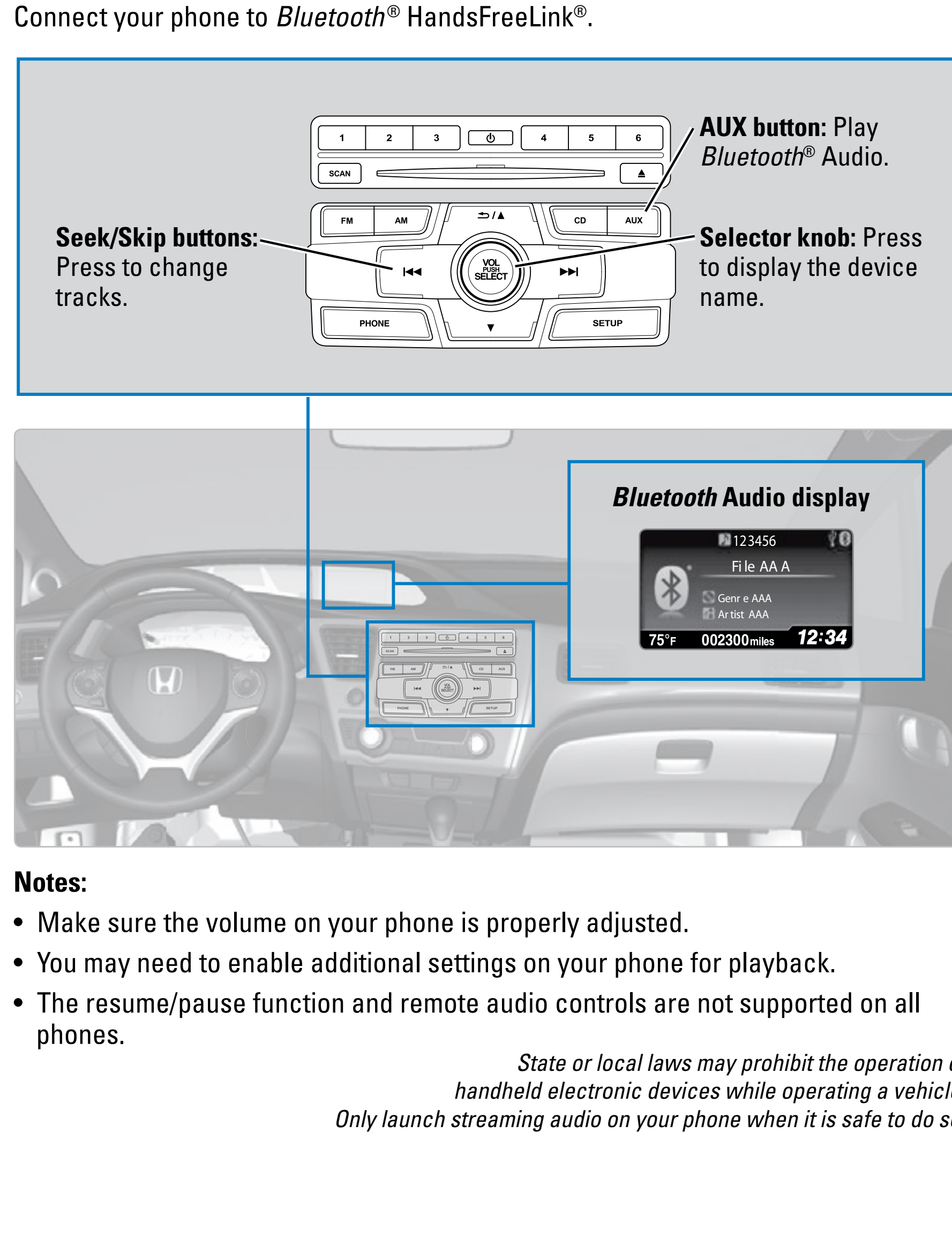

Compact Disc (CD)

The audio system supports audio CDs, CD-Rs, and CD-RWs in MP3, WMA, or AAC formats.

Models with one display

NOTICE

Do not use CDs with adhesive labels or insert a damaged CD. Inserting these types of CDs may cause them to get stuck or damage the audio unit.

iPod®

Play and operate an iPod through the vehicle's audio system.

Models with one display

Connect your device to the USB port.

Searching for Music

Use the selector knob to search for tracks stored on the iPod.

1. From the audio screen, press the selector knob.
2. Select a menu option.
3. Select the track you want to play.

iPod is a trademark of Apple, Inc.

USB Flash Drive

Play and operate a USB flash drive through the vehicle's audio system.

Models with one display

Connect your device to the USB port.

Searching for Music

Use the selector knob to search for tracks stored on the USB flash drive.

1. From the audio screen, press the selector knob.
2. Select a folder.
3. Select the track you want to play.

Bluetooth® Audio

Play streaming or stored audio from your compatible phone through the vehicle's audio system. Visit handfreeink.com (U.S.) or handfreeink.ca (Canada) to check phone compatibility. Standard data rates apply.

Models with one display

Connect your phone to Bluetooth® HandsFreeLink®.

Notes:

- Make sure the volume on your phone is properly adjusted.
- You may need to enable additional settings on your phone for playback.
- The resume/pause function and remote audio controls are not supported on all phones.

State or local laws may prohibit the operation of handheld electronic devices while operating a vehicle. Only launch streaming audio on your phone when it is safe to do so.