

Customized Features*

Use the Vehicle Menu in the i-MID to customize certain features, such as the display, the trip computer, and door locking/unlocking. Use the steering wheel controls to make and enter selections when the vehicle is stopped.

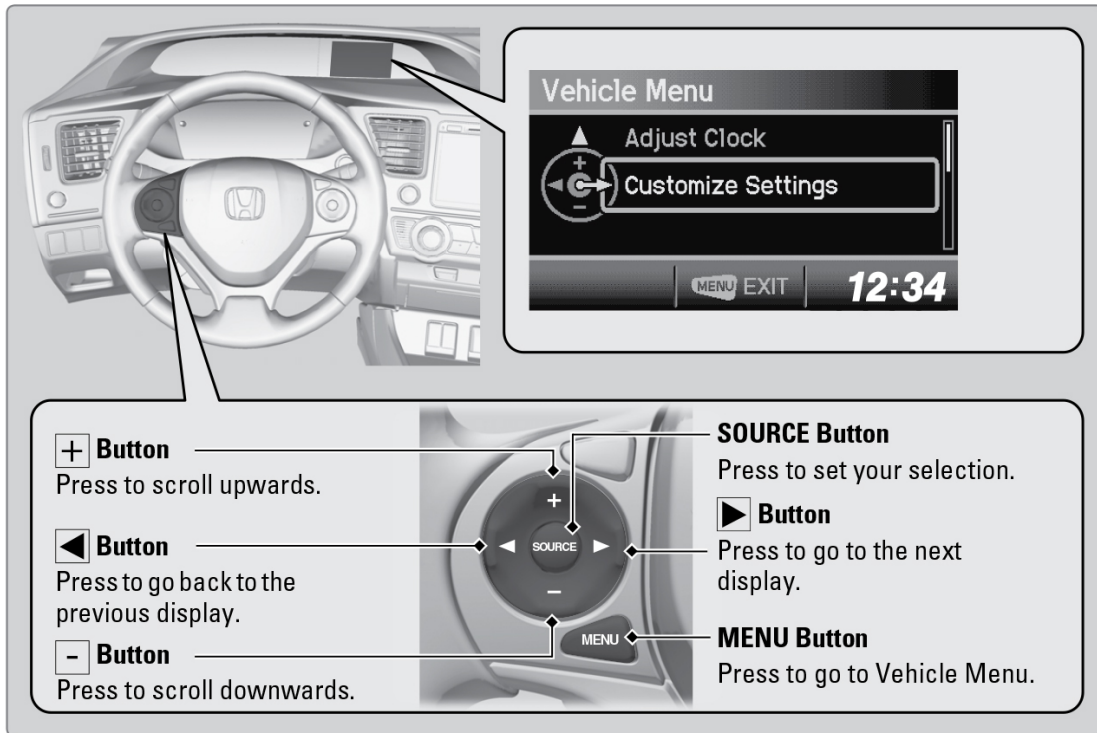

■ Changing Settings Using the Touchscreen*

Select items on the touchscreen to make and enter selections.

1. Select SETTINGS.
2. Select an option (Clock/Info, Audio, Bluetooth, Phone, Camera, System, or Navi*).
3. Select a setting option, and make your preferred changes.
4. Press BACK to exit the menus.

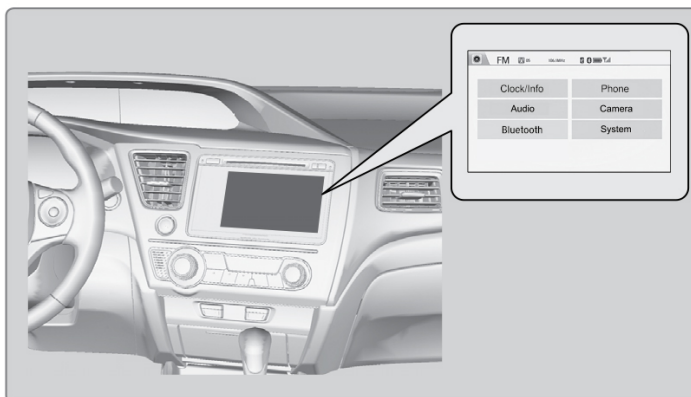

**if equipped*