

## Remote Engine Start\*

Start your vehicle's engine using the remote transmitter before you enter the vehicle.

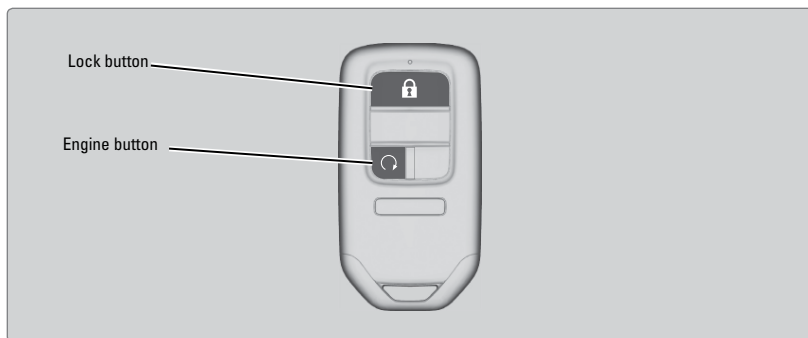

Make sure the vehicle is in a safe location when using remote engine start (i.e., a well ventilated, outside area, away from any flammable materials).

### ■ Starting the Engine

Press the Lock button, then press and hold the Engine button within 5 seconds to remotely start the engine.

The engine runs for up to 10 minutes.

- If it is warm outside, the air conditioning is activated in recirculation mode.
- If it is cold outside, the defroster is activated at a moderately warm temperature, the rear defogger, door mirror heaters, and front seat heaters\* are activated.

To extend the run time for another 10 minutes, repeat the procedure during the initial 10 minutes.

### ■ Stopping the Engine

Press and hold the Engine button.

The engine will also stop if it has been running for more than 10 minutes, or if any door is opened without using the remote or smart entry.

#### **WARNING**

Engine exhaust contains toxic carbon monoxide gas.

Breathing carbon monoxide can kill you or cause unconsciousness.

Never use the remote engine starter when the vehicle is parked in a garage or other area with limited ventilation.