

Driver Information Interface (DII)

Consists of several displays that provide you with useful information.

Press the Display/Information button to see the current display.

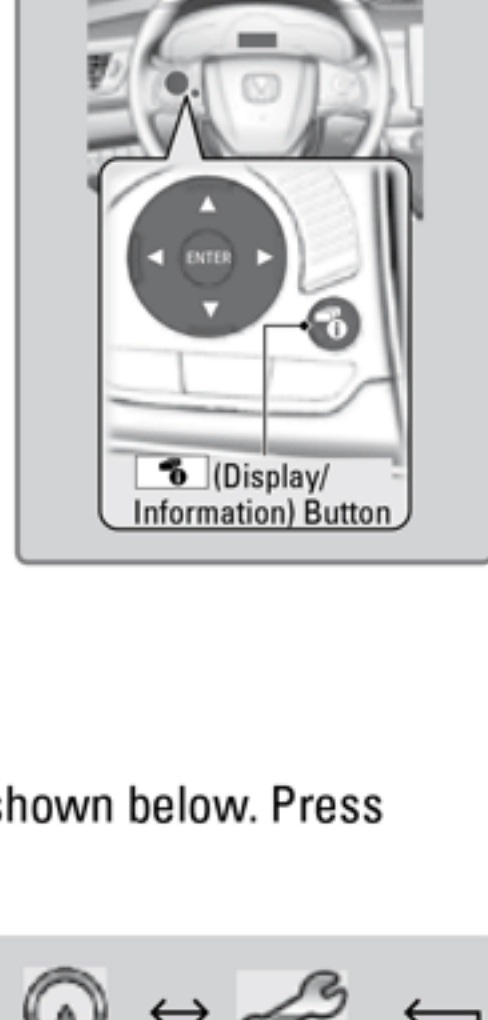

Main Displays

Press ◀ or ▶ button to cycle through the displays shown below. Press ENTER to see detailed information.

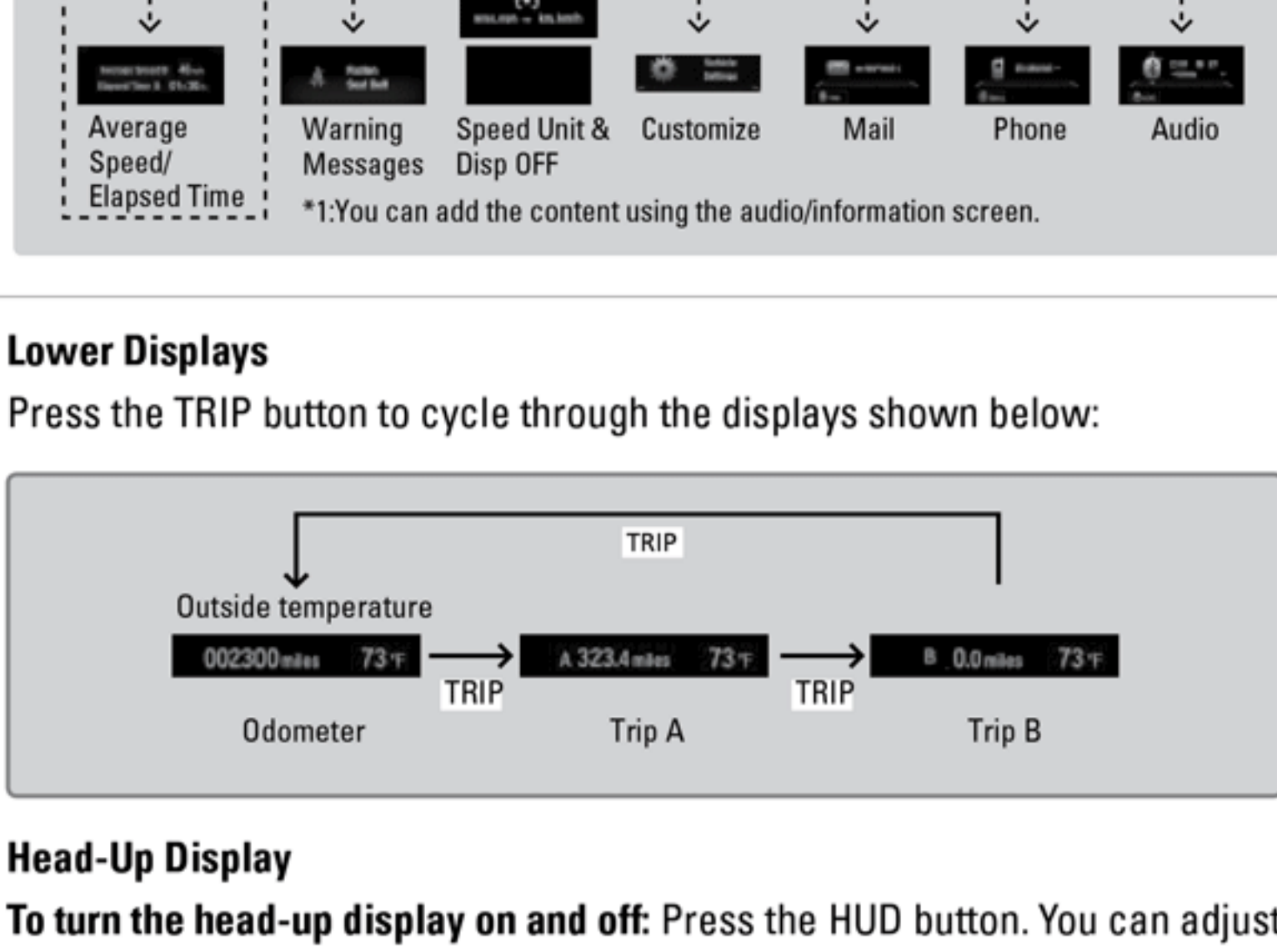

Lower Displays

Press the TRIP button to cycle through the displays shown below:

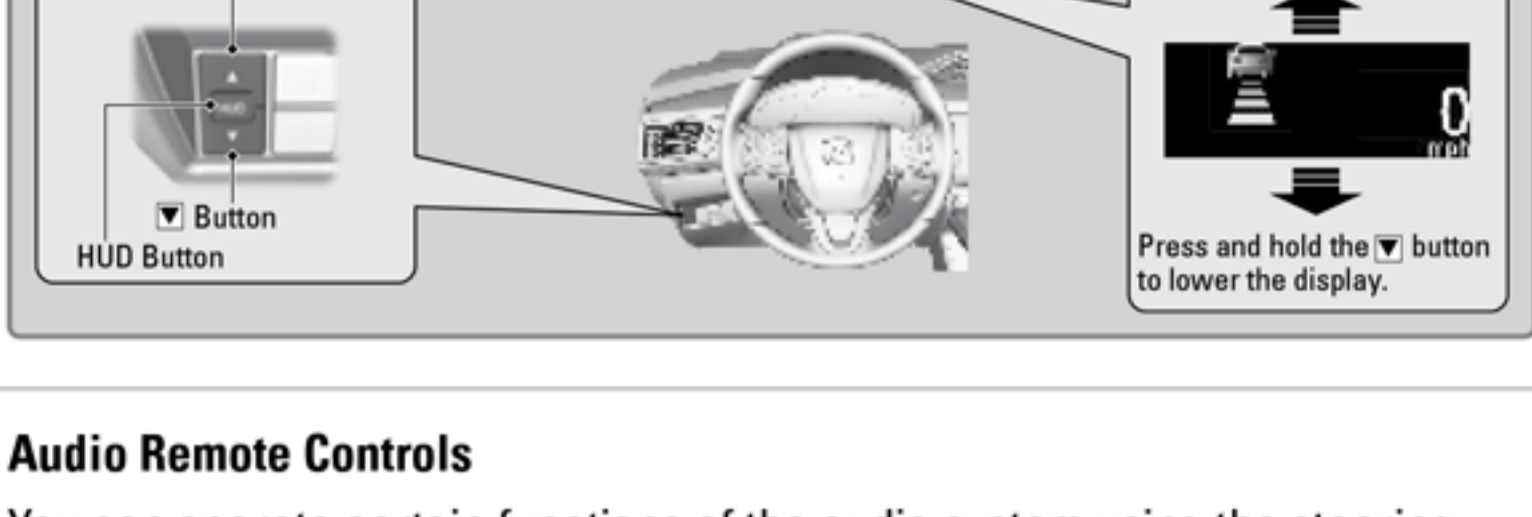

Head-Up Display

To turn the head-up display on and off: Press the HUD button. You can adjust the display up and down to match your eye level.

To raise or lower the head-up display: Press and hold the (▲/▼) button until the desired position is reached.

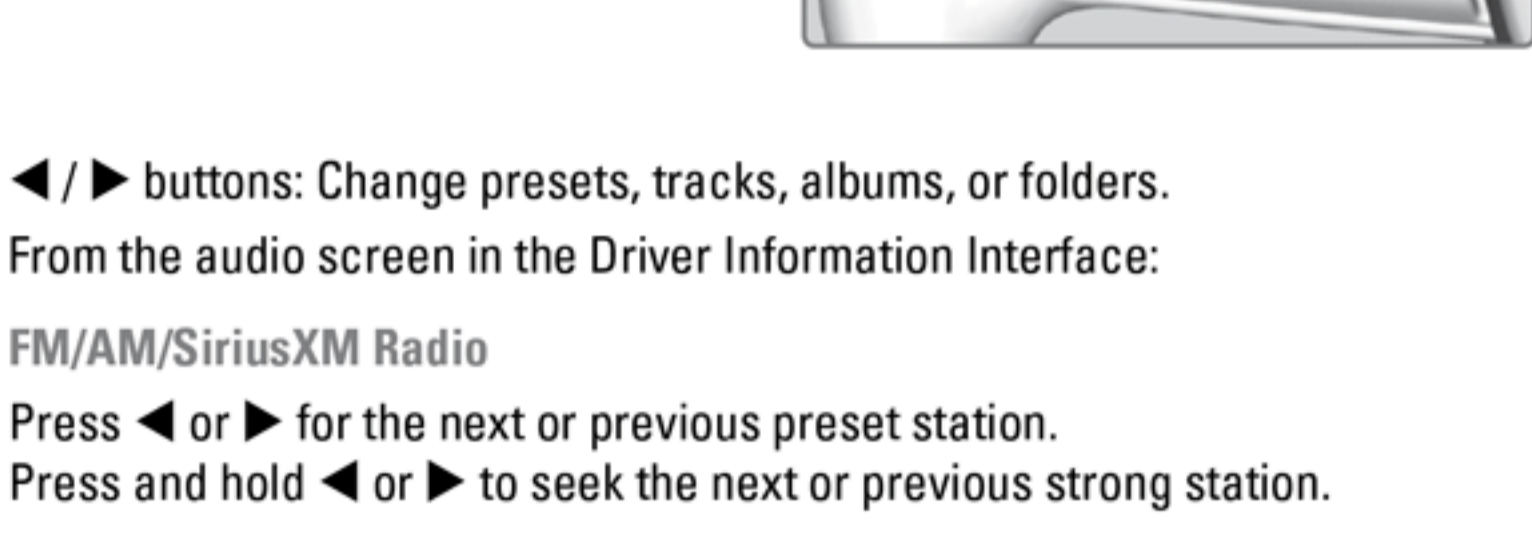

Audio Remote Controls

You can operate certain functions of the audio system using the steering wheel controls.

Phone button: Press until the audio screen is displayed in the Driver Information Interface.

+ / - bar: Press the ends of the bar to adjust audio volume.

ENTER button: Make audio selections in the Driver Information Interface.

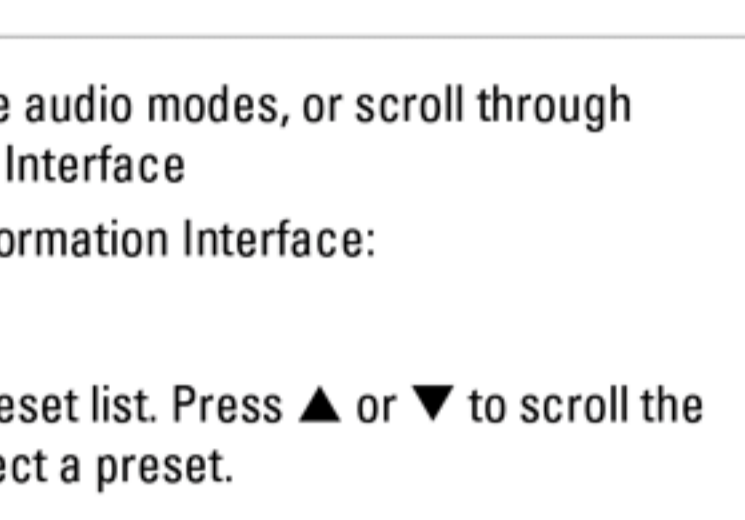

◀ / ▶ buttons: Change presets, tracks, albums, or folders.

From the audio screen in the Driver Information Interface:

FM/AM/SiriusXM Radio

Press ◀ or ▶ for the next or previous preset station.

Press and hold ◀ or ▶ to seek the next or previous strong station.

iPod/USB/Bluetooth Audio

Press ◀ or ▶ for the next or previous track.

Press and hold ◀ or ▶ for the next or previous folder (USB).

Pandora

Press ▶ for the next song.

Press and hold ◀ or ▶ for the previous or next station.

▲ / ▼ buttons: Cycle through available audio modes, or scroll through audio options in the Driver Information Interface

From the audio screen in the Driver Information Interface:

FM/AM/SiriusXM Radio

Press the ENTER button to display a preset list. Press ▲ or ▼ to scroll the list, and press the ENTER button to select a preset.

USB Flash Drive

Press the ENTER button to display the folder list. Press ▲ or ▼ to scroll the list, and press the ENTER button to select a folder. Repeat to select a track.

iPod

Press the ENTER button to display the iPod list. Press ▲ or ▼ to scroll the category, and press the ENTER button to select an item. Repeat to select a track.

Bluetooth Audio

Press the ENTER button to display the track list. Press ▲ or ▼ to scroll the list, and press the ENTER button to select a track.

Pandora

Press the ENTER button to display the station list. Press ▲ or ▼ to scroll the list, and press the ENTER button to select a station.

Adjusting the Sound

Adjust various sound settings.

Using the touchscreen

1. Touch items on the screen to make and enter selections.
2. From the HOME screen, select Audio.
3. Select Menu.
4. Select Sound.
5. Select the tabs to change the sound mode and adjust the setting.
6. Select OK when complete.

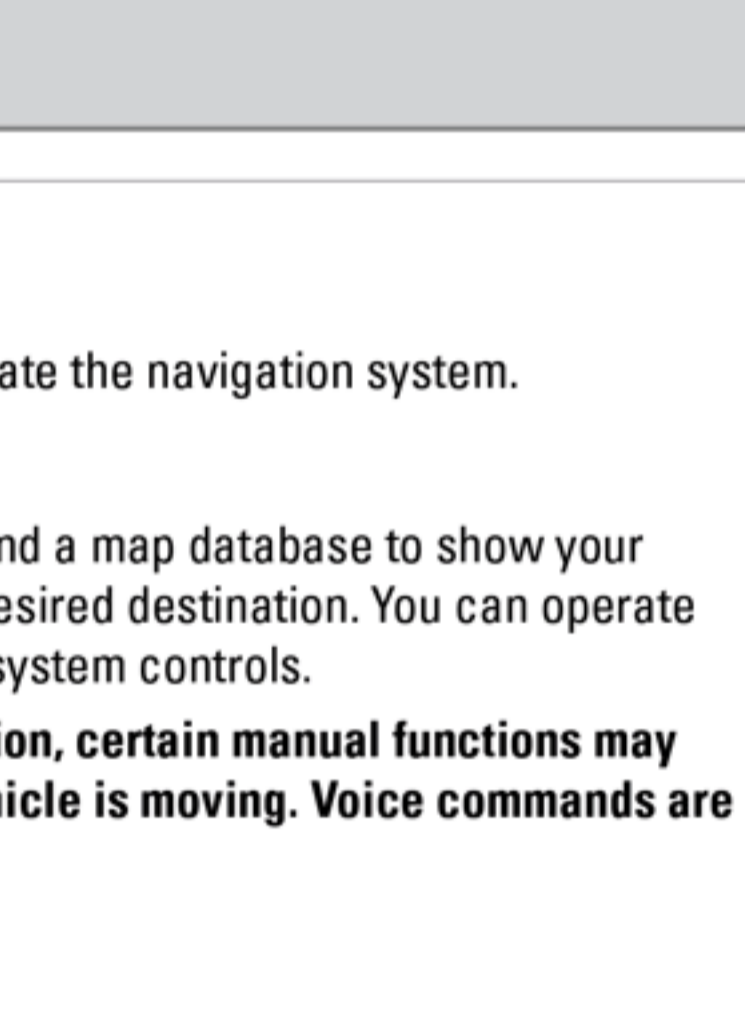

BLUETOOTH HANDSFREELINK® (HFL)

Basic HFL Operation

Make and receive phone calls using the vehicle's audio system, without handling your phone. Visit automobiles.honda.com/handsfreelink to check phone compatibility.

To reduce the potential for driver distraction, certain manual functions may be inoperable or grayed out while the vehicle is moving. Stop or pull over to perform the function. Voice commands are also available.

HFL Controls

Use the controls to enter information and make selections.

Hang-Up/Back button: End or decline a call, or cancel an operation.

Pick-Up button: Answer an incoming call.

Talk button: Make a call using a stored voice tag, or say voice commands.

Phone button: Press until the phone screen is displayed in the Driver Information Interface.

▲ / ▼ buttons: Press to scroll through the contact list in the Driver Information Interface.

ENTER button: From the phone screen in the Driver Information Interface, select from Speed Dial, Call History, or Phonebook.

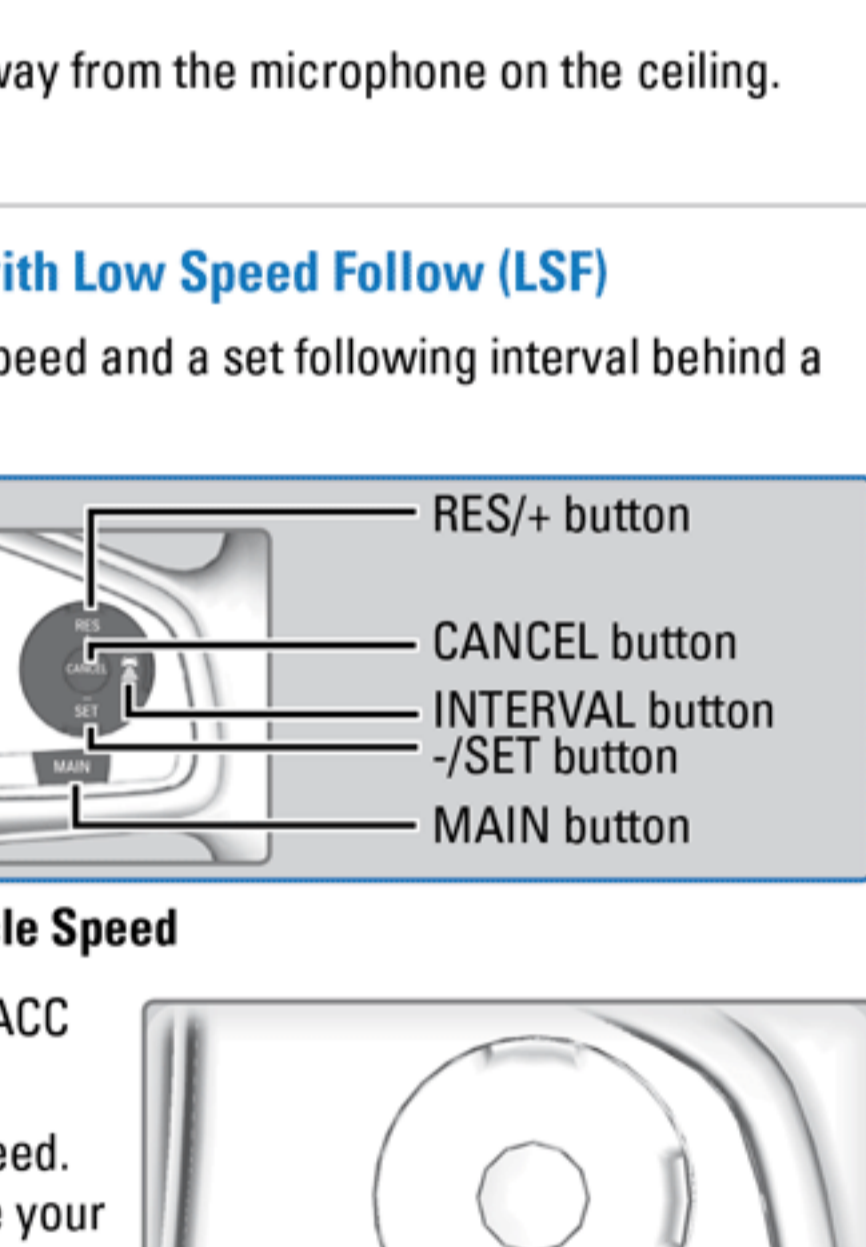

NAVIGATION

Learn how to enter a destination and operate the navigation system.

Basic Navigation Operation

A real-time navigation system uses GPS and a map database to show your current location and help guide you to a desired destination. You can operate the system using voice commands or the system controls.

To reduce the potential for driver distraction, certain manual functions may be inoperable or grayed out while the vehicle is moving. Voice commands are always available.

Steering Wheel Controls

Use the steering wheel controls to say voice commands.

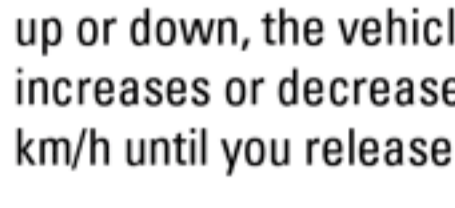

Back button: Press to cancel a command or operation.

Talk button: Press to say navigation commands.

Talk Button Tips

- The system recognizes only the commands listed in the Voice Command Index
- When using the Talk button, wait until you hear a beep before speaking.
- To bypass the system prompts, simply press the Talk button again to say your command.
- When the Talk button is pressed, all available voice commands are highlighted in yellow.
- Speak in a clear, natural voice.
- Reduce all background noise.
- Adjust the dashboard vents away from the microphone on the ceiling.
- Close the windows.

Adaptive Cruise Control (ACC) with Low Speed Follow (LSF)

Helps maintain a constant vehicle speed and a set following interval behind a vehicle detected ahead of yours.

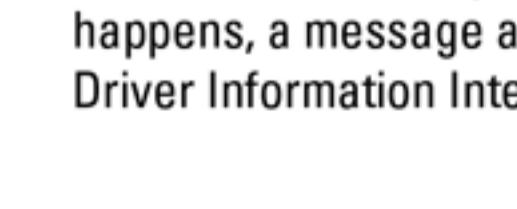

RES/+ button

CANCEL button

INTERVAL button

-/SET button

MAIN button

Activating and Setting the Vehicle Speed

1. Press the MAIN button. The ACC indicator appears.

2. Accelerate to the desired speed. *Above 25 mph (40 km/h):* Take your foot off the pedal and press the -/SET button to set the speed

Below 25 mph (40 km/h) (Low Speed Follow):

Press the -/SET button to set the speed at 25 mph (40 km/h) if a vehicle is detected in front of you.

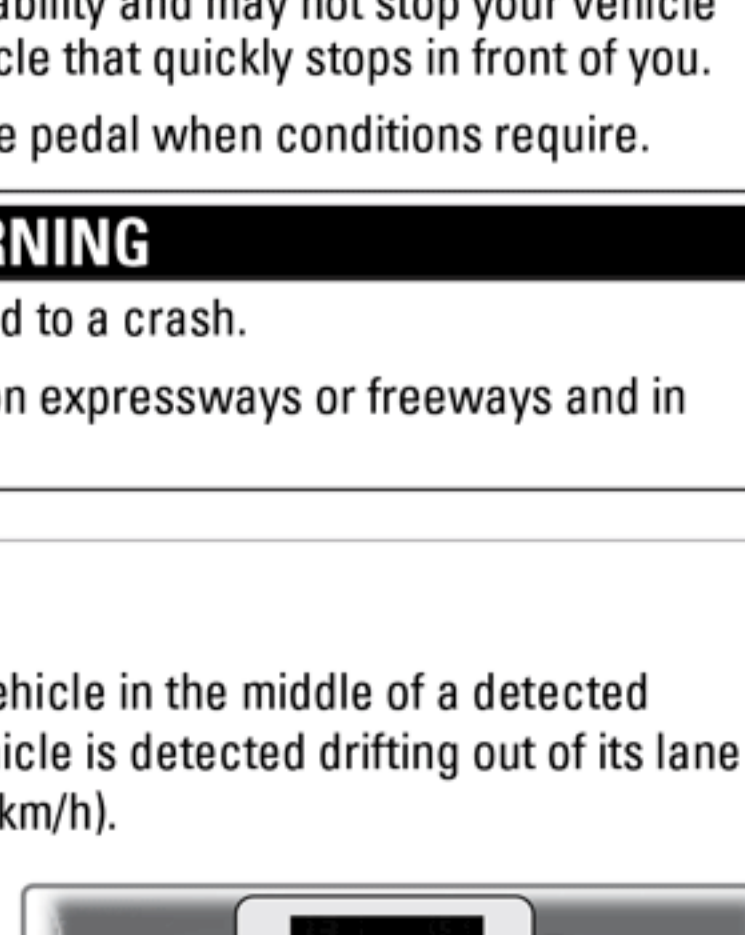

Adjusting the Vehicle Speed

Press the RES/+ button to increase speed, or the -/SET button to decrease speed.

Each time you press the switch up or down, the vehicle speed is increased or decreased by about 1 mph or 1 km/h. If you keep the switch pressed up or down, the vehicle speed increases or decreases by 5 mph or 5 km/h until you release it.



Adjusting the Following Interval

Press the Interval button to change the following interval. Each time you press the button, the following-interval setting cycles through short, middle, long, and extra long.



Interval	Short	Middle	Long	Extra Long
Approx. Gap (seconds)	1.1	1.5	2.1	2.8

Switching to Standard Cruise Control

- Press and hold the Interval button.
- Cruise mode appears in the Driver Information Interface. Press and hold the Interval button again to switch back to ACC.

Canceling ACC

Press the CANCEL or MAIN buttons, or press the brake pedal.

Certain conditions may cause ACC to cancel automatically. When this happens, a message appears on Driver Information Interface.

After adaptive cruise control has been canceled, you can still resume the prior set speed by pressing the RES/+ button.

Press the MAIN button to turn the system off.

⚠ WARNING
Exiting a vehicle that has been stopped while the ACC with LSF system is operating can result in the vehicle moving without operator control. A vehicle that moves without operator control can cause a crash, resulting in serious injury or death. Never exit a vehicle when the vehicle is stopped by ACC with LSF.

⚠ WARNING
ACC with LSF has limited braking capability and may not stop your vehicle in time to avoid a collision with a vehicle that quickly stops in front of you. Always be prepared to apply the brake pedal when conditions require.

⚠ WARNING
Improper use of ACC with LSF can lead to a crash. Use ACC with LSF only when driving on expressways or freeways and in good weather conditions.

Lane Keeping Assist System (LKAS)

Provides steering input to help keep the vehicle in the middle of a detected lane and visual and tactile alerts if the vehicle is detected drifting out of its lane while driving between 45–90 mph (72–145 km/h).

If your vehicle is getting too close to detected left or right side lane markings without a turn signal activated, a message appears on the Driver Information Interface, and the steering wheel vibrates. Steering torque is also applied to help keep your vehicle within your driving lane.

Turning the System On or Off

1. Press the MAIN button. LKAS appears in the Driver Information Interface.

2. Press the LKAS button. Lane outlines appear in the Driver Information Interface. Dotted lane lines turn solid when the system starts operating.

3. Press the MAIN button or the LKAS button to turn the system off.

Important Safety Reminder

LKAS is for your convenience only. It is not a substitute for your vehicle control. The system does not work if you take your hands off the steering wheel or fail to steer the vehicle.

Do not place an object on the top of the instrument panel. It may reflect onto the windshield and prevent the system from detecting lane lines properly.