

## Wiper Operation

The windshield wipers and washers can be used when the vehicle is on.

### ■ Front Wipers

Move the wiper lever up or down to the desired position.

### ■ Headlight-Wiper Integration\*

When the headlights are in the AUTO position, they automatically turn on when the front wipers operate several times within a certain interval. The headlights turn off shortly after the wipers are turned off, or if there is enough ambient light.

### ■ Rear Wiper

Rotate the end of the wiper lever to the desired position.

When you shift to Reverse (R) and the front wipers are activated, the rear wiper activates even if the switch is off.

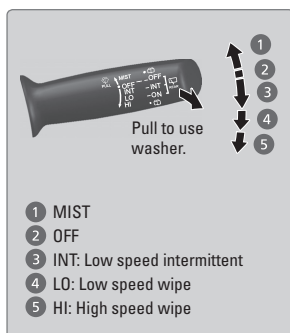

## NOTICE

Do not use the wipers when the windshield is dry. The windshield will get scratched, or the rubber blades will get damaged.

In cold weather, the blades may freeze to the windshield, becoming stuck. Operating the wipers in this condition may damage the wipers. Use the defroster to warm the windshield, or manually clear the windshield of ice and snow before turning on the wipers.