

# NAVIGATION\*

Learn how to enter a destination and operate the navigation system.

## Basic Navigation Operation

A real-time navigation system uses GPS and a map database to show your current location and help guide you to a desired destination. You can operate the system using voice commands or the system controls.

**To reduce the potential for driver distraction, certain manual functions may be inoperable or grayed out while the vehicle is moving. Voice commands are always available.**

### Steering Wheel Controls

Use the steering wheel controls to give voice commands.

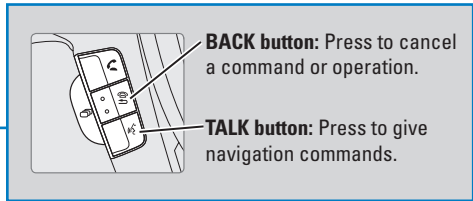
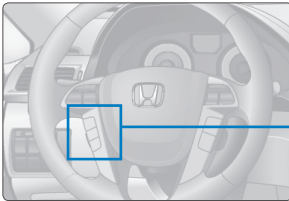

### Talk Button Tips

- When using the Talk button, wait for the beep before saying a command.
- To bypass the system prompts, simply press the Talk button again to say your command.
- When the Talk button is pressed, all available voice commands are highlighted in yellow.
- The system recognizes only the commands listed in the Voice Command Index
- Speak in a clear, natural voice.
- Reduce all background noise.
- Adjust the dashboard and side vents away from the microphone in the ceiling.
- Close the windows and moonroof.

## WARNING

Using the navigation system while driving can take your attention away from the road, causing a crash in which you could be seriously injured or killed.

Operate system controls only when the conditions permit you to safely do so.

## Navigation Display and Controls

Use the controls to enter information and make selections.

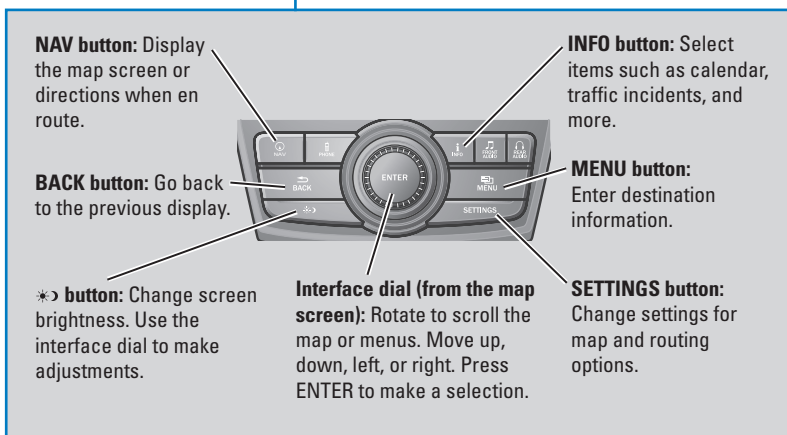
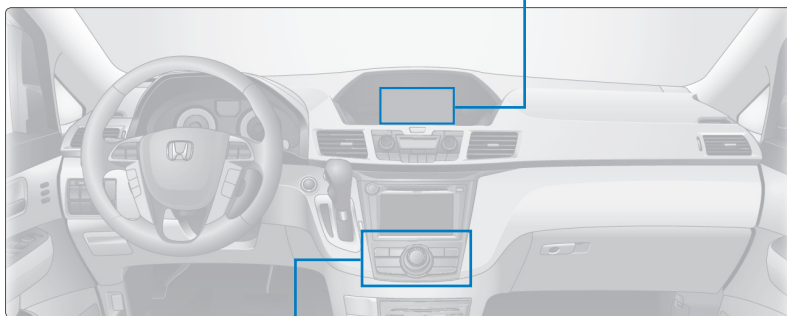
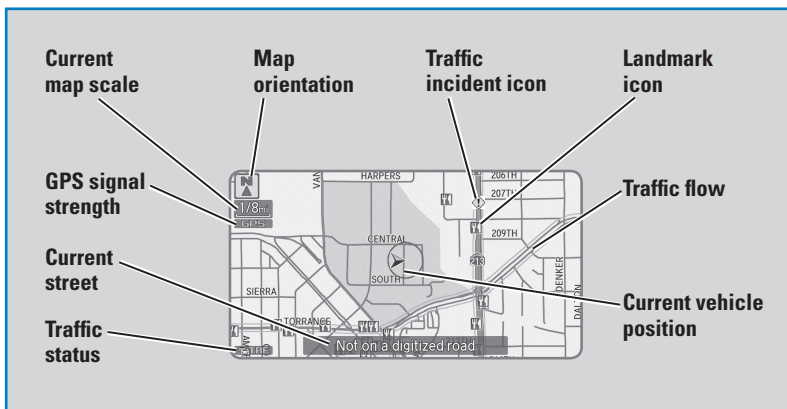

## Interface Dial Feedback

Configure the system to read aloud selections made using the interface dial. Use the interface dial to make and enter selections.

1. Press **SETTINGS**.
2. Select System Settings.
3. Select Interface Dial Feedback.
4. Select Off, Auto, or On.

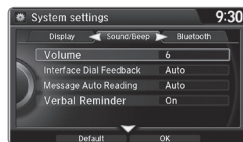

**On:** Always reads the selection.

**Auto:** Reads the selection only when the vehicle is moving.

**Off:** Turns interface dial feedback off.

## System Guidance Volume

Adjust the navigation system volume. This does not affect audio or *Bluetooth* HandsFreeLink volume, which is controlled by the volume knob. Use the interface dial to make and enter selections.

1. Press **SETTINGS**.
2. Select System Settings.
3. Select Volume.
4. Adjust the level, or select off.



## Voice Prompt

Turn the voice feedback feature on or off. Use the interface dial to make and enter selections.

1. Press **SETTINGS**.
2. Select System Settings.
3. Select Voice Rec.
4. Select Voice Prompt.
5. Select On or Off.

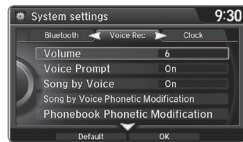

## Voice Prompt Volume

Adjust the voice prompt volume when they are turned on. Use the interface dial to make and enter selections.

1. Press **SETTINGS**.
2. Select System Settings.
3. Select Voice Rec.
4. Select Volume.
5. Adjust the level, or select Off.

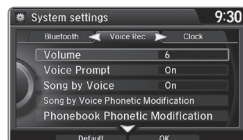

## Entering a Destination

Use multiple methods to enter a destination.

### ■ Home Address

Store your home address in the system so you can easily route to it. Use the interface dial to make and enter selections.

1. Press SETTINGS.
2. Select Navi Settings.
3. Select Edit Go Home.
4. Enter the address, and select OK when complete.

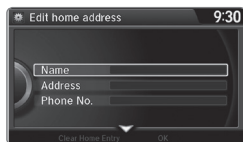

When your home address is stored, you can press the Talk button and say “Go home” at any time. You can also select Go home from the destination menu.

### ■ Street Address

Enter a street address using voice commands. Press the Talk button before saying each command.

1. Say “Address.”
2. Say “Street,” then say the street name on the next screen. For Canadian vehicles, spell the street name one letter at a time. Do not include the direction (N, S, E, W) or type (St., Ave., Blvd., etc.).
3. A list of street names appears. Say the number next to the street you want to select.
4. Say the entire street address number. For example, “1-2-3-4.” If necessary, say “OK” to proceed.
5. If the street address is in more than one city, a list of city names appears. Say the number next to the city you want to select.
6. Say “Set as destination” to set the route.

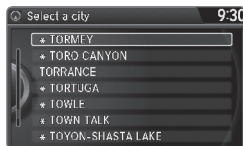

## Place Category

Enter a destination using a point of interest or landmark using the interface dial.

1. Press MENU.
2. Select Place Category.
3. Select a category and a subcategory. For example, Auto Service followed by Honda Dealers.
4. Select a search method, such as Sort by Distance to Travel.
5. A list of places appears. Scroll the list to select the place you want.
6. Select Set as Destination to set the route.



## Find Nearest Place

Enter a destination by category and distance using voice commands. Press the Talk button before saying each command.

1. Say *"Find nearest"* and a place. For example, *"Find nearest ATM."*
2. A list of the nearest places in your area is displayed by shortest distance to destination.
3. Say the number next to the destination you want to select.
4. Say *"Set as destination"* to set the route.



## Routing

After a destination is set, you can alter or cancel your route.

### Map Legend

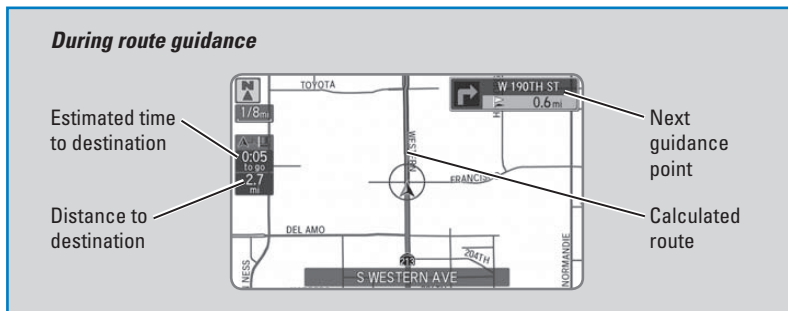

### Taking a Detour

You can calculate a detour route manually if you encounter a road closure or other obstacle. Use the interface dial to make and enter selections.

1. When en route, press DEST/ROUTE.
2. Select Detour. The system attempts to calculate a new route by avoiding the next 5 miles (8 km) while on a freeway or 1 mile (1 km) while on a surface street.



### FM Traffic

View traffic flow, incidents, and construction in major metro areas. You can also route around congestion or incidents using voice commands. Press the Talk button before saying each command.

1. When en route, say *"Display traffic on my route."* A list of incidents on your route appears.
2. Say the number of the incident you want to avoid.
3. Say *"Avoid"* and the incident list returns.
4. Say *"Reroute"* to set the new route.



### Canceling Your Route

You can cancel your route at any time. Press the Talk button and say *"Cancel route."* You can also use the interface dial to make and enter selections.

1. When en route, press DEST/ROUTE.
2. Select Cancel Route. The route is cleared and the map screen returns.

