

Door Operation

Use several methods to lock or unlock the doors.

■ Using the Lock Tab

To unlock: When you unlock either front door using the lock tab, the specific door (driver's or passenger's) unlocks.

To lock: When you lock the door using the lock tab on the driver's door, all the other doors and tailgate lock at the same time. When you lock the door using the lock tab on the front passenger's door, only that door locks.

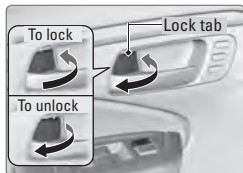

■ Using the Front Door Inner Handle

When you pull either front door inner handle, the door unlocks and opens.

Unlocking and opening the driver's door from the inner handle unlocks all the other doors.



■ Using the Master Door Lock Switch

To unlock: Press the unlock side of the switch to unlock all doors and the tailgate.

To lock: Press the lock side of the switch to lock all doors and the tailgate.

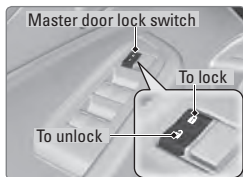

■ Childproof Door Locks

The childproof door locks prevent the rear doors from being opened from the inside regardless of the position of the lock tab.

Slide the lever in the rear door to the lock position, and close the door.

Open the door using the outer door handle.

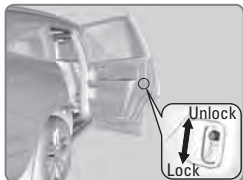

■ Customizing Door Lock Settings

Customize the auto door-lock setting to your preference. Begin with the vehicle off.

Models with color audio

1.	Apply the parking brake	
2.	Position the driver's door	
	<i>To enable auto door lock:</i> close the driver's door	<i>To disable auto door lock:</i> open the driver's door
3.	Set your preference	
	a. Push ENGINE START/STOP twice (do not press the brake pedal)	
	b. Press the lock side of the master door lock switch until you hear a click (~ 5 sec.)	
	c. Push ENGINE START/STOP twice (do not press the brake pedal)	

Models with Display Audio

See Customized Features.

■ Walk Away Auto Lock

When you walk away from the vehicle while carrying the remote transmitter, the doors can automatically lock if the following conditions are met:

- The remote transmitter is within a range of 6 feet (2 m).
- All doors and the hood are closed.
- There is not an additional remote transmitter inside the vehicle.

Follow these steps (see diagram):

1. Exit the vehicle, close the door and stay near it. Listen for a beep. The system is activated.
2. Walk at least 6 feet (2 m) away.
3. Listen for a beep and look for the lights to flash. The doors lock.

To turn on this feature, follow the steps below:

1. From the HOME screen, select Settings.
2. Select Vehicle. The vehicle must be in Park (P).
3. Select Door/Window Setup.
4. Select Walk Away Auto Lock.
5. Select On.
6. Select BACK to exit the menus.

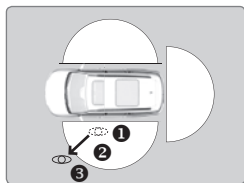

Tailgate Operation

When all the doors are unlocked, the tailgate is unlocked. See power tailgate operation.

To open the tailgate, press the tailgate release button under the tailgate handle. Lift open the tailgate.

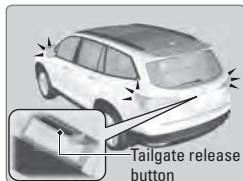

To close the tailgate, grab the inner handle, pull the tailgate down, and push it closed from the outside.

