

# VEHICLE CONTROLS

Learn about the various controls necessary for operating and driving the vehicle.

## Using the Smart Entry Remote

Lock or unlock the doors and trunk.

**Unlock button:** Press once to unlock the driver's door. Press again to unlock all doors.

**CLIMATE button:** Press and hold to remotely start the climate control system.



**Lock button:** Press to lock the doors. Press again for audible verification.

**Trunk button:** Press and hold to unlock and open the trunk.

**Panic button:** Press to sound the alarm for 30 seconds. Press again to cancel.

**Built-in key:** Slide the release knob on the back of the transmitter to pull out the built-in key.

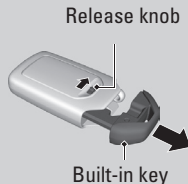

### NOTICE

Leaving the smart entry remote in the vehicle can result in theft or accidental movement of the vehicle. Always take it with you whenever you leave the vehicle unattended.