

## Panoramic Roof\*

The ceiling cover in the second row can be opened and closed to reveal the glass roof when the vehicle is on by using the switch on the ceiling.

### ■ Automatic Operation

**To open:** Push the switch back firmly, then release.

**To close:** Push the switch forward firmly, then release.

The cover opens completely. To stop the cover in either direction, push the switch briefly.

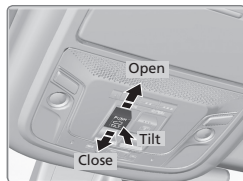

### ■ Manual Operation

**To open:** Push and hold the switch back lightly until the desired position is reached.

**To close:** Push and hold the switch forward lightly until the desired position is reached.

## WARNING

Closing the cover on someone's hands or fingers can cause serious injury. Make sure your passengers are away from the cover before closing it.

*\*if equipped*