

## Models with touchscreen

## Pandora®\*

Play and operate Pandora from your compatible phone through the vehicle's audio system. Visit [automobiles.honda.com/handsfreelink/](http://automobiles.honda.com/handsfreelink/) to check phone compatibility. Standard data rates apply with your phone service provider. **Available in the U.S. only.**

Connect your phone when the vehicle is stopped.

**For iPhone:**

- Connect via *Bluetooth* HandsFreeLink or USB port.
- A pop-up may appear on your phone requesting you to allow access for Pandora to be launched.
- If you cannot operate Pandora through the audio system, it may be streaming through *Bluetooth Audio*. Make sure Pandora is selected on the audio system.
- If Pandora still does not operate, try rebooting the phone and reconnecting the cable if necessary.

**For other compatible smartphones:**

- Connect via *Bluetooth* HandsFreeLink.

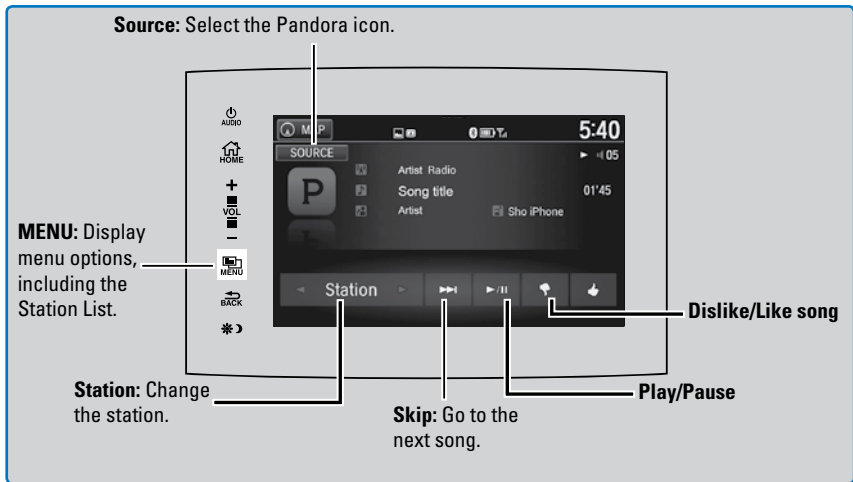

\*If equipped. Applicable laws may prohibit the operation of handheld electronic devices while operating a vehicle. Launch streaming audio on your phone only when it is safe to do so.