

AUDIO AND CONNECTIVITY

Learn how to operate the vehicle's audio system.

Basic Audio Operation

Connect audio devices and operate buttons and displays for the audio system.

■ USB Port

Install the iPod® USB connector or the USB flash drive to the front USB port.

Models with Color Audio

The USB port (1.0A) is for playing audio files on a USB flash drive and connecting a cellular phone and charging device.

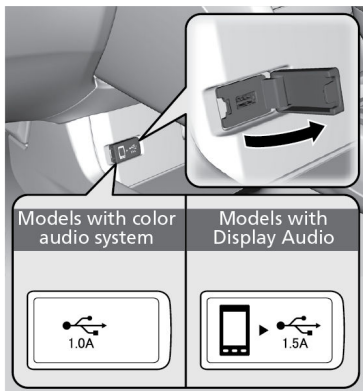

Tip: To prevent any potential issues, be sure to use an Apple MFi Certified Lightning Connector for Apple CarPlay™ or a USB cable certified by USB-IF to be compliant with USB 2.0 Standard for Android Auto™.