

Adaptive Cruise Control (ACC)

Helps maintain a constant vehicle speed and a set following interval behind a vehicle detected ahead of yours.

When to use

The camera is located behind the rearview mirror.



The radar sensor is inside the front grille.

- ☒ Vehicle speed for adaptive cruise control: Desired speed in a range above roughly 25 mph (40 km/h) ~
- ☒ Gear positions for adaptive cruise control: In D or S

■ Activating and Setting the Vehicle Speed

1. Press the MAIN button. The ACC indicator appears in the multi-information display.
2. Accelerate to the desired speed (above 25 mph/40 km/h). Take your foot off the pedal and press the SET/- button to set the speed.

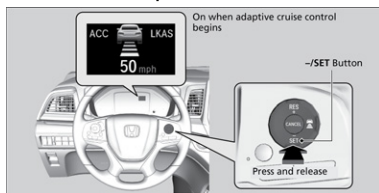

■ Adjusting the Vehicle Speed

Press the RES/+ button to increase speed or the SET/- button to decrease speed.



Each time you press the button, the vehicle speed is increased or decreased by about 1 mph (1.6 km/h). If you keep the button pressed, the vehicle speed increases or decreases by 5 mph or 5 km/h until you release it.

■ Adjusting the Vehicle Distance

Press the Interval button to change the following interval. Each time you press the button, the setting cycles through extra long, long, middle, and short.

■ During Operation

If a vehicle is detected ahead of you when ACC is turned on, the system maintains, accelerates, or decelerates your vehicle's set speed to keep the vehicle's set following interval from the vehicle ahead.

If a vehicle detected ahead of you slows down abruptly, or if another vehicle cuts in front of you, a beep sounds and BRAKE appears on the multi-information display to alert you .

When your vehicle speed drops below 22 mph (35 km/h), ACC will cancel and no longer apply your vehicle's brakes. Always be ready to brake when needed.

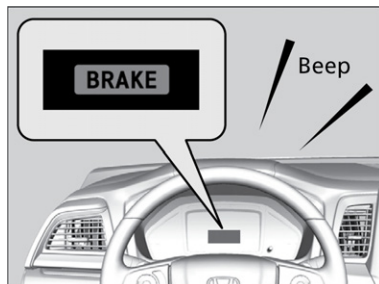

⚠ WARNING

ACC has limited braking capability.

When your vehicle speed drops below 22 mph (35 km/h), ACC will automatically cancel and no longer will apply your vehicle's brakes.

Always be prepared to apply the brake pedal when conditions require.

■ Canceling ACC

Press the CANCEL button, MAIN button or press the brake pedal.

Certain conditions may cause ACC to cancel automatically. When this happens, a message appears on the multi-information display.

After cruise control has been canceled, you can still resume the prior set speed by pressing the RES/+ switch.

Press the MAIN button to turn the system off.

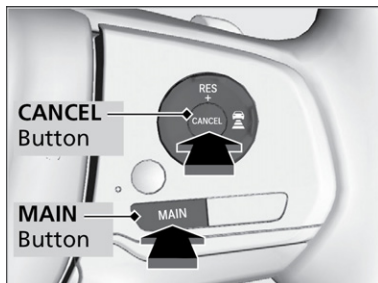

⚠ WARNING

Improper use of ACC can lead to a crash.

Use ACC only when traveling on open highways in good weather.

■ **Switching to Standard Cruise Control**

Press and hold the Interval button.

Cruise Mode Selected appears in the multi-information display. Press and hold the button again to switch back to ACC.

