

■ Power Sliding Doors*1

When the vehicle is OFF or the remote engine start mode is active, the power sliding doors operate when:

- The power sliding door switch is ON (as shown) and
- The power sliding door is unlocked and
- The fuel fill door is closed (for driver's side sliding door).

When the vehicle is ON, the power sliding doors operate when:

- The shift position is P and
- The brake pedal is depressed or the electric parking brake is applied and
- You use the power sliding door switches on the dashboard.

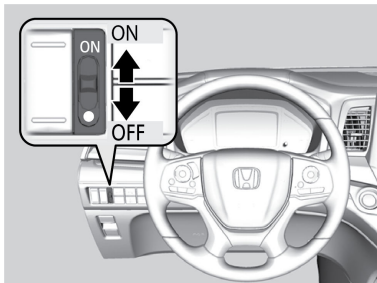

**1 - If equipped*

From the inside

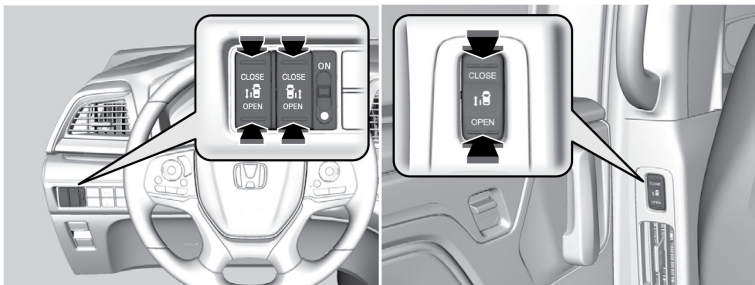

Press OPEN on the power sliding door button for the desired door side.

Press CLOSE to close the door.

While a power sliding door is in operation, you can press the button again to stop it from opening or closing. Press the button again to resume operation.

A sliding door will not open fully if the window is open more than 3 inches (8 cm). Close the door, close the window, and open the door again.

The driver's side sliding door will not open if the fuel fill door is opened.

Note: Closing a sliding door while any part of a passenger is in the door's path can cause serious injury.

Make sure all passengers are clear of the doorway before closing a sliding door.