

AUDIO AND CONNECTIVITY

Learn how to operate the vehicle's audio system.

Basic Audio Operation

Connect audio devices and operate buttons and displays for the audio system.

■ USB Port

Install the iPod® USB connector or the USB flash drive to the USB port.

On the console panel

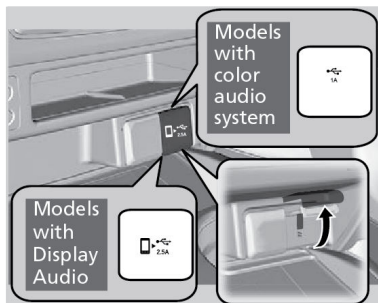

Models with Display Audio

The USB port (2.5A)(1.5A) is for charging devices, playing audio files and connecting compatible phones with Apple CarPlay™ or Android Auto™.

To prevent any potential issues, be sure to use an Apple MFi Certified Lightning Connector for Apple CarPlay™, and for Android Auto™, the USB cables should be certified by USB-IF to be compliant with USB 2.0 Standard.

In the console compartment

The USB port (2.5A) is only for charging devices.

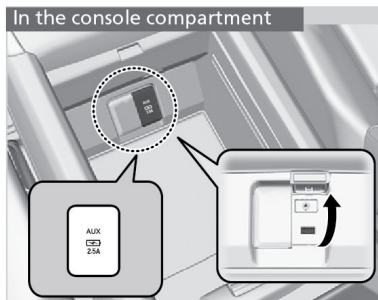

On the back of the console compartment*1

The USB ports (2.5A) are only for charging devices.

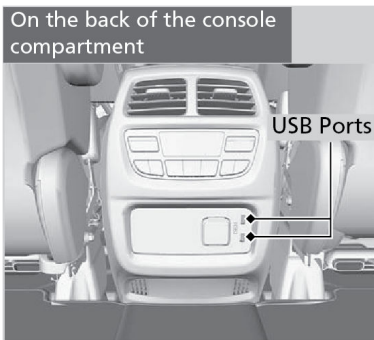

Tip: To prevent any potential issues, be sure to use an Apple MFi Certified Lightning Connector for Apple CarPlay™ or a USB cable certified by USB-IF to be compliant with USB 2.0 Standard for Android Auto™.

■ Auxiliary Input Jack

Use the jack to connect standard audio devices.

1. Open the AUX cover.
2. Connect a standard audio device to the input jack using a 1/8 inch (3.5 mm) stereo miniplug.

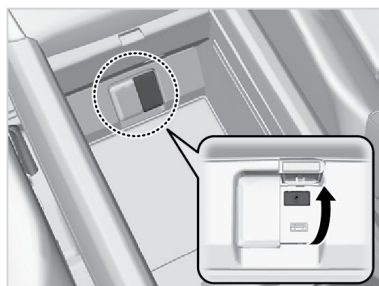

■ Accessory Power Socket

The accessory power sockets can be used when the power mode is in ACCESSORY or ON.

Console panel

Open the lid and the cover to use it.

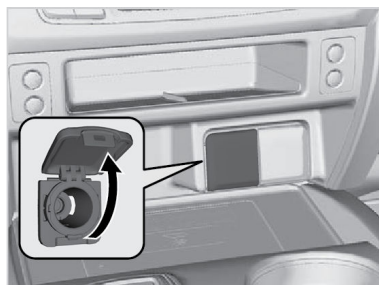

USB Flash Drive

Your audio system reads and plays sound files on a USB flash drive in either MP3, WMA, or AAC format. Connect your USB flash drive to the USB port .

Models with Display Audio

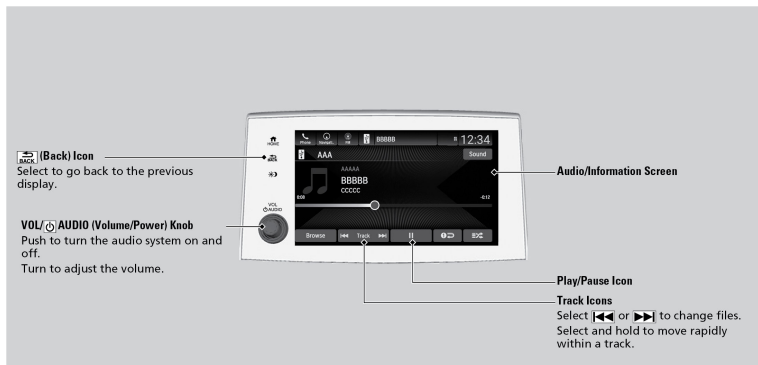

■ Searching for Music

Models with Display Audio

Use the touchscreen to search for tracks.

1. Select **Browse**.
2. Select the items on that menu.

