

AUDIO AND CONNECTIVITY

Learn how to operate the vehicle's audio system.

Basic Audio Operation

Connect audio devices and operate buttons and displays for the audio system.

You can operate the audio system from the buttons*¹ and knobs on the panel, the remote controls on the steering wheel, or the icons on the touchscreen interface *¹.



■ USB Port

Install the iPod® USB connector or the USB flash drive to the USB port.

On the console panel

The USB port (1.0A) is for playing audio files on a USB flash drive, connecting a cellular phone and charging devices.

The USB port (2.5A) on the right side is for charging devices, playing audio files and connecting compatible phones with Apple Carplay™ or Android Auto™.

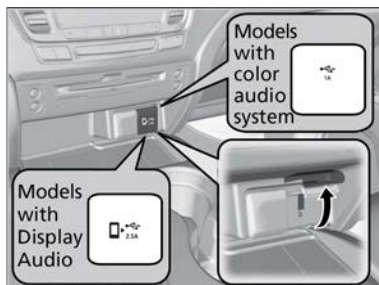

AUDIO AND CONNECTIVITY

In the console compartment

The USB port (2.5A) is only for charging devices.

On the back of the console compartment*1

The USB ports (2.5A) are only for charging devices.

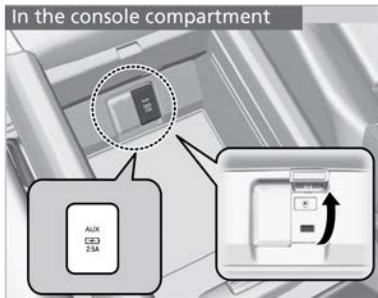

On the back of the console compartment



**1 - If equipped*

AUDIO AND CONNECTIVITY

USB Flash Drive

Your audio system reads and plays sound files on a USB flash drive in either MP3, WMA, or AAC*¹ format. Connect your USB flash drive to the USB port, then press the **MEDIA** button.