

Customized Features

Before you customize settings, make sure that the vehicle is at a complete stop and shift to Park (P).

Models with Color Audio

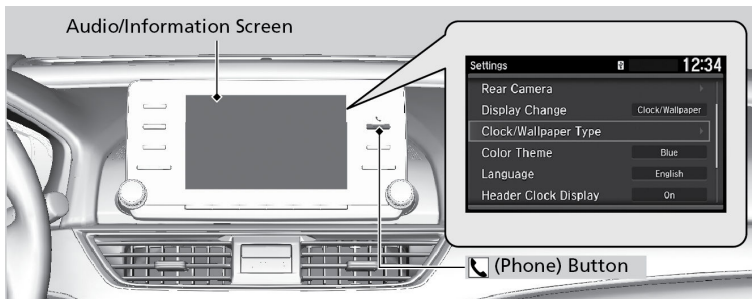

Models with Display Audio



■ To Change a Setting

Models with Color Audio

Use the selector knob to make and enter selections.

1. Press the MENU/CLOCK button.
2. Select Settings.
3. Select a setting option and make your preferred changes.

Models with Display Audio

1. Press the **Home** button.
2. Select **Settings**.
3. Select a category.
4. Select a setting option, and make your preferred changes.

Setting the Clock

On vehicles with navigation, the time is automatically set using GPS signals. To manually adjust the clock, use the following steps:

Models with Color Audio

1. Press and hold the **MENU/CLOCK** button.
2. Select **Adjust Clock**, then press the selector knob.
3. Rotate to change the hour, then press the selector knob.
4. Rotate to change the minute, then press the selector knob to switch to Set.
5. Press the selector knob to complete clock adjustment.

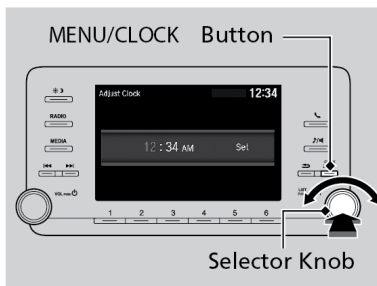

Models with Display Audio

The vehicle is equipped with an Automatic Date & Time feature. If you would like to turn this feature off and manually adjust the time, use the following steps.

1. Press the **HOME** icon, then select **Settings**.
2. Select **System**.
3. Select **Day & Time**.
4. Select **Set Date & Time**.
5. Select **Automatic Date & Time**, then select **OFF**.
6. Select **Set Time**.
7. Use the **Up or Down arrow** to change the time.
8. Select **Save** to set the time.

