

Power Moonroof*¹ Operation

The moonroof can be opened and closed when the vehicle is on by using the switch on the ceiling.

■ Automatic Operation

To open: Firmly pull the switch back.

To close: Firmly push the switch forward.

The moonroof will automatically open or close all the way. To stop the moonroof at any time, push the switch briefly.

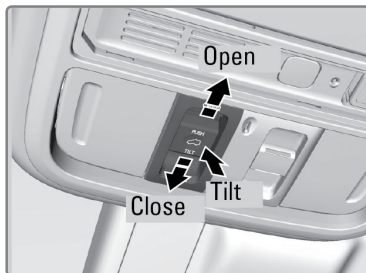

■ Manual Operation

To open: Push down on the switch lightly, and hold it until the desired position is reached.

To close: Pull the switch up lightly, and hold it until the desired position is reached.

■ Moonroof Tilt

To tilt: Push the center of the switch.

To close: Push the switch forward firmly, then release.

NOTICE

Opening the moonroof in below freezing temperature or when it is covered with snow or ice can damage the moonroof panel or motor.

⚠ WARNING

Opening or closing the moonroof on someone's hands or fingers can cause serious injury.

Make sure all hands and fingers are clear of the moonroof before opening or closing it.