

## In-Bed Convenience Items

### ■ In-Bed Box

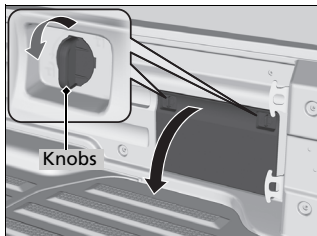

Turn the knobs to the left to open the lid.

### ■ AC Power Outlet\*

To use the AC power outlet, the power mode must be in ACCESSORY or ON.

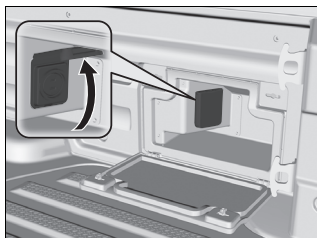

1. Turn the knobs to the left to open the lid.
2. Open the cover and plug in the appliance slightly. Turn the plug 90° clockwise, then push it in all the way.

### ⊠ AC Power Outlet\*

Do not use the AC power outlet for electrical appliances that require high initial peak wattage, such as cathode-ray tube type televisions, refrigerators, electric pumps, etc. It is not suitable for devices that process precise data, such as medical equipment, and that require an extremely stable power supply, such as microcomputer-controlled electric blankets, touch sensor lamps, etc.

The AC power outlet is designed to supply power for up to 115 volt appliances that are rated 400 watts or less.

Continued use of any electrical appliance/device exceeding these ratings may result in damage to the appliance/device.

When the AC power outlet is not in use, close the cover to prevent any small foreign objects from getting into the AC power outlet.

\* Not available on all models

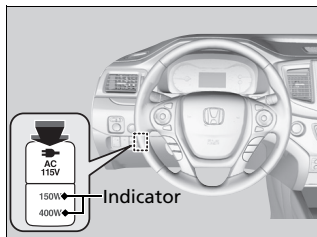

### ■ ON and OFF

Press the AC power outlet button to turn the system on and off.

- The indicator in the button comes on when the system is on.

**400W** (Amber) mode is:

- When the engine running and the transmission in **P**.

**150W** (Green) mode is:

- When the power mode is in ACCESSORY or ON.
- When the engine running and the transmission out of **P**.
- When the truck bed audio system is activated.

### ⊗ AC Power Outlet\*

The protection circuit may be activated to cut the power supply if any of the following conditions apply:

- The engine is started when the power outlet switch on.
- An electrical appliance exceeding the maximum capacity is used.
- The total power consumed by the electrical features (head lights, air conditioning, etc.), including the truck bed audio, has exceeded the maximum vehicle wattage capacity for a prolonged period of time.

\* Not available on all models