

# Honda Sensing® [↔ P. 423](#)

Honda Sensing® is a driver support system which employs the use of two distinctly different kinds of sensors, a radar sensor located behind the emblem and a front sensor camera mounted to the interior side of the windshield, behind the rearview mirror.

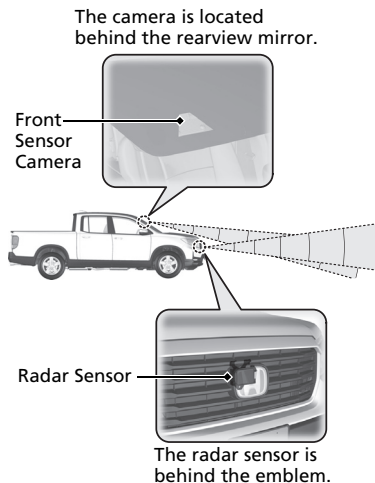

## Collision Mitigation Braking System™ (CMBST™) [↔ P. 426](#)

Can assist you when there is a possibility of your vehicle colliding with a vehicle or a pedestrian detected in front of yours. The CMBST™ is designed to alert you when the potential for a collision is determined, as well as to reduce your vehicle speed to help minimize collision severity when a collision is deemed unavoidable.

## Adaptive Cruise Control (ACC) [↔ P. 438](#)

Helps maintain a constant vehicle speed and a set following-interval behind a vehicle detected ahead of yours, without you having to keep your foot on the brake or the accelerator.

## Lane Keeping Assist System (LKAS) [↔ P. 451](#)

Provides steering input to help keep the vehicle in the middle of a detected lane and provides tactile and visual alerts if the vehicle is detected drifting out of its lane.

## Road Departure Mitigation System [↔ P. 460](#)

Alerts and helps to assist you when the system detects a possibility of your vehicle unintentionally crossing over detected lane markings and/or leaving the roadway altogether.

Honda Sensing® is a driver support system which employs the use of two distinctly different kinds of sensors: a radar sensor located behind the emblem and a front sensor camera mounted to the interior side of the windshield, behind the rearview mirror.

Honda Sensing® has following functions.

■ **The functions which do not require switch operations to activate**

- Collision Mitigation Braking System™ (CMBS)™ ➡ P. 426
- Road Departure Mitigation System ➡ P. 460

■ **The functions which require switch operations to activate**

- Adaptive Cruise Control (ACC) ➡ P. 438
- Lane Keeping Assist System (LKAS) ➡ P. 451

## ■ Operation Switches for the ACC/LKAS

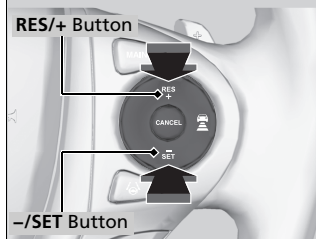
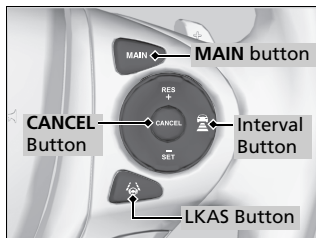

### ■ MAIN Button

Press to activate standby mode for ACC and LKAS. Or press to cancel these systems.

### ■ LKAS Button

Press to activate or cancel the LKAS.

### ■ RES/+ and -/SET Buttons

Press **RES/+** button to resume the ACC or increase the vehicle speed.

Press **-/SET** button to set the ACC or decrease the vehicle speed.

### ■ Interval Button

Press to change the ACC following-interval.

### ■ CANCEL Button

Press to cancel ACC.

## Instrument Panel Content

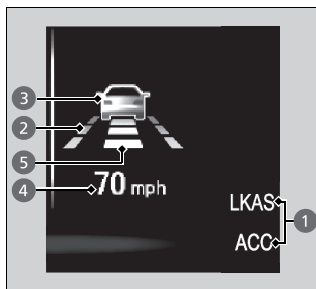

You can see the current state of ACC and LKAS.

- 1 Indicates that ACC and LKAS are ready to be activated.
- 2 Indicates that LKAS is activated and whether or not traffic lane lines are detected.
- 3 Indicates whether or not ACC detected the vehicle ahead.
- 4 Indicates that ACC shows the set vehicle speed.
- 5 Indicates that ACC shows the set vehicle interval.